

STUDIO
BOOTH

FULL - SERVICE ARCHITECTURAL DESIGN

Bedfordshire

Email: contact@studio-booth.co.uk
Website: www.studio-booth.co.uk
Telephone: 07901 913 918

NOTES:

REVISIONS:

A Rear extension reduced to 3m	01.03.24
B Revised to suit planning requirements	03.09.24
C Externals and crossover updated	09.09.24

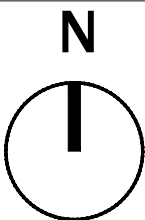

STATUS: PLANNING APPROVAL

CLIENT:

Topping

PROJECT:
CONVERSION OF DWELLING
INTO TWO FLATS
AT 23 SKIPTON DRIVE
HAYES
UB3 1PL

TITLE:

SITE & LOCATION PLAN

SCALE: 1:100/ 1:1250 @ A2

DRAWN BY: TB

DATE: 28.11.23

NUMBER:

100C



2 LOCATION PLAN
SCALE 1:1250

ADJACENT REAR
EXTENSION

EXISTING VEGETATION
TO BE RETAINED &
PRUNED

EXISTING VEGETATION
TO BE RETAINED

ADJACENT
OUTBUILDING

ADJACENT REAR
EXTENSION

ADJACENT
OUTBUILDING

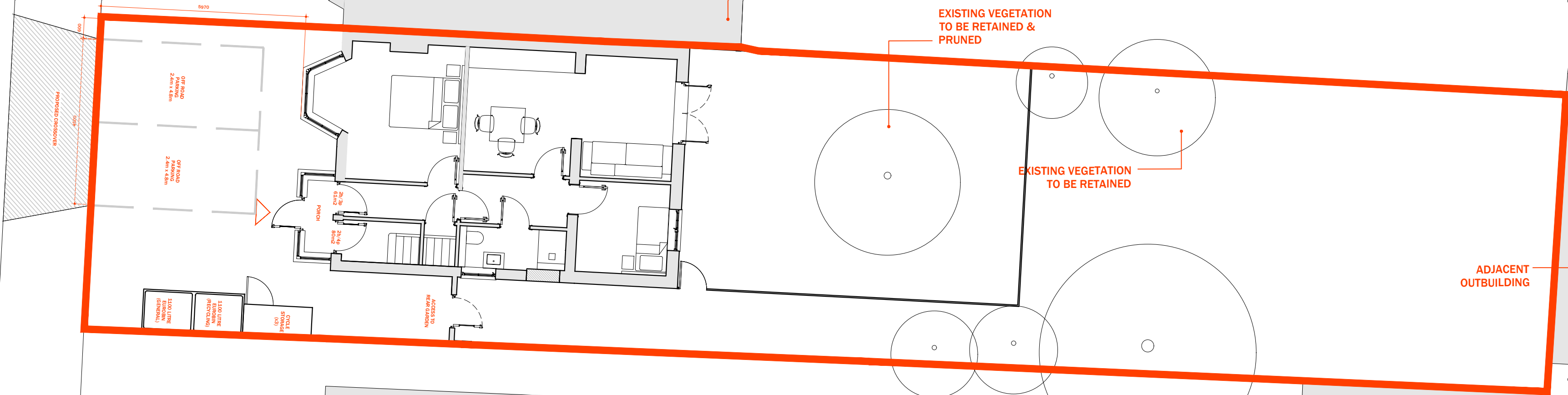

1 SITE PLAN
SCALE 1:100