

studio BOOTH

FULL - SERVICE ARCHITECTURAL DESIGN

Bedfordshire

Email: contact@studio-booth.co.uk

Website: www.studio-booth.co.uk

Telephone: 07901 913 918

NOTES:

REVISIONS:

A Rear extension reduced to 3m	01.03.24
B Revised to suit planning requirements	03.09.24

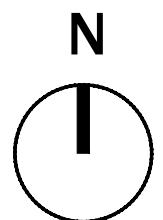

STATUS: **PLANNING APPROVAL**

CLIENT:

Topping

PROJECT:

**REAR EXTENSION
AT 23 SKIPTON DRIVE
HAYES
UB3 1PL**

TITLE:

SITE & LOCATION PLAN

SCALE: **1:100/ 1:1250 @ A2**

DRAWN BY: **TB**

DATE: **28.11.23**

NUMBER:

100B



2 LOCATION PLAN
SCALE 1:1250

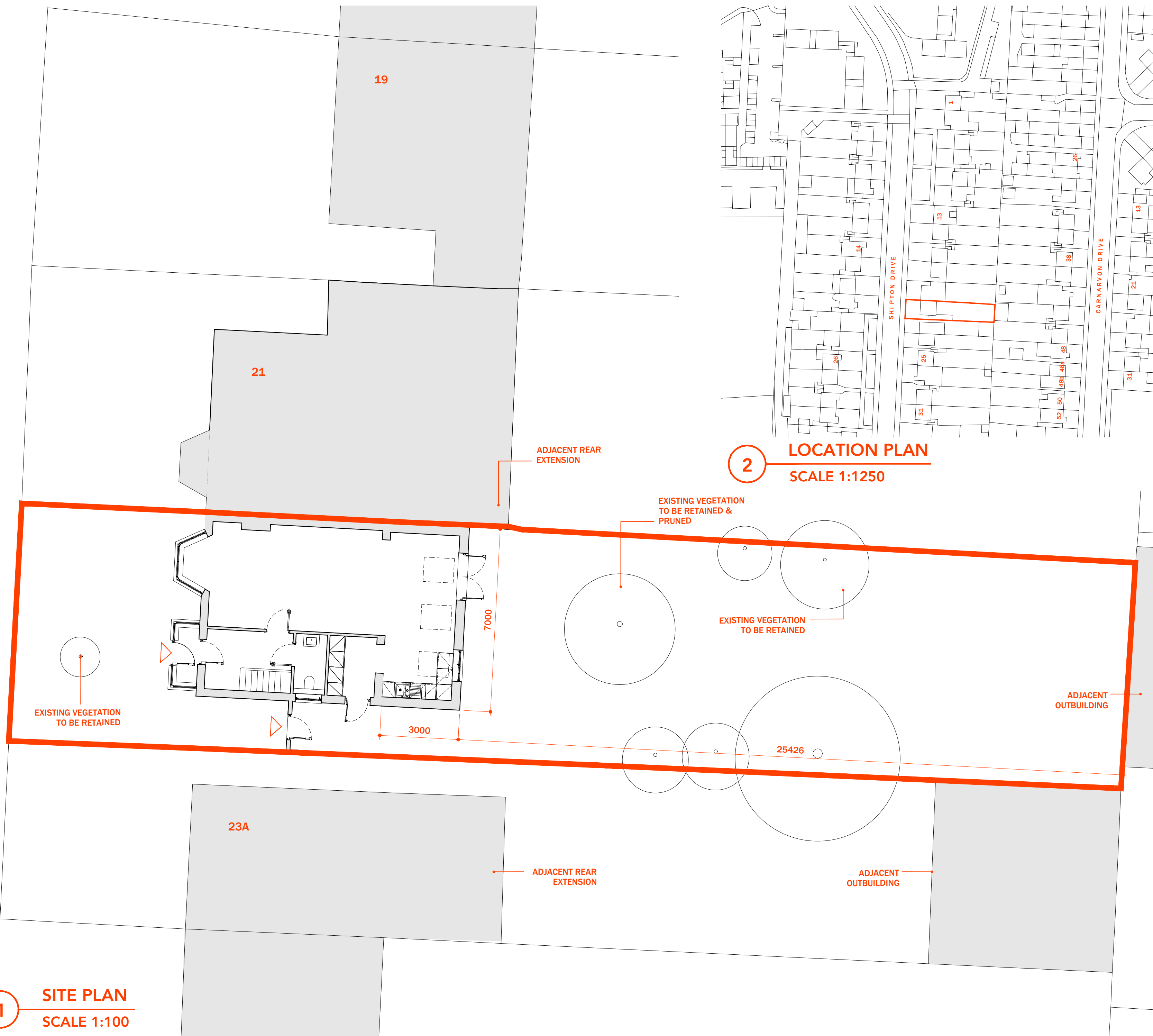

1 SITE PLAN
SCALE 1:100