

Existing Site Plan

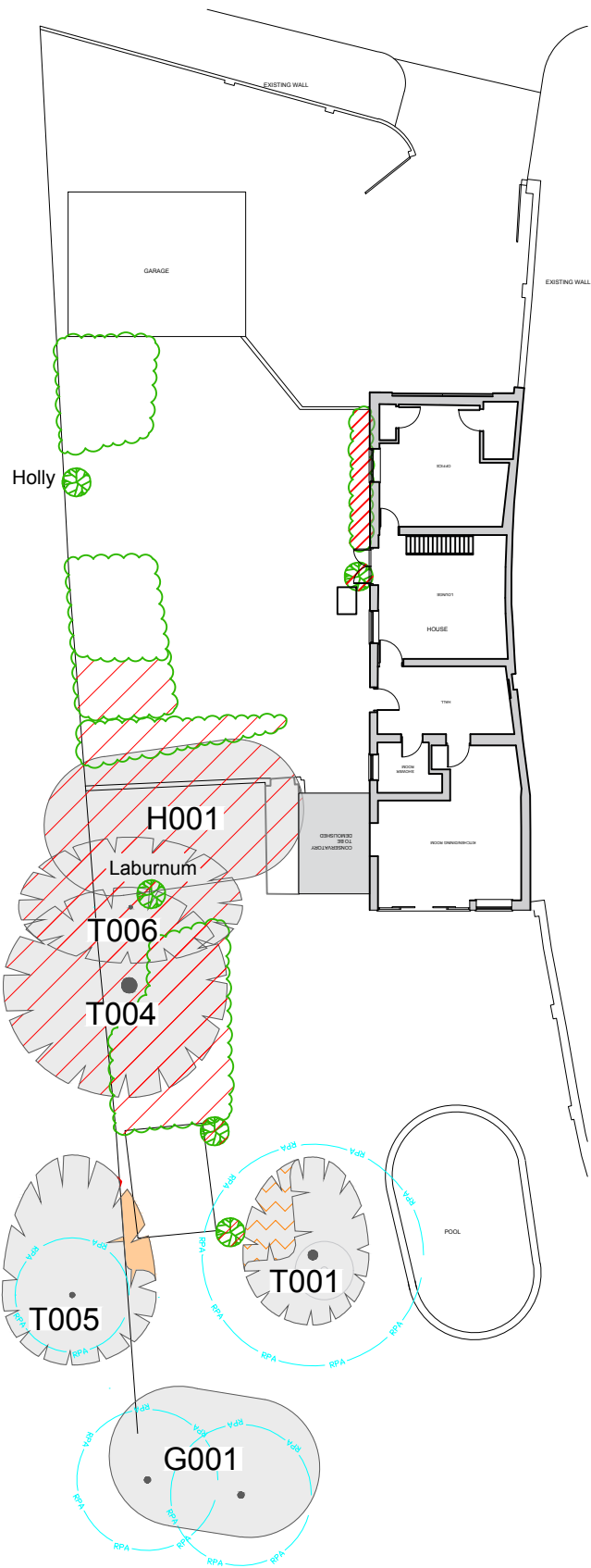

LEGEND

	Existing Tree/Feature BS 5837:2012 Category C
	Existing Tree/Hedge to be crown lifted to allow for development
	Trees which require crown reduction to facilitate the prospective development
	Line of Root Protection Area (RPA) - calculated following guidelines set in BS 5837:2012
	Existing Tree/Feature to be removed to allow for development BS 5837:2012 Category C
	Additional feature which doesn't meet BS 5837: 2012 categorisation but is included for reference
	Additional feature which doesn't meet BS 5837: 2012 categorisation but is included for reference

Proposed Site Plan

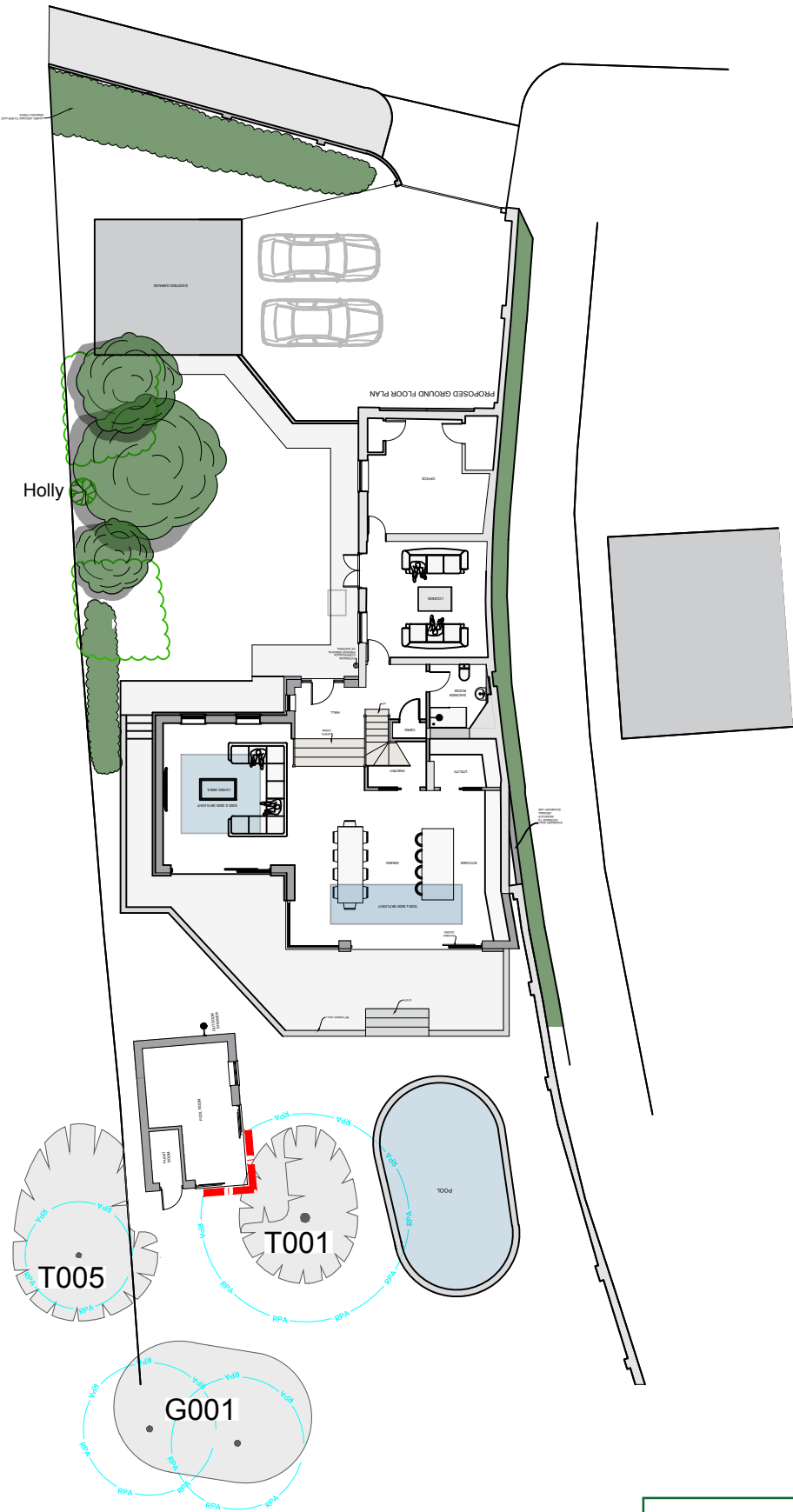

LEGEND

	Line of proposed Root Pruning
--	-------------------------------

TREE PROTECTION STATUS

Hayden's sourced TPO & Conservation Area status from the Local Planning Authority's Online Mapping System on 26/06/2025.

We were informed that:

- No TPO's are present on site
- The site is located within a conservation area

We would advise it prudent that before any tree work commences, this is checked directly with the Local Planning Authority to confirm that their online mapping system is definitive.

CATEGORY AND DEFINITION

Trees unsuitable for retention	
Category U	Those in such condition that they cannot realistically be retained as living trees in the current land use for longer than 10 years
Trees to be considered for retention	
Category A	Trees of high quality with an estimated remaining life expectancy of at least 40 years
Category B	Trees of moderate quality with an estimated remaining life expectancy of at least 20 years
Category C	Trees of low quality with an estimated remaining life expectancy of at least 10 years, or young trees with a stem diameter below 150mm

NOTE:

Hayden's Arboricultural Consultants were provided with a Topographical Survey but these do not always show the positions of all the trees/features on site. The locations of any additional features have been fixed using GPS. As such the position of the trees/landscape features should not be taken as exact but gives a fair distribution of their locations on site.



17/07/25 KFJ Based on LPS Architecture Drawings: 1.0 00 and 1.2 00

Rev: Date: By: Revision:

The position, condition, and dimensions of the trees are based on a site survey undertaken on 25/08/22

"The original of this drawing was produced in colour - a monochrome copy should not be relied upon"

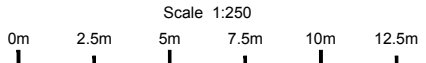

© HAYDEN'S 2025

5 Moseleys Farm Business Centre,
Fornham All Saints,
Bury St Edmunds,
Suffolk, IP28 6JY.

Head Office: 01284 765391

Southern Office: 01722 657423

www.treesurveys.co.uk Email: info@treesurveys.co.uk

Client:	LPS Architecture	Drawing Title:	Prelim AIA (Extension)
---------	------------------	----------------	------------------------

Site: The Old Stables, 77 Park Lane, Harefield, UB9 6BL

Date:	17/07/2025	Drawn By:	KFJ	Cad File Ref:	C:\Pro\11808-D-AIA - The Old Stables 77 Park Lane Harefield
Scale:	1:250 (A3)	Checked By:	AT	Drawing No:	11808-D-AIA
				Rev:	-