

Existing Site Plan
@ Scale 1:500

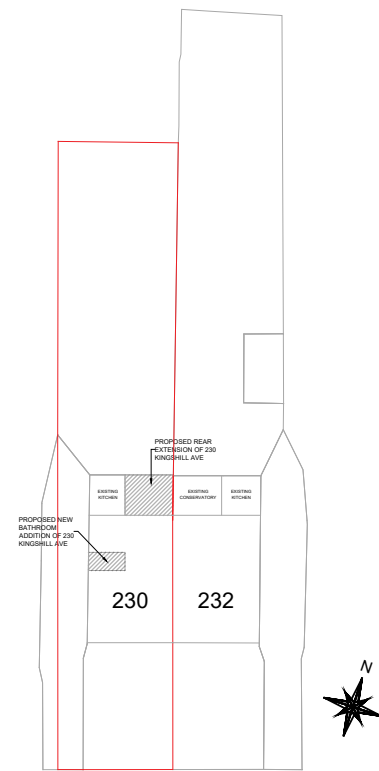

Proposed Site Plan
@ Scale 1:500



Location Plan @ Scale 1:1250

Proposed Development:
Conversion of Single Story Rear
Conservatory to Single Story Rear Extension

Site Address:
230 Kingshill Avenue
Hayes
UB4 8DA

Drawing Description:
Site and Location Plan

Drawing No:
PDC/KHA230/SLP-03

Scale: 1:500, 1:1250
Paper Size: A3
Sheet No: 1 of 7

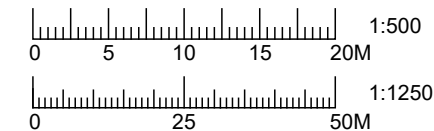

Plan Design Construct Ltd.
Contact: 07424 796662
Email: contact@plandesignconstruct.co.uk
Website: <http://plandesignconstruct.co.uk>