

ROOF LIGHTS on pitch roof
Rooflights to be double glazed + to meet 'U' value of min. 2.0 W/m sq.K.
All roof lights to be A-A fire rated.

Double up rafters on the side of opening, supporting double trimmers above & below opening. Bolt together with M12 bolts at 450 c/s.
Must be 450mm minimum clear opening with non opening fasteners.

Slim line frame for pitched roof.
Reset within roof tiles.
Can be fixed to roof pitch as low as 12 deg. & as high as 90 deg.

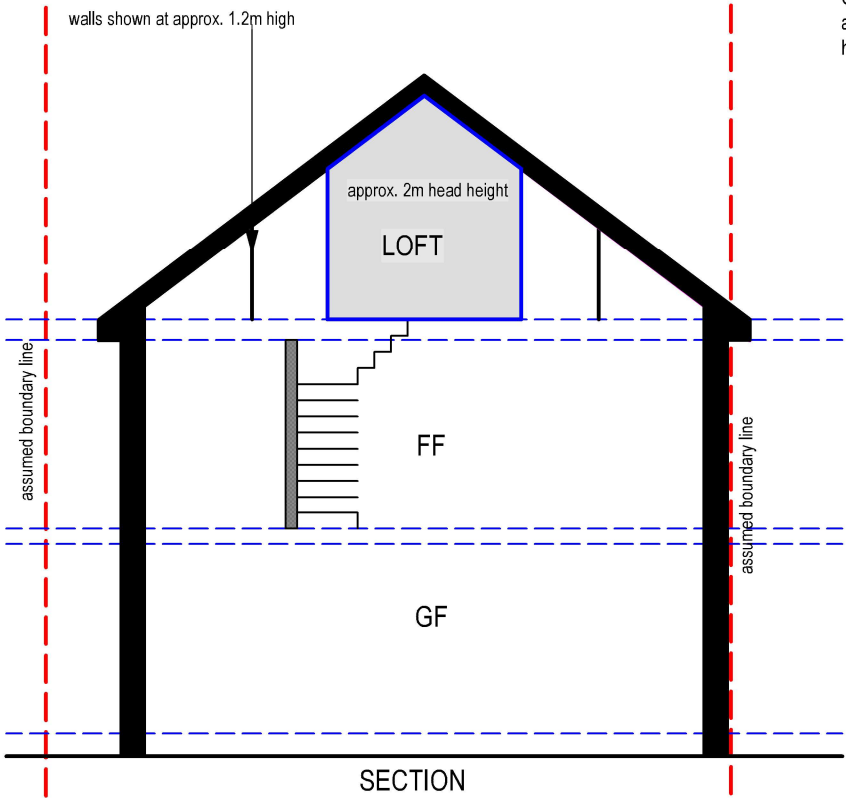

- New internal walls
- New external walls
- Walls to be demolished
- New doors/windows
- Proposed work shaded
- Rooflight

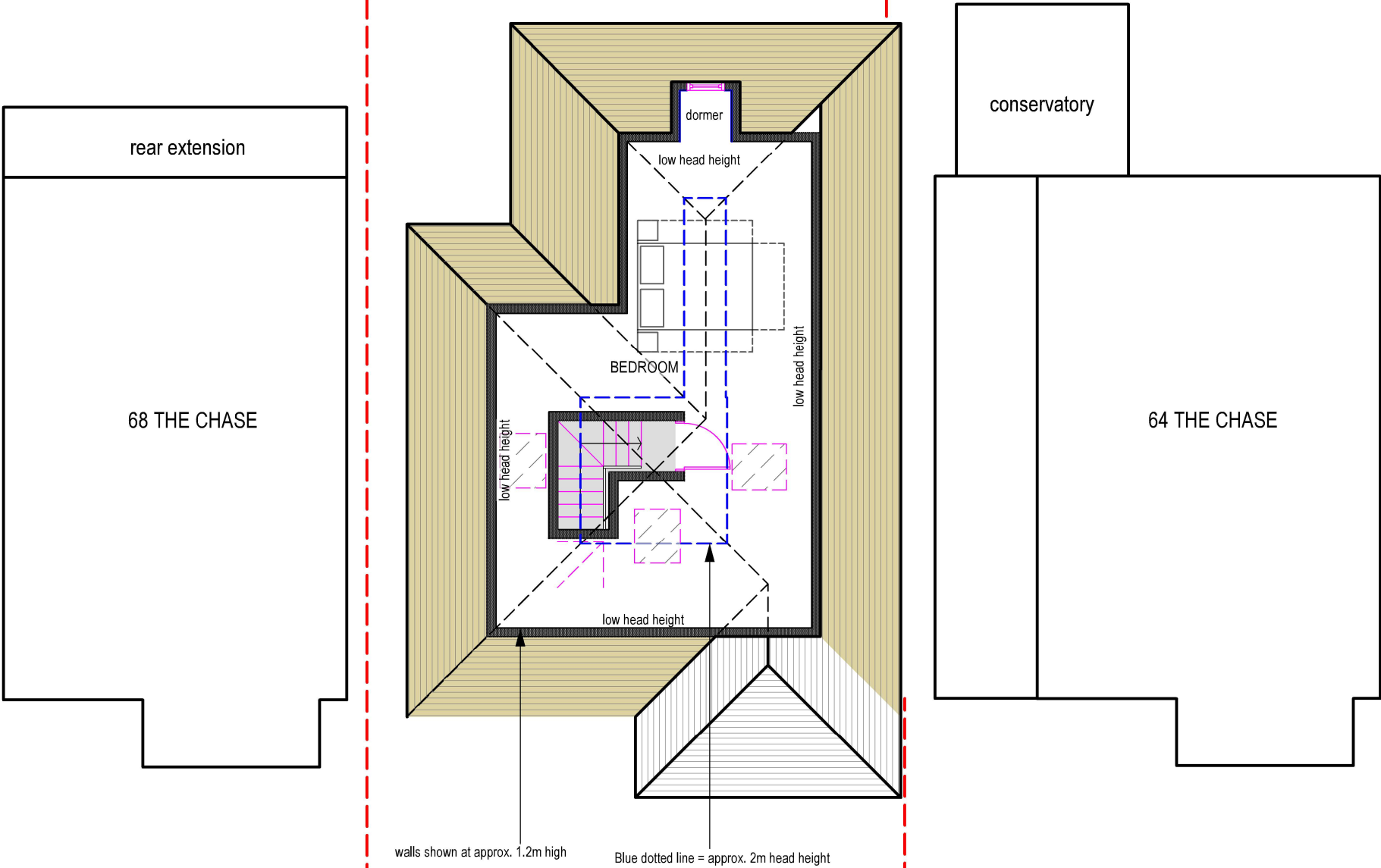

13

PROP LOFT PLAN
Scale: 1:100



tel : 0796 222 3141
email : sandeep@sskarchitects.co.uk

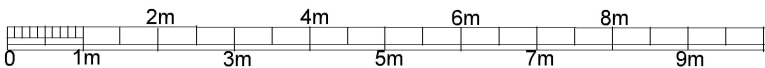

scale - 1 : 100 @ A3

Purpose - Householder planning application

All dimensions to be checked on site. All omissions & discrepancies to be reported to the designer. © SSK architects owns the copyright of this drawing which must not be reproduced in whole or part without the written permission.	PROJECT: 66 The Chase, Pinner, HA5 1SN	DATE: 24/02/2025
	DWG NO: PROP LOFT	REVISION: 13

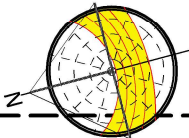

PROPOSED