



EXISTING
FRONT SITE PICTURE



PROPOSED
FRONT SITE PICTURE

PROPOSED
TO INCREASING WIDTH
OF LOWERING CURB STONE

THIS DRAWING AND ALL THE INFORMATION CONTAINED HEREIN, COMPLETE WITH THE DESIGN CONCEPT AND INTENT, IS PROTECTED BY COPYRIGHT AND IS THE PROPERTY OF ZD DESIGN LTD. NO PART OF THIS DRAWING OR THE INFORMATION CONTAINED HEREIN MAY BE REPRODUCED OR TRANSMITTED IN ANY FORM OR BY ANY MEANS, ELECTRONIC OR MECHANICAL, INCLUDING PHOTOCOPYING, RECORDING, OR BY ANY INFORMATION STORAGE AND RETRIEVAL SYSTEM, WITHOUT THE WRITTEN PERMISSION OF ZD DESIGN LTD.

CONTRACTOR TO PREPARE AND SUBMIT SHOP DRAWINGS FOR DESIGNER'S APPROVAL.
THE CONTRACTOR SHALL VERIFY AND BE RESPONSIBLE FOR THE TRUE SETTING OUT ON SITE AND SHALL OBTAIN WRITTEN APPROVAL OF ZD DESIGN LTD. IF THERE ARE VARIANTS OR DISCREPANCIES.
IT IS THE CONTRACTOR'S RESPONSIBILITY TO SUBMIT SAMPLES OF MATERIALS AND FINISHES FOR APPROVAL PRIOR TO FINAL APPLICATION.
IT IS THE CONTRACTOR'S RESPONSIBILITY TO CHECK THE DRAWINGS AND ANY DESIGN DETAIL FOR THE INTENDED RESULTS.

SCALE BAR



E info @ zddesign . co . uk
E francois@zddesign.co.uk
www. z d d e s i g n . co . uk
MOB. 078 0 33 01 656
TEL : 020 4 5 4 2 3 8 2 3
449 LITTLE VENICE
EDGWARE ROAD
LONDON W2 1TH

PROJECT	HOUSE N : 61	JOB N	ZDD- HA4 6PU 20-10-22
CLIENT	Mr. MAHMOUD RIDHA	61 CLYFFORD ROAD RUISLIP LONDON HA4 6PU LOCATION	
INTERIOR ARCHITECTURE	F Z		
DATE	31 DECEMBER 2022		

REVISION		DATE	PAGE	801
A	ARCHITECTURAL DESIGN DWGS	05 - 11 - 22		
B	ARCHITECTURAL DESIGN DWGS	31 - 12 - 22	A 3	
C				
D			DWGS	REF
E			PROPOSED	
F			FRONT VIEW	
G			REF-DWGS	ZDD HA4 6PU REV B: 801



EXISTING
REAR SITE PICTURE



PROPOSED
REAR SITE PICTURE

THIS DRAWING AND ALL THE INFORMATION CONTAINED HEREIN, COMPLETE WITH THE DESIGN CONCEPT AND INTENT, IS PROTECTED BY COPYRIGHT AND IS THE PROPERTY OF ZD DESIGN LTD. NO PART OF THIS DRAWING OR THE INFORMATION CONTAINED HEREIN, MAY BE REPRODUCED OR TRANSMITTED IN ANY FORM OR BY ANY MEANS, WITHOUT THE WRITTEN PERMISSION OF ZD DESIGN LTD. ALL MEASUREMENTS ARE IN MILLIMETERS UNLESS OTHERWISE SPECIFIED. IT IS THE CONTRACTOR'S RESPONSIBILITY TO CHECK THE DRAWING AND ANY DESIGN DETAIL FOR THE INTENDED RESULTS.

CONTRACTOR TO PREPARE AND SUBMIT SHOP DRAWINGS FOR DESIGNER'S APPROVAL. THE CONTRACTOR SHALL VERIFY AND BE RESPONSIBLE FOR THE TRUE SETTING OUT ON SITE AND SHALL OBTAIN WRITTEN APPROVAL OF ZD DESIGN LTD IF THERE ARE VARIANTS OR DISCREPANCIES. IT IS THE CONTRACTOR'S RESPONSIBILITY TO SUBMIT SAMPLES OF MATERIALS AND FINISHES FOR APPROVAL PRIOR TO FINAL APPLICATION.

SCALE BAR



INTERIOR ARCHITECTURE DESIGN PLANNING

E info @ zddesign . co . uk
E francois@zddesign.co.uk
www. z d d e s i g n . co . uk
MOB. 078 0 33 01 656
TEL : 020 4 5 4 2 3 8 2 3

449 LITTLE VENICE
EDGWARE ROAD
LONDON W2 1TH

PROJECT	HOUSE N : 61	JOB N	ZDD- HA4 6PU 20-10-22
CLIENT	Mr. MAHMOUD RIDHA	61 CLYFFORD ROAD RUISLIP LONDON HA4 6PU	
INTERIOR ARCHITECTURE	F Z		
DATE	31 DECEMBER 2022		

REVISION		DATE	PAGE	802
A	ARCHITECTURAL DESIGN DWGS	05 - 11 - 22		
B	ARCHITECTURAL DESIGN DWGS	31 - 12 - 22	A 3	
C				
D			DWGS	REF
E			PROPOSED	
F			REAR VIEW	
G			REF-DWGS	ZDD HA4 6PU REV B: 802



PROPOSED
FRONT VIEW



PROPOSED
REAR VIEW

THIS DRAWING AND ALL THE INFORMATION CONTAINED HEREIN, COMPLETE WITH THE DESIGN CONCEPT AND INTENT, IS PROTECTED BY COPYRIGHT AND IS THE PROPERTY OF ZD DESIGN LTD. NO PART OF THIS DRAWING OR INFORMATION CONTAINED HEREIN MAY BE REPRODUCED OR TRANSMITTED IN ANY FORM OR BY ANY MEANS, ELECTRONIC OR MECHANICAL, INCLUDING PHOTOCOPYING, RECORDING, OR BY ANY INFORMATION STORAGE AND RETRIEVAL SYSTEM, WITHOUT THE WRITTEN PERMISSION OF ZD DESIGN LTD.

GENERAL NOTES

- CONTRACTOR TO PREPARE AND SUBMIT SHOP DRAWINGS FOR DESIGNER'S APPROVAL.
- THE CONTRACTOR SHALL VERIFY AND BE RESPONSIBLE FOR THE TRUE SETTING OUT ON SITE AND SHALL OBTAIN WRITTEN APPROVAL OF ZD DESIGN LTD IF THERE ARE VARIANTS OR DISCREPANCIES.
- IT IS THE CONTRACTOR'S RESPONSIBILITY TO SUBMIT SAMPLES OF MATERIALS AND FINISHES FOR APPROVAL PRIOR TO FINAL APPLICATION.

SCALE BAR

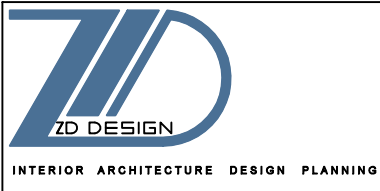

E info @ zddesign . co . uk
E francois@zddesign.co.uk
www. z d d e s i g n . co . uk
MOB. 078 0 33 01 656
TEL : 020 4 5 4 2 3 8 2 3

440 LITTLE VENICE
EDGWARE ROAD
LONDON W2 1TH

PROJECT	HOUSE N : 61	JOB N	ZDD- HA4 6PU 20-10-22
CLIENT	Mr. MAHMOUD RIDHA	61 CLYFFORD ROAD RUISLIP LONDON HA4 6PU	
INTERIOR ARCHITECTURE	F Z		
DATE	31 DECEMBER 2022		

REVISION		DATE	PAGE	803
A	ARCHITECTURAL DESIGN DWGS	05 - 11 - 22		
B	ARCHITECTURAL DESIGN DWGS	31 - 12 - 22	A 3	
C				
D				
E				
F				
G				
REF-DWGS		ZDD HA4 6PU REV B:	803	