

AERIAL VIEW

Site shown
in red

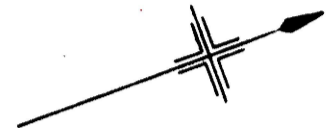

ILLINGDON



Description of proposed works

- Ground floor - Rear extension
- Ground floor - Front extension
- Ground floor - Internal alterations
- Ground floor - Rooflights
- First floor - Rear extension
- First floor - Internal alterations
- First floor - Rooflights
- Loft floor - Make habitable
- Loft floor - Rear dormer
- Loft floor - Rooflights

Drawing nos.	scale	Description
01	1:1250	Title sheet & Location Plan

Existing

02	Aerial views
03	1:150	Site plan
04	1:100	Ground floor plan
05	1:100	First floor plan
06	1:100	Roof plan
07	1:100	Elevations Front and rear
08	1:100	Elevations Side
09	Photos - front, rear & garden views
10	Planning statement

Proposed

11	1:150	Site plan
12	1:100	Ground floor plan
13	1:100	First floor plan
14	1:100	Loft floor plan
15	1:100	Roof plan
16	1:100	Elevations - front and rear
17	1:100	Elevations - side
18	Heritage Statement

Approx. areas

Existing		
Site area	-	955 sq. meters.
Ground Floor	-	160 sq. meters.
Proposed		
Ground Floor	-	35 sq. meters.

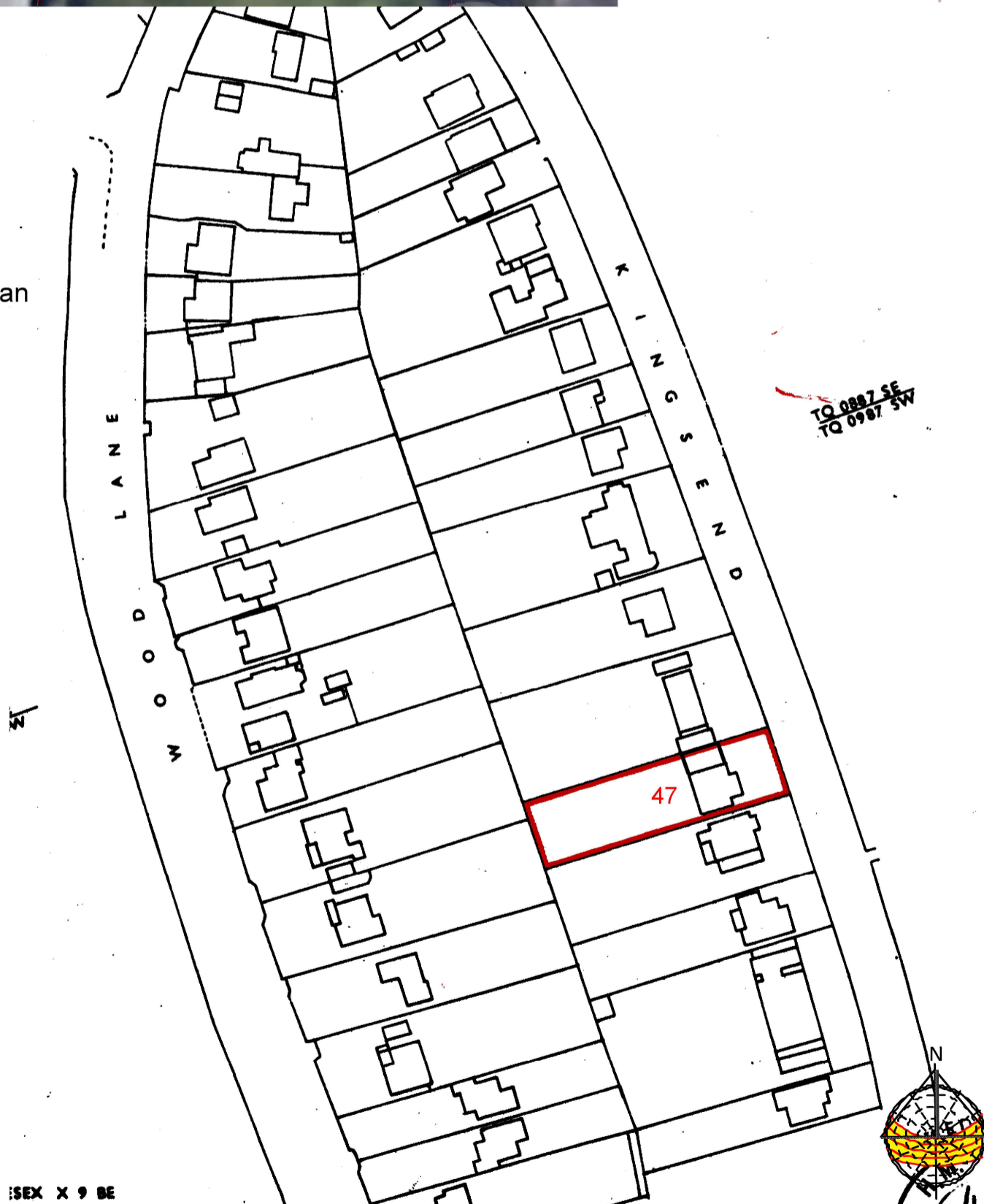

TO 0887 SE
TO 0987 SW

ISEX X 9 BE

LOCATION PLAN

Site boundary
shown in red

REV A - 15/05/25
Site plan amended to show
attached annexe

DRAWING TITLES
&

LOCATION PLAN

Purpose - Householder planning application

All dimensions to be checked on site. All omissions & discrepancies to be reported to the designer. SSK architects owns the copyright of this drawing which must not be reproduced in whole or part without the written permission.	PROJECT: 47 Kingsend, Ruislp, HA4 7DD	DATE: 30/03/2025
	DWG NO: TITLE SHEET 01	REVISION: A

scale - 1 : 1250 @ A3

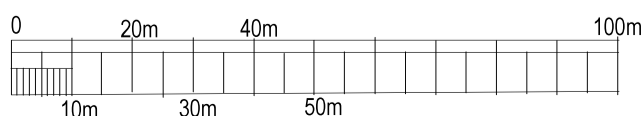

tel : 0796 222 3141

email : sandeep@sskarchitects.co.uk