

AERIAL VIEW

Site shown
in red

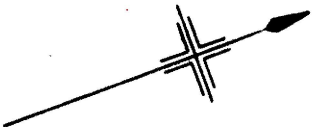

ILLINGDON



Description of proposed works

- Ground floor
- Rear extension
 - Front extension
 - Internal alterations
 - Rooflights
- First floor
- Rear extension
 - Internal alterations
 - Rooflights
- Loft floor
- Make habitable
 - Rear dormer
 - Rooflights

Drawing nos.	scale	Description
01	1:1250	Title sheet & Location Plan

Existing		
02	Aerial views
03	1:150	Site plan
04	1:100	Ground floor plan
05	1:100	First floor plan
06	1:100	Roof plan
07	1:100	Elevations Front and rear
08	1:100	Elevations Side
09	Photos - front, rear & garden views
10	Planning statement

Proposed		
11	1:150	Site plan
12	1:100	Ground floor plan
13	1:100	First floor plan
14	1:100	Loft floor plan
15	1:100	Roof plan
16	1:100	Elevations - front and rear
17	1:100	Elevations - side
18	Heritage Statement

Approx. areas		
Existing		
Site area	-	955 sq. meters.
Ground Floor	-	160 sq. meters.

Proposed		
Ground Floor	-	35 sq. meters.

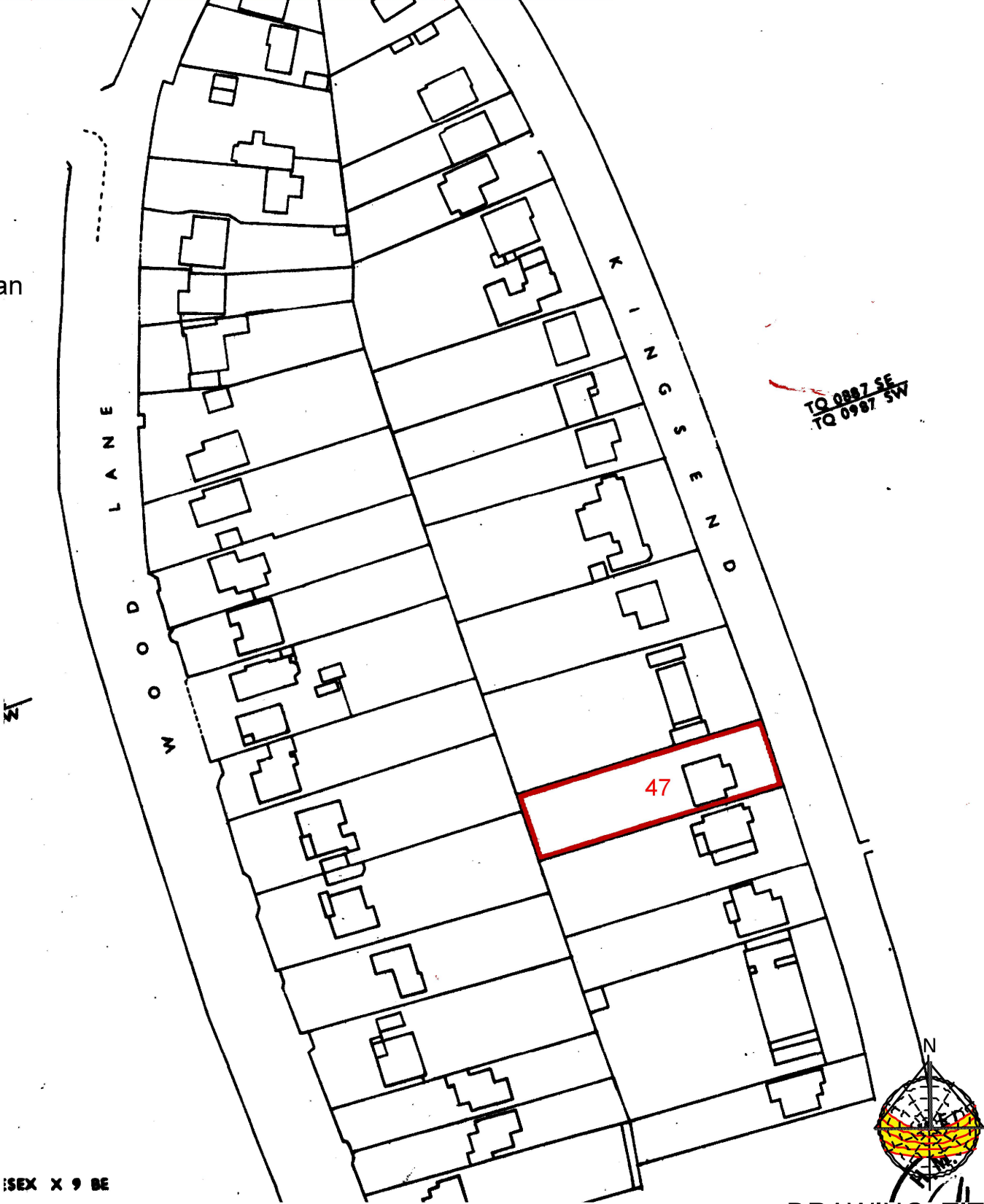

LOCATION PLAN

Site boundary
shown in red

DRAWING TITLES
&

LOCATION PLAN

Purpose - Householder planning application

All dimensions to be checked on site. All omissions & discrepancies to be reported to the designer. SSK architects owns the copyright of this drawing which must not be reproduced in whole or part without the written permission. ©	PROJECT: 47 Kingsend, Ruislp, HA4 7DD	DATE: 30/03/2025
	DWG NO: TITLE SHEET 01	REVISION:



tel : 0796 222 3141
email : sandeep@sskarchitects.co.uk

