

# HRUC - Barra Hall SEND College

## Proposed Site Layout Plan 1:200 @A1

### Notes:

1. Refurbished entrance gate and post from storage to be re-installed
2. New Security Building located on existing site - See EV-005
3. New 2.4m High Prison Mesh Fence (painted green) to boundary as shown, with new screen planting to Barra Hall Park.
4. 3no new 2.4m High Security Gates as shown.
5. Existing 1.8m High Metal Fence to be relocated as shown.
6. 1no new and 1no re-located 1.8m high pedestrian gates as shown.
7. Existing Buggy Store to be re-purposed as Bike Store.
8. New inset slabs to match existing as shown, this to support lunchtime parking for food van.
9. Existing carpark areas to be cleared of moss, with bay lines re-painted as shown.
10. New pedestrian walkway over tarmac defined.
11. New timber Bin Store at c1500D x 6400L x 2000Hmm. New hard standing and structure to support 4no 1100litre bins, each bay with its own hinged door.

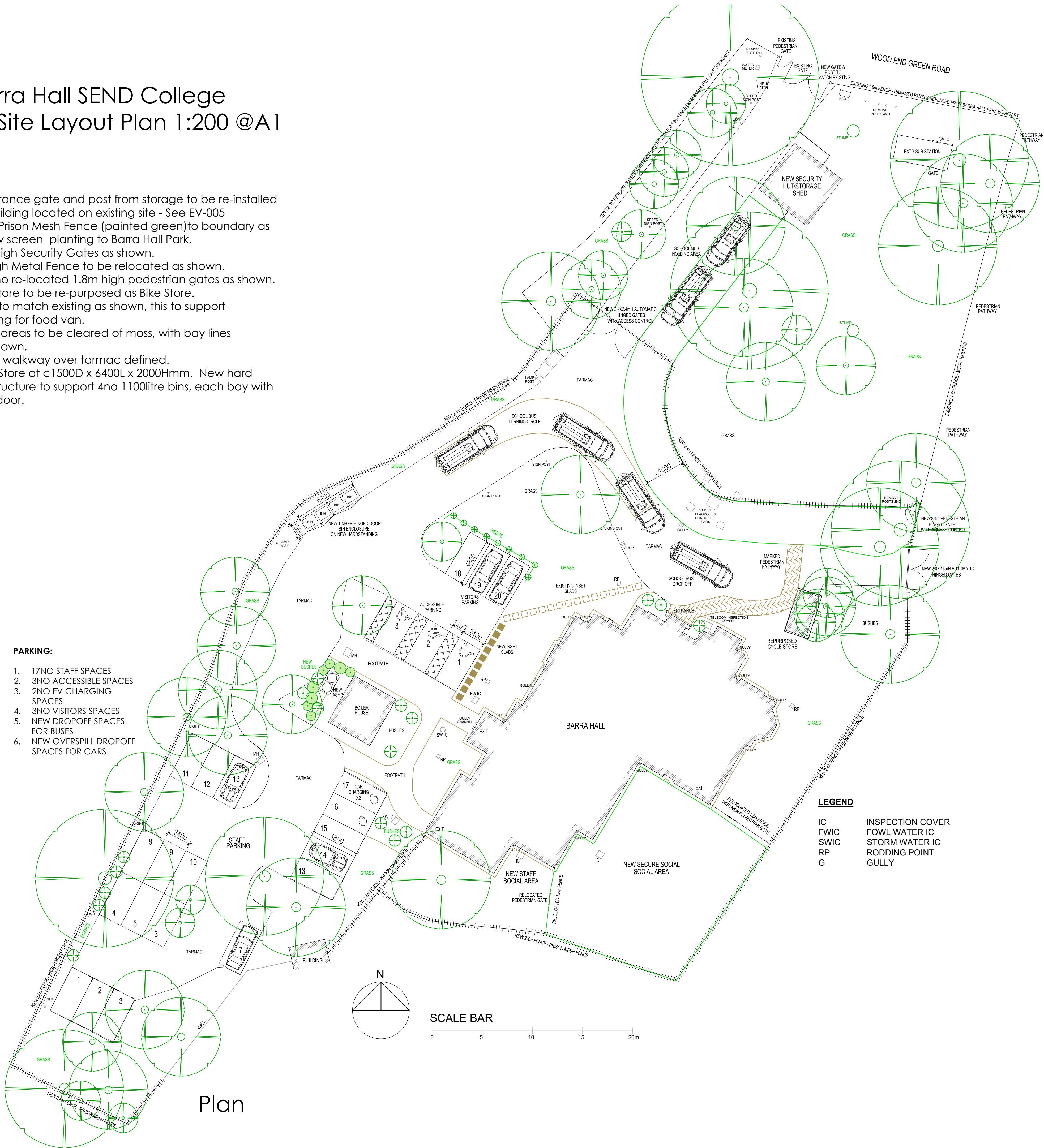

1. THIS DRAWING IS COPYRIGHT.
2. THE CONTRACTOR AND SUBCONTRACTORS ARE TO VERIFY ALL DIMENSIONS ON SITE BEFORE MAKING DRAWINGS OR COMMENCING MANUFACTURE.
3. ANY DISCREPANCIES ARE TO BE NOTIFIED TO TWC IMMEDIATELY.
4. DO NOT SCALE.

REV	DETAILS	STAGE	DATE
A	NOTATION UPDATE	BC	14-03-25
B	PARKING NOTATION UPDATE	DD	02-04-25
C	TRAFFIC/PLANNING UPDATES	DD	15-04-25
D	GRASS GRID REMOVED	DD	05-06-25

Project Number	SCALE (@ A1)	DATE
TWC 183	AS NOTED	17-Mar-25

CLIENT
HRUC BARRA HALL

PROJECT
BARRA HALL

ADDRESS
WOOD END, HAYES

DRAWING NAME
PROPOSED SITE LAYOUT PLAN

DRAWING NUMBER	REV
SP-003	AS NOTED

DRAWN BY	CHECKED BY
CLC	----

The Workspace Consultants LLP  
1 Avenue Business Park  
Brockley Road  
Elsworth, Cambridgeshire  
CB23 4EY  
Tel: +44(0)1223 656111

WORKSPACE