

HRUC - Barra Hall SEND College  
Builders Plans  
1:100@A1

SCALE BAR

0 1 2 3 4 5 6 7 8 9 10



Stained glass damage

A - Wall c1990  
B - Wall c1900

Stripout existing internal walls and sanitary-ware to allow revised toilet layout for accessibility. New walls and sanitary-ware as shown.

Remove internal walls and sanitary ware to allow revised toilet layout for accessibility.

Ground Floor

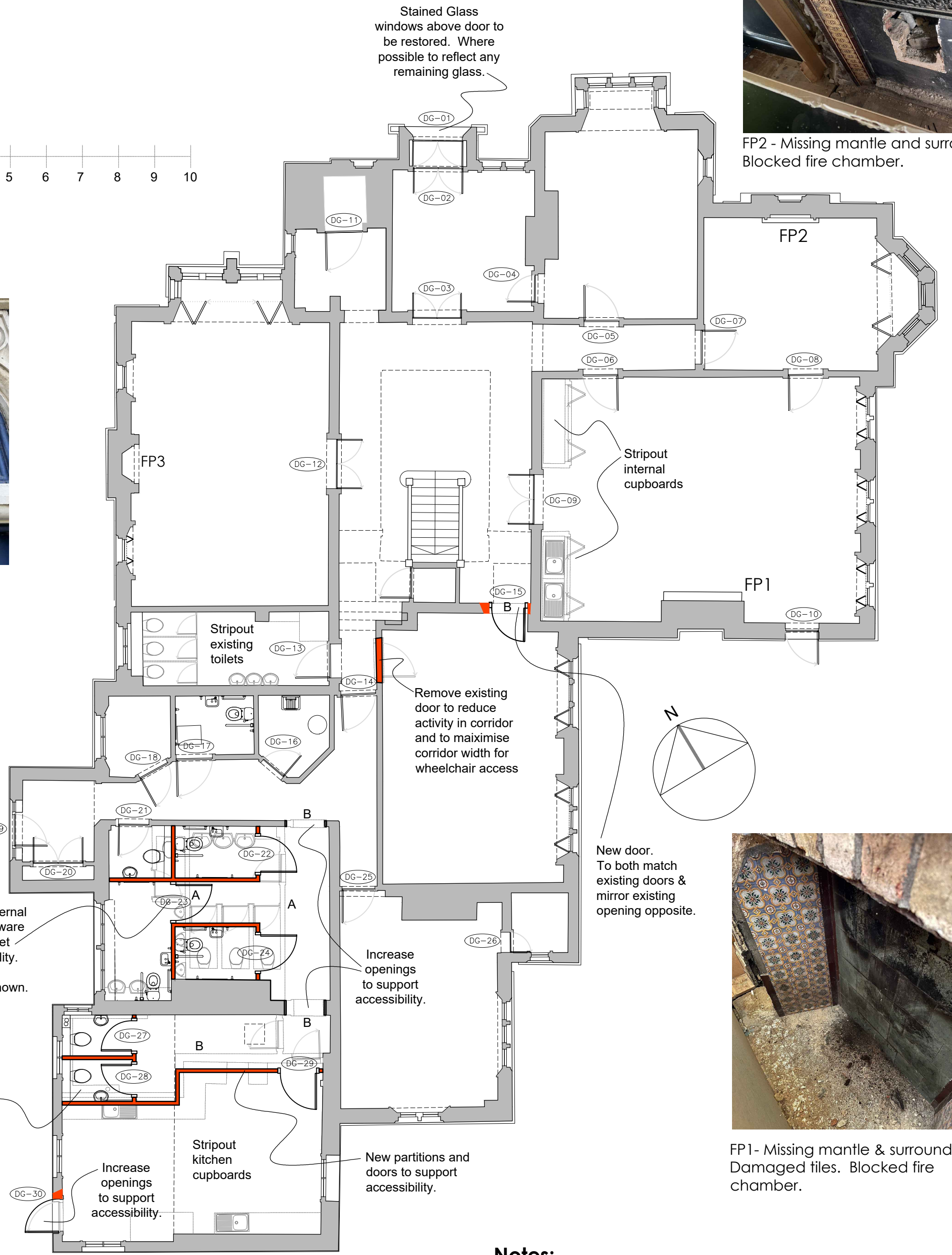

Notes:

- Stained glass over front door to be restored, detail to be approved.
- New glazed balustrade to 1st floor landing (see section on GA-002)
- Existing floorboxes to be removed and joists strengthened and leveled where necessary. (New beams added to Structural Engineers design tbc.)
- Missing and damaged fire mantles & surrounds to be sympathetically replaced, detailed design to be approved. Chimneys to be swept.
- Missing and damaged skirting boards to be replaced to match existing, detailed designs to be approved
- All new walls to match local existing skirting boards and architraves.
- All new doors to match historic 2 or 4 paneled existing doors. See Door Schedule for more detail.
- New hardwood double glazed sashes to existing frames and cills. Detail tbc.



FP2 - Missing mantle and surround. Blocked fire chamber.



FP1 - Missing mantle & surround. Damaged tiles. Blocked fire chamber.



FP9 - Missing surround.



FP8 - Damaged tiles.



FP6 - Damaged mantle



FP6 - Damaged tiles.

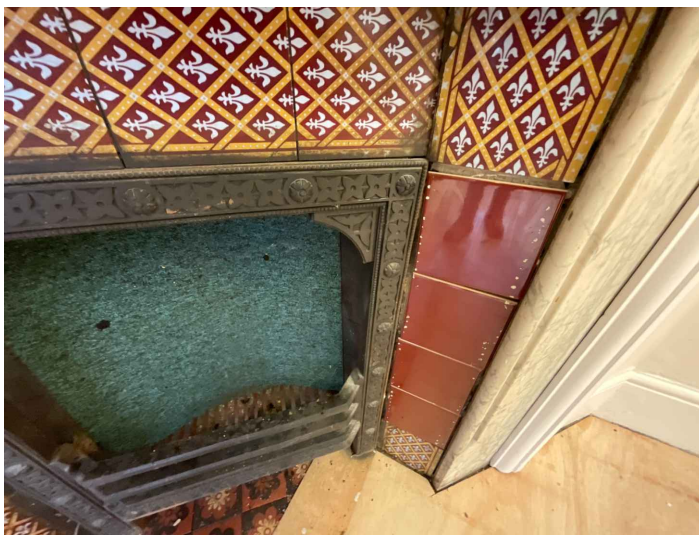

FP5 - Damaged tiles.



FP4 - Damaged tiles & fire chamber.

First Floor

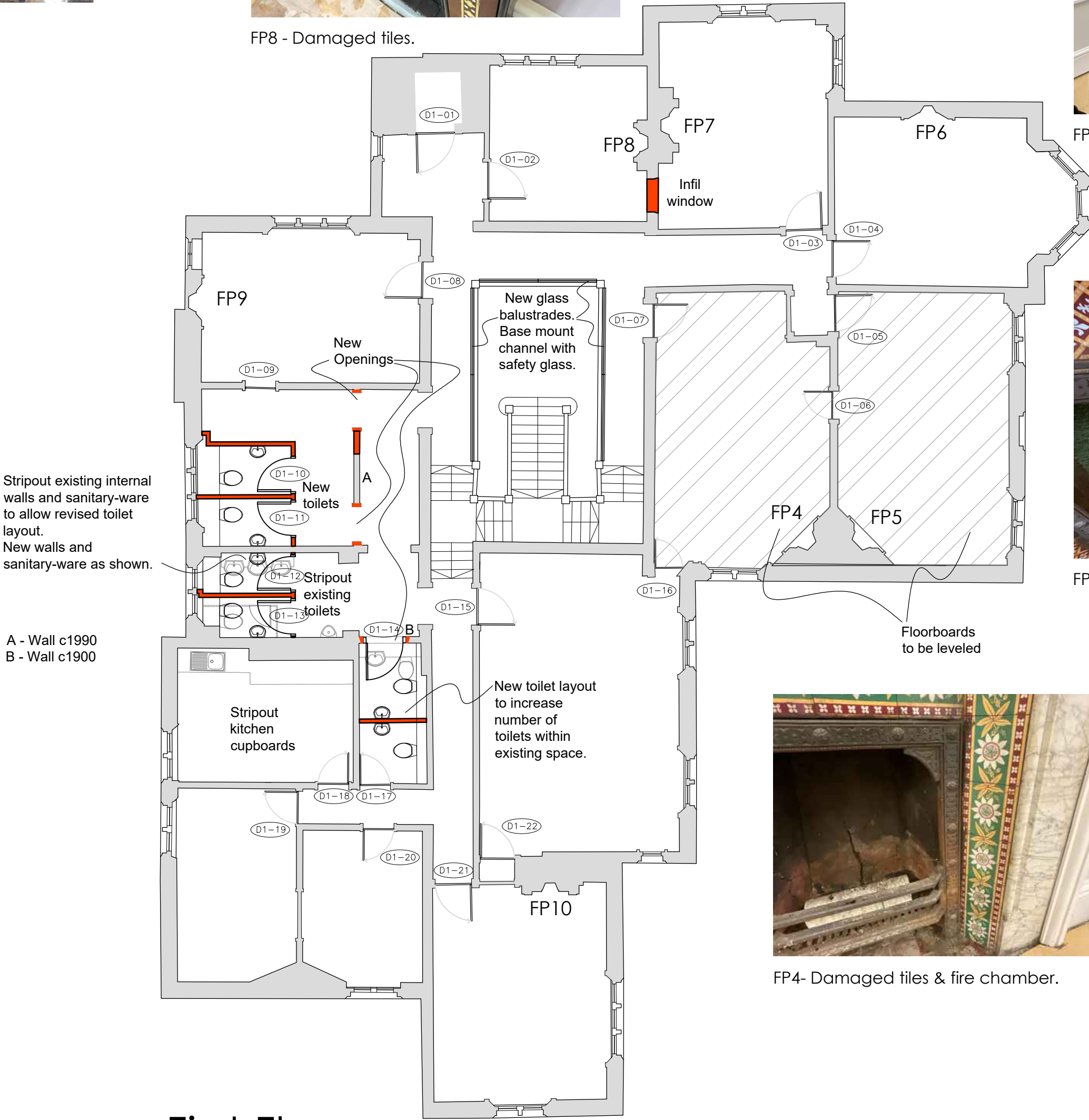

1. THIS DRAWING IS COPYRIGHT.
2. THE CONTRACTOR AND SUBCONTRACTORS ARE TO VERIFY ALL DIMENSIONS ON SITE BEFORE MAKING DRAWINGS OR COMMENCING MANUFACTURE.
3. ANY DISCREPANCIES ARE TO BE NOTIFIED TO TWC IMMEDIATELY.
4. DO NOT SCALE.

REV	DETAILS	STAGE	DATE
A	1ST FLOOR BALUSTRADE & DOOR NUMBERS ADDED	DD	13-02-25
B	DESIGN DEVELOPMENT	DD	19-02-25

Project Number TWC 183	SCALE (@ A1) AS NOTED	DATE 28-Jan-25
---------------------------	--------------------------	-------------------

CLIENT HRUC BARRA HALL
---------------------------

PROJECT BARRA HALL
-----------------------

ADDRESS WOOD END, HAYES
----------------------------

DRAWING NAME BUILDERS PLANS
--------------------------------

DRAWING NUMBER BP - 001	REV AS NOTED
----------------------------	-----------------

DRAWN BY CLC	CHECKED BY ----
-----------------	--------------------

The Workspace Consultants LLP  
1 Avenue Business Park  
Brockley Road  
Elsworth, Cambridgeshire  
CB23 4EY  
Tel: +44(0)1223 656111

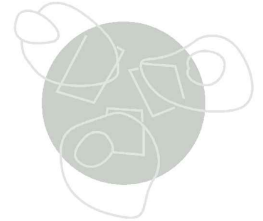

WORKSPACE