



Marshall's Drivesett graphite argente priora permeable block paving



Marshall's Paving Flags; Vela Granite 300 x 100 size



Contemporary Block Paving Setts, 105x140mm, Borders, Edgings, Graphite Colour

Vehicle Crossover Construction

For proposed single or double vehicle crossovers to properties, the construction shall be similar to the flexible footway construction as specified on the previous page except for the lower base course thickness, which is increased to 175mm.

a) The new access shall tie in with the existing footway and carriageway surfacing materials and levels. Prior to excavation, all edges shall be cleanly saw-cut to prevent damage to surrounding surfaces. Vertical faces to be painted with bitumen when reinstated.

b) For redundant crossovers, existing dropped kerbs shall be raised in line with the carriageway kerbs. New granite Kerbs shall be used where the existing kerbs cannot be reused. Precast concrete kerbs may only be used where the kerbs on the existing public highway are precast concrete.

c) Kerbs as specified shall be laid to conform to the existing alignment of the footway and the kerbs shall be sunk to project 25mm above carriageway channel level for the full width of the crossing. The kerbs shall be bedded on ST4 concrete of 150mm thick and backed up with 150mm of concrete to a height of 100mm, or 175mm, from the base of the kerb whichever dimension applies and haunched on the front face. Tapered transition kerbs shall be used to form a ramp on each side of the crossing.

d) Precast concrete edging 50mm x 150mm shall be provided as directed to retain the footway and shall be bedded on ST4 concrete 75mm thick and backed up with 75mm of concrete and haunched on the front face.

e) All inspection chamber covers, electricity, gas, telephone, cable, water boxes or any other covers in the footway shall be properly adjusted in level as required and bedded so as to conform to the new surface levels and gradients.

f) Where a surface water drain or roadside ditch exists within the area to be covered by the access the person undertaking the works shall be required to carry out such additional strengthening and piping works as may be deemed necessary by the Engineer's representative.

g) With reference to the new access road, if refuse vehicles and emergency vehicles are expected to enter the site then the access road must be constructed to the adoptable standards as specified previously. If the estate road is not required to facilitate such access or be so constructed then bin stores shall be provided within 10 metres from the nearest public highway.

h) The extent of public highway shall be delineated with double rows of granite setts or a single row of 150mm x 150mm granite kerbs with the outside / leading face to be the private boundary line.

i) All existing gullies fronting the development shall be cleaned, emptied and connections jet cleaned as part of the works at the end of the development to the satisfaction of the Engineer's representative.

THE RETAIL UNITS WILL BENEFIT FROM EXISTING PARKING PROVISIONS AND ACCESS ALONG BYRON PARADE

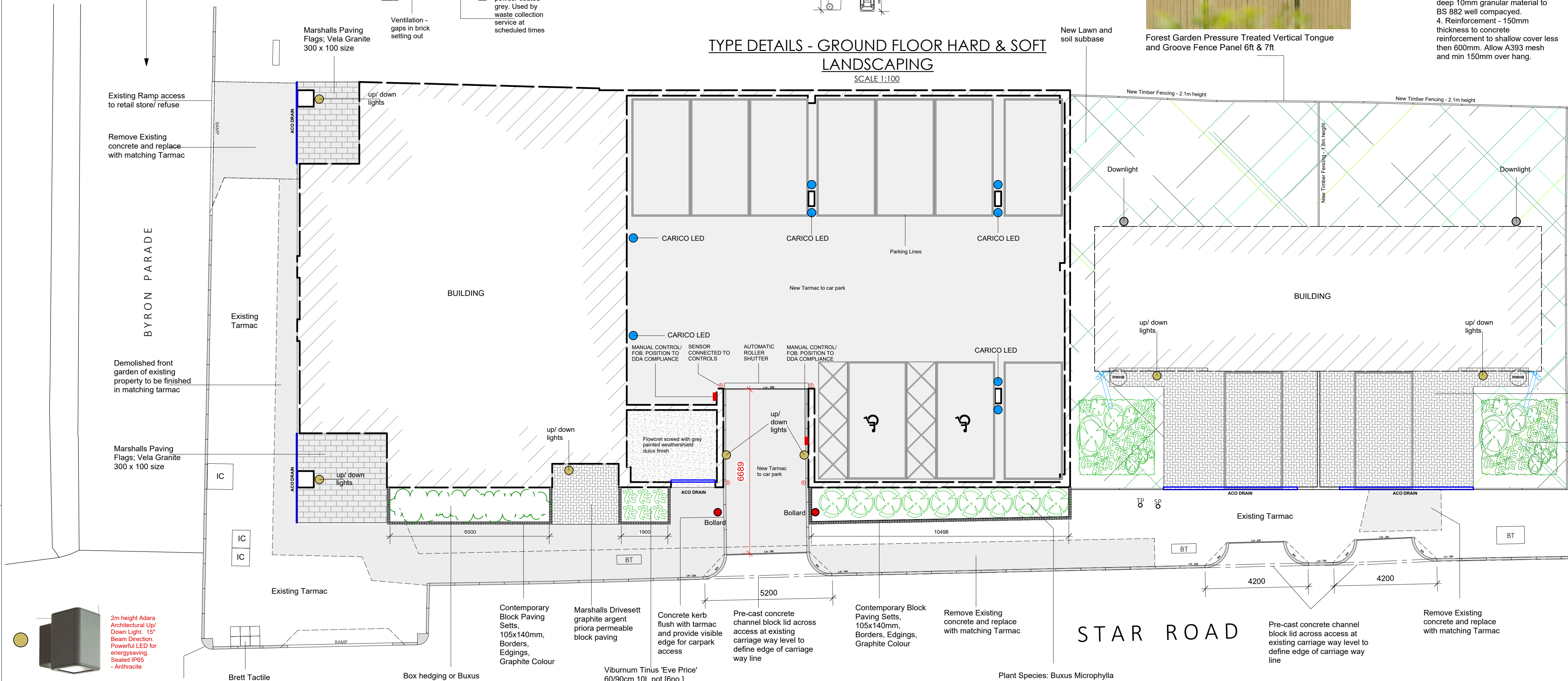

SPLAY LINES

SCALE 1:200

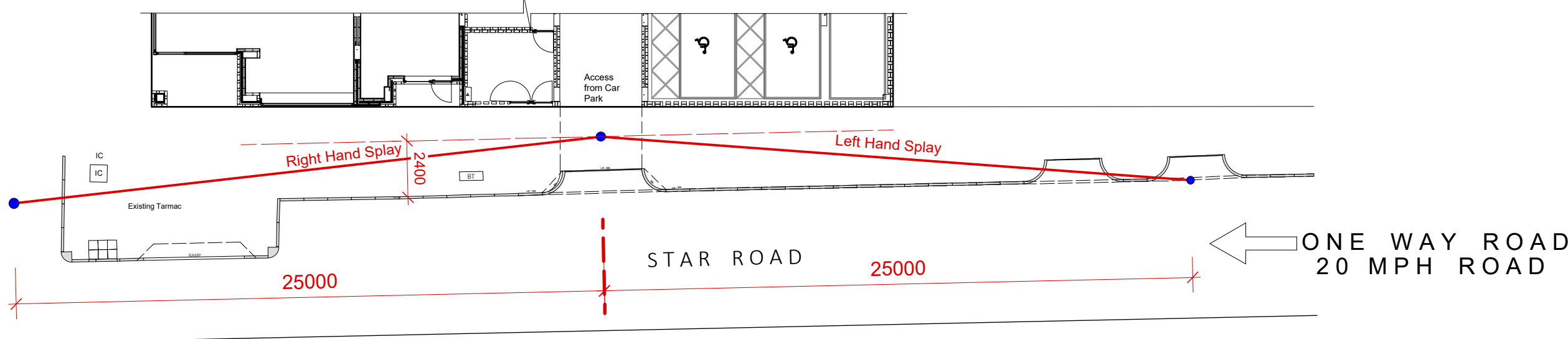

TYPE DETAILS - GROUND FLOOR HARD & SOFT LANDSCAPING

SCALE 1:100

TYPE S - CONCRETE SLAB FOUL WATER PIPE

SCALE 1:10

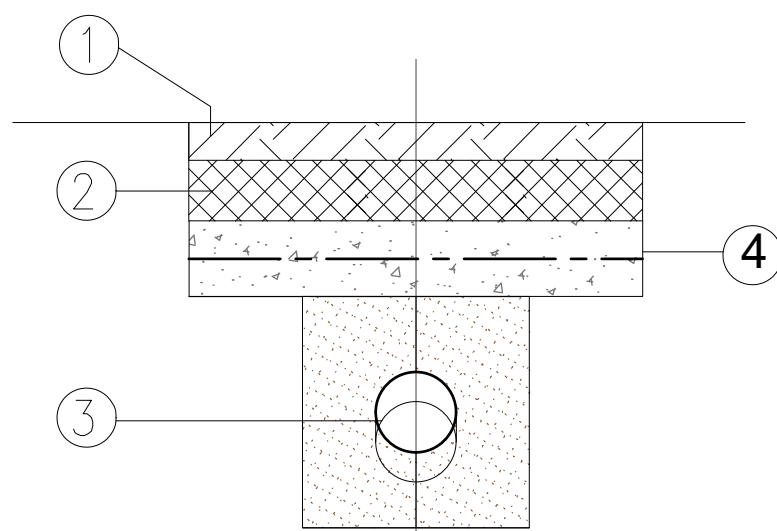

Type S or S1 with Concrete Slab

Presents an existing situation and upgrade along foot path - used where sewer do not achieve required cover depth of 600mm

TYPICAL KURB DETAILS

SCALE 1:10

FLAT TOP EDGE TYPE EF (150MM X 50MM PCC KERB)

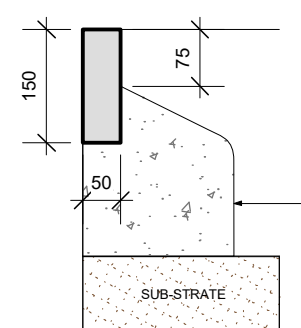

FLAT TOP EDGE TYPE EF (DOUBLE ROW - 150MM X 100MM GRANITE SETT)

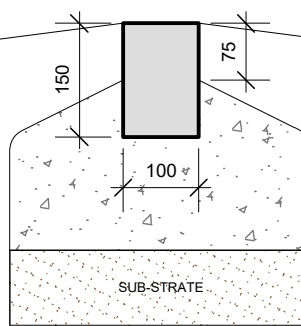

HALF BATTER KERB HB (275MM X 125MM PCC KERB)

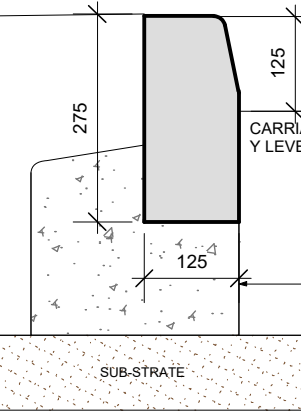

HALF BATTER KERB HB (150MM X 125MM PCC KERB)

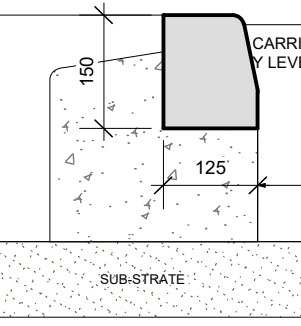

SECTION FOOTPATH

SCALE 1:10

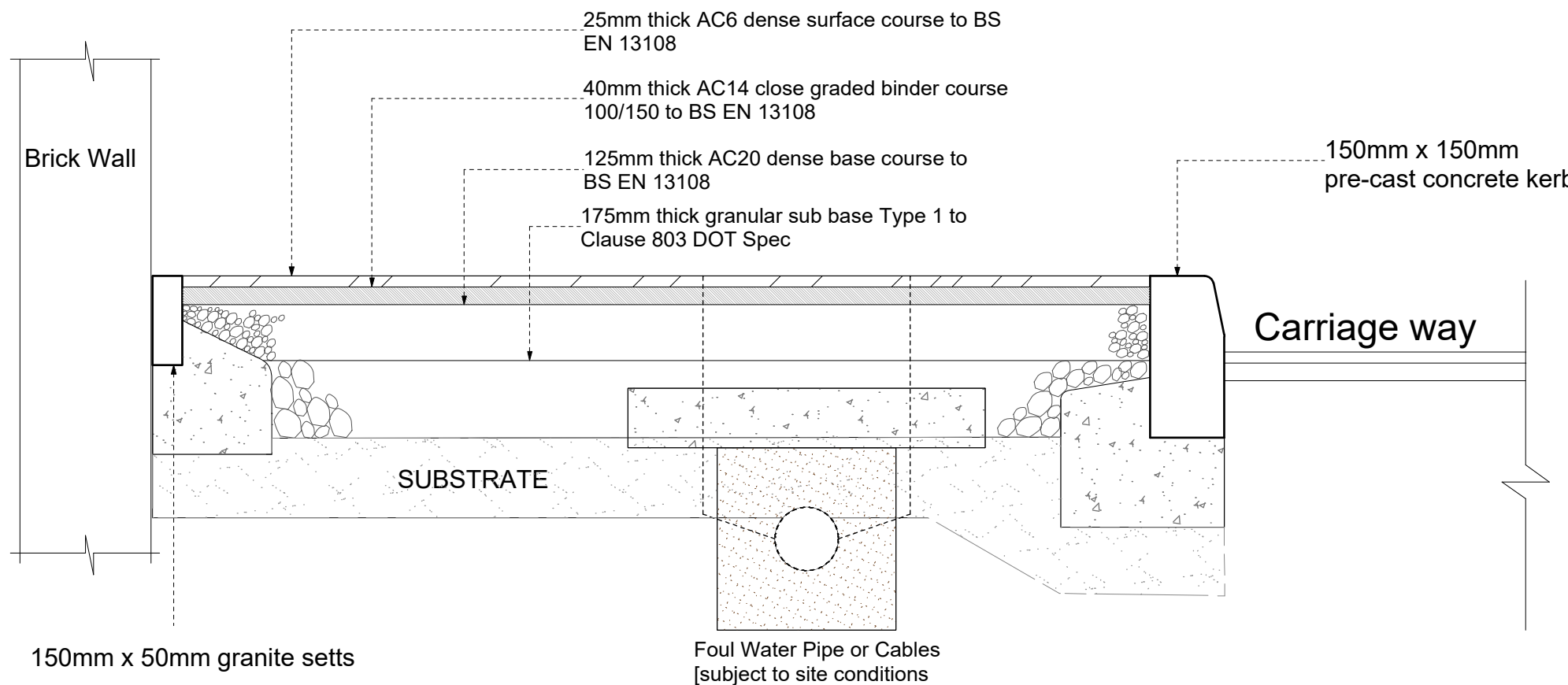

PLANNING CONDITIONS

All dimensions to be verified on site by contractors. Any discrepancies to be verified with the designer. No scaled dimensions to be used only figured dimensions. Copyright of HSD Contractors to work to CDM 2015 if applicable.

HSD ARB RIBA

Project: STAR PUB DEVELOPMENT

Title: Condition 10 & 12 - traffic Arrangements and Hard/ soft landscape

SCALE	DRAWN:	REVISION	DATE
1:10/ 100/ 200	H S SURI		
@ A1	PG NO: DWG 01		