

PROPOSED GROUND FLOOR

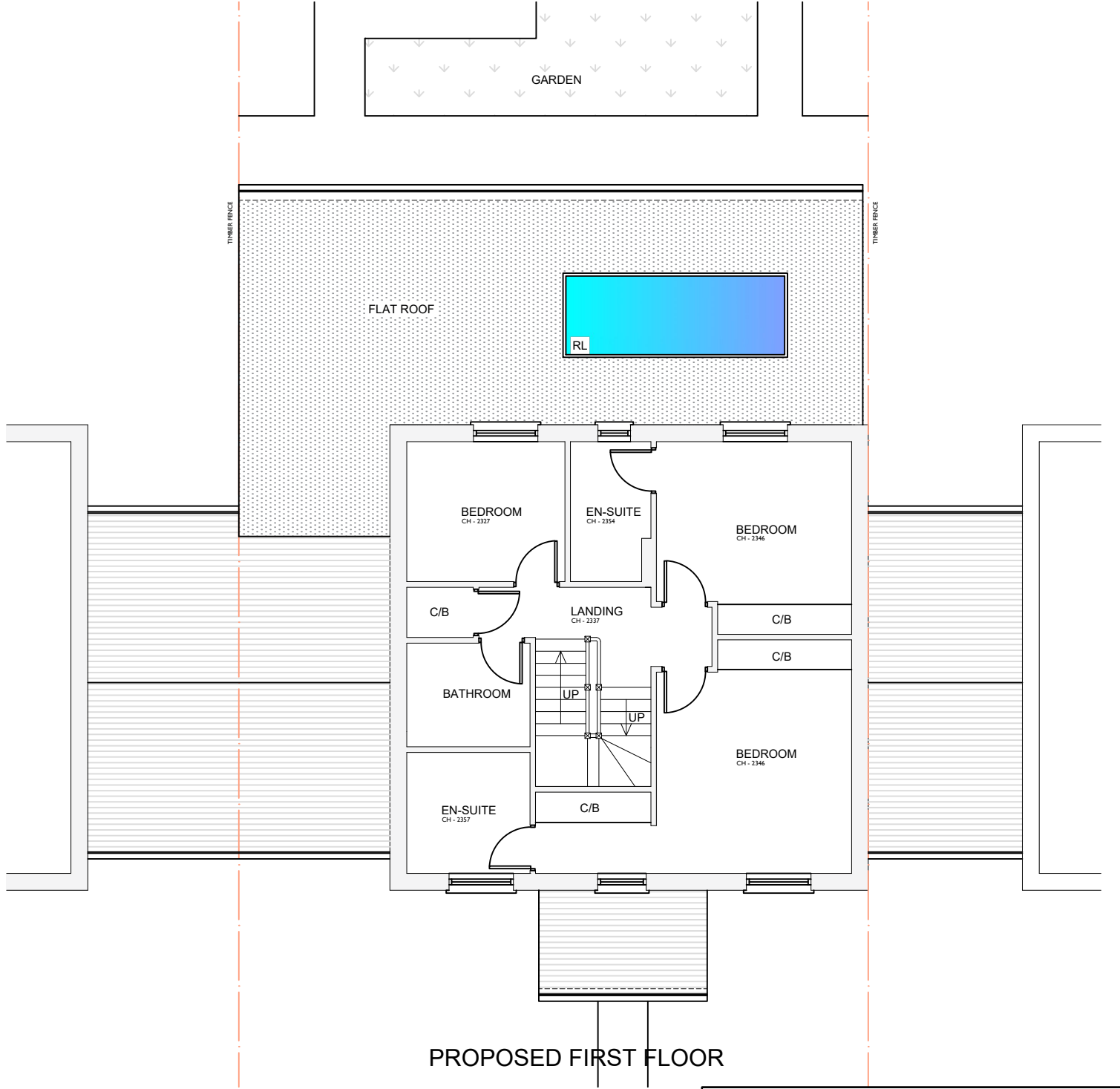

PROPOSED FIRST FLOOR

Client	MR AMBARISH AMIN	
	LONDON INTERIORS UNIT 8 BOWMAN TRADING ESTATE WESTMORELAND ROAD LONDON NW9 9RL	
Project	126 WRAYSBURY DRIVE YIEWSLEY UB7 7FR	
Drawing Title	PROPOSED GROUND & FIRST FLOORPLANS	
Drawing No	PR24-098d	Rev.
Drawn By:	Scale:	Date:
AS	1/100	05/12/2025

