

Existing Elevations

0 1 2 3 4 5 10  
1:100 @ A1 1:200 @ A3

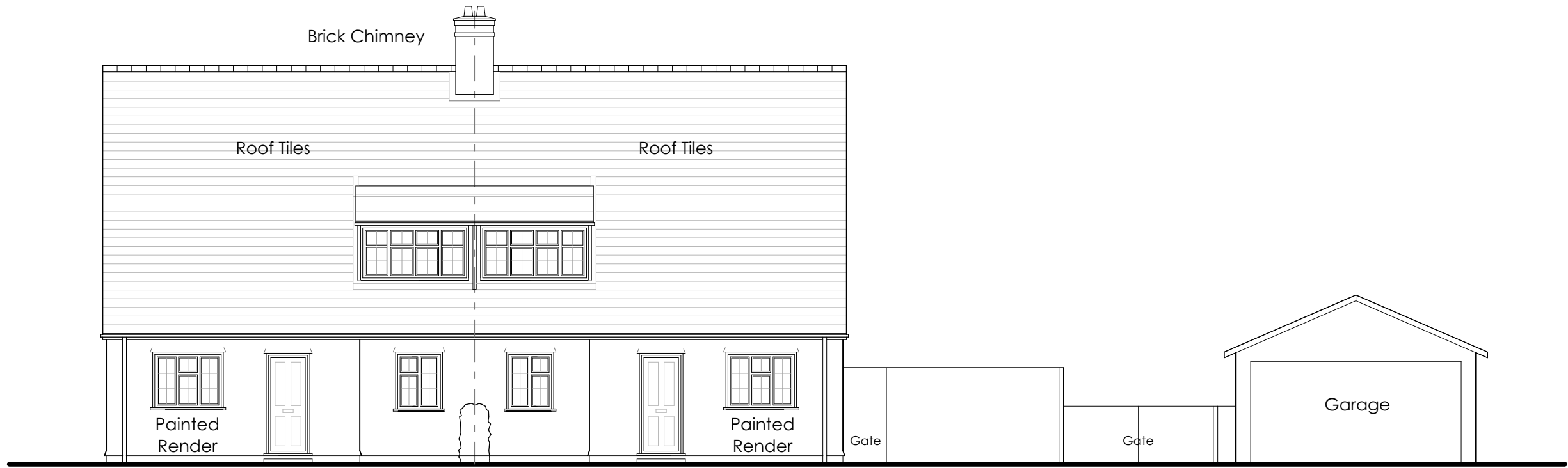

Front Elevation - South  
Facing Green Walk

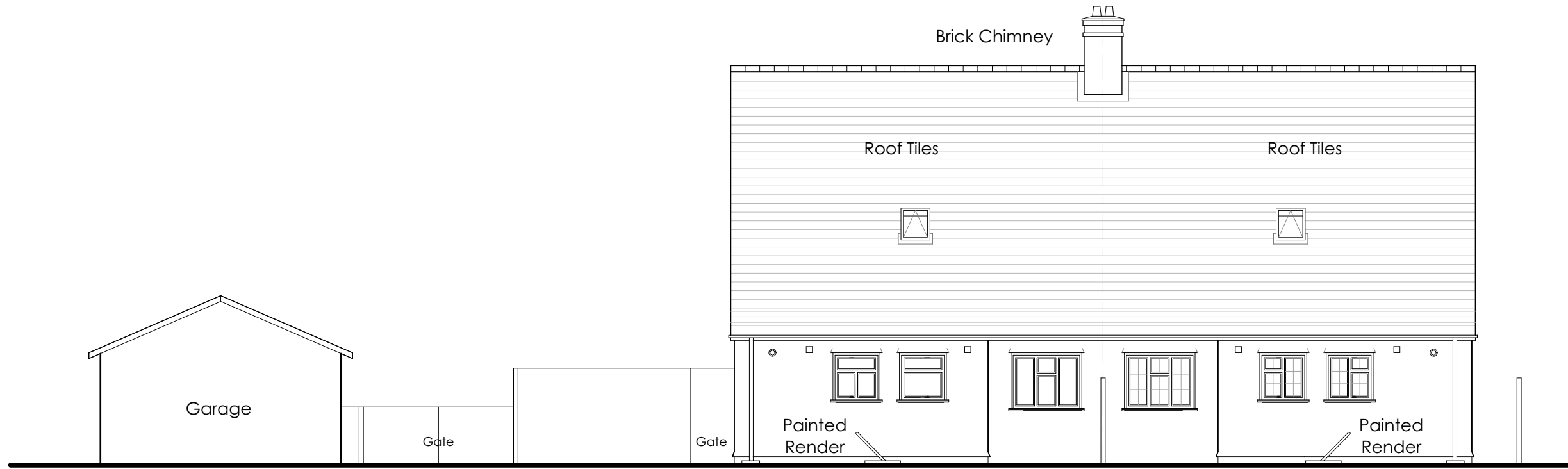

Rear Elevation - North

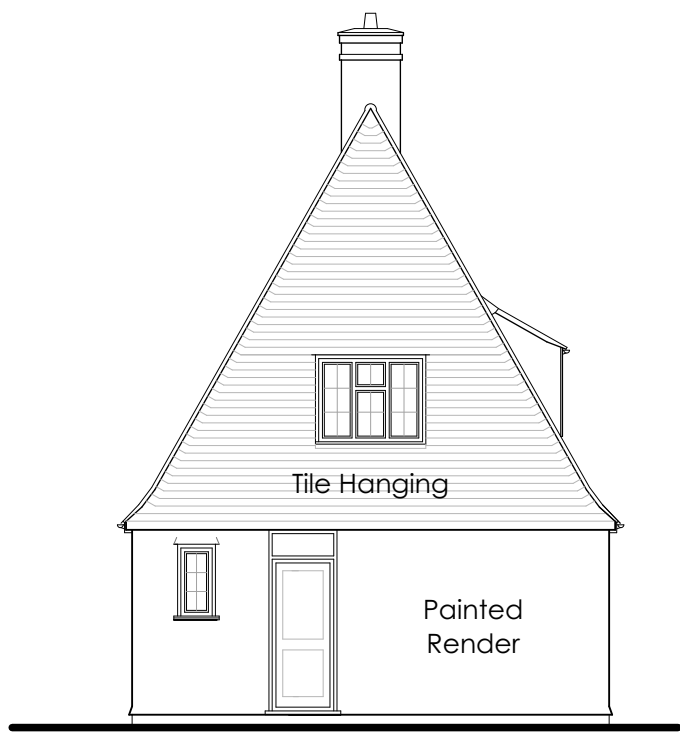

Side Elevation - West

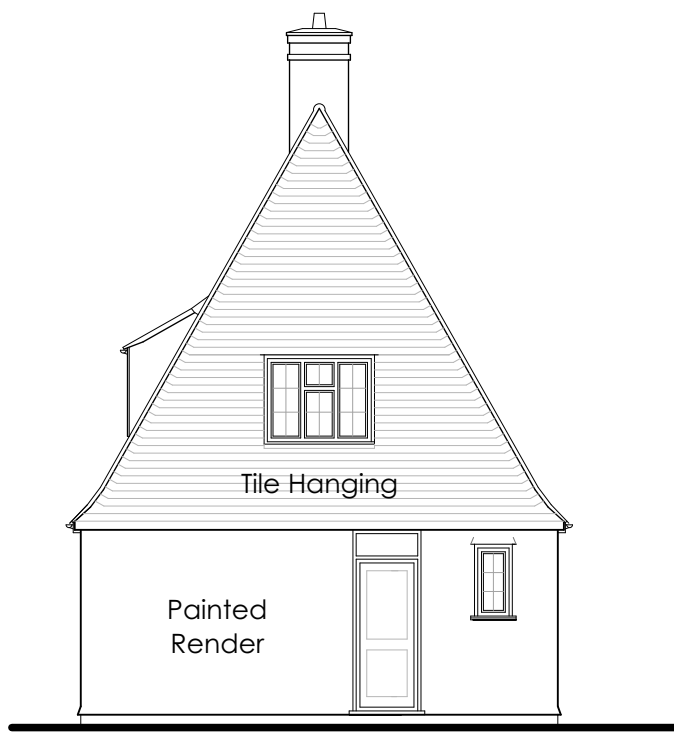

Side Elevation - East

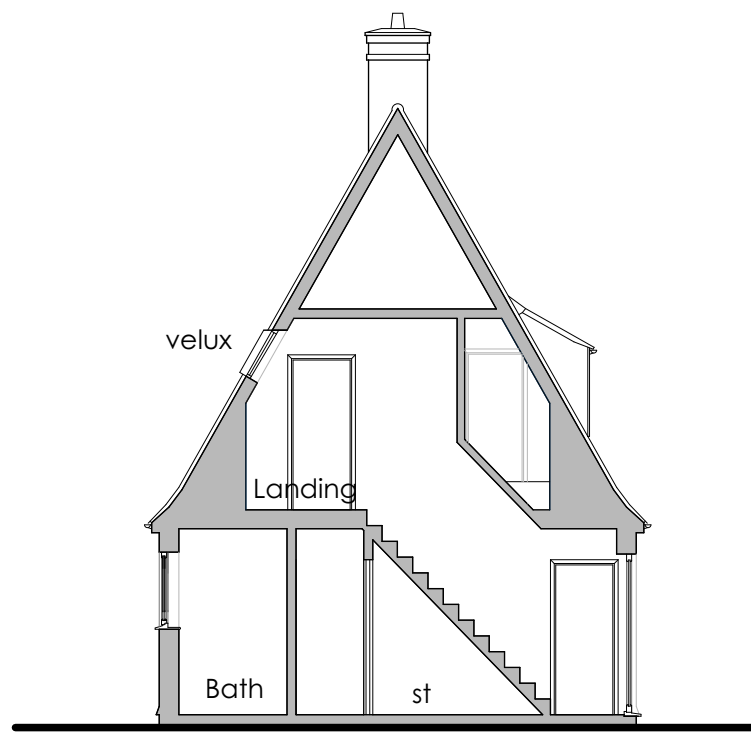

Section A-A

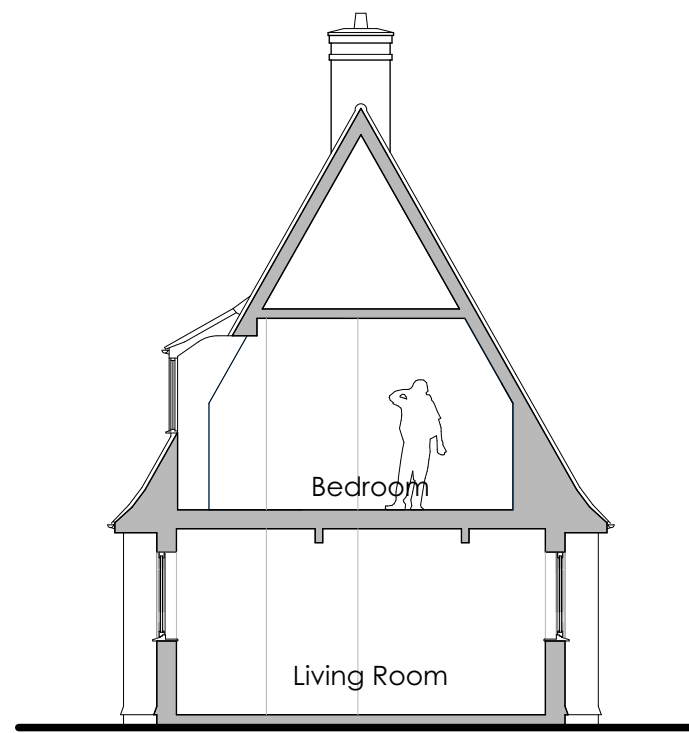

Section B-B

Do not scale drawing - Plans have been prepared from hand measured survey and accuracy cannot be guaranteed

This is not a survey drawing. The accuracy of this drawing may be reliant upon topographical information provided by a third party. Do not scale this drawing unless for planning purposes only. Used figured dimensions. Any discrepancies to be reported. Drawing to be read in conjunction with other relevant architectural drawings / consultants details, reports and specifications.

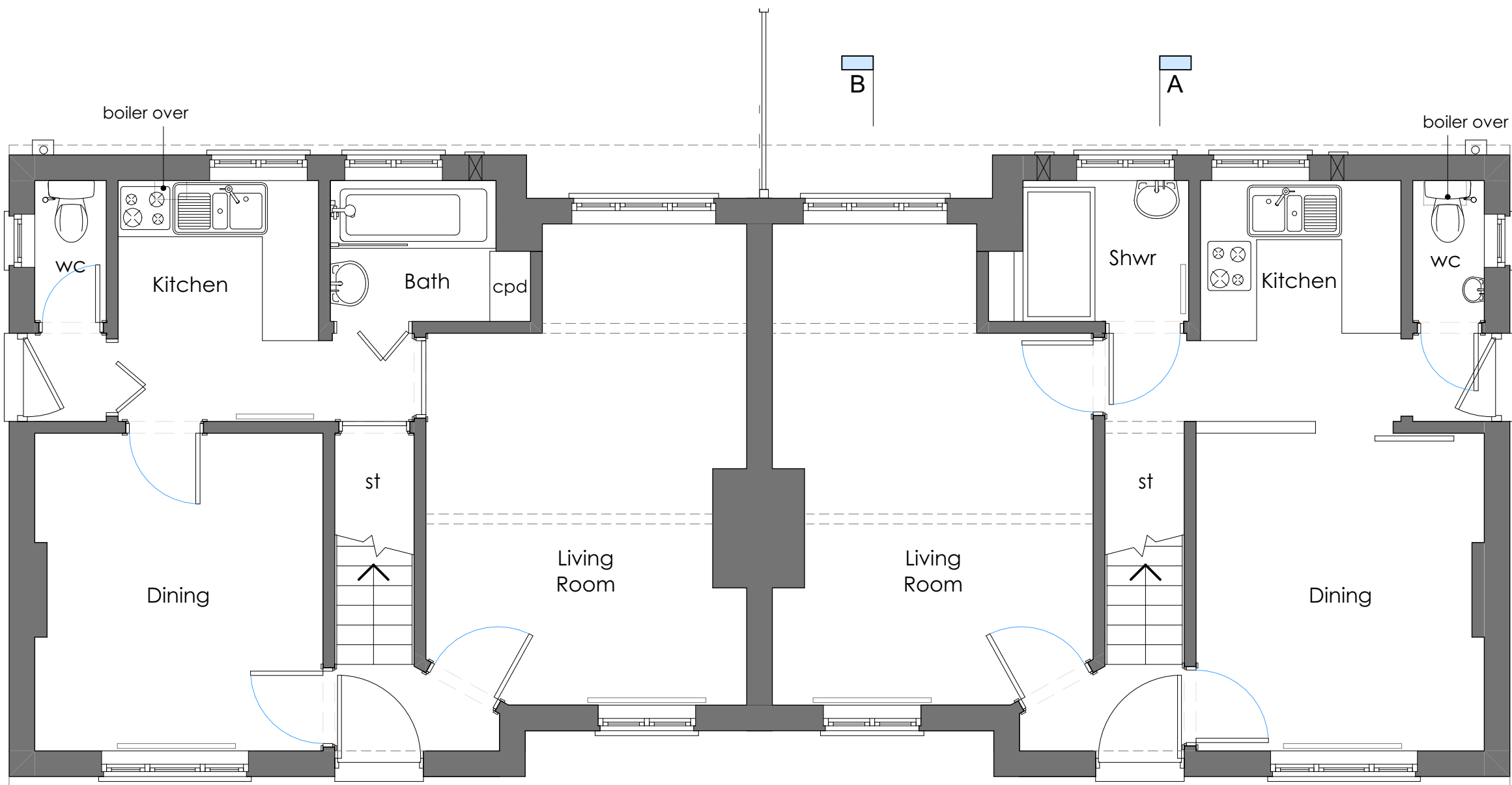

No 24

No 23

Ground Floor Plan

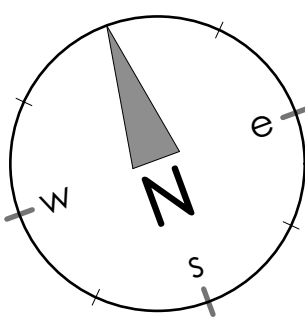

Existing Floor Plans 1:50 @ A1

1:50 @ A1 1:100 @ A3

1 2 3 4 5

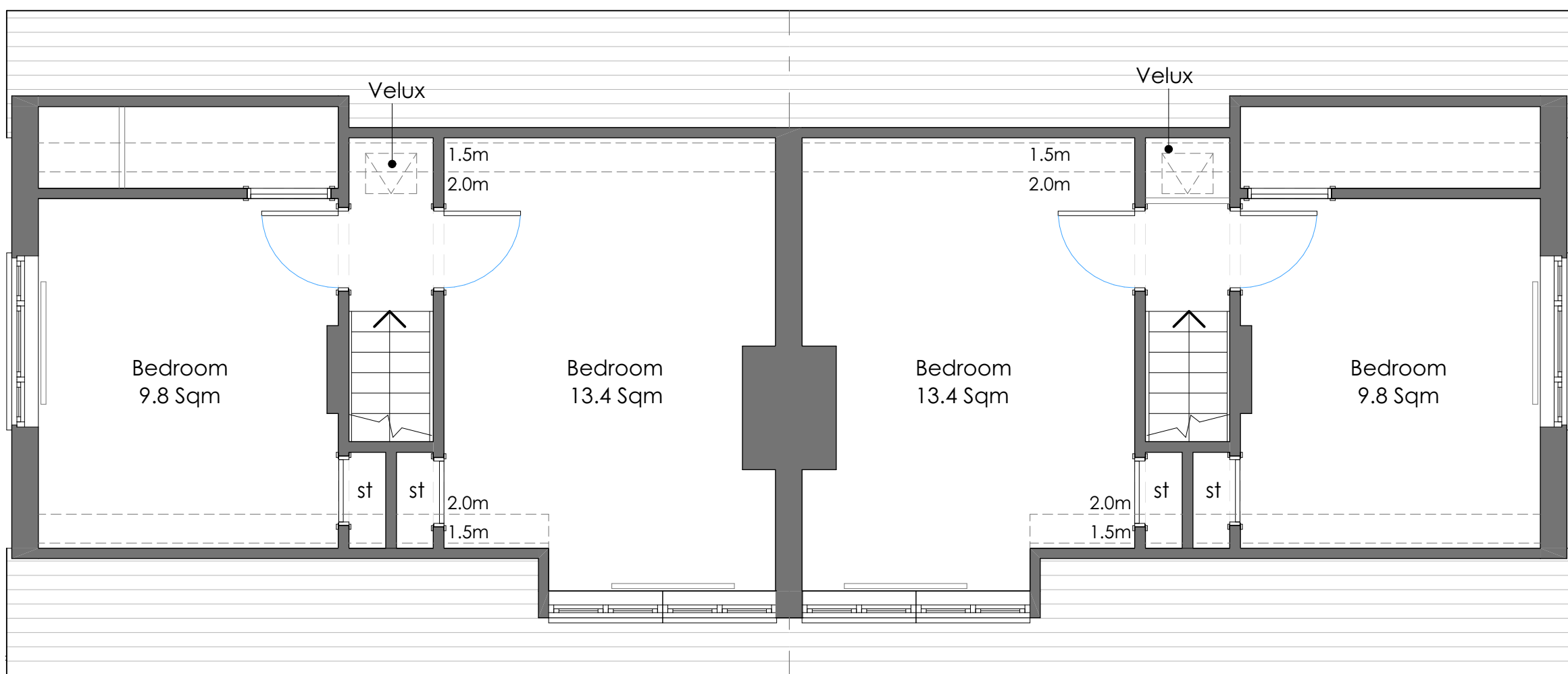

No 24

No 23

First Floor Plan

Rev	Date	Notes

This drawing is the copyright work of **Key Land Estates Architecture Ltd.** Unless formally assigned in writing



52 Brook Street  
Tring - Hertfordshire - HP23 5EF  
T: +44(0)7968 031139  
pburman@keylandestates.co.uk  
[www.keylandestates.co.uk](http://www.keylandestates.co.uk)

Project  
**23 Green Walk  
Ruislip HA4 8NL**  
for  
Ruislip Manor Cottage Society

Drawing Title  
**Existing Floor Plans &  
Elevations**

Job No KA2413	Dwg No <b>KA2413-202</b>	Rev
Drawn PKB	Scale 1:100 @ A1 - 1:200 @ A3 1:50 @ A1 - 1:100 @ A3	
Date 08/12/2025	Status <b>PLANNING</b>	