

EAST AVENUE

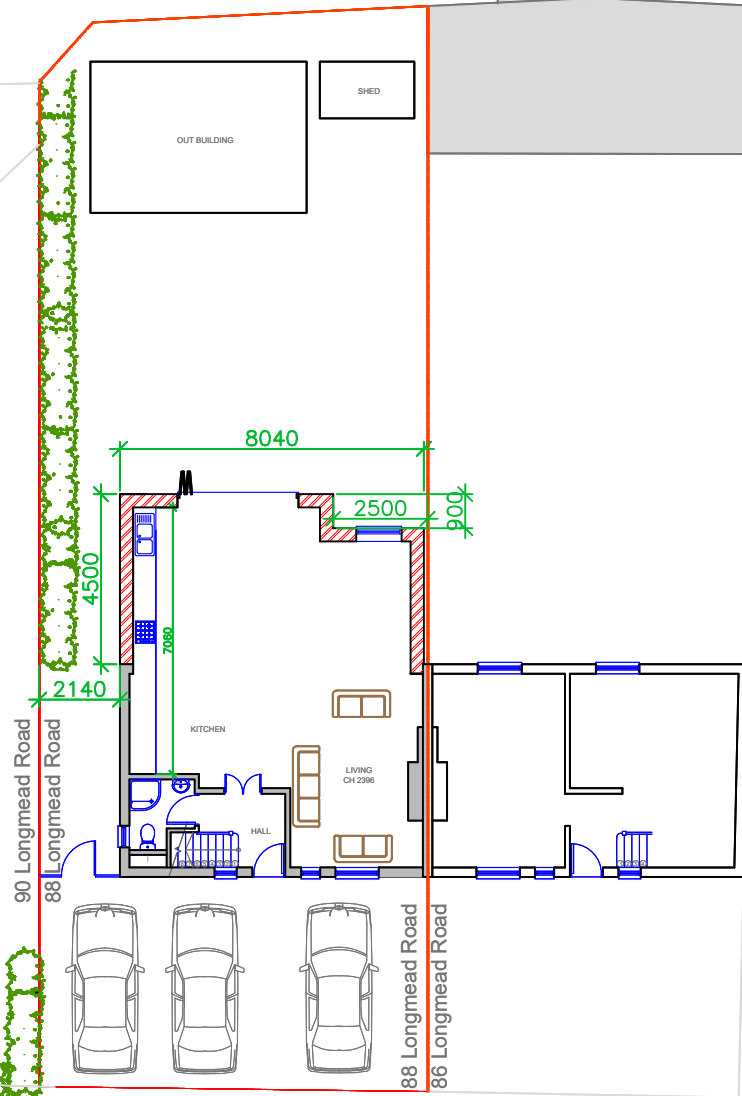
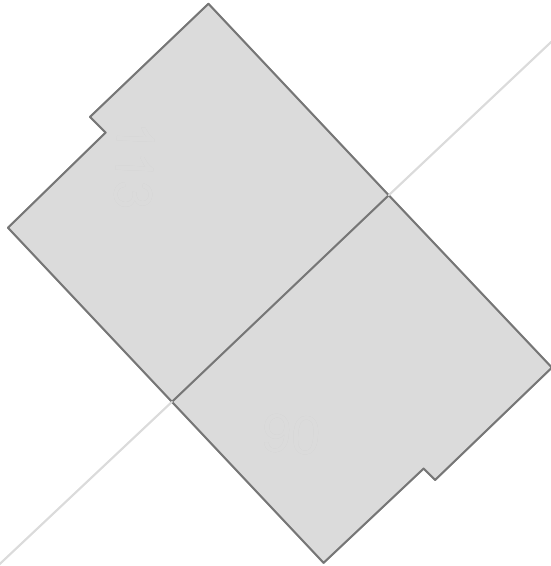

Notes:
All dimensions are in mm unless stated otherwise

Area Calculation
Plot area excluding the original house: 245 m²

Plot area excluding the proposed house with extension and existing outbuilding and shed: 184 m²

Therefore area of the plot remaining after extension: $\frac{184}{245}$ = 75% which is more than 50%, of the original plot.

Therefore the design proposal is believed to meet the planning policies.

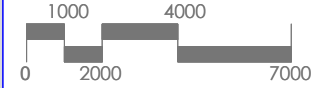

Prepared by:
A+L Architecture Studio, Hitchin

Address:
88 Longmead Road, Hayes, UB3 2HG

Drawing name:
Block Plan: As Proposed

Scale:
1:200 @ A4

Date drawn:
Mar 2026

Drawing number:
88LR-FP200
Rev 01

BLOCK PLAN
AS PROPOSED

LONGMEAD ROAD