

Opening Tree Constraint & Protection Plans

When drawing is opened in AutoCAD the Proxy Information dialog should appear as below:

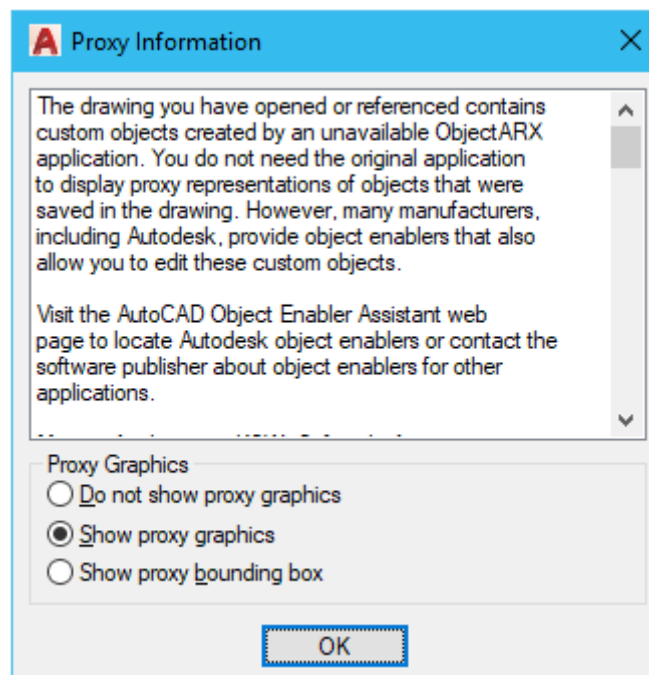

Select the option “Show proxy graphics” and select [OK] to open the drawing. This will ensure the graphics used to represent the trees appear.

What to do if the Proxy Information dialog does not appear AND the KeyTREE graphics do not show?

In the AutoCAD settings the control options have been set to not display the Proxy Information dialog or, more importantly, to not show the proxy graphics. In this instance:

- With the drawing closed, at the command line enter PROXYSHOW and press Return. The current value of the AutoCAD system variable is displayed and is most likely to be set to 0, i.e. to not show proxy objects
- At the prompt: Enter new value for PROXYSHOW, enter 1 (to show proxy objects) and press Return
- The AutoCAD PROXYSHOW system variable is a global setting (i.e. affects all drawings) that controls the display of proxy objects in an AutoCAD drawing where the application that created the objects is not available. The following options exist:
 - 0 Proxy objects are not displayed
 - 1 Graphic images are displayed for all proxy objects
 - 2 Only the bounding box is displayed for all proxy objects

KeyTREE drawing opened in AutoCAD will show all the graphics as image entities only, i.e. not editable as AutoCAD objects. This is because they are fixed and do not need to be changed.