

Contact:
Email: rabinkhadda@hotmail.co.uk,
Cell: 044 + 078 3293 8374
Web site: www.bluearchdesign.co.uk

Notes:
© 2025 Blue Architecture Limited.
All rights reserved.
All drawings are for the purpose of gaining
Planning Permission approval only.
All written dimensions to be taken in
preferences to scaled dimensions.

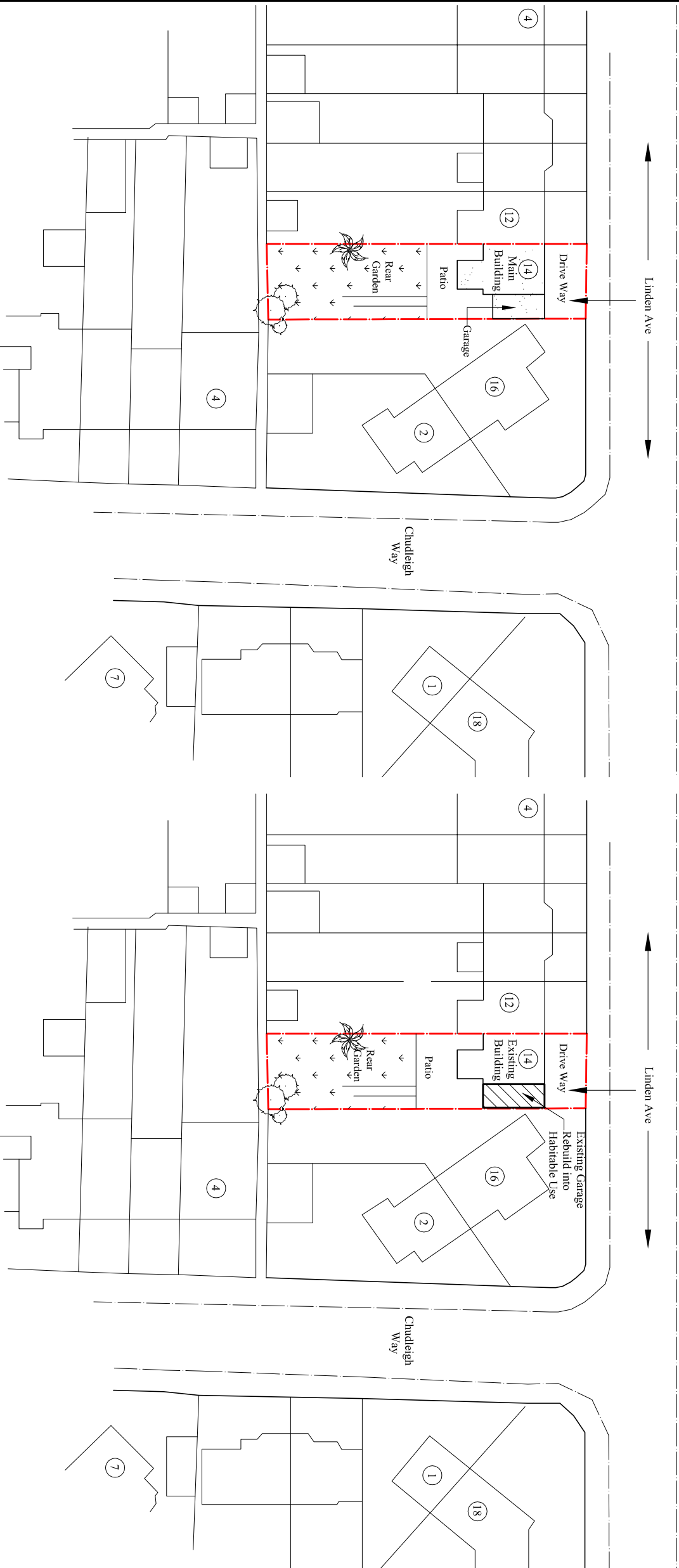
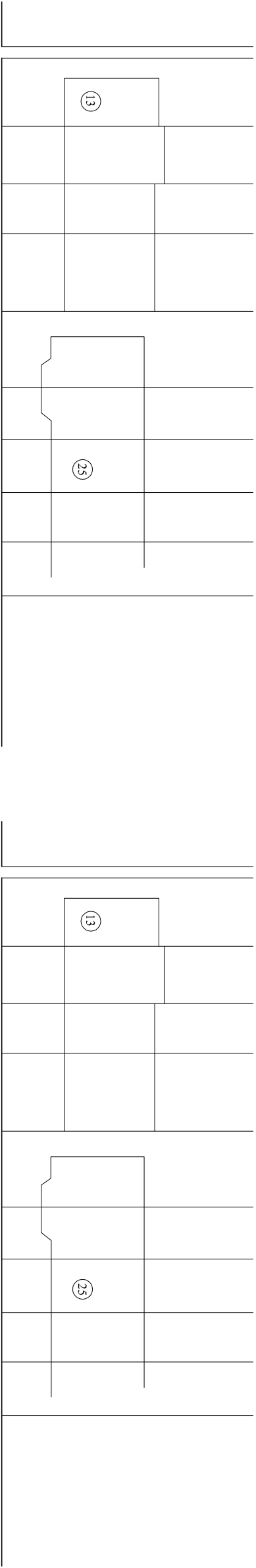

Rev.	Description	By	Ckd	Date

Client:
Mrs. Mankumari Rai

Project:
Existing side Garage Rebuild into Habitable use with Roof alteration and extending at back inline with the depth of existing building.

Location:
14 Linden Ave, Ruislip,
Middlesex, HA4 8TW.

Status:
PLANNING

Title:
Existing and Proposed Block plans

Drawn by:	Str. Fr.	Checked by:
L.p	---	R.k
Project no:	Sheet Size	Sheet no.
BAL-14LA	A3	
Date:	Scale:	
22/09/2025	1:500	