

Volume calculation:

$$V1 = 3.837 \times 2.822 \times 5.467 \times 0.5 = 29.60 \text{ m}^3$$

$$V2 = 0.096 \times 3.837 \times 5.467 \times 0.5 = 1.01 \text{ m}^3$$

Total volume..... = 30.61 m³

New roof rear extension is within allowed 40.0 cu.m.

Application for a Lawful Development Certificate
for a Proposed use or development
Town and Country Planning Act 1990 (as amended)
and The Town and Country Planning
(Development Management Procedure)
(England) Order 2015 (as amended).

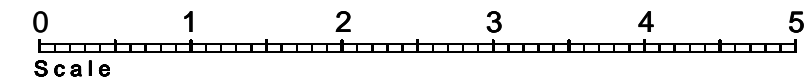
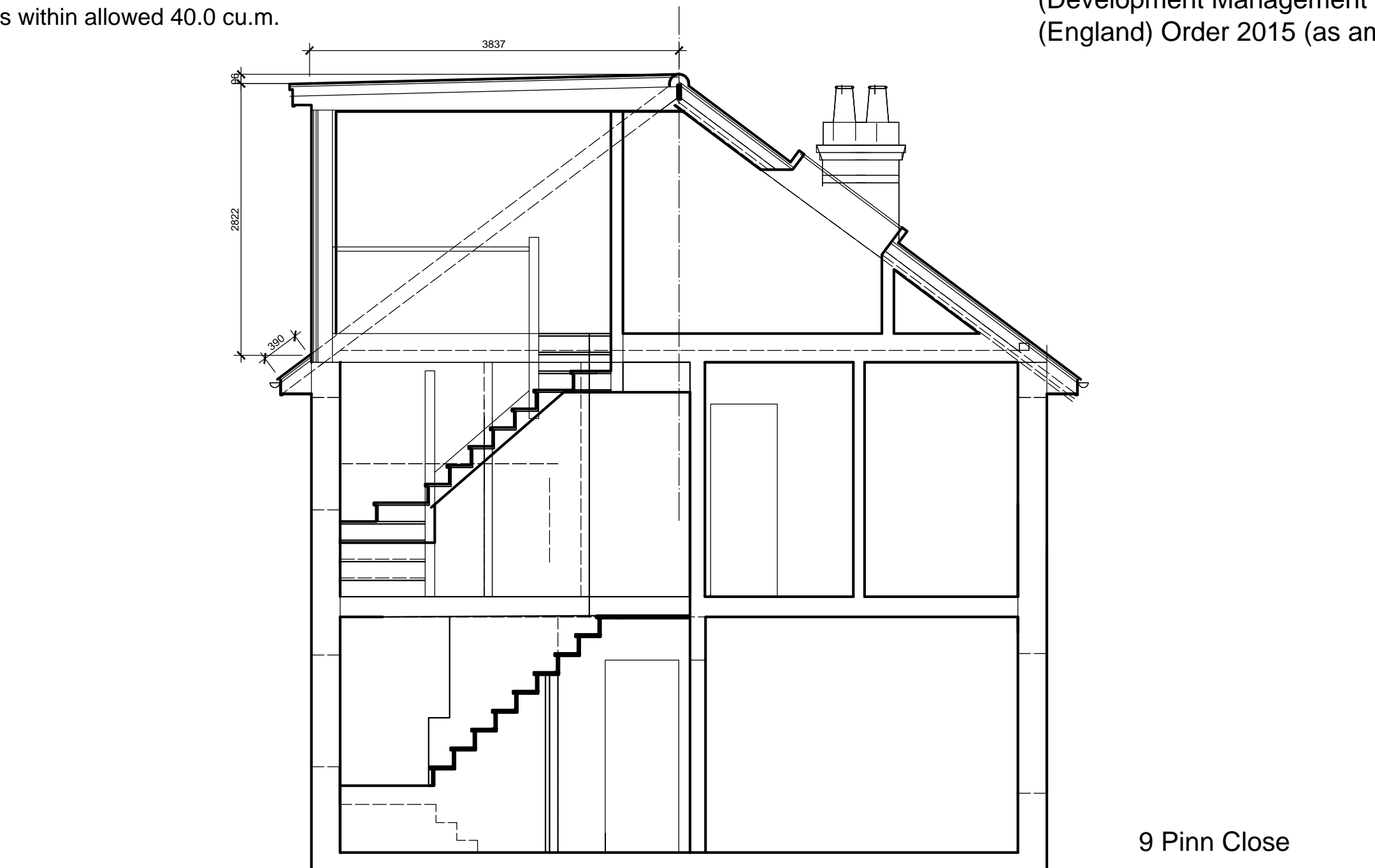

Plans, drawings and material submitted to the council are protected by the Copyright Acts (Section 47, 1988 Act). You may only use material which is downloaded or printed for consultation purposes. Further copies must not be made without written prior permission of the copyright owner.

3DArch Studio
2, Panmuir Road
London SW20 0PZ

Pawel J. Stasch Architect RIBA

Drawing title:
House extension
Section I - I
New proposal

Job title:
9 Pinn Close
Hillingdon
UB8 3TB

Job no:

C/S/B

Scale:

1:50@A3

Date:

21.01.25

Drawing no:

9

Revision suffix:

Drawn by:

P.J.S.

Checked by: