

© Axiom Architects LLP 2025.  
 It is for planning application purposes only and may not be reproduced in whole or in part without permission. Drawings lodged for planning approval may be reproduced by the Planning Authority in accordance with the Copyright (Material Open to Public Inspection) (Marking of Copies of Plans and Drawings) Order 1990 and must carry the relevant copyright restriction note. Scaling from this drawing should only be carried out from a print at the scale and size specified within the title block. Responsibility for ensuring correct size reproduction remains with the reader.

**Legend:**

- Existing Restaurant & BOH
- Existing Premier Inn

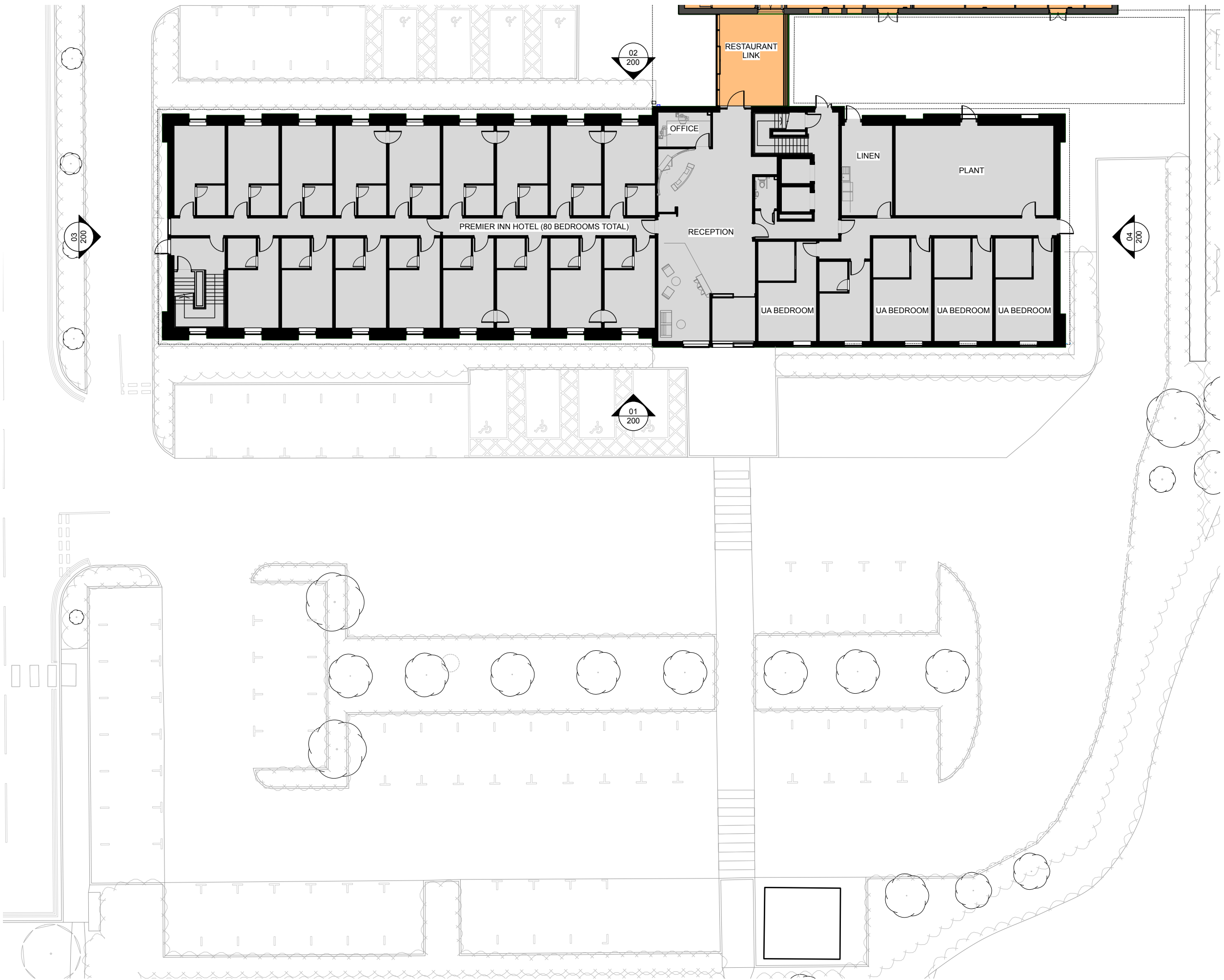

Rev	Date	Description	By	Chk

Addlepool Business Centre  
 Cyst St George  
 Exeter. EX3 0NR  
 Tel. 01392 368426  
 www.axiomarchitects.co.uk

**AXIOM**  
ARCHITECTS

**Client**  
WHITBREAD GROUP PLC

**Project**  
PREMIER INN LONDON UXBRIDGE  
500 RIVERSIDE WAY  
UXBRIDGE, UB8 2YF

**Drawing**  
Existing Ground Floor Plan

Scale	Date	Drawn	Checked
1:250@A3	05/12/25	SC	RW

Drawing No. Revision

**6505-PL- 100**

Status  
PLANNING

1 Existing Ground Floor  
Scale: 1:250

