

GROUND FLOOR PLAN  
PROPOSED

All new works or making good  
to the retained fabric shall be  
finished to match in size,  
colour, texture and profile  
those of the existing building.

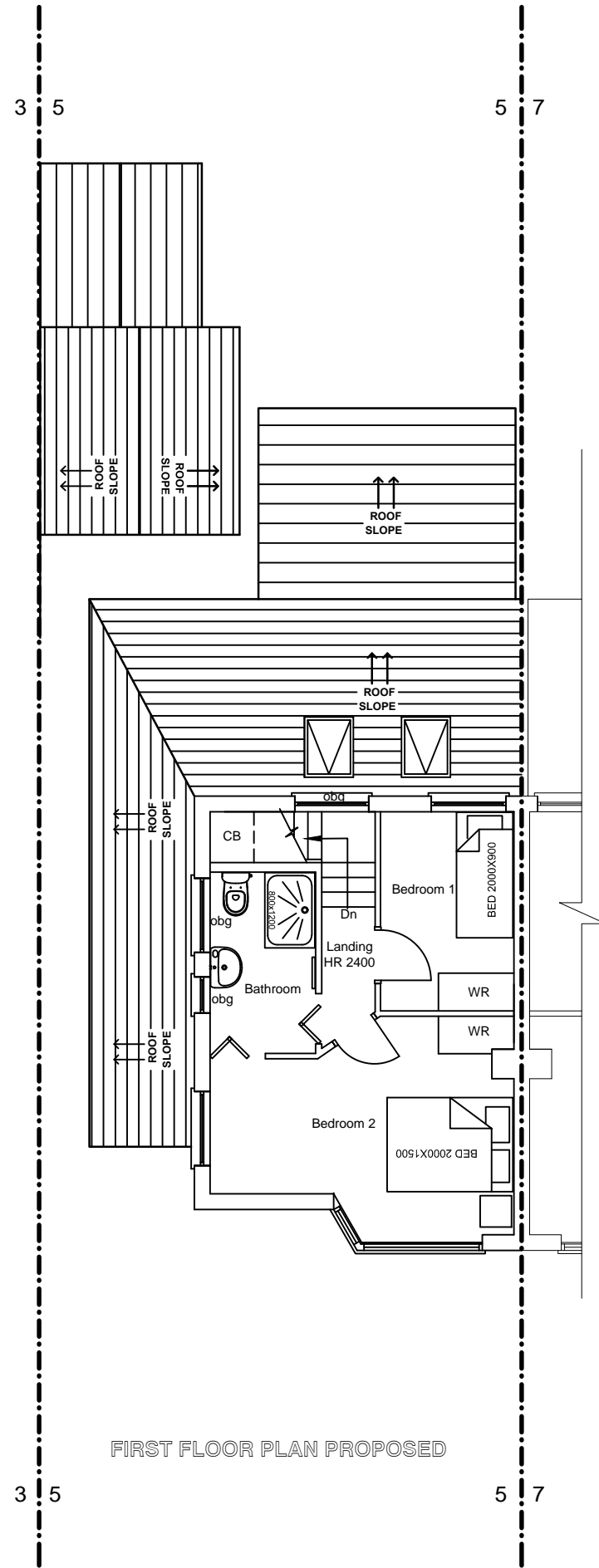

FIRST FLOOR PLAN PROPOSED

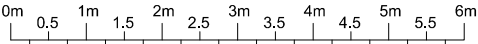

			<b>PROJECT:</b> PART DEMOLITION OF THE GARAGE, DEMOLITION OF THE CANOPY ROOF, ALTERATIONS TO THE EXISTING PITCH ROOF OF REAR EXTENSION INCLUDING INSERTATION OF TWO ROOF LIGHTS, SINGLE STOREY SIDE TO REAR EXTENSION AND ASSOCIATED ALTERATIONS AT 5 WARLEY AVENUE, HAYES UB4 0QZ	<b>Title: Proposed Plans</b>	
	14/10/2024	FOR HOUSEHOLDER DEVELOPMENT		<b>Drawn By:</b> PSL	<b>Rev:</b>
	09/09/2024	FOR CLIENTS REVIEW		<b>Date:</b> 14/10/2024	
<b>Rev</b>	<b>Date</b>	<b>Comment</b>		<b>SCALE:</b> 1:100@A3	<b>DRG. NO:</b> 2412-Warley Ave 5-102