

All doors / frames in Hallway at ground , first and second floor rooms to be provided with FD30 Fire doors

ALL steel beams to be provided with 2 coats of redoxide paint and beams /columns to be encased in 2 layers of fireline plasterboards to provide 1/2 Hr Fire resistance.

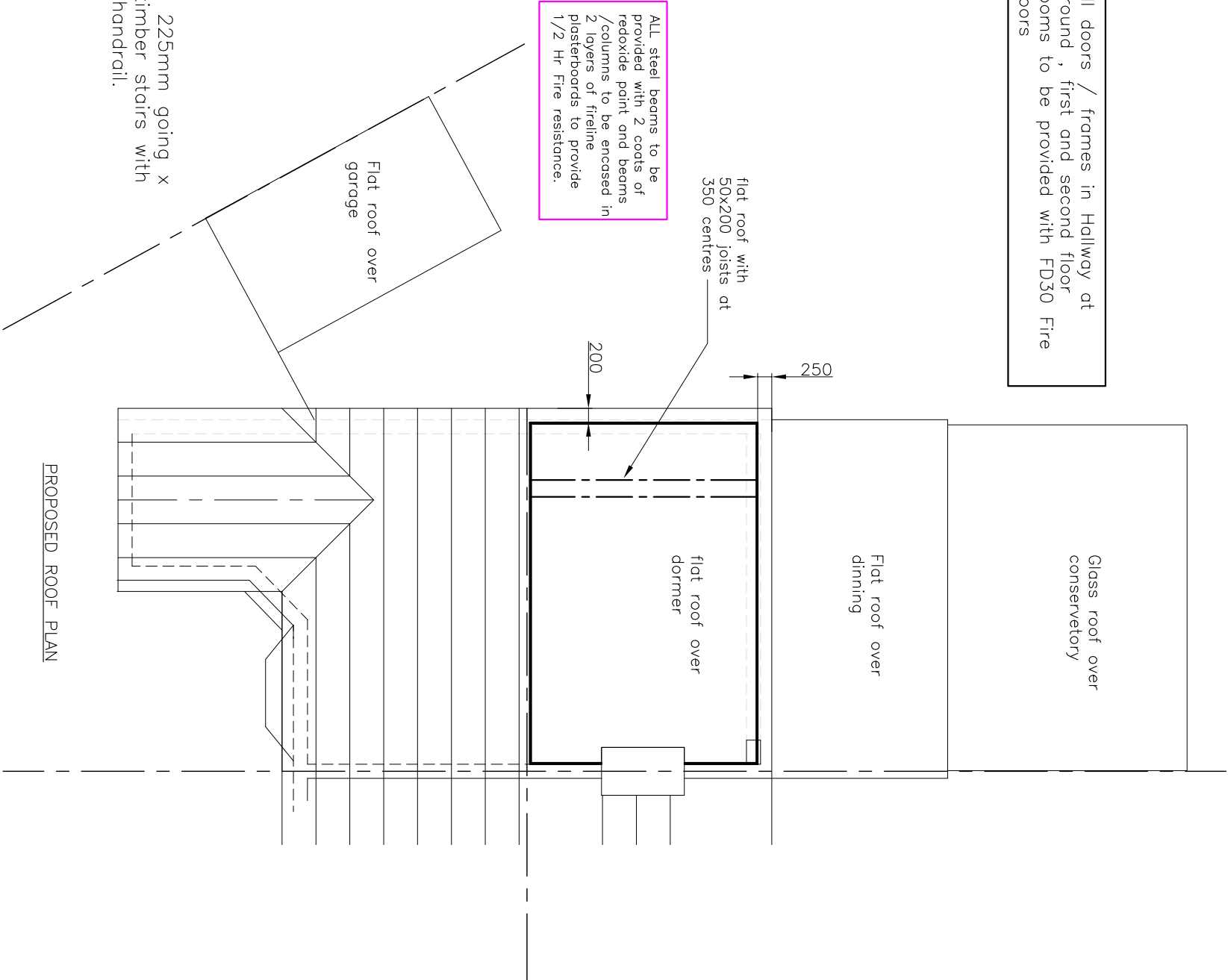

		DRAWING TITLE Proposed ground Floor & Roof plans		TITLE Proposed loft conversion with gable end, dormers at rear and roof lights on front elevation 20 Sutton close, Pinner HA5 2JX		Owner Mr Vamsi	
REV	DATE	DESCRIPTION	Drawn by Dev	Date Sept 24	Scale 1:100	Drawing No. V-02	Revision 01