

Rev.	Date	By	Check	Appr.	Description
A	21.08.2024	LH	NML	CB	Issued for planning
B	14.01.2025	ML	LH	CB	Issued for response to planning comments

Site boundary

Material Key

- 1 Standing Seam Zinc
- 2 Steel Doors
- 3 Louvred Doors
- 4 Buff Brick
- 5 Aluminium Rooflight
- 6 Zinc Gutter and Downpipe
- 7 Glass Block
- 8 PPC Aluminium Panel with Signage

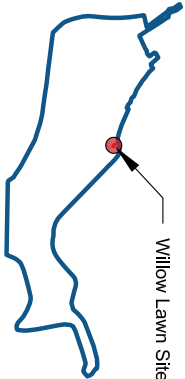
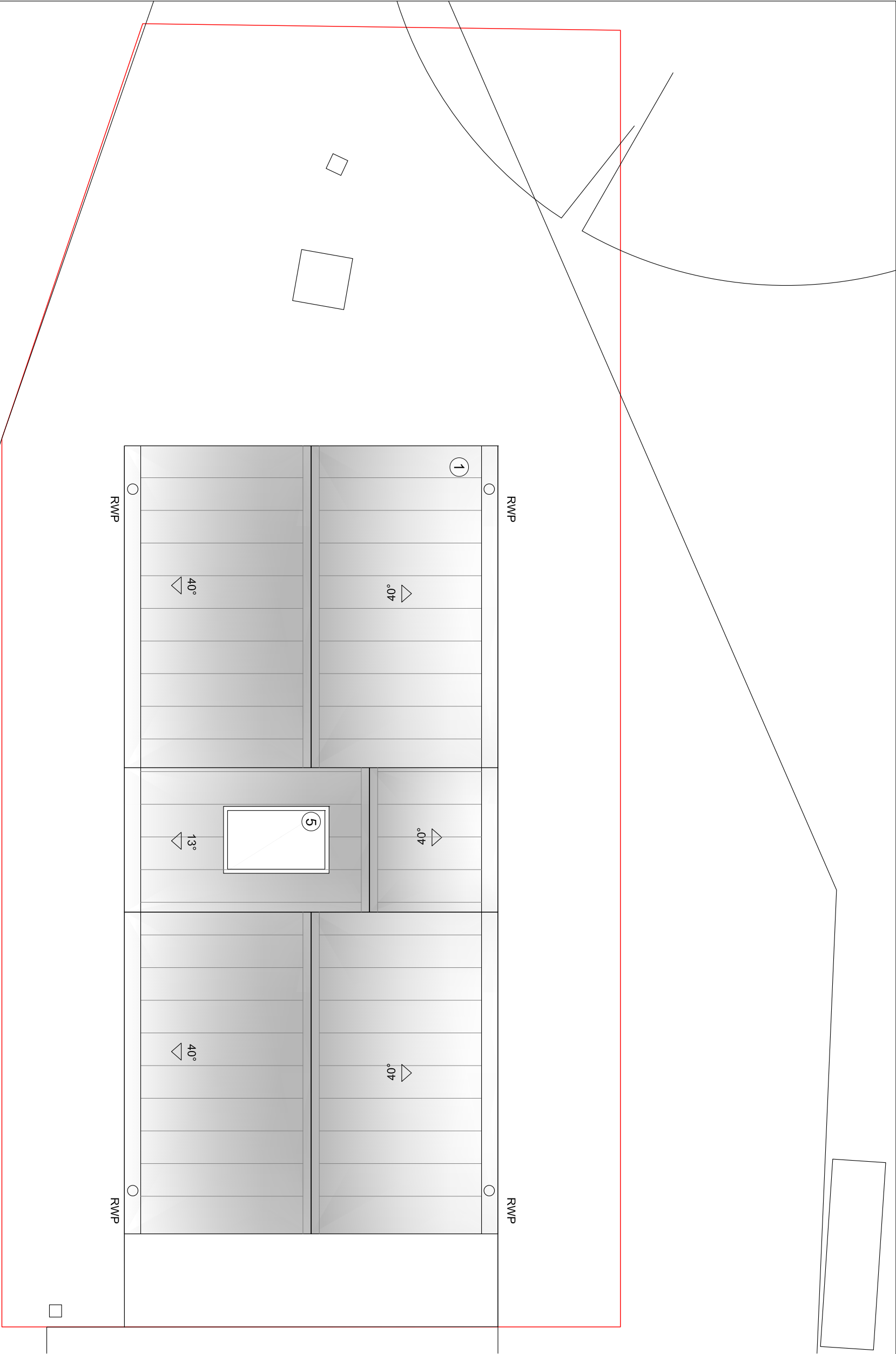

Prepared by: **1326** **P1052** **B**
Scales: 1:50@A3
11.07.2024
CB

Client: Hillingdon Council
Job Title: Ruinslip Lido
Drawing Title: Willow Lawn Proposed GF Plan

Job/Dwg No/Rev: 1326 P1052 B
Drawn: LH **Checked:** CB **Appr:** CB **Date:** 11.07.2024

Drawing Status: Planning
21.08.2024
14.01.2025
11.07.2024
1:50@A3