

Rev.	Date	By	Check	Appr.	Description
A	21.08.2024	LH	NM	CB	Issued for planning
B	14.01.2025	ML	LH	CB	Issued for response to planning comments

- Site boundary
- Existing building elements  
proposed to be demolished

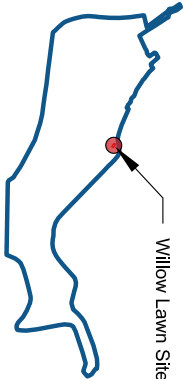
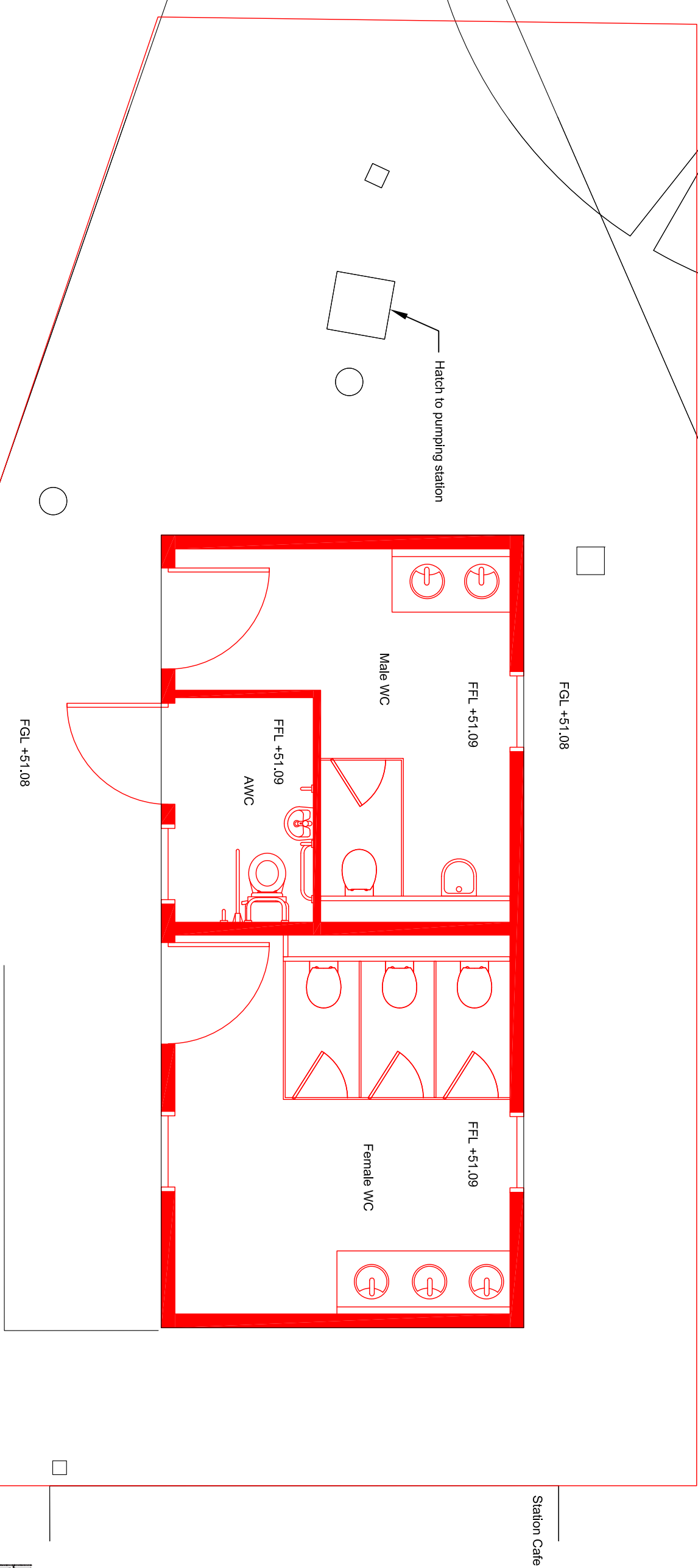

**Revised 14.12.24** 14.12.24/25/7/5/6  
SHEILA M. CUNNINGHAM  
COUNCIL PLANNING  
WWW.HILLINGDON.COUNCIL

**Client:**  
Hillingdon Council

**Job Title:**  
Ruinslip Lido

**Drawing Title:**  
Existing & Demolition Willow Lawn GF Plan

**Job/Dwg/Rev:** 1326 P1050 B

**Drawn:** LH **Checked:** CB **Appr:** CB **Date:** 21.08.2024

**Drawing Status:** Planning **Check:** All dimensions are as site **Scale:** 1:50@A3