

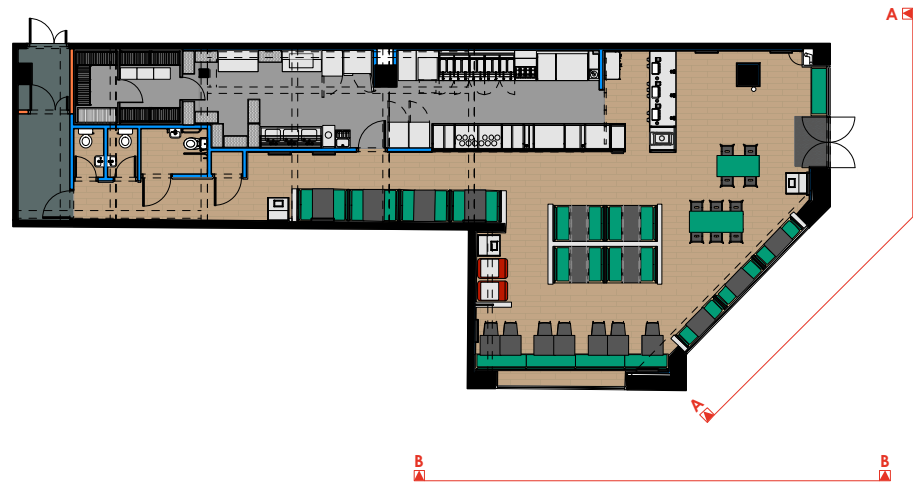

FRONT ELEVATION AA
SCALE 1:100



FRONT ELEVATION BB
SCALE 1:100



KEY PLAN
SCALE 1:250

SIGNAGE:		(S3)	WINGSTOP MOTIF - 01no. reverse applied cut crystal etch vinyls applied to new shopfront top door glass, dims & positions tbc on site	NOTES :		(03)	NEW GLAZED ALUMINIUM SHOPFRONT, POWDERCOATED RAL 9005 JET BLACK		CLIENT		TITLE			PROPOSED SHOPFRONT				the design content has been based on original dwg files provided by wingstop uk lemon pepper holdings ltd to tanner design limited for their use. all dims to be confirmed on site no site survey has been undertaken by tanner. structural works tbc by structural engineer. all elements to comply with statutory requirements.
(S1)	WINGSTOP SIGN - 01no 3200w 330h shown dimension and details tbc on site	(S4)	FLAVOUR MANIFESTATION - 01no. black vinyl flavour texts 3 high applied to glazing shown dimension tbc on site	(01)	NEW 700MM HIGH ALUMINIUM LOUVRES, POWDERCOATED RAL 9005 JET BLACK	(04)	HIGH LEVEL SHOPFRONT TO BE RETAINED		DRAWING No. TD24/WS07/01.2			REVISION NOTES			Tanner Design Limited Marcar House 13 Parkshot Richmond Surrey TW9 2RG tel. 07974 324216 email. studio@tannerdesign.co.uk www.tannerdesign.co.uk			
(S2)	OPENING HOURS - 01no. reverse applied cut white vinyls 400w 480h MOTIF & OPENING HOURS applied to new shopfront door glass	(S5)	SHOPFRONT MANIFESTATIONS -11no. reverse applied cut crystal etch vinyls 125h WINGS FRIES SIDES REPEAT, applied to existing shopfront windows as shown	(02)	SIGNAGE PANEL (SIGNAGE SUBJECT TO SEPARATE ADVERTISING CONSENT)	(05)	EXISTING SHOPFRONT TO BE RETAINED POWDERCOATED RAL 9005 JET BLACK	LOCATION THE CHIMES, UXBRIDGE High Street, UB8 Unit HS4 Ground Floor		REVISION .	DATE 31.07.24	SCALE 1:50@A1 1:100@A3						