

Front Elevation

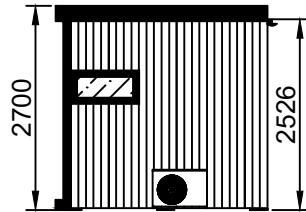

Right Elevation

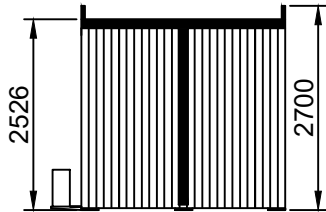

Rear Elevation

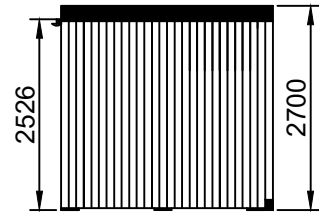

Left Elevation

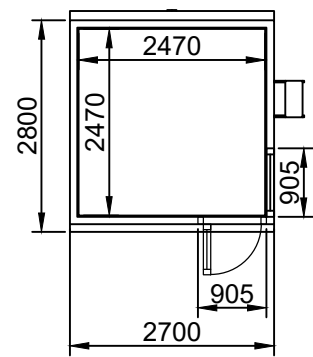

Floor Plan

General Construction:

Roof:

60mm - 95mm of high density polyurethane insulation surrounded by 1mm steel plates

Floor:

80mm Interlocking steel coated structurally insulated floor panels sit on top of foundation system.

Walls:

Timber frame (Tanalised) with 50mm of Rockwool insulated cavity incorporating breathable foiled photon wrap. Internal plaster board and plaster skim.

Cladding:

Composite black cladding to all elevations.

Doors:

Single door (905mm x 2070mm, clad)

Windows:

Lozenge window (905mm x 440mm, Opening: top-hung) with Planitherm glass

Air-Con Condenser to right elevation

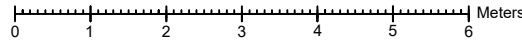

Drawing Title: Louis Coleman	Number: 1.	Scale: 1:100 All measurements in mm, setup for A3 printing.
Designed By: Becky Harper	Date: 02/08/2024	
Installation Address: 6 Mill Drive Ruislip HA4 7GL	Design: G2 - 2.5m x 2.5m	
	Reference: 240700517GRS1	