

Ash Grove

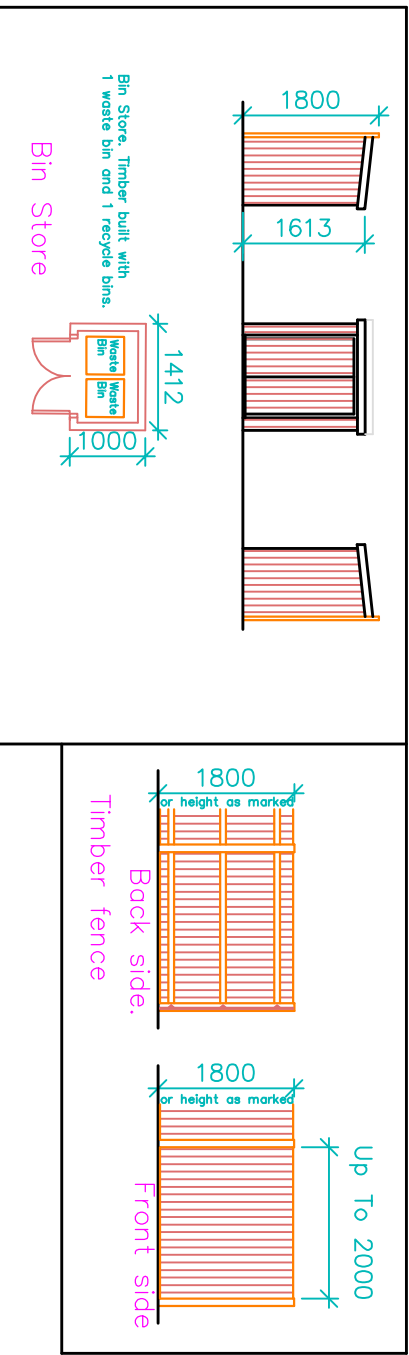
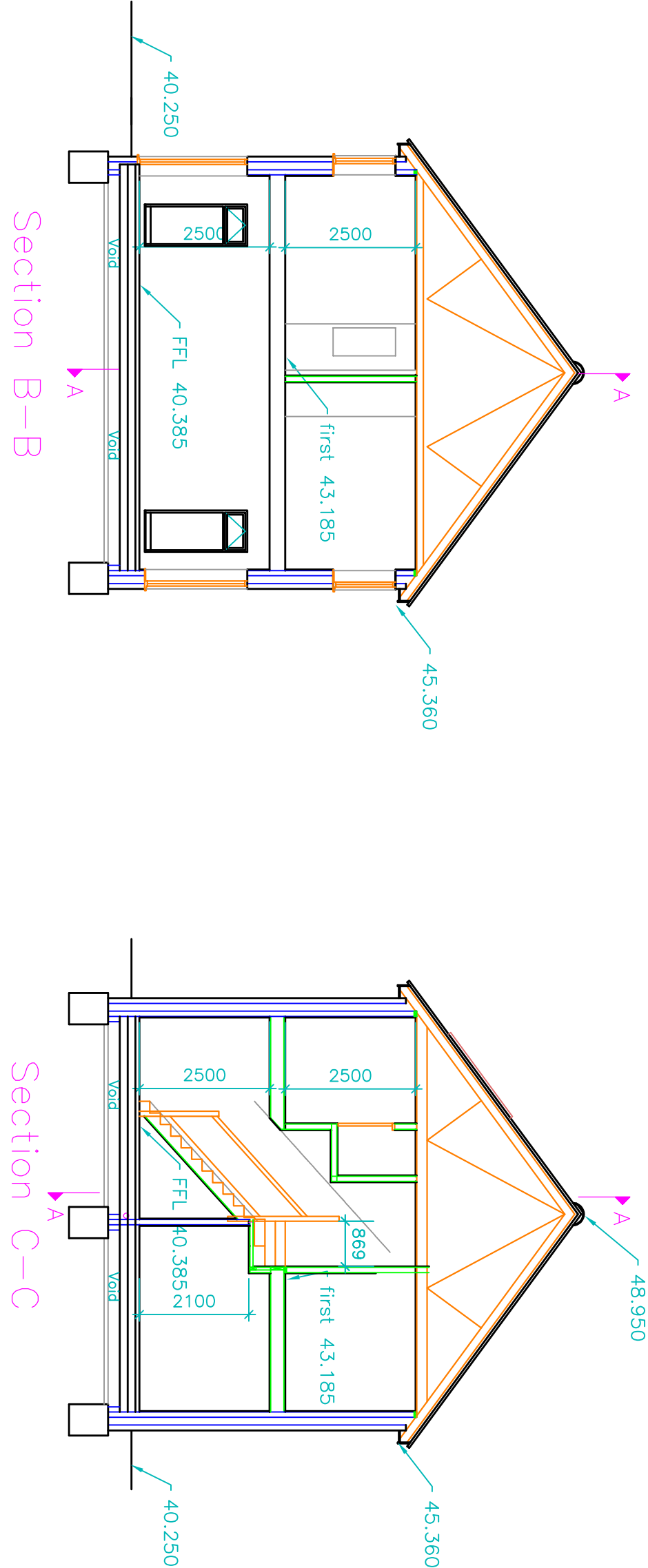

1. Do not scale from this drawing.		2. All dimensions to be checked on site before ordering materials or commencing work.	
3. In case of discrepancies in drawings, calculations or details refer to TOWERS ASSOCIATES LTD. for clarification. Unilateral decisions by contractors will not be accepted.		4. For any information not covered by ASSOCIATES LTD. for clarification: Unilateral decisions by contractors will not be accepted.	
5. The contractor must ensure that work is in accordance with the latest revisions of all the working drawings.		6. It is the contractor's responsibility to inform the local authority before work commences on site, and at all prescribed stages of work. All to the District.	
7. If any person's satisfaction, ASSOCIATES LTD. accept no responsibility for any additional work or materials that the District Surveyor may require.		8. This drawing and all copies produced there from are the property of TOWERS ASSOCIATES LTD. It may only be reproduced by TOWERS ASSOCIATES LTD and ASSOCIATES LTD if demanded.	
By using this drawing the user and his or her employer signify their agreement of the above terms and conditions.			
JDB and to the rear of 58 Beechwood Avenue Hayes, UB3 1JP.		Proposed Layout Sheet 1 of 2	
REV. No. 3354-03		REV.	
SCALE 1:100		DATE May 24	
DRAWN BY JDB		CHECKED DN	
TOWERS ASSOCIATES LTD		DATE May 24	
Harefield Oil Terminal Harefield Rd.		TOWERS ASSOCIATES LTD	
Harefield, MIDD. UB9 6JL.		TOWERS ASSOCIATES LTD	
TEL. 01895 812 822		TOWERS ASSOCIATES LTD	
email: info@towers-associates.com		TOWERS ASSOCIATES LTD	
WEB: www.towers-associates.com		TOWERS ASSOCIATES LTD	