

GENERAL NOTES:

All work must be carried out in accordance with the manufacturer's , suppliers rewritten instructions and recommendations so that all guarantees can be achieved.

All work to be carried out in accordance with all statutory requirements, standards and codes of practice.

his drawing is protected by
copy right laws. ©

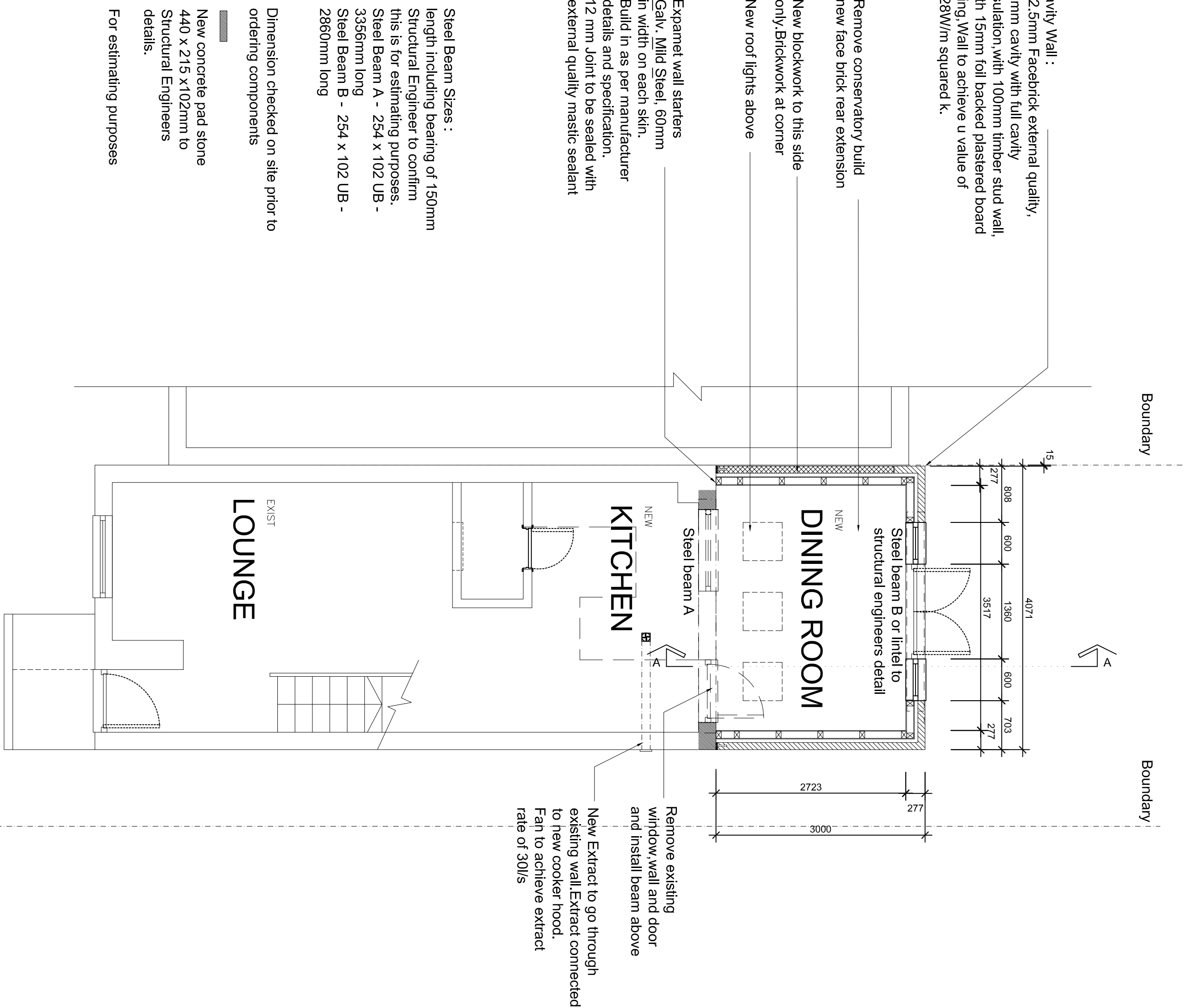

Steel Beam Sizes :
length including bearing of 150mm
Structural Engineer to confirm
this is for estimating purposes.
Steel Beam A - 254 x 102 UB -
3356mm long
Steel Beam B - 254 x 102 UB -
2860mm long

Dimension checked on site prior to ordering components

New concrete pad stone
440 x 215 x 102mm to
Structural Engineers
details.

For estimating purposes

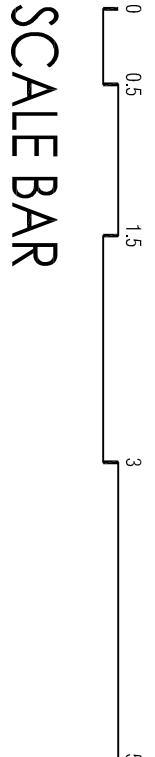
PLAN OF PROPOSED GROUND FLOOR
SCALE 1:50 @ A1

A	28.01.24	FOR PLANNING APPROVAL	DCR	DCR
NO	DATE	REVISION	BY	CHECKED

address	
14 GREYSTOKE DRIVE RUISSLIP HA4 7YL	
project	
PERMITTED DEVELOPMENT	
Proposed Rear Extension	
Plan Proposed - PROPOSED GROUND FLOOR	
client	
Diane and Martin Boothby	
date	28.01.2024
specie	
dwgn by	As Shown
DCR	(@A1)
DCR no	REC/V
DCR no	A
DCR no	DRS101-102



DOUGLAS
ROLE
STUDIOS

Project
Name

DOUGLAS ROLE

Address

14 Greystoke Drive, Russlip, HA4 7YL

Phone: 01187 211066

Email: info@douglasrolestudios.com

Website: www.douglasrolestudios.com

Architectural Services

Interior Design

Planning & Building Regulations

Structural Engineering

Energy & Sustainability

Health & Safety

Access

Fire Safety

Other: Please List

Ref: 2024/01/01

Rev: 002