

PLANNING ISSUE

Check all dimensions on site.Do not scale off drawings without prior consultation. Any discrepancies to be reported to architect before execution of relevant works. This drawing has been produced for Ms Trisk for the development of 16 North Drive, HA4 8EZ and for that application alone and is not intended for use by any other person or for any other purpose. Drawings remain copyright of Kinoko Studio and may not be reproduced without written consent or licence.

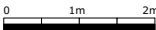

Section C

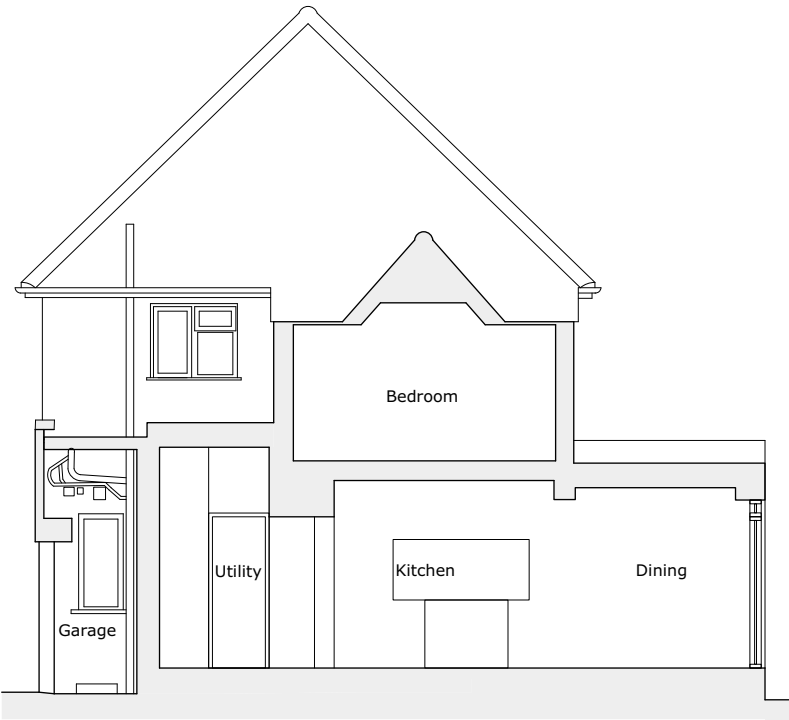

Section D

Issue/Revision		Planning Issue	Date	16.02.2024	Rev	-
Project:						
Extension and renovation 16 North Drive. HA4 8EZ						
k i n o k o s t u d i o						
71-75 Shelton Street, London WC2H 9JQ T: 07479 888 363 E. mail@kinokostudio.co.uk www.kinokostudio.co.uk						
Subject:		Proposed Sections C and D				
Scale:		1:100		Date: 16.02.2024		
Original Size:		A3				
Drawing No.:		05 P062			-	