

Scale bar 1:500 (Meter)

BLUE ARCHITECTURE LIMITED
Consulting Architects, Engineers and Interiors.
102 Dorchester Way, Hayes, Middlesex,
UB4 0HY, London.

Contact:
Email: info@bluearchdesign.co.uk,
Cell: 044 + 078 3293 8374
Web site: www.bluearchdesign.co.uk

Notes:
© 2023 Blue Architecture Limited.
All rights reserved.
All drawings are for the purpose of gaining
Planning Permission approval only.
All written dimensions to be taken in
preferences to scaled dimensions.
Rear Extension:-
Carpet Area: 21.92 Sq.M

Rev.	Description	By	Ckd	Date

Client:
Mr. Thakur Dhungana.

Project:
Single storey Rear Extension 4.0 M Deep.

Location:
66 Ryefield Avenue, Uxbridge,
Middlesex, UB10 9BY.

Status:
Larger extension: neighbour consultation scheme

Title:
Existing and proposed Block plans

Drawn by: L.p	Str. Fr. ---	Checked by: R.k	Sheet no.
Project no: BAL-1675	Sheet Size A3		
Date: 07/12/2023	Scale: 1:500		05

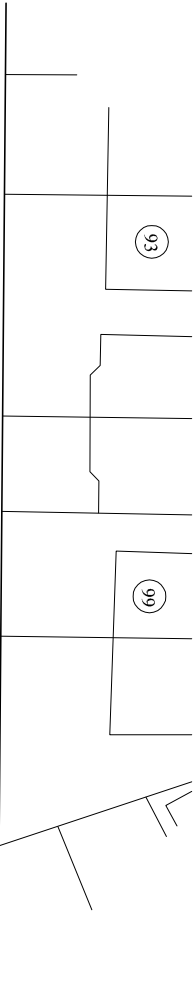

Ryefield Avenue

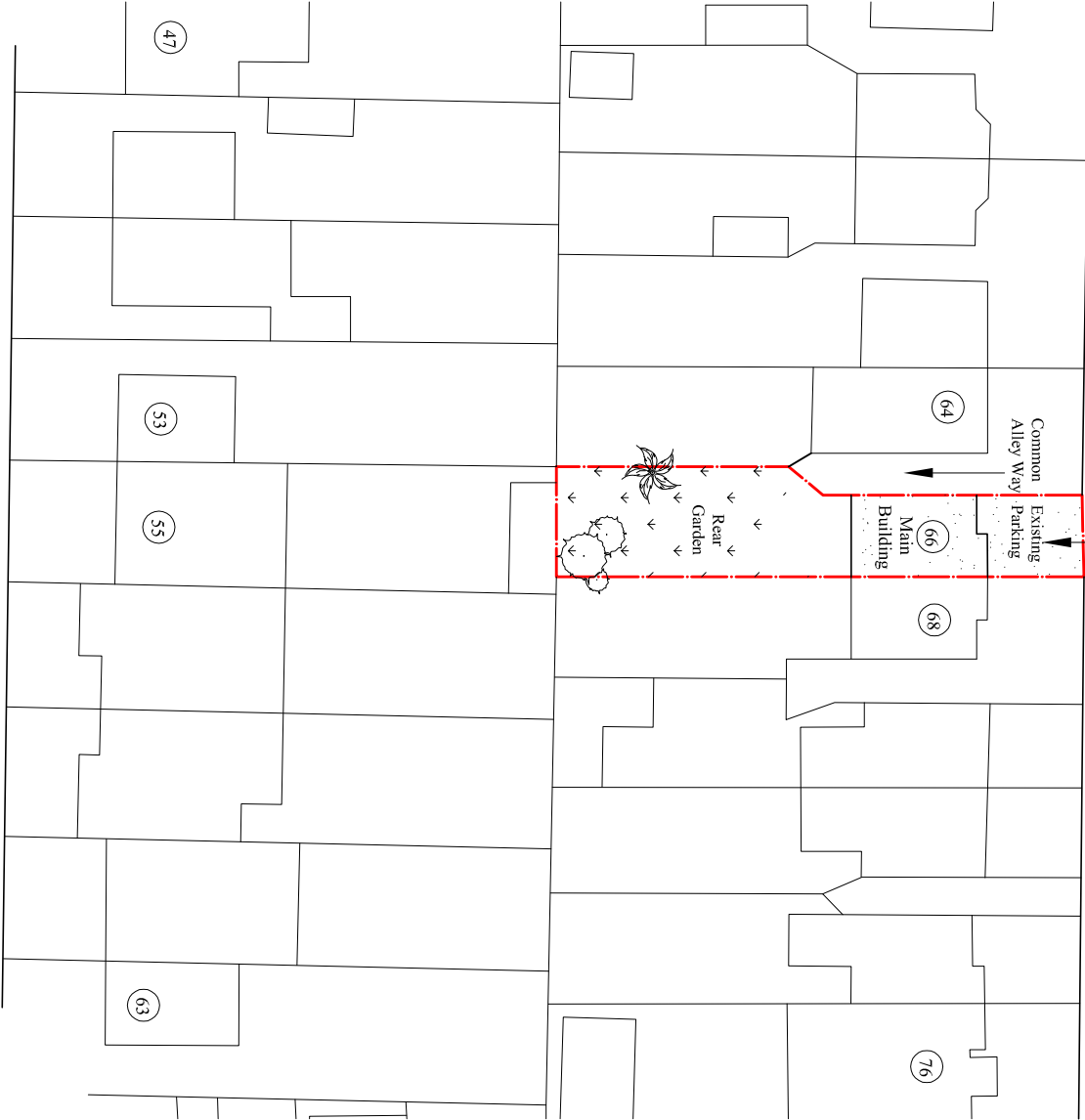

Sedgwick Avenue

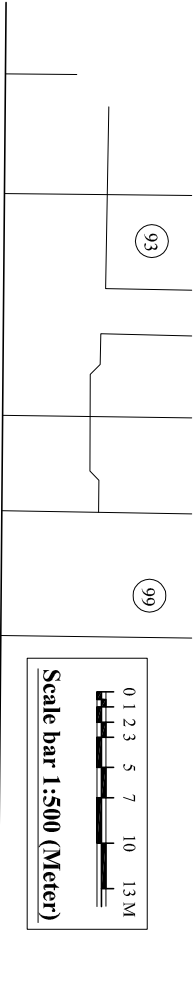

Ryefield Avenue

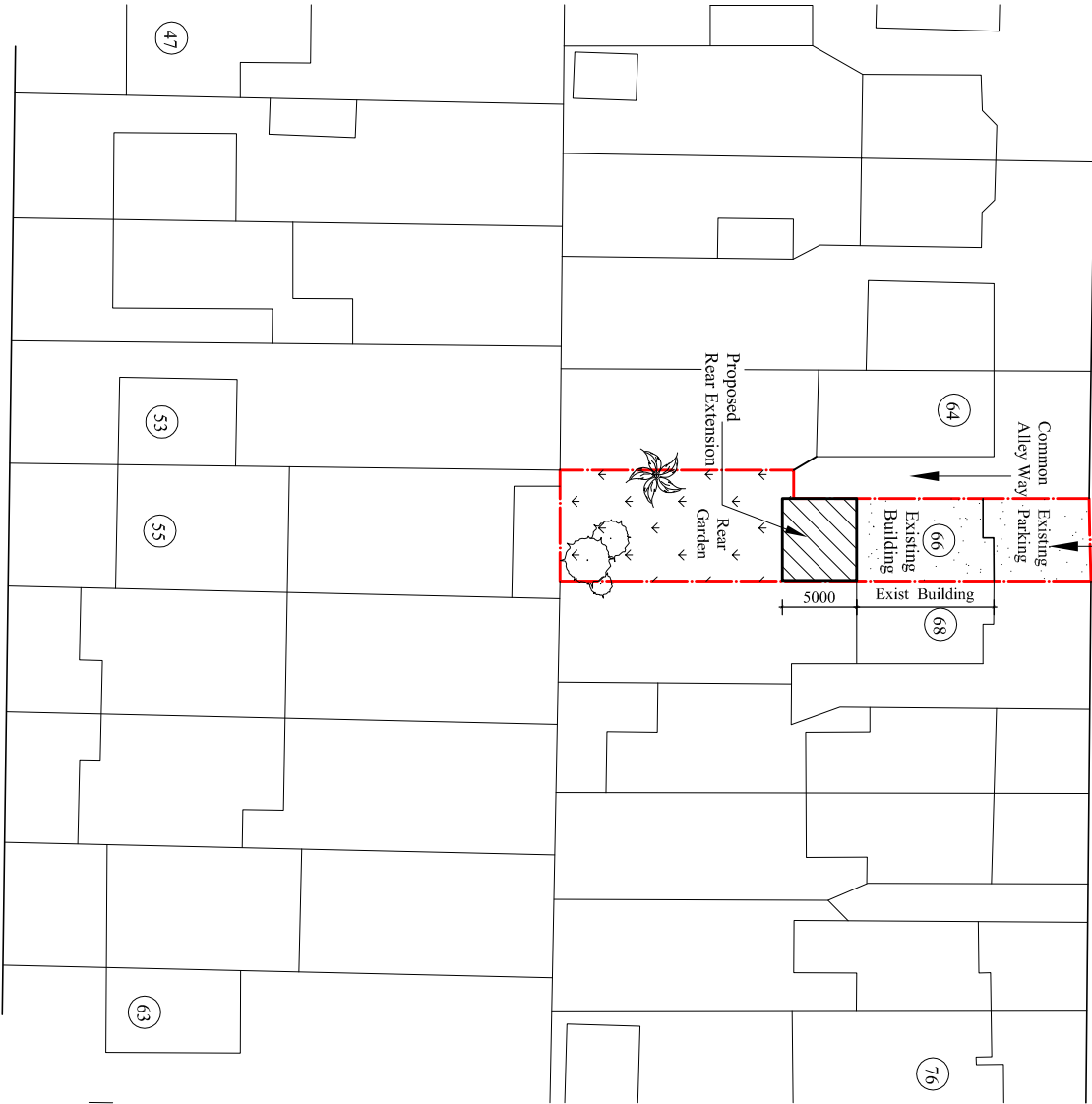

Sedgwick Avenue

Existing Block Plan

Scale:1:500

● = Trees

Proposed Block Plan

Scale:1:500

● = Trees