

GEA						
Floor Level	Existing (SQM)	Existing (SQF)	Proposed (SQM)	Proposed (SQF)	Additional (SQM)	Additional (SQF)
Ground Floor	146.4	1576	225.3	2424	78.9	1319
First Floor	87.7	944	182.7	1966	95.0	1022
Second Floor	N/A*	N/A*	139.0	1496	N/A*	N/A*
Total	234.3	2520	547.0	5886	N/A*	N/A*
N/A* = Not Surveyed (Existing loft uninhabitable space not surveyed)						

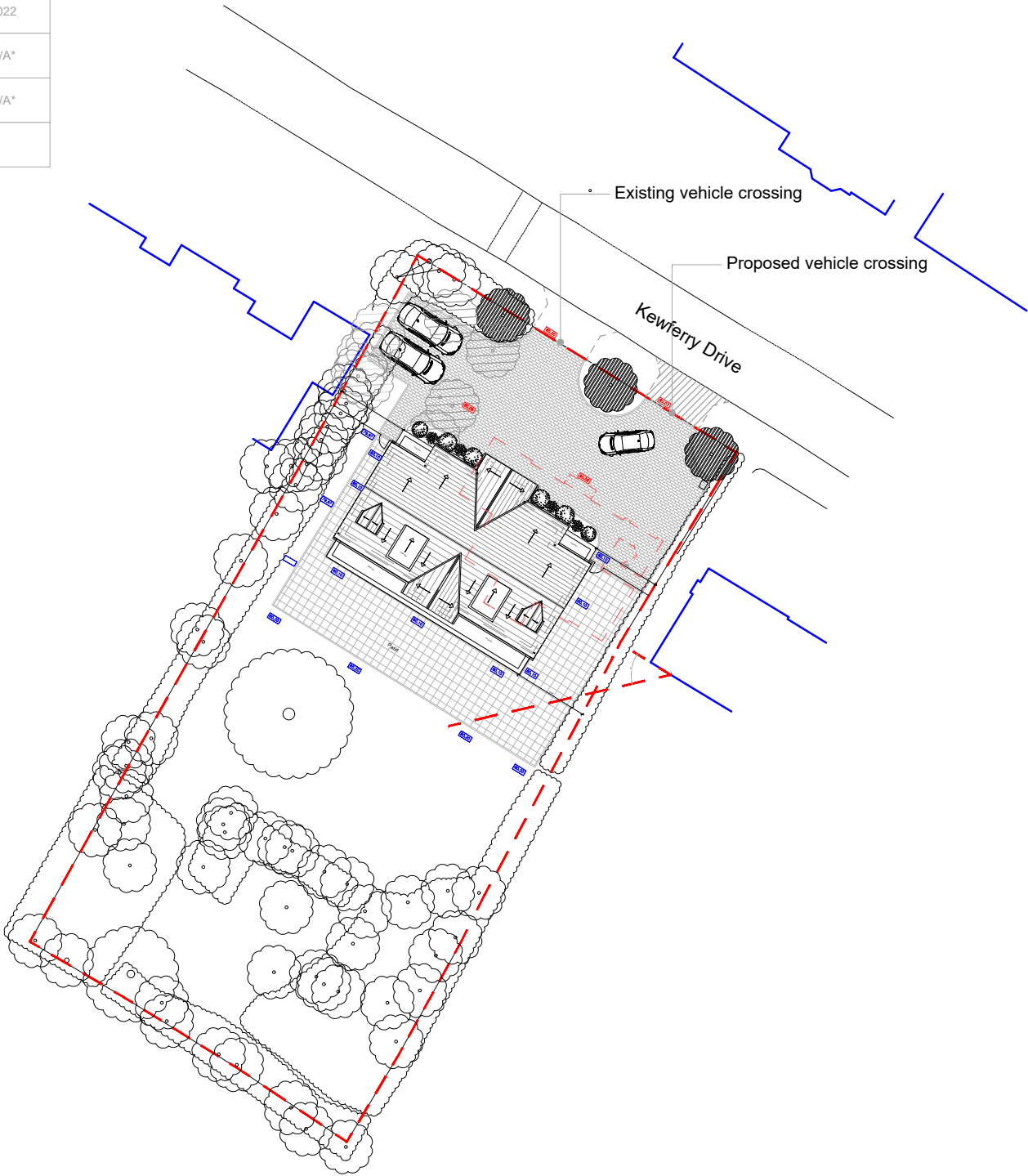

PLANNING

Amendments/Notes

Rev.	Description	Date	Issued by
A	Additional 2M to rear added as per clients comments	18.04.2024	PCS
B	Play room door changed, Utility and Spice Kitchen combined as a Spice Kitchen	25.04.2024	PCS
C	Curved staircase omitted and staircase widened to 4m as per clients request	16.05.2024	PCS
D	Materials annotated, building dropped by 150mm to reduce increase of ridge height and general presentation amendments	17.06.2024	PCS

Key

- Existing tree
- Tree to be removed following arborist report
- Proposed tree
- Neighboring buildings
- Existing footprint
- Site boundary
- Proposed level
- Existing level

All dimensions and levels to be checked on site by contractor prior to preparation of shop drawings and commencement of work on site. Dimensions MUST NOT be scaled from this drawing.

This drawing and the copyrights and patents therein are the property of MiCasa Architects and Architectural Interior Design and may not be used, reproduced or distributed without consent.

This drawing is to be read in conjunction with all relevant consultants and/or specialist's drawings/documents and any discrepancies or variations are to be notified to MiCasa Architects and Architectural Interior Design before the affected work commences.

All works on site are to be carried out fully in accordance with current CDM regulations and recommendations, current Building Regulations, British Standards and Codes of Practice as appropriate.

Notes specific to Architectural Interior Design (In addition to the above)

All dimensions to be checked on site prior to installation / building / fitting.

Architectural Interior Design details shown on this drawing are for approval purposes.

This drawing must be signed, approved and accepted as correct by the client before the project progresses.

Project:

13 Kewferry Drive,
Northwood, HA6 2NT

Client: MR & Mrs Gujar

Drawing:

Proposed
Site Plan

MICASA
JUST IMAGINE

Chartered Architects
Interior Architecture



8-10 Rowland Place | Green Lane
Northwood | HA6 1AB
01923 827070 | studio@micasagroup.co.uk

Scale: 1:100 @ A3	Date: Mar 2024	AR
Drawn By: PCS	Checked By: JP	

Drawing No:	Rev:
2402-PL-101	D

0 Scale 1:500 50m