

Winston Churchill Theatre - Landscaping Plan

Summary of Plan:

Proposed hard landscaping:

- Installation of new fenced enclosure to contain 3no. ASHPs units.
- Shingle base laid within new enclosure to accommodate drainage of condensate from ASHPs.
- Concrete plinths below ASHP feet to mount units on.
- No change to existing pedestrian access or walkways.
- No change to existing vehicle access routes.

Proposed soft landscaping:

- Planting of shrubs around new fenced enclosure.
- Planting of new trees in the line of sight between the Manor House and Theatre to screen solar PV.

Existing Landscape

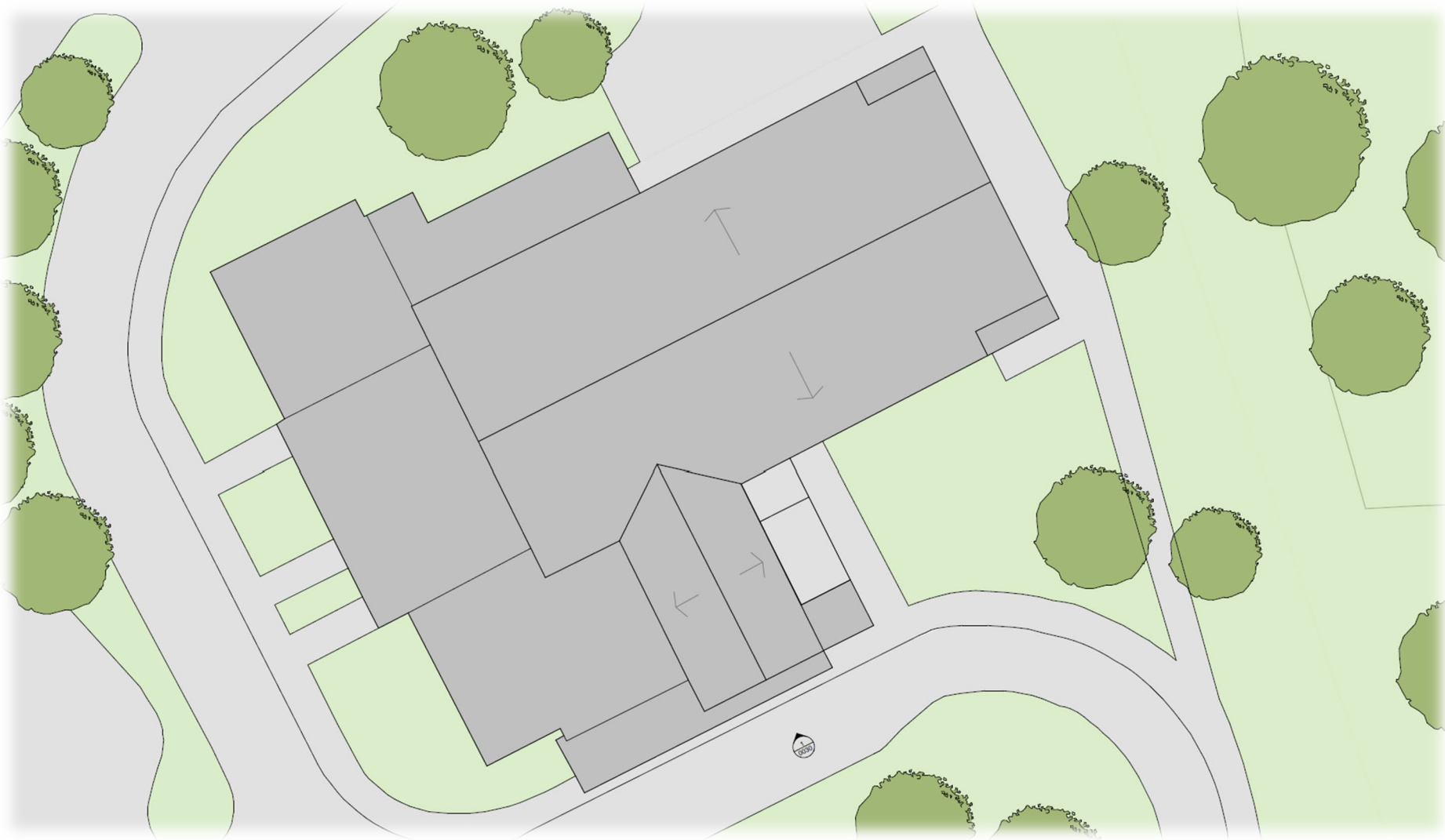

Existing Soft Landscaping

Existing Trees

Existing Dense Vegetation

Proposed Landscape

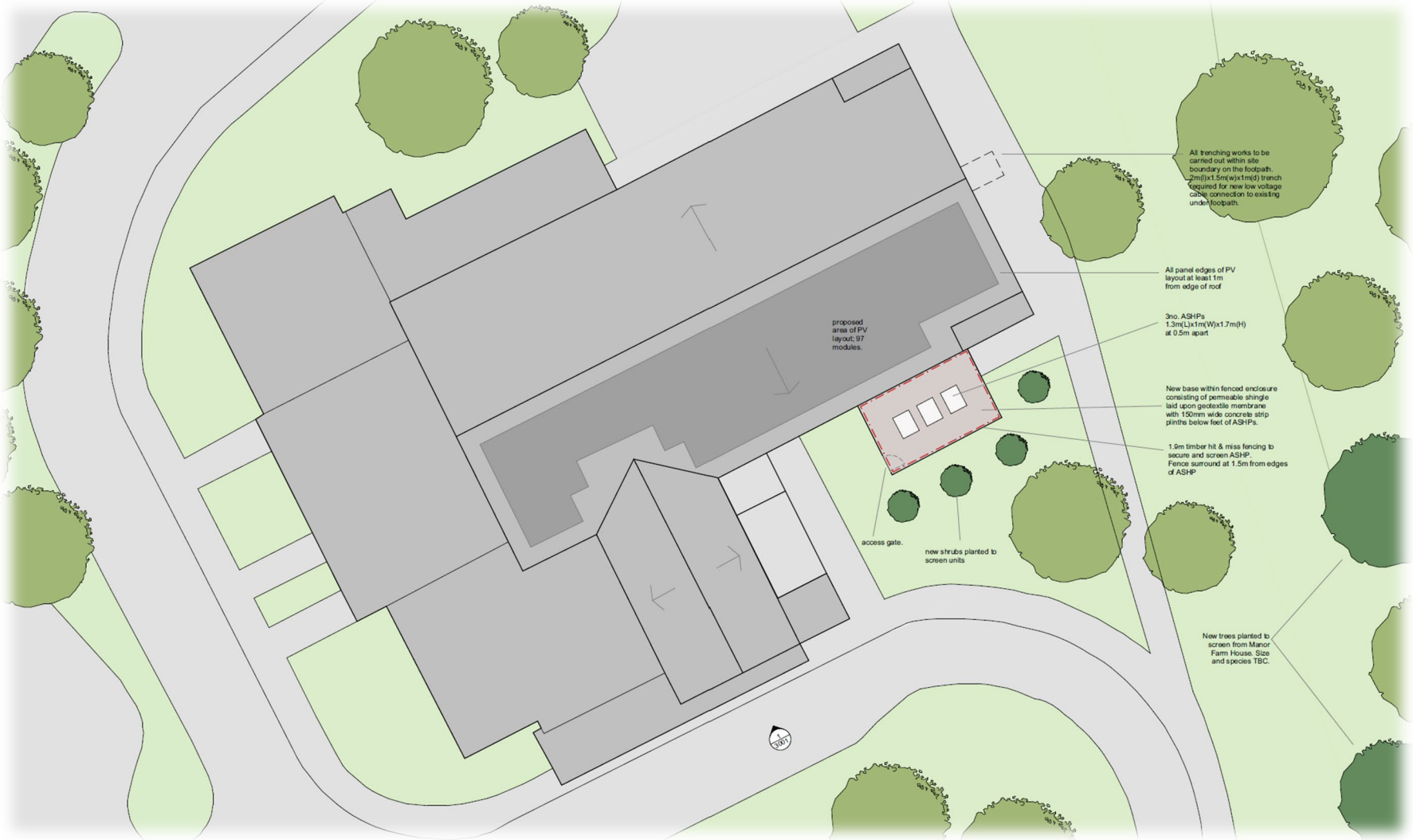

- | | | |
|---------------------------|----------------|----------------------------------|
| Existing Soft Landscaping | Existing Trees | Proposed new fencing |
| Existing Dense Vegetation | Proposed Trees | Roof area proposed for PV layout |
| Proposed Hard Landscaping | | |

Proposed Hard Landscaping

3no. ASHPs to be securely enclosed within 1.9m high timber hit & miss fencing along south elevation of the theatre building.



New base within the fenced enclosure consisting of permeable shingle laid upon a geotextile membrane with 150mm wide strips of concrete plinths added below feet of ASHPs.

Any excavation works to be completed under a Watching Brief in accordance with a Written Scheme of Investigation that has been agreed prior to commencement of these works with the Local Planning Authority.

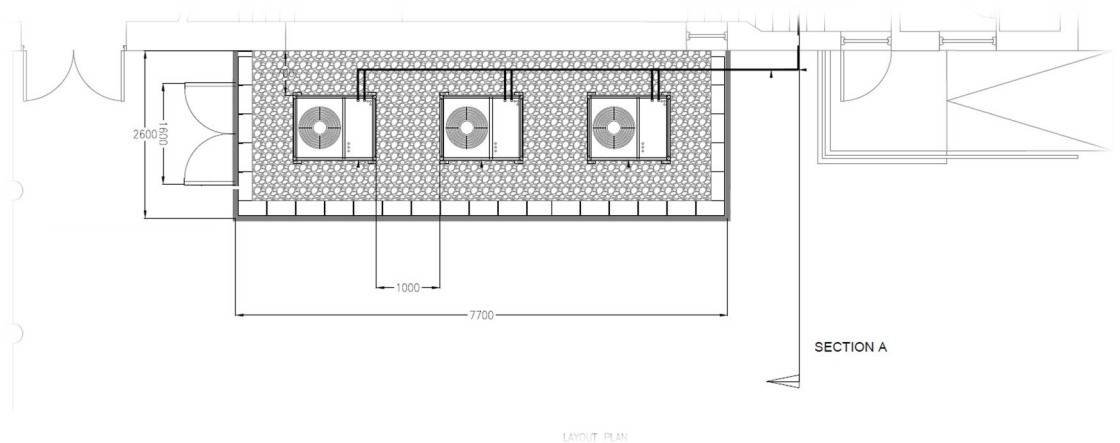
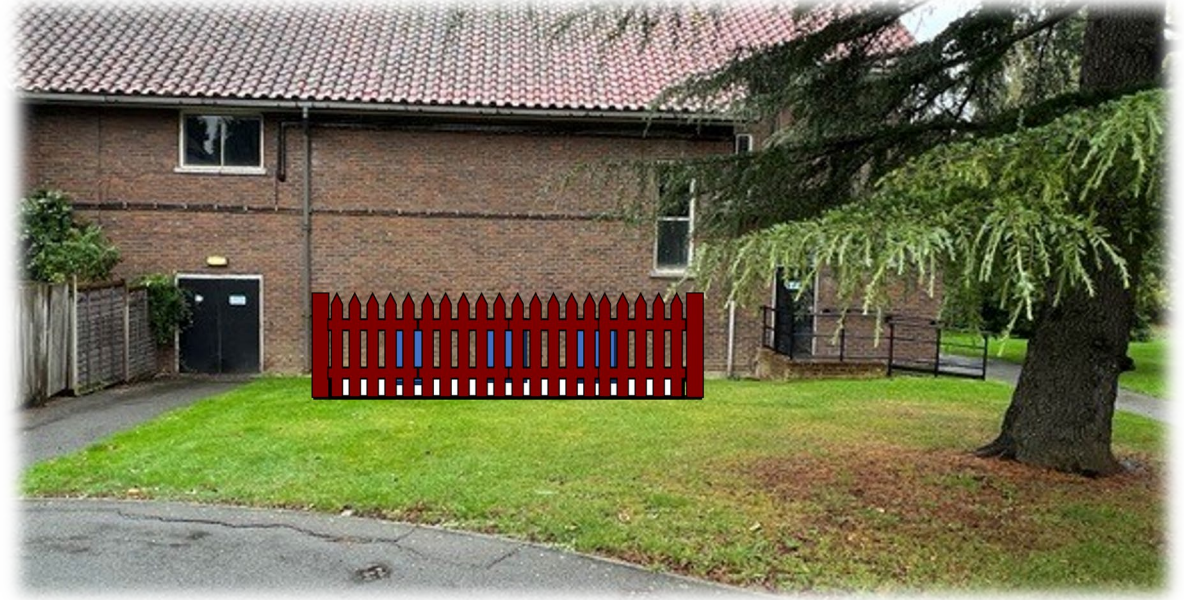

Proposed Soft Landscaping

To screen the new fencing, a row of Laurel Root Ball hedging will be planted along the outside of the enclosure. The hedge will be maintainable to the height of the fence or above.

To screen the solar PV from the Manor House viewpoint, 2no. Silver Birch trees will be planted. They will be planted into 1m x 1m x 1m pits which will have a 200mm layer of shingle at the bottom, 200mm of subsoil and then 600mm of topsoil.



Plants will be sourced from a local tree nursery. For the first 2 months after planting, they will be watered and maintained by a professional landscaper to ensure their survival.

Contaminant-free, single source, nutrient rich soil will be sourced from a local supplier.

Excavated earth will be collected using skips / bulk bags and be disposed of as organic waste (managed sustainably and recycled where possible) using a licensed waste removal company.