

Ground

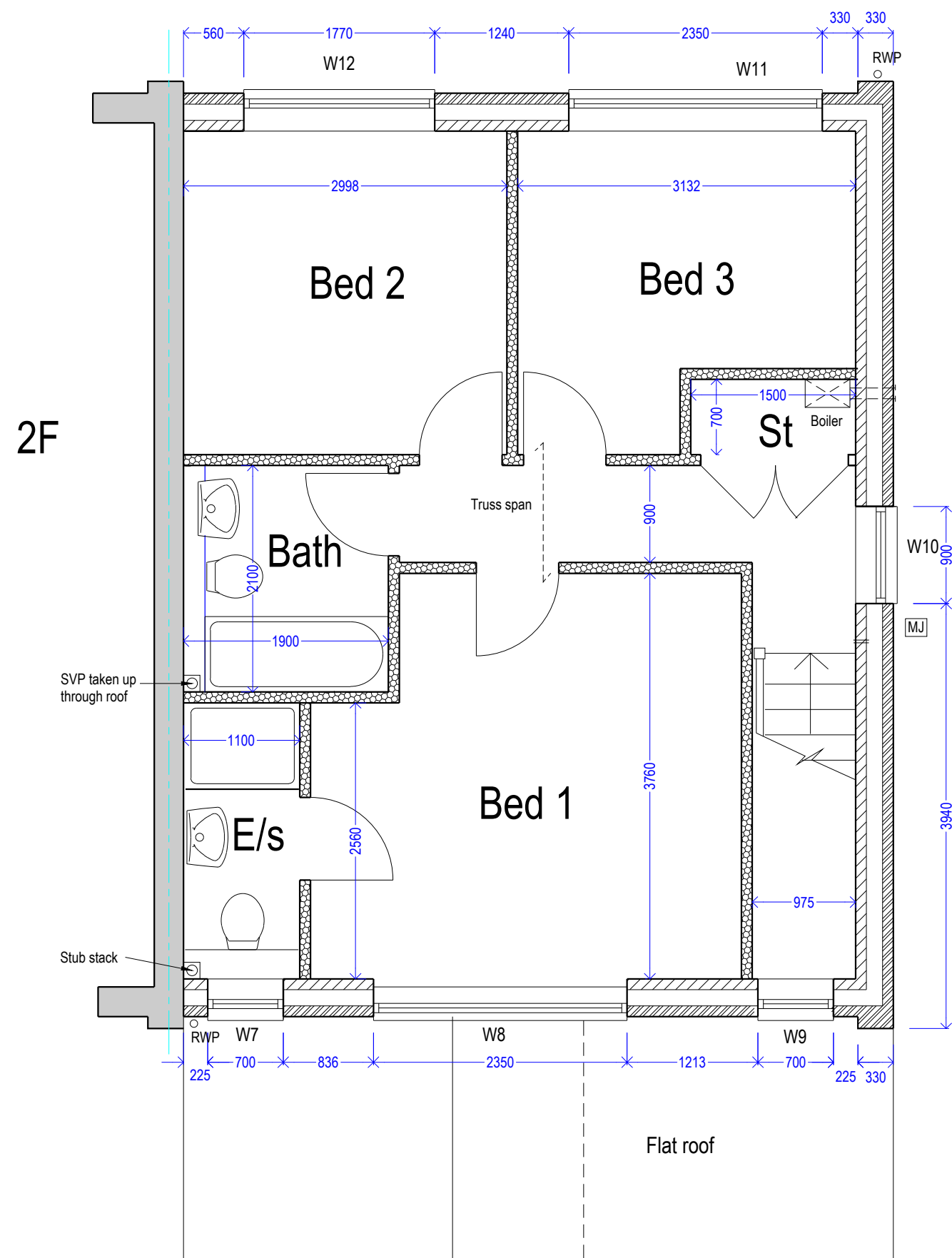

- KEY
- Beam and block floor span by specialist
  - Joist direction to floor over.
  - Location of vertical movement joint to inner leaf all as detail
  - 3.6N/mm block wall
  - Stud partition



First

Plans

New dwelling and alterations to existing  
2f Beacons Close, Uxbridge, UB8 1PX  
For Kearns Developments Ltd

HDA  
ARCHITECTURE

8 LIME GROVE, BUGBROOKE  
NORTHAMPTON  
NN7 3QZ  
TEL: 01604 622226  
71 BRUNSWICK ROAD  
EALING  
LONDON W5 1AQ  
TEL: 020 3592 4198

SCALE 1:100 (A2)	DATE 6/23	DRN/CHD IB
DRG NO 23013/11 P3		