

Proposed Section A-A _ scale 1:50 @ A1

Copyright © Studio136 Ltd

This drawing which is the property of Studio 136 Ltd is the subject of Intellectual Property Rights including copyright and design right and shall not be reproduced, copied, loaned or submitted to any other party without the written consent of Studio 136 Ltd.

Any discrepancies to be reported to Studio 136 Ltd prior to setting out or ordering of any materials.

Notes:

All new materials to match existing..

New casement window sizes to be confirmed with client on site.

Proposed staircase is shown as a guide. Exact layout and dimensions is to be confirmed by the staircase company and the Building Control on site.

Plans may change after Contract is Signed subject to Final Design and Specific Structural Engineer Specifications.

The Contractor should check all dimensions on site prior to ordering materials or fitting any steel beams/timber joists.

Exact position and size of all chimney stacks/breasts to be confirmed on site prior to ordering materials. In case the proposed structure is affected, the Contractor should seek report back to the Engineer or Architect.

General Notes on Layout and Furniture:

Please note furniture, beds, kitchens and cupboard shown are for illustration purposes only.

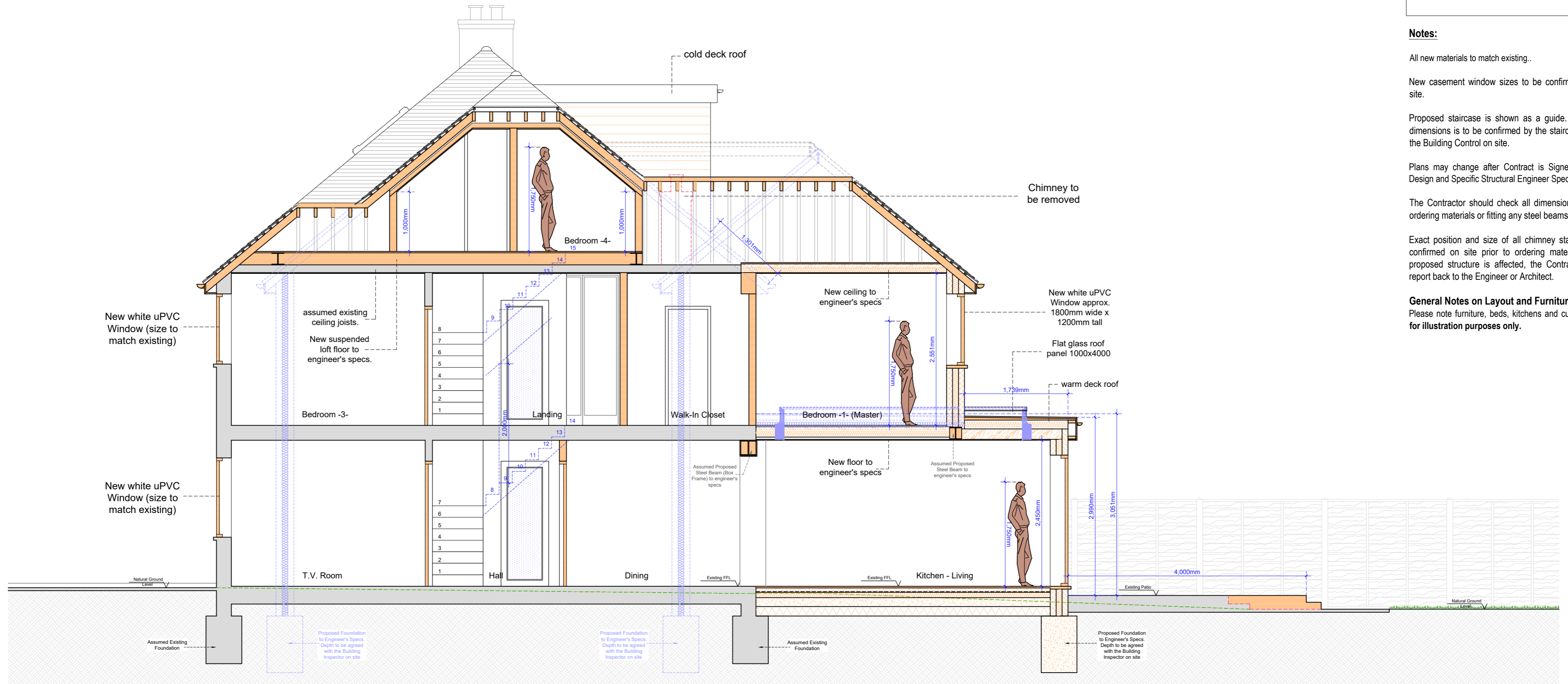

PROPOSED SECTION A-A

KEYS

	Head height < 1.8m
	demolition
	Cavity Walls
	Proposed
	Original

VOLUME CALCULATIONS

Volume of Hip to Gable Conversion

$$V = (D \times \frac{1}{2} L) \times \frac{1}{3} E = (9.159 \times \frac{1}{2} 4.579) \times \frac{1}{3} 3.793 = \mathbf{26.51m^3}$$

Volume of Dormer

$$V = (B \times \frac{1}{2} C) \times A = (2.476 \times \frac{1}{2} 2.990) \times 4.692 = \mathbf{17.37m^3}$$

$$\mathbf{TOTAL VOLUME = 26.51 + 17.37 = 43.88m^3}$$

0 1m 2m 3m 4m 5m

Scale Bar @1:100

0 1m 2m 3m

Scale Bar @1:50

studio
136 architects

6 The Broadway, Wembley, Middlesex, HA9 8JT

Tel/Fax: 020 8907 7131

e-mail: info@studio136.co.uk

Project

Two storey side and part rear extension, part single storey rear extension, loft conversion and internal alterations AT
55 LONG DRIVE
RUISLIP
HA4 0HN

Client
Ms. Mariyah Ebrahim
55 LONG DRIVE
RUISLIP
HA4 0HN

Drawing Title

PROPOSED SECTION A-A

Scale	Drawn	Checked	Authorised
1:50@A2	--	--	--
	4th October 2024	--	--

Drawing Number	Rev
ST_24_55LONGDRIVE_08	A