

510200

510400

510600



Historical Aerial Photography

Published 1999

This aerial photography was produced by Getmapping, these vertical aerial photographs provide a seamless, full colour survey of the whole of Great Britain



Historical Aerial Photography - Segment A13

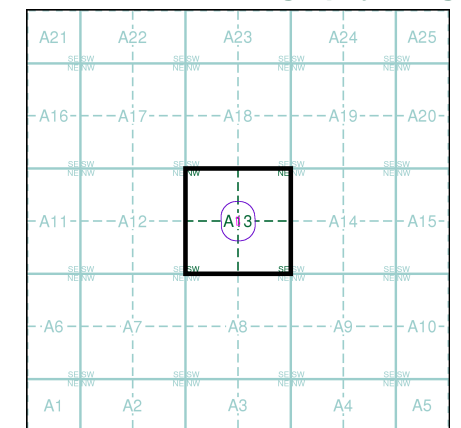

Order Details

Order Number: 394055057_1_1
 Customer Ref: 25-262.01
 National Grid Reference: 510420, 189230
 Slice: A
 Site Area (Ha): 0.1
 Search Buffer (m): 100

Site Details

Garage Court, r/o 66-74 Farmlands, Joel Street, Pinner, HA5 2LN



Tel: 0844 844 9952
 Fax: 0844 844 9951
 Web: www.envirocheck.co.uk

Historical Mapping Legends

Ordnance Survey County Series 1:10,560

	Gravel Pit		Sand Pit		Other Pits
	Quarry		Shingle		Orchard
	Osiers		Reeds		Marsh
	Mixed Wood		Deciduous		Brushwood
	Fir		Furze		Rough Pasture
	Arrow denotes flow of water		Trigonometrical Station		
	Site of Antiquities		Bench Mark		
	Pump, Guide Post, Signal Post		Well, Spring, Boundary Post		
	-285 Surface Level				
	Sketched Contour		Instrumental Contour		
	Main Roads		Minor Roads		
	Sunken Road		Raised Road		
	Road over Railway		Railway over River		
	Railway over Road		Level Crossing		
	Road over River or Canal		Road over Stream		
	Road over Stream				
	County Boundary (Geographical)				
	County & Civil Parish Boundary				
	Administrative County & Civil Parish Boundary				
	County Borough Boundary (England)				
	County Burgh Boundary (Scotland)				
	Rural District Boundary				
	Civil Parish Boundary				

Ordnance Survey Plan 1:10,000

	Chalk Pit, Clay Pit or Quarry		Gravel Pit
	Sand Pit		Disused Pit or Quarry
	Refuse or Slag Heap		Lake, Loch or Pond
	Dunes		Boulders
	Coniferous Trees		Non-Coniferous Trees
	Orchard		Scrub
	Coppice		Bracken
	Heath		Rough Grassland
	Marsh		Reeds
	Saltings		
	Building		Glasshouse
	Sloping Masonry		Pylon
	Electricity Transmission Line		Pole
	Cutting		Embankment
	Standard Gauge Multiple Track		Standard Gauge Single Track
	Siding, Tramway or Mineral Line		Narrow Gauge
	Geographical County		
	Administrative County, County Borough or County of City		
	Municipal Borough, Urban or Rural District, Burgh or District Council		
	Borough, Burgh or County Constituency Shown only when not coincident with other boundaries		
	Civil Parish Shown alternately when coincidence of boundaries occurs		
	BP, BS Boundary Post or Stone		Pol Sta Police Station
	Ch Church		PO Post Office
	CH Club House		PC Public Convenience
	F E Sta Fire Engine Station		PH Public House
	FB Foot Bridge		SB Signal Box
	Fn Fountain		Spr Spring
	GP Guide Post		TCB Telephone Call Box
	MP Mile Post		TCP Telephone Call Post
	MS Mile Stone		W Well

1:10,000 Raster Mapping

	Gravel Pit		Refuse tip or slag heap
	Rock		Rock (scattered)
	Boulders		Boulders (scattered)
	Shingle		Mud
	Sand		Sand Pit
	Slopes		Top of cliff
	General detail		Underground detail
	Overhead detail		Narrow gauge railway
	Multi-track railway		Single track railway
	County boundary (England only)		Civil, parish or community boundary
	District, Unitary, Metropolitan, London Borough boundary		Constituency boundary
	Area of wooded vegetation		Non-coniferous trees
	Non-coniferous trees (scattered)		Coniferous trees
	Coniferous trees (scattered)		Positioned tree
	Orchard		Coppice or Osiers
	Rough Grassland		Heath
	Scrub		Marsh, Salt Marsh or Reeds
	Water feature		Flow arrows
	MHW(S) Mean high water (springs)		MLW(S) Mean low water (springs)
	Telephone line (where shown)		Electricity transmission line (with poles)
	Bench mark (where shown)		Triangulation station
	Point feature (e.g. Guide Post or Mile Stone)		Pylon, flare stack or lighting tower
	Site of (antiquity)		Glasshouse
	General Building		Important Building



Historical Mapping & Photography included:

Mapping Type	Scale	Date	Pg
Middlesex	1:10,560	1868	3
Buckinghamshire	1:10,560	1883	4
Middlesex	1:10,560	1897	5
Middlesex	1:10,560	1916	6
Middlesex	1:10,560	1916	7
Middlesex	1:10,560	1935	8
Middlesex	1:10,560	1935	9
Middlesex	1:10,560	1938	10
Middlesex	1:10,560	1938	11
Historical Aerial Photography	1:10,560	1948 - 1950	12
Ordnance Survey Plan	1:10,000	1960	13
Ordnance Survey Plan	1:10,000	1965 - 1968	14
Ordnance Survey Plan	1:10,000	1975 - 1976	15
London	1:25,000	1985	16
Ordnance Survey Plan	1:10,000	1989	17
Ordnance Survey Plan	1:10,000	1990 - 1993	18
10K Raster Mapping	1:10,000	1999	19
10K Raster Mapping	1:10,000	2006	20
VectorMap Local	1:10,000	2025	21

Historical Map - Slice A

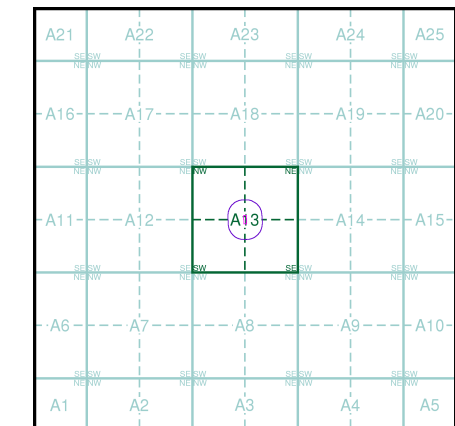

Order Details

Order Number: 394055057_1_1
 Customer Ref: 25-262.01
 National Grid Reference: 510420, 189230
 Slice: A
 Site Area (Ha): 0.1
 Search Buffer (m): 1000

Site Details

Garage Court, r/o 66-74 Farmlands, Joel Street, Pinner, HA5 2LN

Landmark
 INFORMATION GROUP

Tel: 0844 844 9952
 Fax: 0844 844 9951
 Web: www.envirocheck.co.uk

Russian Military Mapping Legends

1:5,000 and 1:10,000 mapping

a. Not drawn to scale b. Drawn to scale

Government and Administrative Buildings

Military and Industrial Buildings

Military and Communication Areas

Subway Entrance

Fireproof Building

Prominent Fireproof Building

Non-fireproof Building

Non-fireproof Building (non-dwelling)

Factory, mill, and flour mill, with chimneys

Factory, mill, and flour mill, without chimneys

Power Station, drawn to scale

Hydroelectric Power Station

Radio Station, drawn to scale

Telephone Station, drawn to scale

Abandoned Open-pit Mine or Quarry

Open-pit Salt Mine

Pit

Oil Deposit or Well

Oil Seepage

Tailings Pile

Fuel Storage Tanks

Natural Gas Tank

Bench Mark

Drill Hole

Burial Mound

Triangulation Point on Burial Mound

Fill

Cut

Small Bridge

Double-track Railroad and Station Building

Single-track Railroad

Coniferous Forest

Deciduous Forest

Mixed Forest

Lawns

Citrus Orchard

Wet Ground

Scattered Vegetation

243,8 Values for prominent elevations

186.0 Numbers for spot elevations, depth soundings, contour lines, etc.

0,2 Velocity of the current, width of river bed, depth of river

$\frac{180}{12}$ $\frac{180}{12}$ Fractional terms: length and capacity of bridges; depth of fords and condition of the river bottom; height of forest and the diameter of trees

Russian Alphabet (For reference and phonetic interpretation of map text)

А а (A)	З з (Z)	П п (P)	Ч ч (CH)
Б б (B)	И и (I)	Р р (R)	Ш ш (SH)
В в (V)	Й й (Y)	С с (S)	Щ щ (SHCH)
Г г (G)	К к (K)	Т т (T)	Ъ (-)
Д д (D)	Л л (L)	У у (U)	Ы (Y)
Е е (E)	М м (M)	Ф ф (F)	Ь (')
Ё ё (YO)	Н н (N)	Х х (KH)	Э э (E)
Ж ж (ZH)	О о (O)	Ц ц (TS)	Ю ю (YU or IU)
			Я я (YA or IA)

1:25,000 mapping

a. Not drawn to scale b. Drawn to scale

Government and Administrative Buildings

Military and Industrial Buildings

Military and Communication Areas

Subway Entrance

Partly Demolished Buildings

Demolished Buildings

Built-Up Area with Fireproof Buildings Predominant

Built-Up Area with Non-Fireproof Buildings Predominant

Individual Fireproof Building

Prominent Industrial Building

Individual Dwelling, Fireproof

Ruins of an Individual Dwelling

Factory or Mill Chimney

Factory or Mill with Chimney

Factory or Mill without Chimney

Mine or Open Pit Mine

Operating Shaft or Mine

Non-Operating Shaft or Mine

Salt Mine

Tailings Pile

Pit

Stone Quarry

Gas Pump or Service Station

Fuel Storage or Natural Gas Tank

Oil or Natural Gas Derrick

Small Hydroelectric Power Station

Power Station

Transformer Station

Cemetery

Burial Mound (height in metres)

Triangulation Point on Burial Mound

Triangulation Point

Bench Mark

Bench Mark (monumented)

Telegraph Office

Telephone Station

Radio Station

Radio Tower

Airfield or Seaplane Base

Landing Strip

Cut

Fill

Km Post

Plantings

Telegraph/Telephone Lines

Main Highway

Highway under Construction

Improved Dirt Road (former truck road)

Width of Road

Steep Grade

Small Bridge

Pipe (Culvert)

Tunnel

Dismantled Railroad

Double-track Railroad with First Class Station

Railroad Under Construction

Shore Embankment

River or Ditch with Embankment

Direction and velocity of current

Water Gauge

Water Level Mark

Well

Water Reservoir or Rain Water Pit

Spring

Isobath with value

Heavy (Index) Contour Line

Contour Line and Value

Half Contour Line

Spot Elevation Value

Coniferous

Deciduous

Mixed

Scrub

Key to Numbers on Mapping



Historical Mapping & Photography included:

Mapping Type	Scale	Date	Pg
Middlesex	1:10,560	1868	3
Buckinghamshire	1:10,560	1883	4
Middlesex	1:10,560	1897	5
Middlesex	1:10,560	1916	6
Middlesex	1:10,560	1916	7
Middlesex	1:10,560	1935	8
Middlesex	1:10,560	1935	9
Middlesex	1:10,560	1938	10
Middlesex	1:10,560	1938	11
Historical Aerial Photography	1:10,560	1948 - 1950	12
Ordnance Survey Plan	1:10,000	1960	13
Ordnance Survey Plan	1:10,000	1965 - 1968	14
Ordnance Survey Plan	1:10,000	1975 - 1976	15
London	1:25,000	1985	16
Ordnance Survey Plan	1:10,000	1989	17
Ordnance Survey Plan	1:10,000	1990 - 1993	18
10K Raster Mapping	1:10,000	1999	19
10K Raster Mapping	1:10,000	2006	20
VectorMap Local	1:10,000	2025	21

Russian Map - Slice A

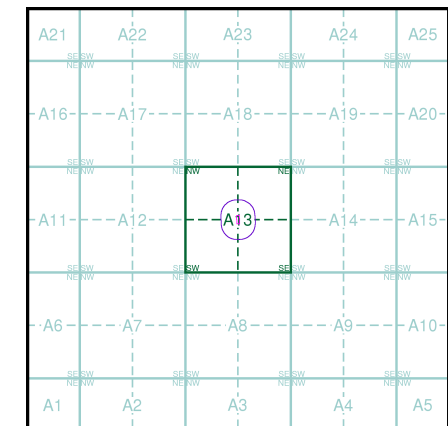

Order Details

Order Number: 394055057_1_1
 Customer Ref: 25-262.01
 National Grid Reference: 510420, 189230
 Slice: A
 Site Area (Ha): 0.1
 Search Buffer (m): 1000

Site Details

Garage Court, r/o 66-74 Farmlands, Joel Street, Pinner, HA5 2LN



Tel: 0844 844 9952
 Fax: 0844 844 9951
 Web: www.envirocheck.co.uk

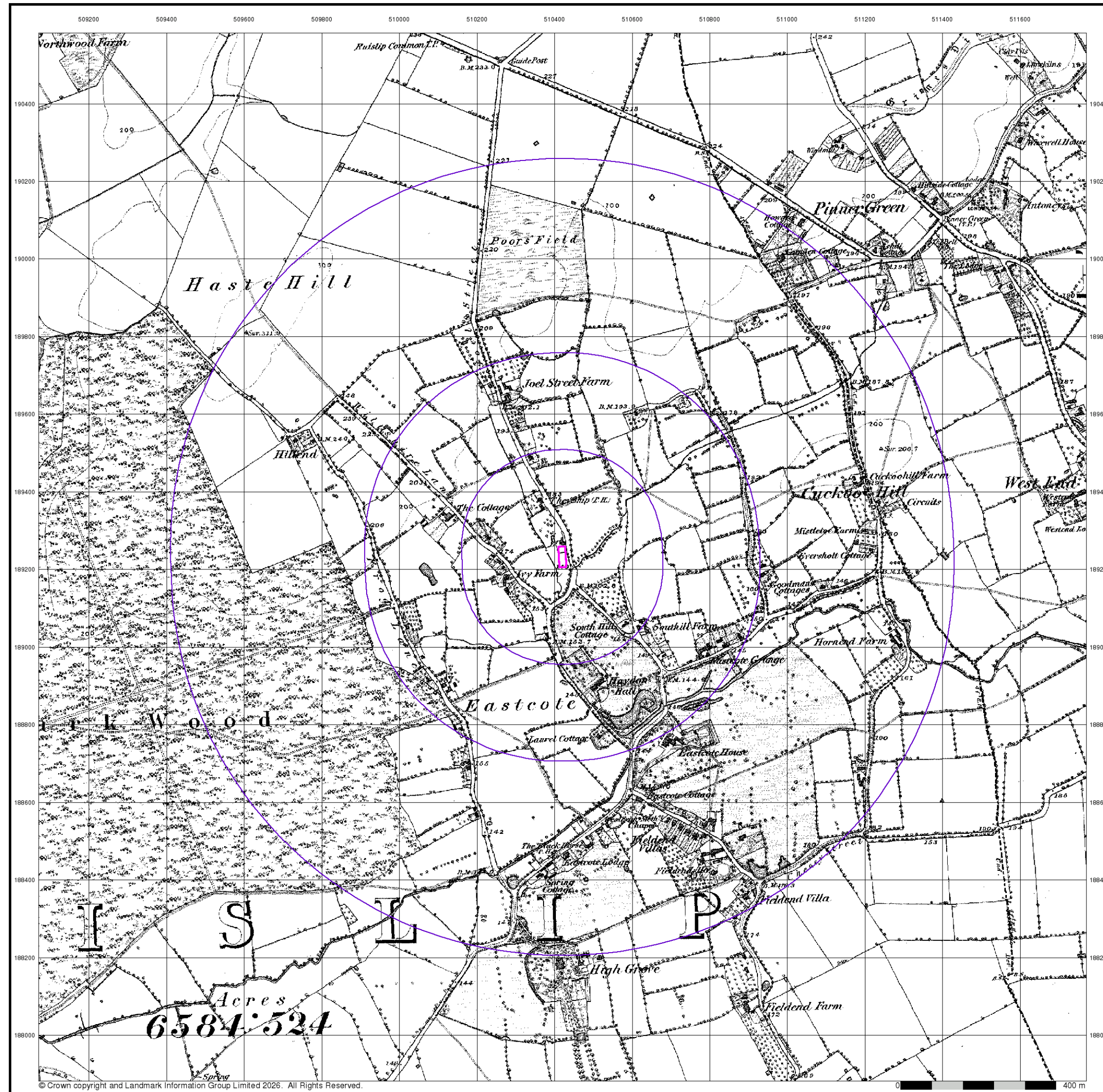

Middlesex
Published 1868
Source map scale - 1:10,560

The historical maps shown were reproduced from maps predominantly held at the scale adopted for England, Wales and Scotland in the 1840's. In 1854 the 1:2,500 scale was adopted for mapping urban areas; these maps were used to update the 1:10,560 maps. The published date given therefore is often some years later than the surveyed date. Before 1938, all OS maps were based on the Cassini Projection, with independent surveys of a single county or group of counties, giving rise to significant inaccuracies in outlying areas. In the late 1940's, a Provisional Edition was produced, which updated the 1:10,560 mapping from a number of sources. The maps appear unfinished - with all military camps and other strategic sites removed. These maps were initially overprinted with the National Grid. In 1970, the first 1:10,000 maps were produced using the Transverse Mercator Projection. The revision process continued until recently, with new editions appearing every 10 years or so for urban areas.

Map Name(s) and Date(s)

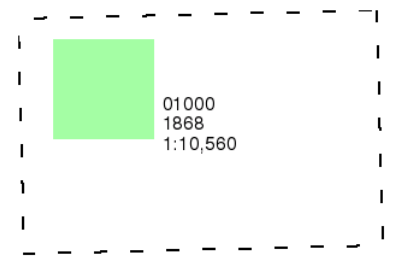

Historical Map - Slice A

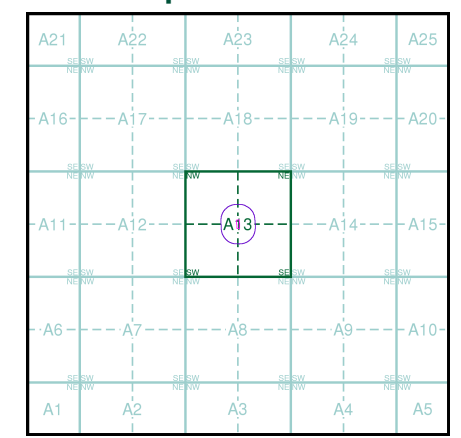

Order Details

Order Number: 394055057_1_1
 Customer Ref: 25-262.01
 National Grid Reference: 510420, 189230
 Slice: A
 Site Area (Ha): 0.1
 Search Buffer (m): 1000

Site Details

Garage Court, r/o 66-74 Farmlands, Joel Street, Pinner, HA5 2LN



Tel: 0844 844 9952
 Fax: 0844 844 9951
 Web: www.envirocheck.co.uk

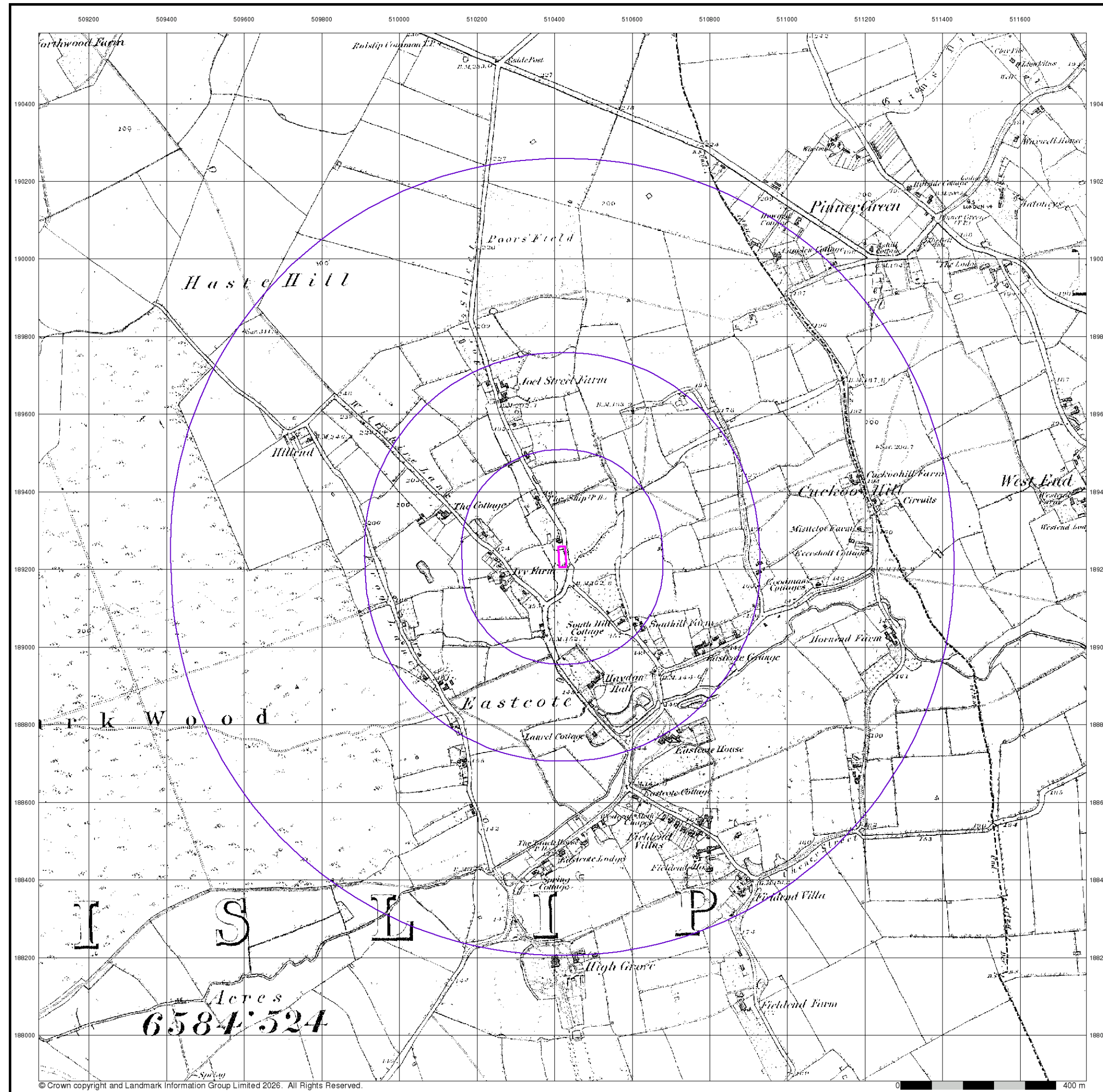

Buckinghamshire
Published 1883
Source map scale - 1:10,560

The historical maps shown were reproduced from maps predominantly held at the scale adopted for England, Wales and Scotland in the 1840's. In 1854 the 1:2,500 scale was adopted for mapping urban areas; these maps were used to update the 1:10,560 maps. The published date given therefore is often some years later than the surveyed date. Before 1938, all OS maps were based on the Cassini Projection, with independent surveys of a single county or group of counties, giving rise to significant inaccuracies in outlying areas. In the late 1940's, a Provisional Edition was produced, which updated the 1:10,560 mapping from a number of sources. The maps appear unfinished - with all military camps and other strategic sites removed. These maps were initially overprinted with the National Grid. In 1970, the first 1:10,000 maps were produced using the Transverse Mercator Projection. The revision process continued until recently, with new editions appearing every 10 years or so for urban areas.

Map Name(s) and Date(s)

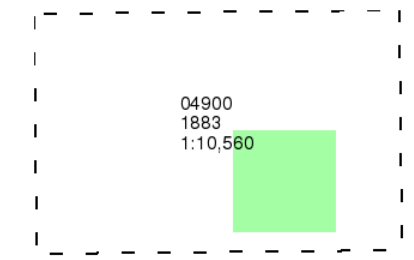

Historical Map - Slice A

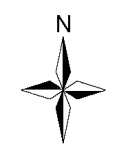
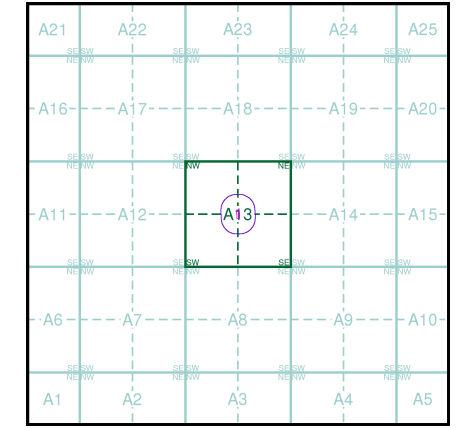

Order Details
 Order Number: 394055057_1_1
 Customer Ref: 25-262.01
 National Grid Reference: 510420, 189230
 Slice: A
 Site Area (Ha): 0.1
 Search Buffer (m): 1000

Site Details
 Garage Court, r/o 66-74 Farmlands, Joel Street, Pinner, HA5 2LN

Landmark
 INFORMATION GROUP
 Tel: 0844 844 9952
 Fax: 0844 844 9951
 Web: www.envirocheck.co.uk

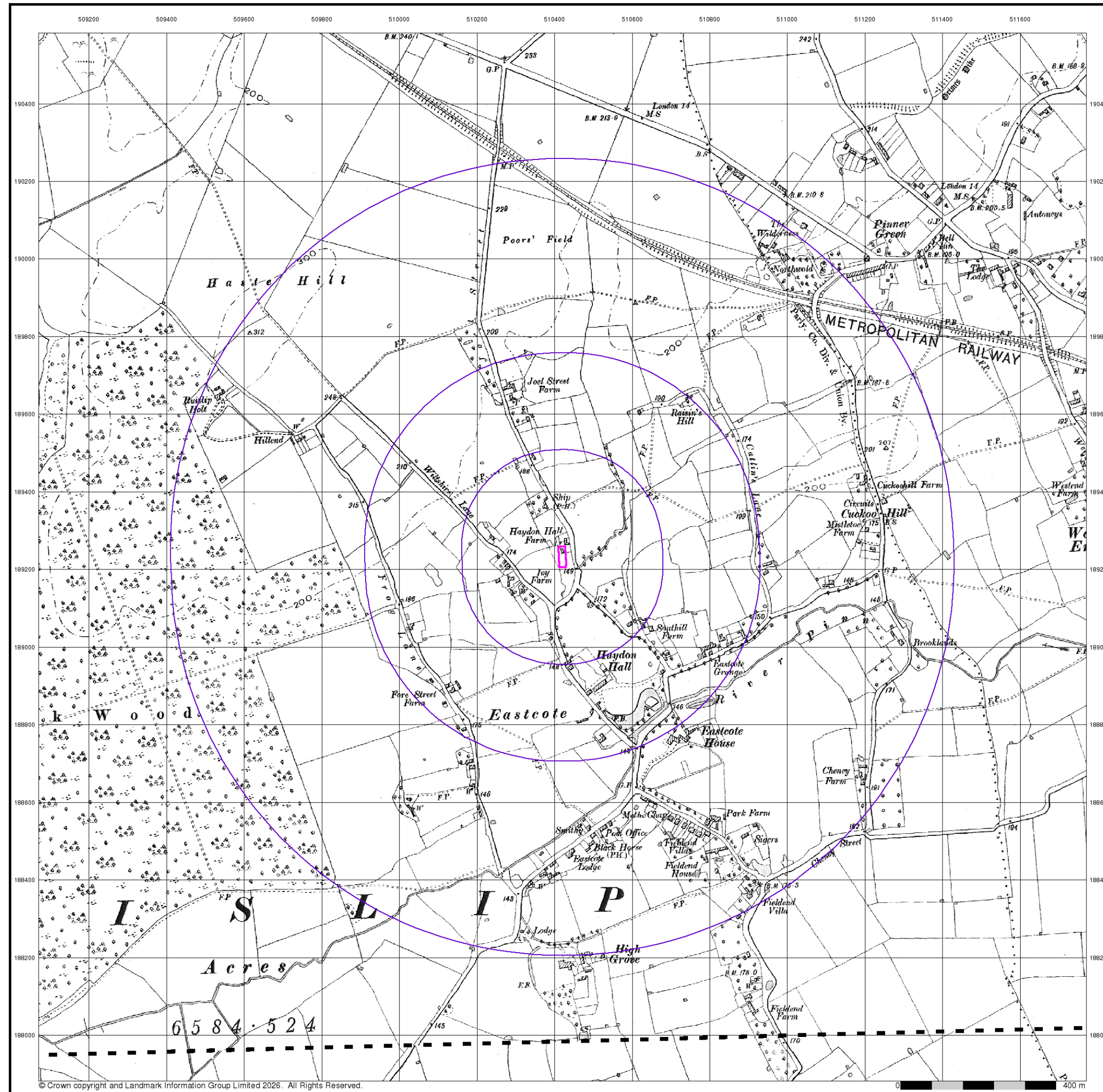

Middlesex
Published 1897
Source map scale - 1:10,560

The historical maps shown were reproduced from maps predominantly held at the scale adopted for England, Wales and Scotland in the 1840's. In 1854 the 1:2,500 scale was adopted for mapping urban areas; these maps were used to update the 1:10,560 maps. The published date given therefore is often some years later than the surveyed date. Before 1938, all OS maps were based on the Cassini Projection, with independent surveys of a single county or group of counties, giving rise to significant inaccuracies in outlying areas. In the late 1940's, a Provisional Edition was produced, which updated the 1:10,560 mapping from a number of sources. The maps appear unfinished - with all military camps and other strategic sites removed. These maps were initially overprinted with the National Grid. In 1970, the first 1:10,000 maps were produced using the Transverse Mercator Projection. The revision process continued until recently, with new editions appearing every 10 years or so for urban areas.

Map Name(s) and Date(s)

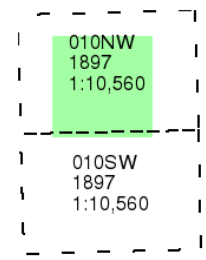

Historical Map - Slice A

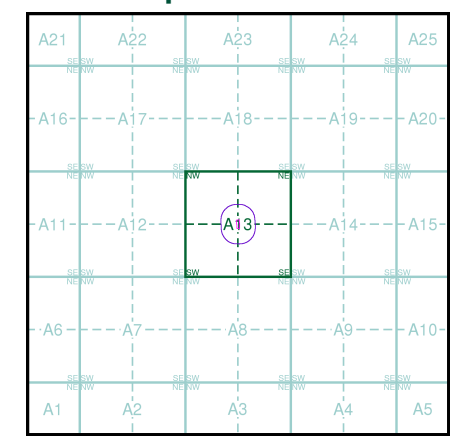

Order Details

Order Number: 394055057_1_1
 Customer Ref: 25-262.01
 National Grid Reference: 510420, 189230
 Slice: A
 Site Area (Ha): 0.1
 Search Buffer (m): 1000

Site Details

Garage Court, r/o 66-74 Farmlands, Joel Street, Pinner, HA5 2LN



Tel: 0844 844 9952
 Fax: 0844 844 9951
 Web: www.envirocheck.co.uk

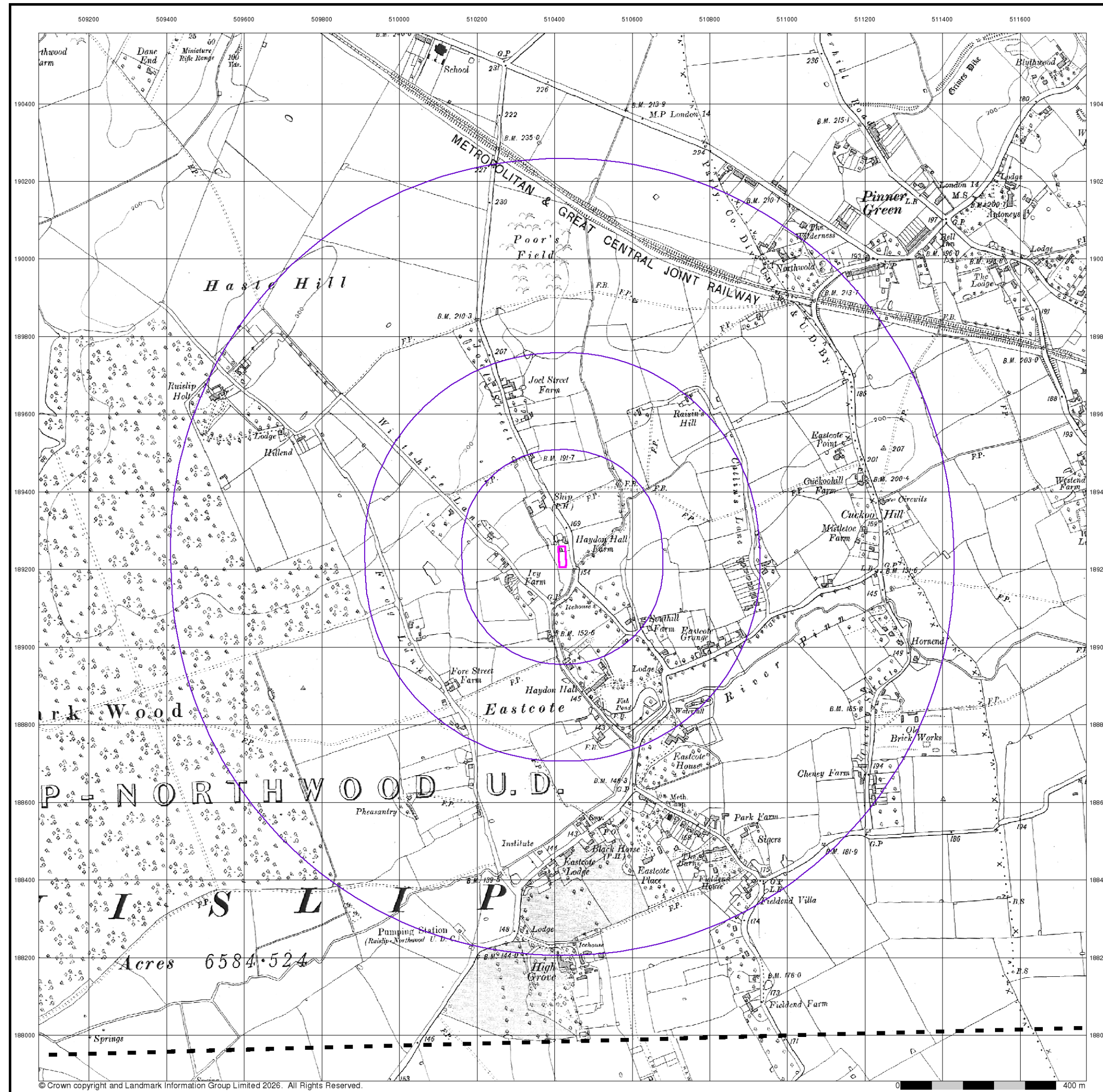

Middlesex
Published 1916
Source map scale - 1:10,560

The historical maps shown were reproduced from maps predominantly held at the scale adopted for England, Wales and Scotland in the 1840's. In 1854 the 1:2,500 scale was adopted for mapping urban areas; these maps were used to update the 1:10,560 maps. The published date given therefore is often some years later than the surveyed date. Before 1938, all OS maps were based on the Cassini Projection, with independent surveys of a single county or group of counties, giving rise to significant inaccuracies in outlying areas. In the late 1940's, a Provisional Edition was produced, which updated the 1:10,560 mapping from a number of sources. The maps appear unfinished - with all military camps and other strategic sites removed. These maps were initially overprinted with the National Grid. In 1970, the first 1:10,000 maps were produced using the Transverse Mercator Projection. The revision process continued until recently, with new editions appearing every 10 years or so for urban areas.

Map Name(s) and Date(s)

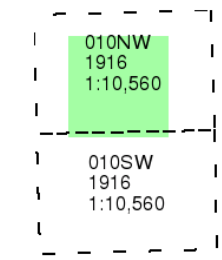

Historical Map - Slice A

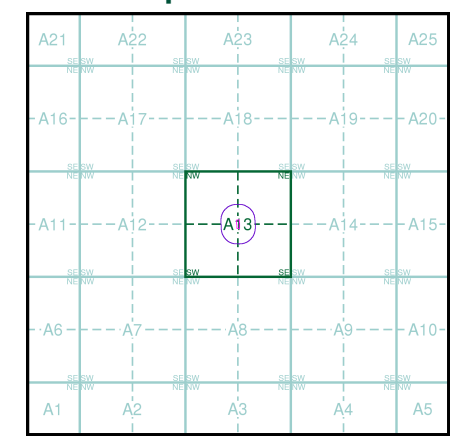

Order Details
 Order Number: 394055057_1_1
 Customer Ref: 25-262.01
 National Grid Reference: 510420, 189230
 Slice: A
 Site Area (Ha): 0.1
 Search Buffer (m): 1000

Site Details
 Garage Court, r/o 66-74 Farmlands, Joel Street, Pinner, HA5 2LN

Landmark
 INFORMATION GROUP
 Tel: 0844 844 9952
 Fax: 0844 844 9951
 Web: www.envirocheck.co.uk

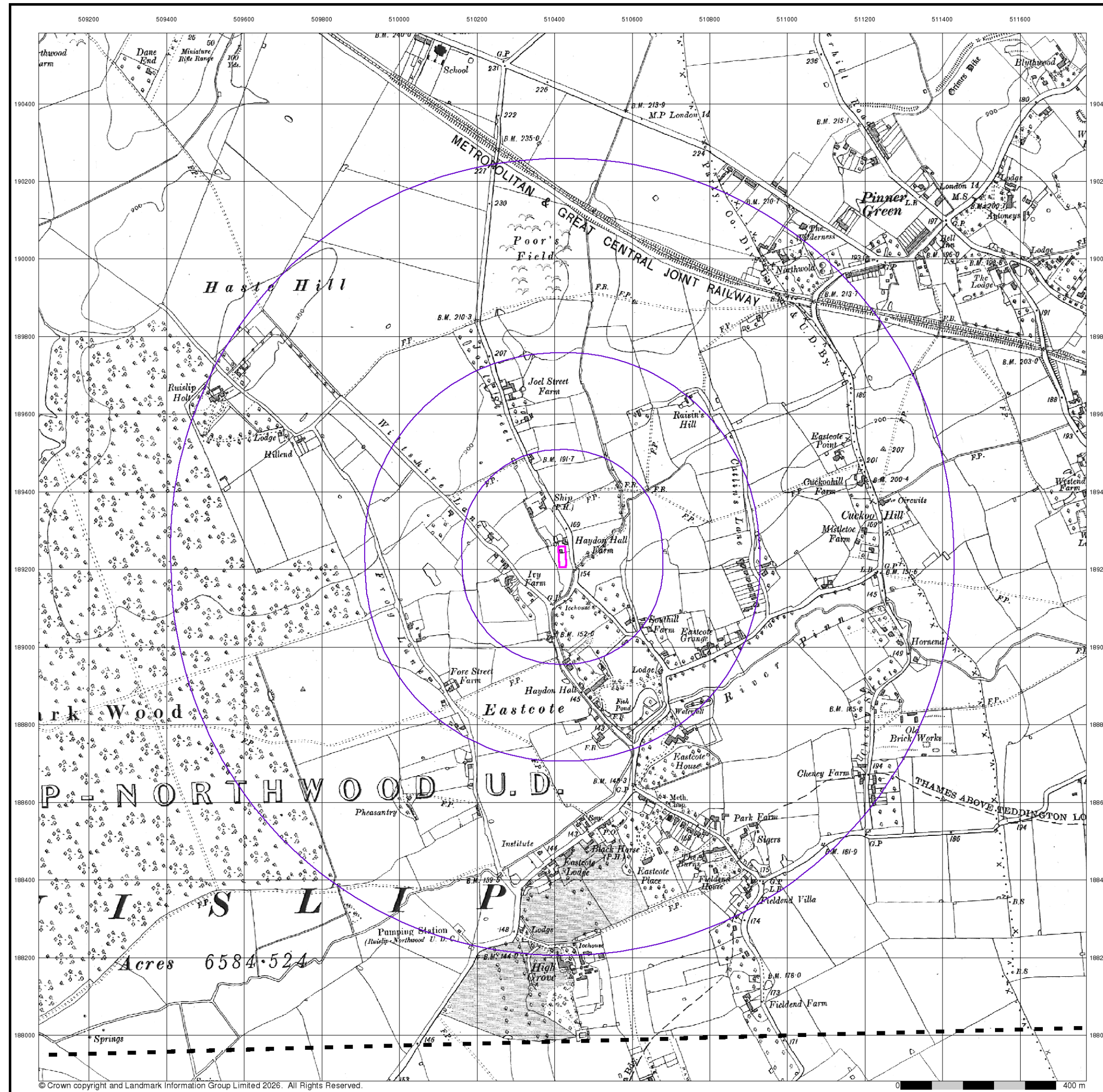

Middlesex
Published 1916
Source map scale - 1:10,560

The historical maps shown were reproduced from maps predominantly held at the scale adopted for England, Wales and Scotland in the 1840's. In 1854 the 1:2,500 scale was adopted for mapping urban areas; these maps were used to update the 1:10,560 maps. The published date given therefore is often some years later than the surveyed date. Before 1938, all OS maps were based on the Cassini Projection, with independent surveys of a single county or group of counties, giving rise to significant inaccuracies in outlying areas. In the late 1940's, a Provisional Edition was produced, which updated the 1:10,560 mapping from a number of sources. The maps appear unfinished - with all military camps and other strategic sites removed. These maps were initially overprinted with the National Grid. In 1970, the first 1:10,000 maps were produced using the Transverse Mercator Projection. The revision process continued until recently, with new editions appearing every 10 years or so for urban areas.

Map Name(s) and Date(s)

010NW	1916	1:10,560
010SW	1916	1:10,560

Historical Map - Slice A

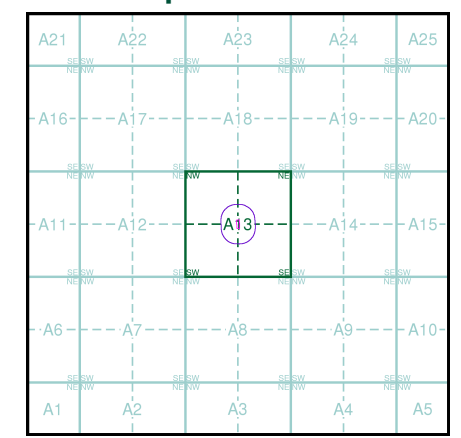

Order Details
 Order Number: 394055057_1_1
 Customer Ref: 25-262.01
 National Grid Reference: 510420, 189230
 Slice: A
 Site Area (Ha): 0.1
 Search Buffer (m): 1000

Site Details
 Garage Court, r/o 66-74 Farmlands, Joel Street, Pinner, HA5 2LN

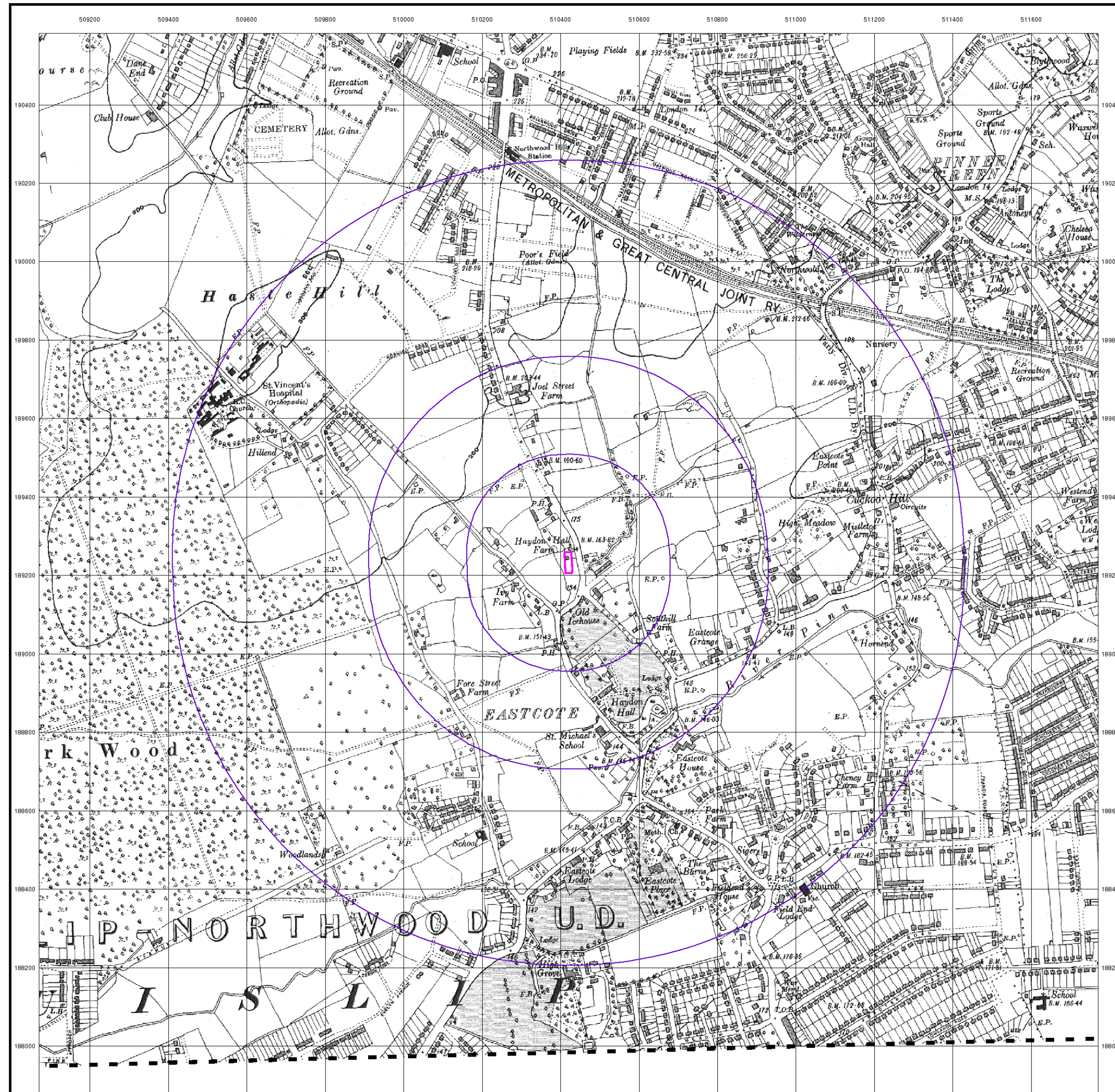

Middlesex
Published 1935
Source map scale - 1:10,560

The historical maps shown were reproduced from maps predominantly held at the scale adopted for England, Wales and Scotland in the 1840's. In 1854 the 1:2,500 scale was adopted for mapping urban areas; these maps were used to update the 1:10,560 maps. The published date given therefore is often some years later than the surveyed date. Before 1938, all OS maps were based on the Cassini Projection, with independent surveys of a single county or group of counties, giving rise to significant inaccuracies in outlying areas. In the late 1940's, a Provisional Edition was produced, which updated the 1:10,560 mapping from a number of sources. The maps appear unfinished - with all military camps and other strategic sites removed. These maps were initially overprinted with the National Grid. In 1970, the first 1:10,000 maps were produced using the Transverse Mercator Projection. The revision process continued until recently, with new editions appearing every 10 years or so for urban areas.

Map Name(s) and Date(s)

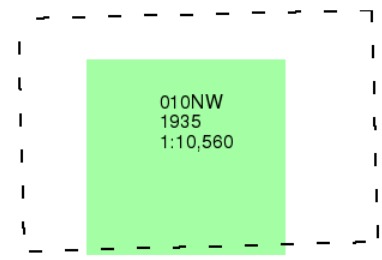

Historical Map - Slice A

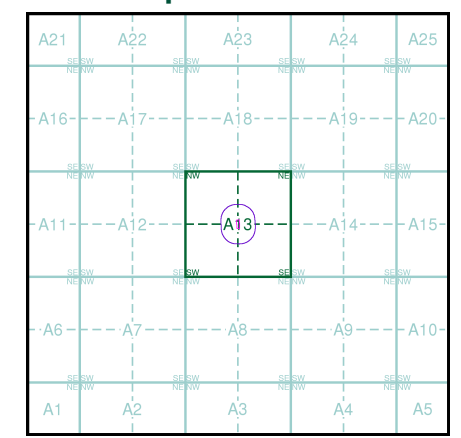

Order Details

Order Number: 394055057_1_1
 Customer Ref: 25-262.01
 National Grid Reference: 510420, 189230
 Slice: A
 Site Area (Ha): 0.1
 Search Buffer (m): 1000

Site Details

Garage Court, r/o 66-74 Farmlands, Joel Street, Pinner, HA5 2LN



Tel: 0844 844 9952
 Fax: 0844 844 9951
 Web: www.envirocheck.co.uk

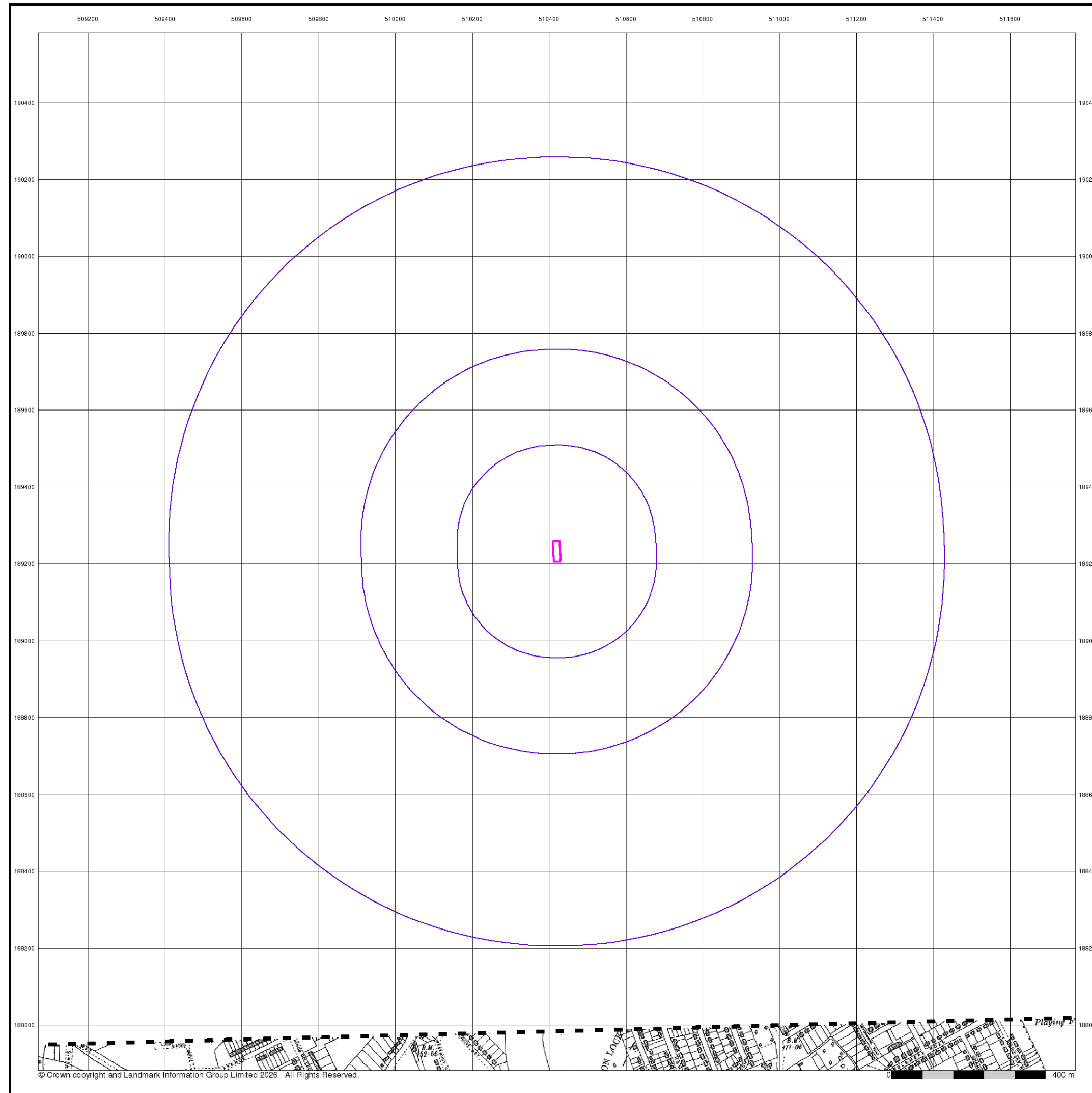

Middlesex

Published 1935

Source map scale - 1:10,560

The historical maps shown were reproduced from maps predominantly held at the scale adopted for England, Wales and Scotland in the 1840's. In 1854 the 1:2,500 scale was adopted for mapping urban areas; these maps were used to update the 1:10,560 maps. The published date given therefore is often some years later than the surveyed date. Before 1938, all OS maps were based on the Cassini Projection, with independent surveys of a single county or group of counties, giving rise to significant inaccuracies in outlying areas. In the late 1940's, a Provisional Edition was produced, which updated the 1:10,560 mapping from a number of sources. The maps appear unfinished - with all military camps and other strategic sites removed. These maps were initially overprinted with the National Grid. In 1970, the first 1:10,000 maps were produced using the Transverse Mercator Projection. The revision process continued until recently, with new editions appearing every 10 years or so for urban areas.

Map Name(s) and Date(s)

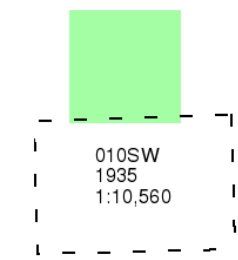

Historical Map - Slice A

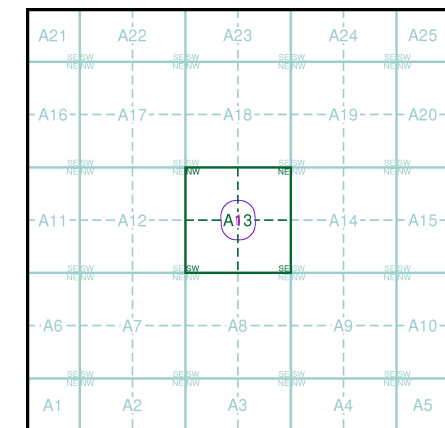

Order Details

Order Number: 394055057_1_1
 Customer Ref: 25-262.01
 National Grid Reference: 510420, 189230
 Slice: A
 Site Area (Ha): 0.1
 Search Buffer (m): 1000

Site Details

Garage Court, r/o 66-74 Farmlands, Joel Street, Pinner, HA5 2LN



Tel: 0844 844 9952
 Fax: 0844 844 9951
 Web: www.envirocheck.co.uk

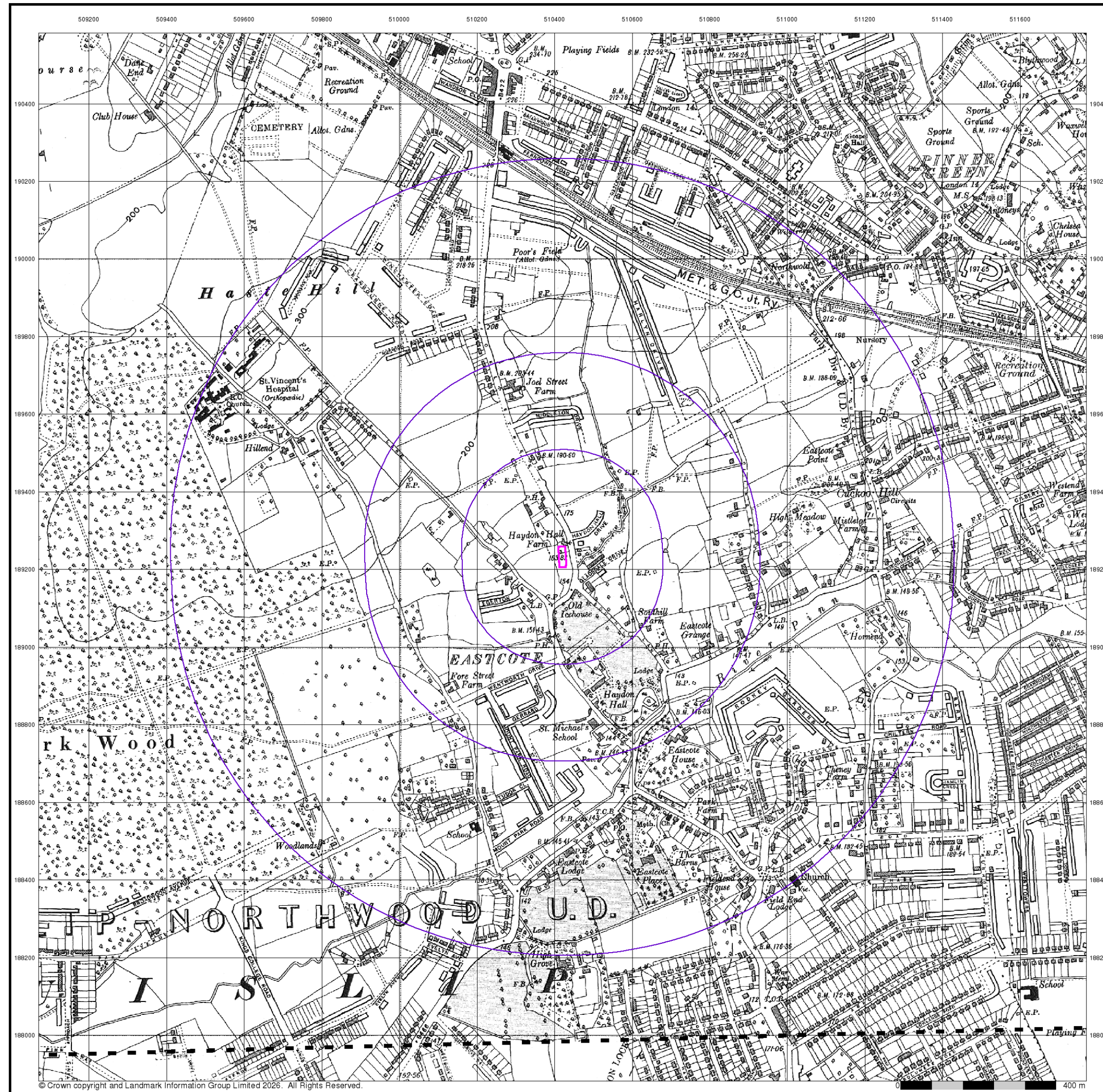

Middlesex
Published 1938
Source map scale - 1:10,560

The historical maps shown were reproduced from maps predominantly held at the scale adopted for England, Wales and Scotland in the 1840's. In 1854 the 1:2,500 scale was adopted for mapping urban areas; these maps were used to update the 1:10,560 maps. The published date given therefore is often some years later than the surveyed date. Before 1938, all OS maps were based on the Cassini Projection, with independent surveys of a single county or group of counties, giving rise to significant inaccuracies in outlying areas. In the late 1940's, a Provisional Edition was produced, which updated the 1:10,560 mapping from a number of sources. The maps appear unfinished - with all military camps and other strategic sites removed. These maps were initially overprinted with the National Grid. In 1970, the first 1:10,000 maps were produced using the Transverse Mercator Projection. The revision process continued until recently, with new editions appearing every 10 years or so for urban areas.

Map Name(s) and Date(s)

010NW	1938	1:10,560
010SW	1938	1:10,560

Historical Map - Slice A

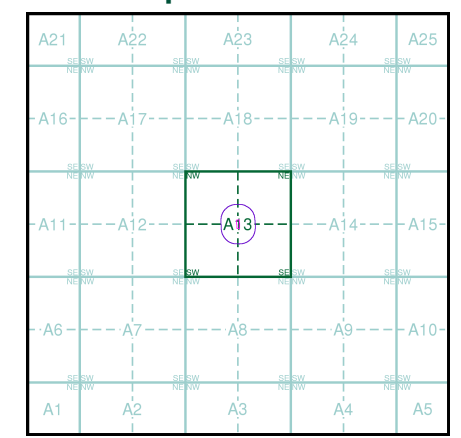

Order Details

Order Number: 394055057_1_1
 Customer Ref: 25-262.01
 National Grid Reference: 510420, 189230
 Slice: A
 Site Area (Ha): 0.1
 Search Buffer (m): 1000

Site Details

Garage Court, r/o 66-74 Farmlands, Joel Street, Pinner, HA5 2LN



Tel: 0844 844 9952
 Fax: 0844 844 9951
 Web: www.envirocheck.co.uk

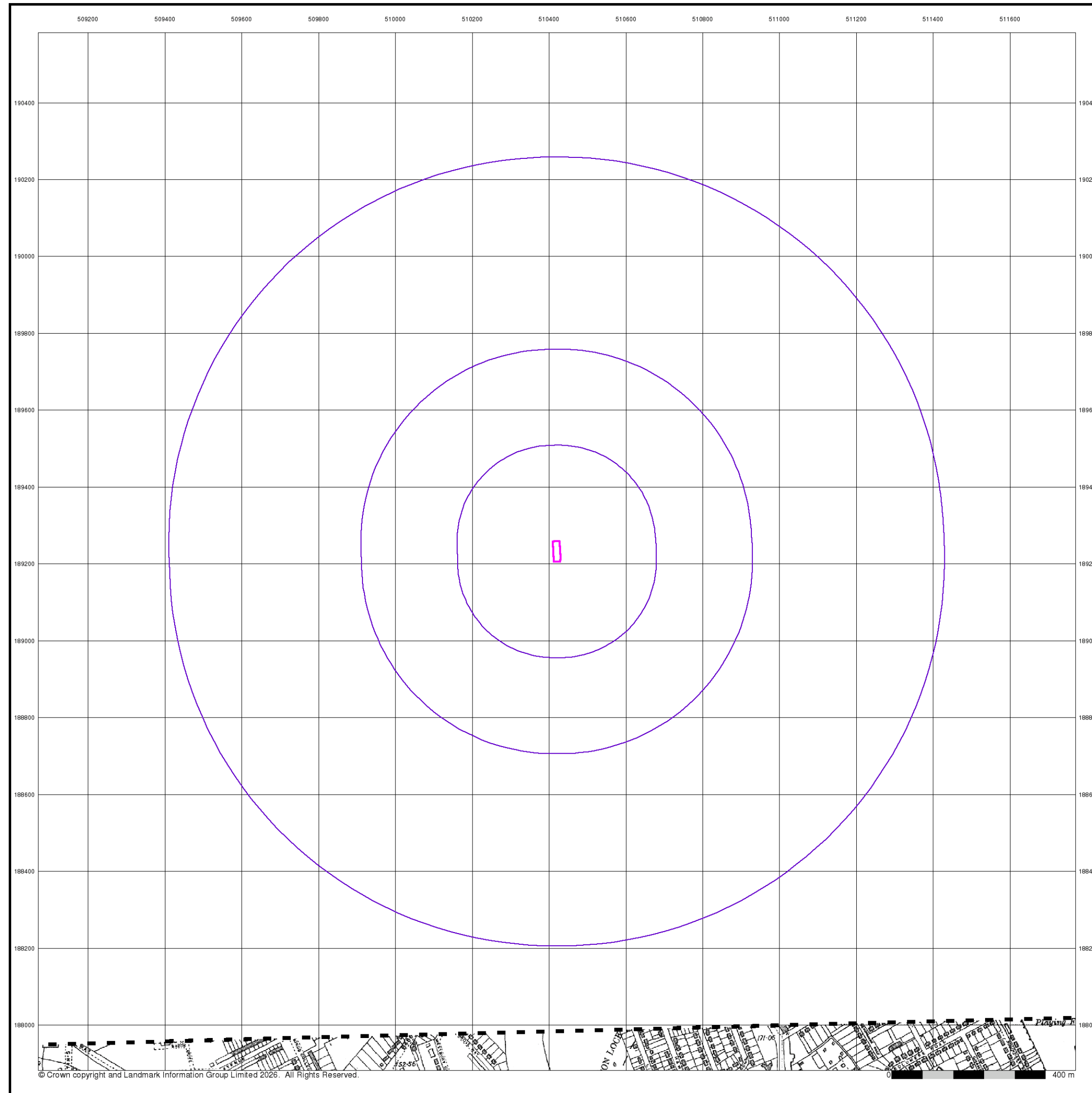

Middlesex

Published 1938

Source map scale - 1:10,560

The historical maps shown were reproduced from maps predominantly held at the scale adopted for England, Wales and Scotland in the 1840's. In 1854 the 1:2,500 scale was adopted for mapping urban areas; these maps were used to update the 1:10,560 maps. The published date given therefore is often some years later than the surveyed date. Before 1938, all OS maps were based on the Cassini Projection, with independent surveys of a single county or group of counties, giving rise to significant inaccuracies in outlying areas. In the late 1940's, a Provisional Edition was produced, which updated the 1:10,560 mapping from a number of sources. The maps appear unfinished - with all military camps and other strategic sites removed. These maps were initially overprinted with the National Grid. In 1970, the first 1:10,000 maps were produced using the Transverse Mercator Projection. The revision process continued until recently, with new editions appearing every 10 years or so for urban areas.

Map Name(s) and Date(s)

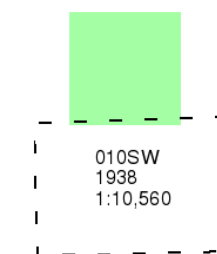

Historical Map - Slice A

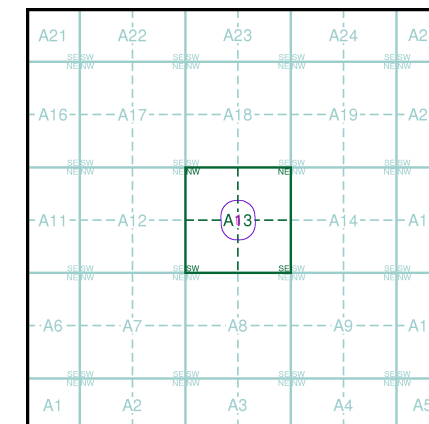

Order Details

Order Number: 394055057_1_1
 Customer Ref: 25-262.01
 National Grid Reference: 510420, 189230
 Slice: A
 Site Area (Ha): 0.1
 Search Buffer (m): 1000

Site Details

Garage Court, r/o 66-74 Farmlands, Joel Street, Pinner, HA5 2LN



Tel: 0844 844 9952
 Fax: 0844 844 9951
 Web: www.envirocheck.co.uk