

# **NET WORLD SPORTS»**

8m/26ft BALL STOP POST

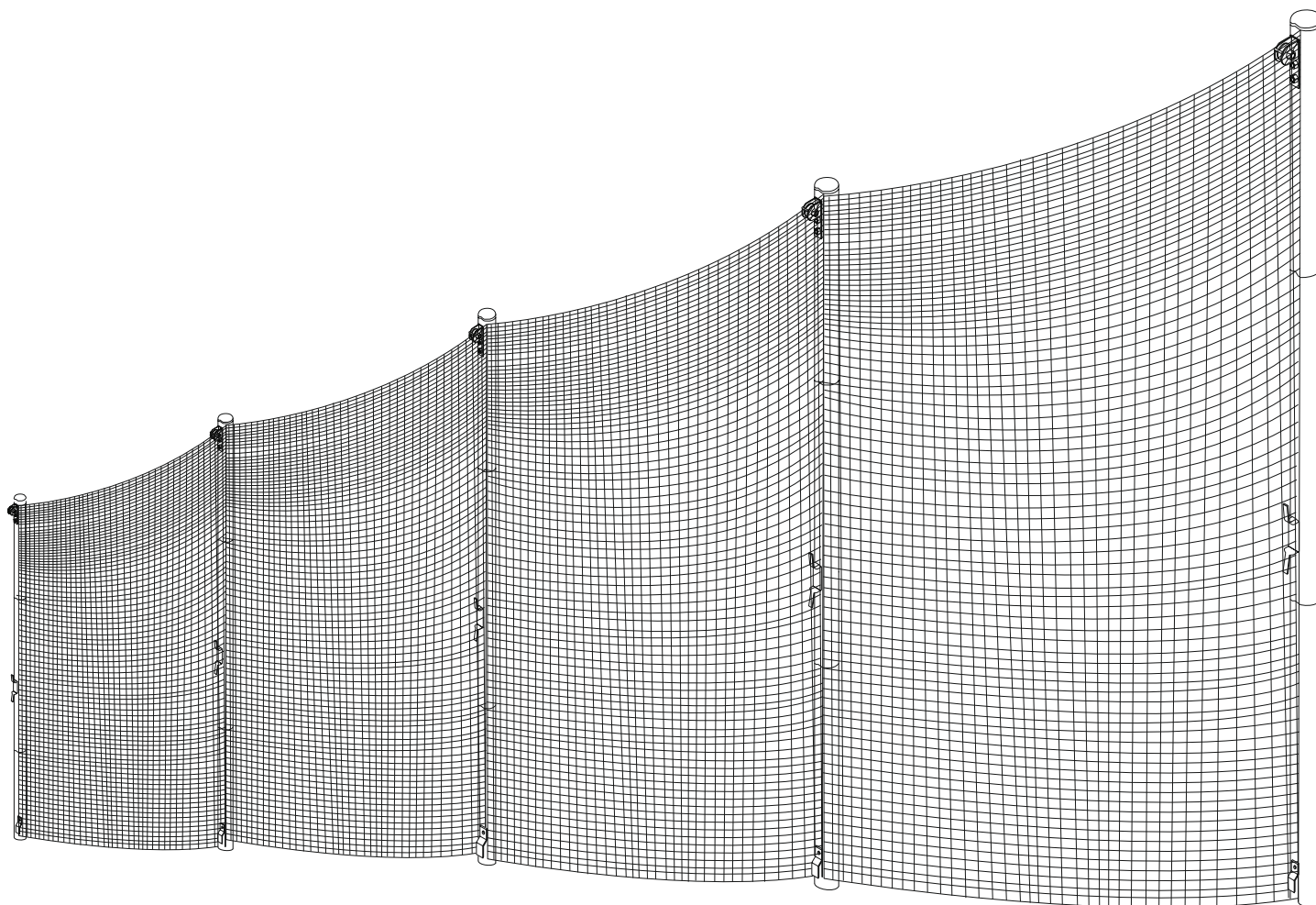

Scan QR code to view assembly  
video instructions



All assembly instructions available on Youtube  
@NetWorldSports

**NET WORLD SPORTS»**



@NetWorldSports

[www.networldsports.co.uk](http://www.networldsports.co.uk) // +44 (0) 1691 683 807 // [cs@networldsports.co.uk](mailto:cs@networldsports.co.uk)

[www.networldsports.com](http://www.networldsports.com) // 1-866-861-9095 // [cs@networldsports.com](mailto:cs@networldsports.com)

# PARTS LIST

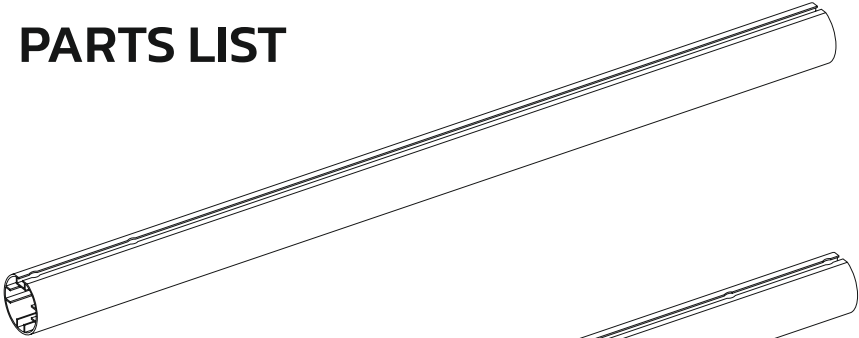

**39287**  
Rail (2x)

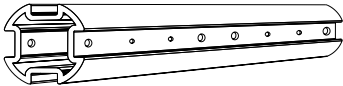

**39289**  
Rail Connection (3x)

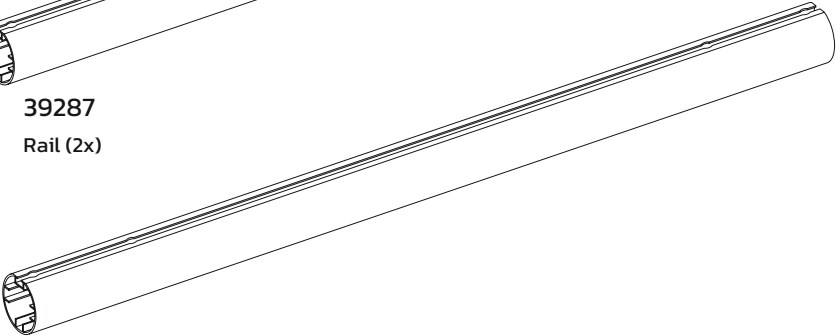

**39288**  
Rail Middle Section (2x)

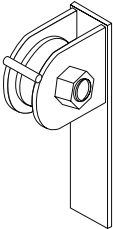

**39173**  
Pulley (1x)



**39174**  
Cleat (1x)



**39175**  
net hook (1x)

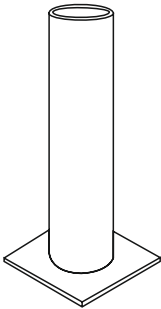

**39270**  
Socket (1x)



**39177**  
Rubber end Cap (1x)



**39178**  
Socket cap (1x)

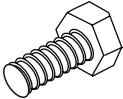

**38049**  
M10x20 bolt (4x)

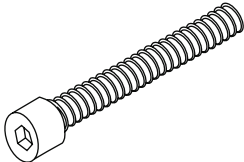

**39179**  
M10x90 hex bolt (12x)



**38088**  
M10 Washer (16x)



**38077**  
M10 Lock nut (12x)

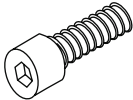

**38071**  
M8x20 hex bolt (12x)



**38099**  
M8 Spring washer (12x)



Hauling rope.

# HANDY EXTRAS

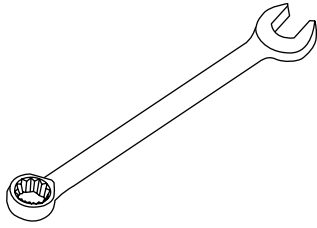

Wrench

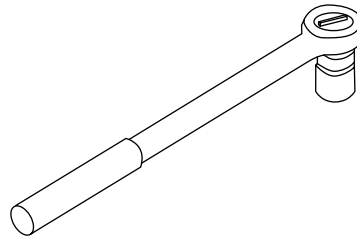

Ratchet with Sockets

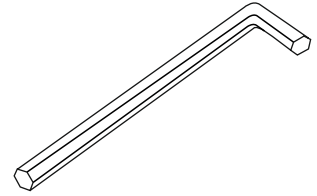

Allen key

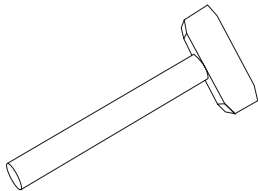

Rubber mallet



## \*IMPORTANT

1. Read through the instruction thoroughly before assembling.
2. Check parts for any defects prior to the assembly.
3. Ensure due diligence is carried out and a risk assessment followed prior to the assembly.
4. Safety/warning stickers must be visible at all times.
5. Ensure ground sockets/anchors are correctly installed.
6. Never climb or swing on the product.
7. Use extreme caution when moving or raising the product.
8. Beware of over head power lines when installing the product.
9. We recommend lowering the netting and posts in high winds and extreme weather conditions.
10. Remove nets when the product is not in use.
11. We recommend lubricating/greasing the appropriate components (winders, sockets, inserts nuts and bolts) to prolong lifespan.
12. Part 39171 (middle section) is not required for 12ft ball stop system.

## SOCKET INSTALLATION GUIDE

### STEP 1

Establish the position of each ground socket.

We recommend using a measuring tape and spray paint to do this.

We also recommend socket centres of 6m (19ft 8") for our aluminium posts although this may vary depending on what setup you have ordered (for clarification please contact us).

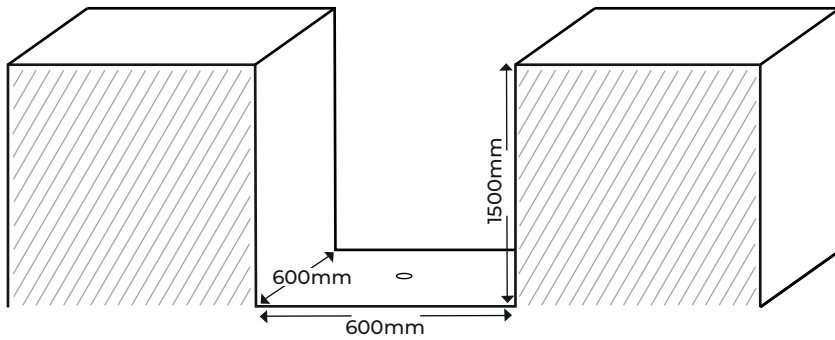

### STEP 2.

For normal soil conditions dig holes 1500mm deep x 600mm square.

If the soil is weak/sandy then the hole size will need to be bigger. Please consult an appropriate grounds contractor for expert advice as we cannot provide this information.

### STEP 3.

Place the socket correctly into position in the centre of the hole ensuring there is a drainage hole at the base of the socket.

If the soil is weak/sandy then you may need to place rubble/stone at the base of the hole to prevent the sockets sinking over time.

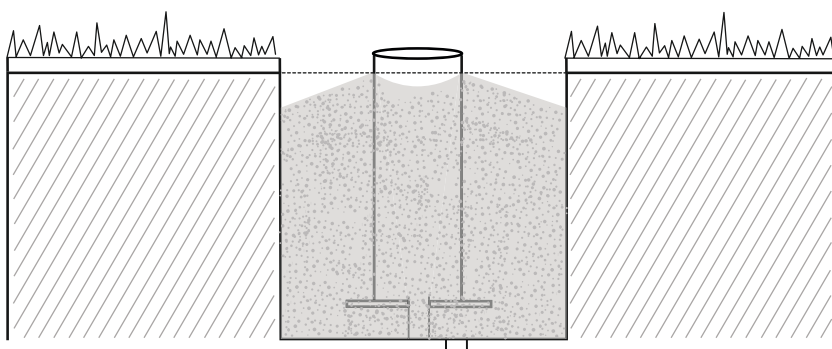
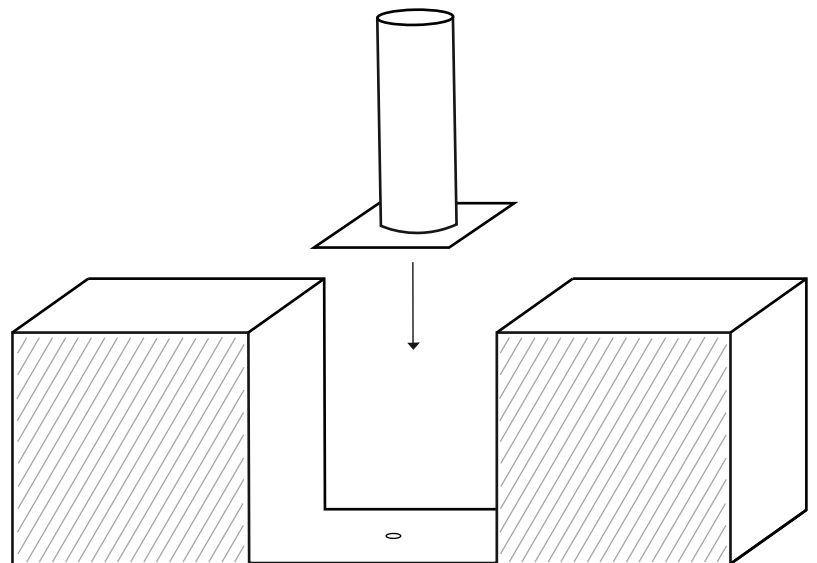

### STEP 4

Pour concrete into the hole and allow to set.

Please ensure that you leave a gap of 50mm at the top of the concrete block to cover with top soil after the concrete has set.

## POST ASSEMBLY GUIDE.

### STEP 1 – assemble posts

Lay out x2 rail sections (39287), x2 rail middle section (39288) and x3 rail connectors (39289)

Slide 1 connector into each end of middle rail section aligning pre-drilled holes over each other.

Slide one end of rail section (39287) onto connectors ensuring holes align.

SEE FIG1.

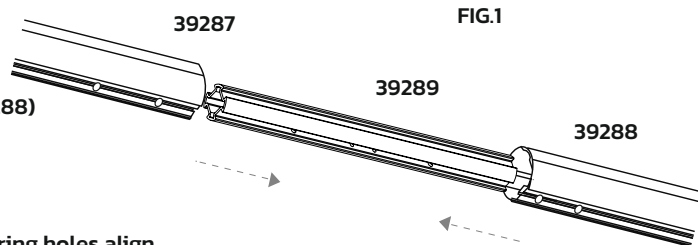

### STEP 2 – Securing posts.

Pass 1x M10x90 hex through one of the outer holes in the rail section  
Locate M10 washer (38088) and M10 lock nut (38077) over bolt.  
repeat this for each outer hole (x4) See FIG.2

Screw M8x20 bolts (38071) into remaining holes in rail sections ensuring M8x20 spring washers (38099) are in place see FIG.2

Once all bolts are in place tighten each nut and bolt.

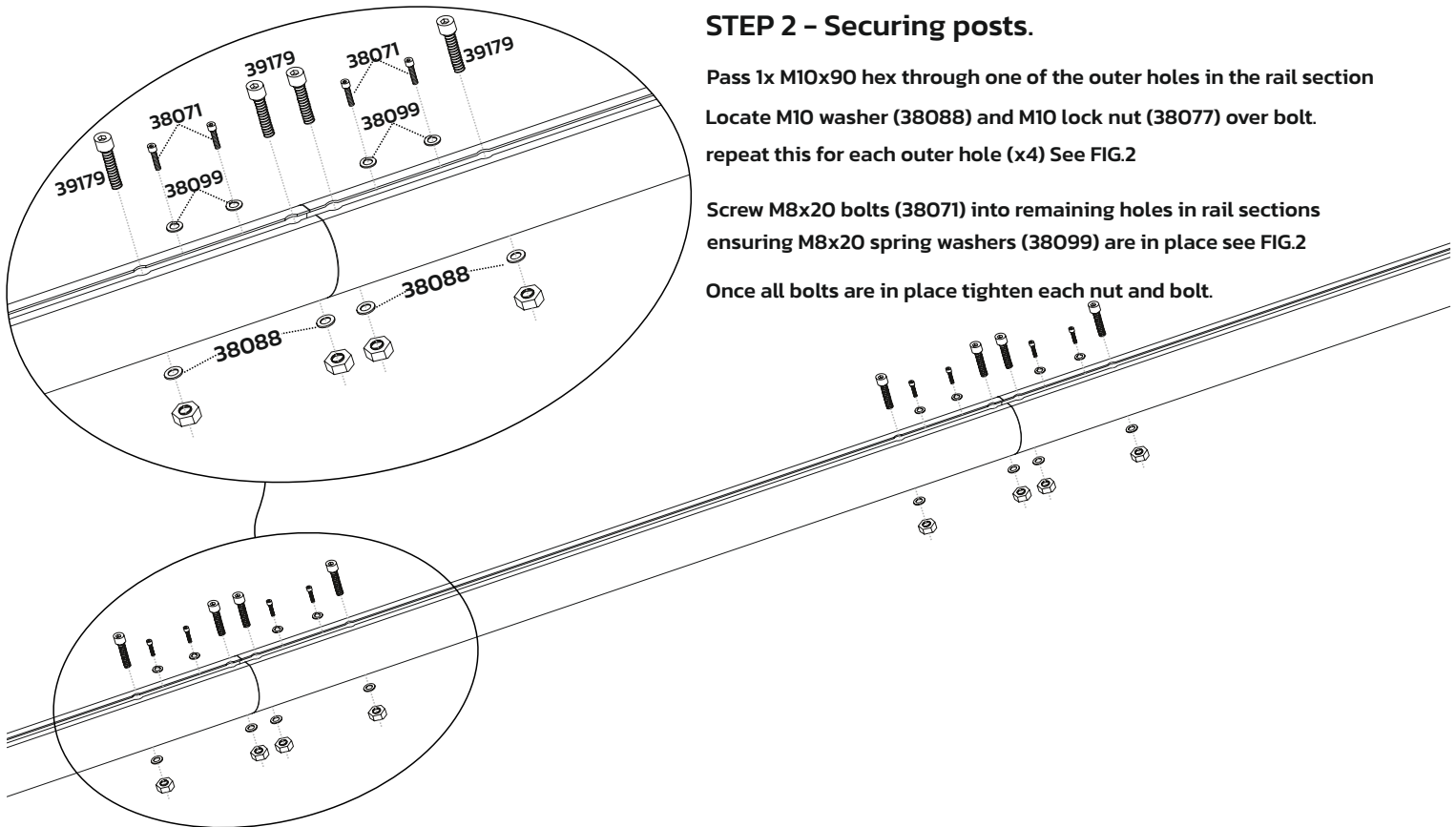

### STEP 3 – Fixing pulley and end cap

Slide 2x M10x20 bolts (38049) into 1 end of the assembled post  
locate pulley (39173) over the M10 bolts with pulley wheel nearest the top

See FIG.3 and 3.a

secure in place with M10 washer (38088) and M10 lock nut

Locate rubber cap (39177) on to the post See FIG 3.b

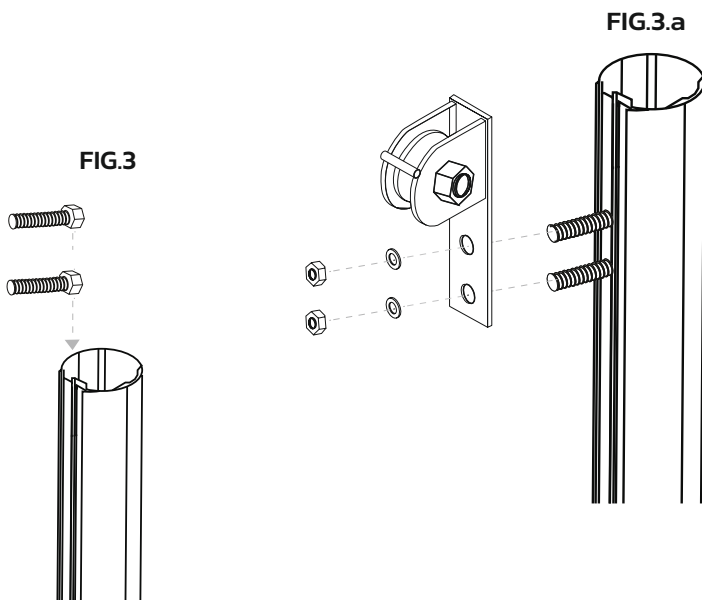

## STEP 6 - Fix cleat and net hook

Slide 2x M10x20 bolts (38049) into the other end of the assembled post

Locate 1 bolt approximately 1.25m from the bottom and locate the cleat (39174) over it

Secure with M10 washer and Lock nut

Locate the other bolt high enough up the post to allow it to be located properly into socket (approx 0.9m)

secure with M10 washer and lock nut

See Fig4. 4.a and 4.b

Fig 4.a

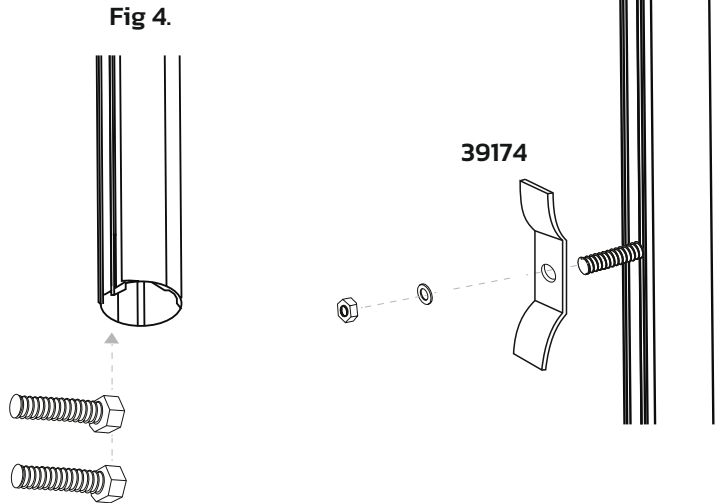
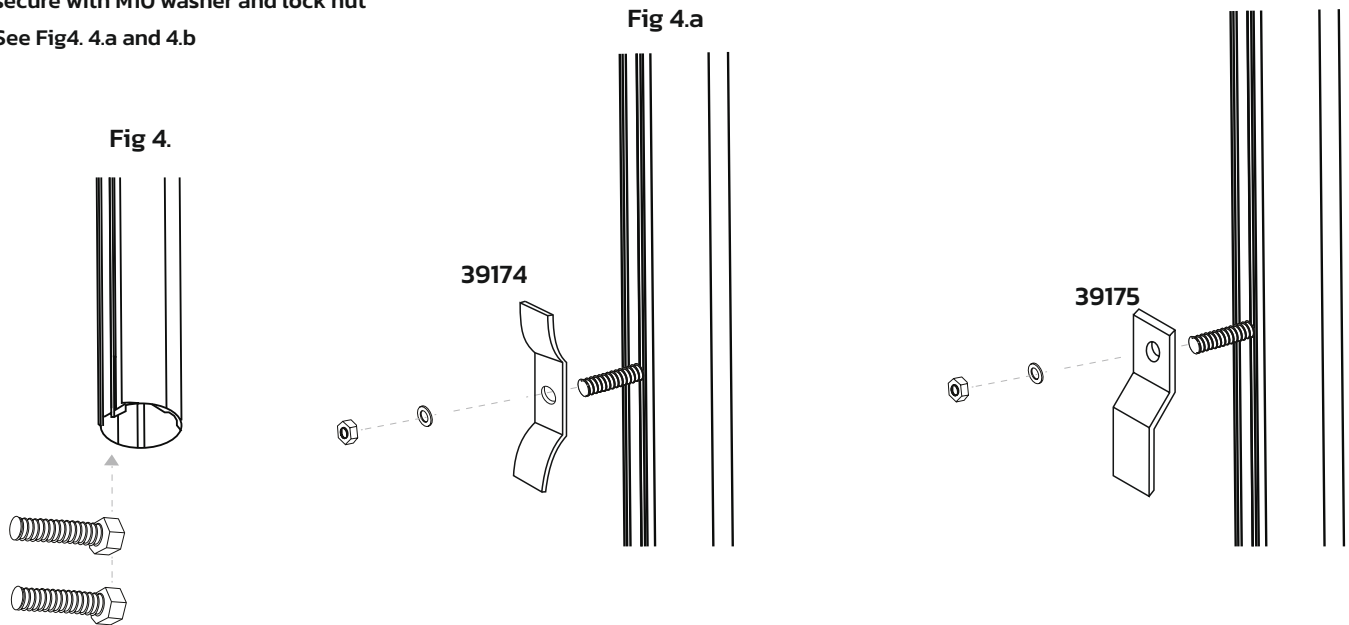
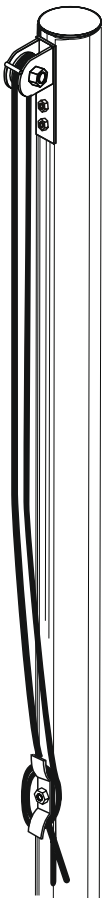

Fig 4.b



## STEP 7 Attach hauling rope

thread hauling rope through pulley and tie to cleat.



## STEP 8 Install posts and net.

install posts into pre installed sockets.

Lay out net and tie one end of hauling rope to the net  
haul the rope to the top and hook net over net hook.

