

## Proposed Colts Ground Facilities

### Existing Block Plan

Scale 1:500

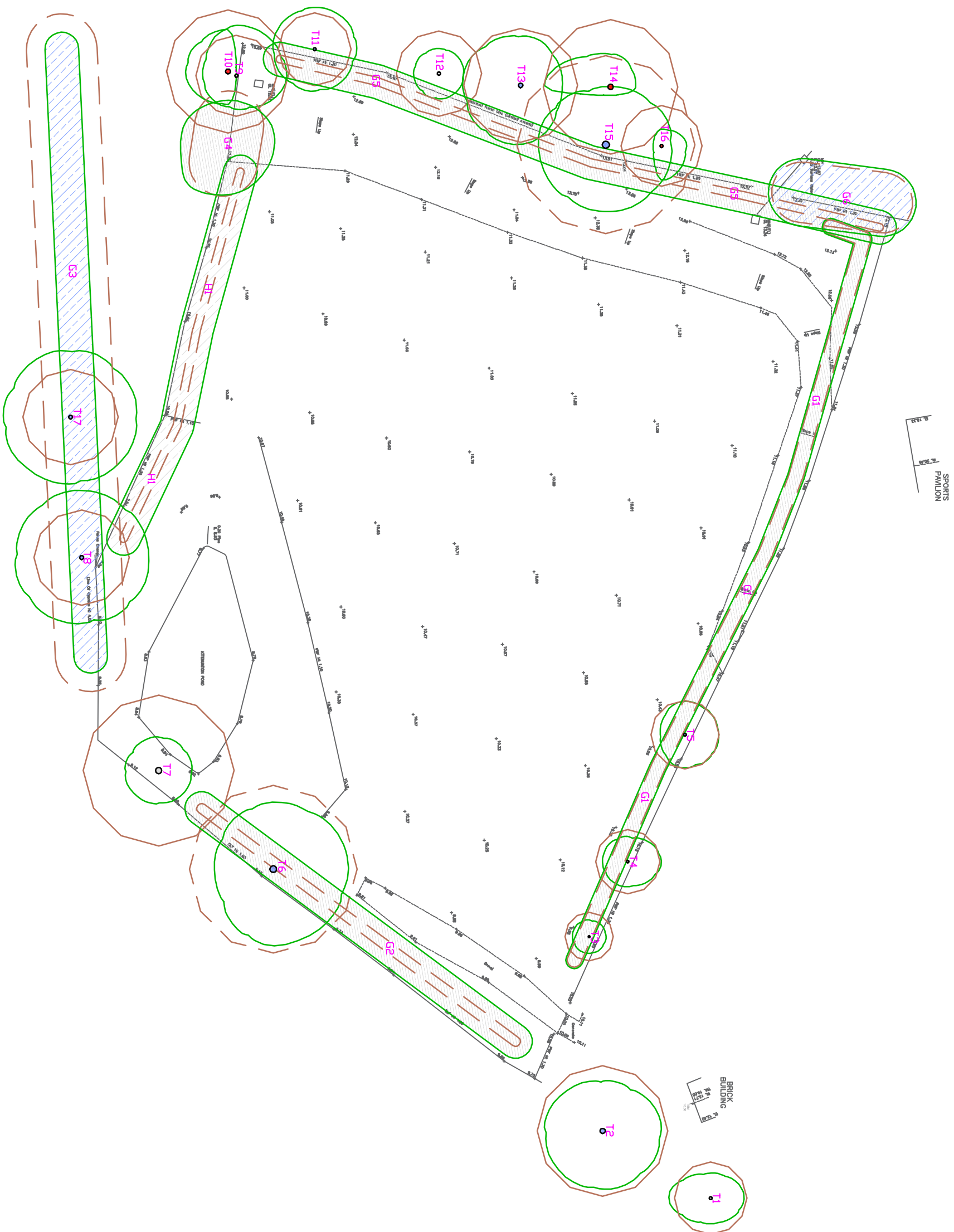

### Perimeter Fencing

Net World Sports - Socketed semi-permanent 'Stop That Ball' - Ball Stop Net & 10.0m (30.0 ft) Posts to the entirety of the perimeter as indicated, comprising:-

- Semi-permanent Stop That Ball™ System comes with removable ground sockets;
- System is 12ft (3.7m) tall once in the ground;
- 32mm diameter poles are made from 1.2mm thick galvanised steel;
- Ground sockets measure 450mm long and are manufactured from extremely durable steel;
- Poles feature a scratch-resistant, black powder coating for protection against rust;
- Black netting made from 2mm HDPP twine;
- 48mm knotted mesh netting is UV stabilised for outdoor use;
- Netting features a knotted design and is specially bonded for added strength, allowing it to withstand maximum impact;
- 6mm border rope is fully edged for increased strength and fray protection.

### Gabions - Generally

Ground level beneath gabions excavated to not less than 300mm below intended ground level (with straight, tight sides) and with all base areas consolidated;

- Circa 500mm x 1000mm gabions (of 4mm galvan coated wire) positioned on consolidated base and helical wired together both horizontally and vertically;
- Gabions fully filled with appropriate interlocking stones measuring 75mm - 150mm, preferably laid in horizontal courses;
- Where multiple gabion height is required gabions to be helical wired tied together both horizontally and vertically.

### Gabions - To Pond

- Ground level beneath gabions generally excavated to not less than 300mm below intended ground level (with straight, tight sides) and with all base areas consolidated;
- Circa 1000mm x 1000mm gabions (of 5mm galvan coated wire) positioned on consolidated base and helical wired together both horizontally and vertically;
- Gabions filled with appropriate interlocking stones measuring 75mm - 150mm, preferably laid in horizontal courses;
- Where multiple gabion height is required gabions to be helical wired tied together both horizontally and vertically;

Subject to Structural Engineer design

### Proposed Block Plan

Scale 1:500



### Gabions

Fullest anticipated extent indicated on the above proposed block plan in green.

### Perimeter Fencing

Fullest anticipated extent indicated on the above proposed block plan in red.

### Dedicated Toilet/Changing Facility

Maximum extent of the dedicated toilet/changing facility indicated on the above proposed block plan to the North West corner in magenta.

### Landscaping

Refer to adjusted ground levels indicated on the above proposed block plan.  
Defer to Arboricultural Report in all other respects.

### Dedicated Toilet/Changing Facility

Core unit provided in the form of a re-purposed portacabin/temporary building to provide the facilities required. Exact proportions unknown, but not to exceed that indicated.

Temporary building delivered to site intact with bespoke support jack configuration to suit installed on limited depth consolidated 150mm roadstone substrate, 20mm sharp sand blinding and 2No stacked 50mm concrete paving flags.

Exterior of temporary building (from maximum height to proposed ground level) provided with brick-slip system and mortar pointing to exactly replicate the existing detached pavilion.

All mains services concealed locally within void beneath unit.

All subterranean mains service connections to existing remote pavillion services to be confirmed.

www.abstrkt-design.co.uk		www.abstrkt-design.co.uk	
CLIENT		REVISIONS	
Northwood Cricket Club		No.	
PROJECT		Date	
Intended Reuse of Jubilee Field to Create Dedicated Colts Ground		DRAWING TITLE	
SCALE		Existing & Proposed Block Plans	
1:100 @ A1		Drawing No	
DATED		20220617	
Feb 2024		PL06	
DRAWN		REV	
CPH		-	
RICKS		-	