

- General Notes
1. New work shown shaded or hatched
  2. Demolition generally shown dotted
  3. W: Wardrobe
  4. RL: Rooflight below
  5. RLA: Rooflight above

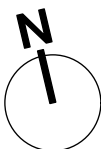
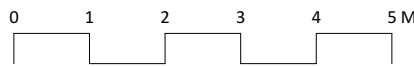
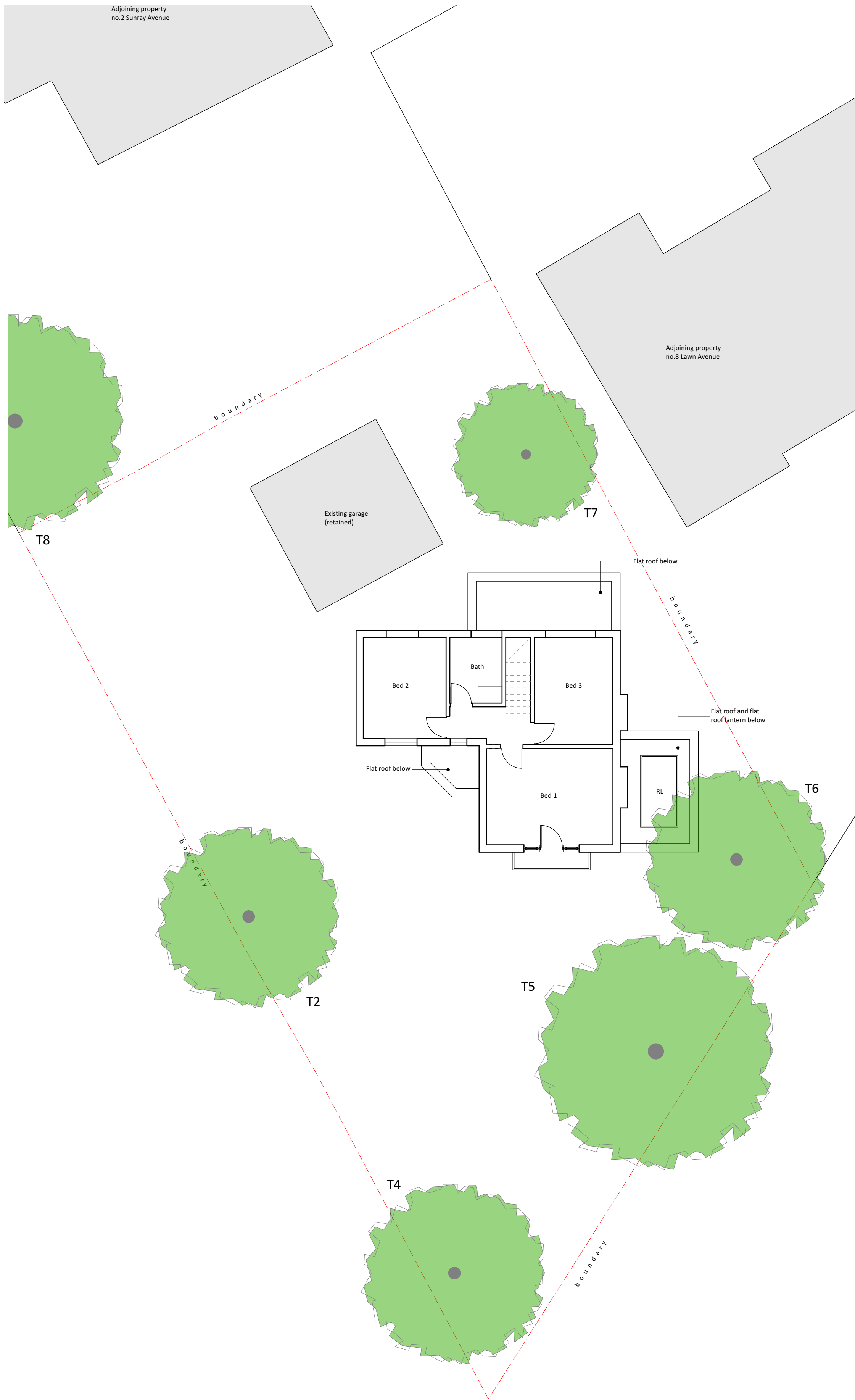
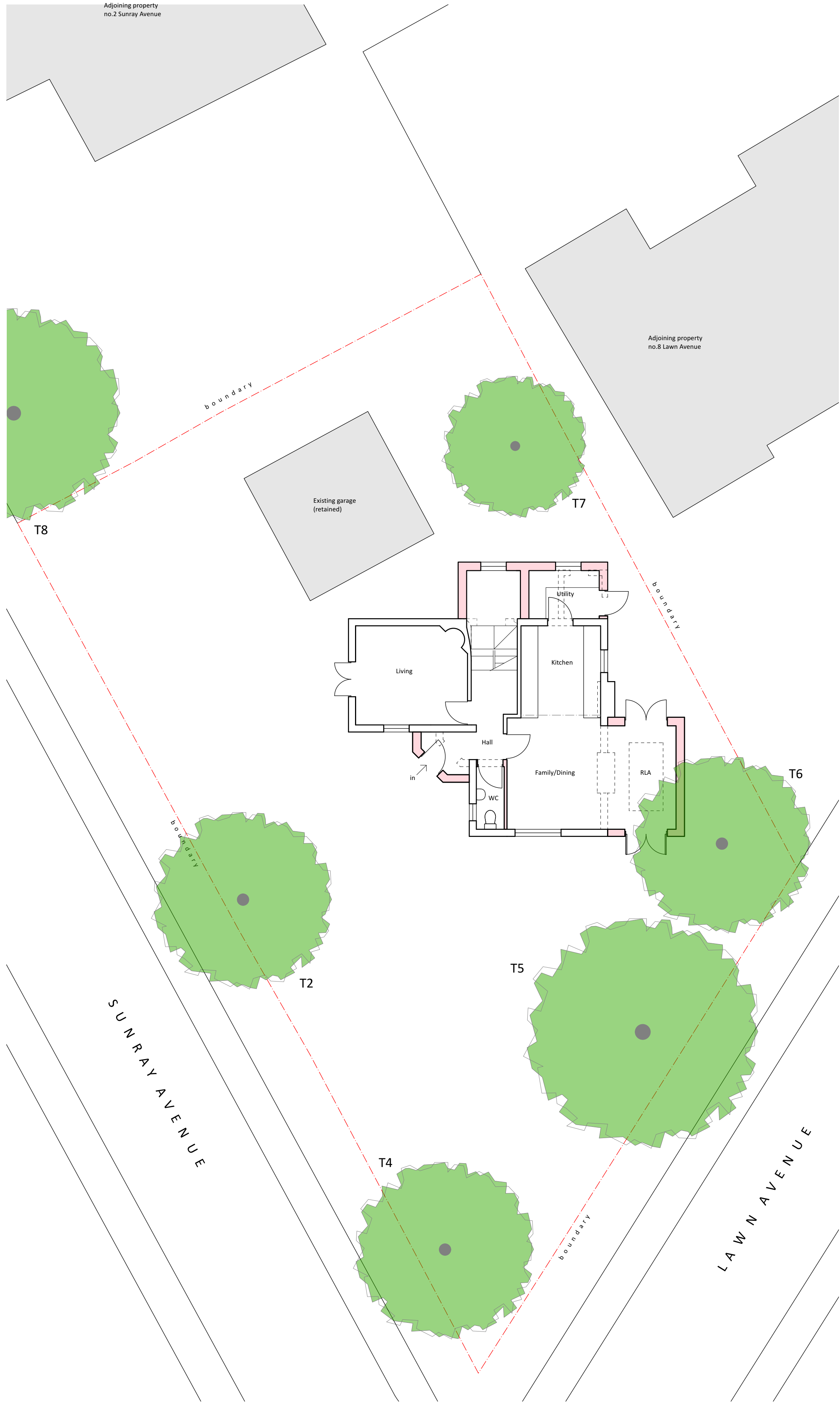

ISSUE	DATE	REVISION
A	18/08/2022	Amendments based off of Planner's comments

LAWFUL DEVELOPMENT

PROJECT  
10 Lawn Avenue, West Drayton, UB7 7AQ

CLIENT  
Mr & Mrs Ghedia

DRAWING  
PROPOSED PLANS + SITE LAYOUT



All rights described in chapter IV of the copyright designs & patents act 1988 have been asserted. This drawing must not be scaled; only figured dimensions should be used. Check and verify all dimensions on site prior to commencing any work. Any discrepancies should be reported to the Architects immediately.

PROJECT #	2021.002	DWG #	REV
DATE	01/06/2022		
SCALE	1:100		
DRAWN	PB	CHKD	JC

Akaal Associates Ltd trading as aa+ architects  
Moor House Farm Lower Road Denham Uxbridge UB9 5EN  
t 01895 834961 e info@aa-plus.uk w aa-plus.uk