

Contaminated  
Land  
Solutions

## Industrial Land Use Map

### General

- Specified Site
- Specified Buffer(s)
- Bearing Reference Point
- Slice
- Map ID

### Industrial Land Use

- Contemporary Trade Directory Entry
- Fuel Station Entry
- Gas Pipeline
- Points of Interest - Commercial Services
- Points of Interest - Education and Health
- Points of Interest - Manufacturing and Production
- Points of Interest - Public Infrastructure
- Points of Interest - Recreational and Environmental
- Underground Electrical Cables

## Industrial Land Use Map - Slice A

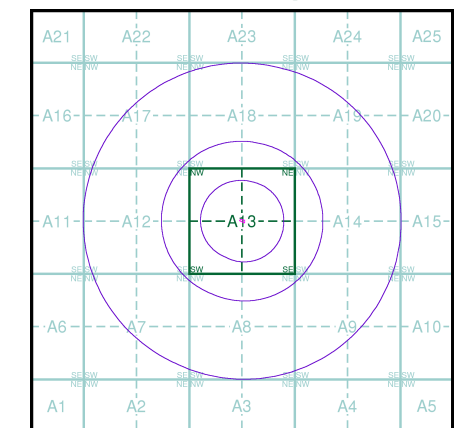

### Order Details

Order Number: 316398082\_1\_1  
Customer Ref: 2604  
National Grid Reference: 506020, 178600  
Slice: A  
Site Area (Ha): 0.04  
Search Buffer (m): 1000

### Site Details

140, Rowan Road, West Drayton, UB7 7UE

**Landmark**  
INFORMATION GROUP

Tel: 0844 844 9952  
Fax: 0844 844 9951  
Web: [www.envirocheck.co.uk](http://www.envirocheck.co.uk)



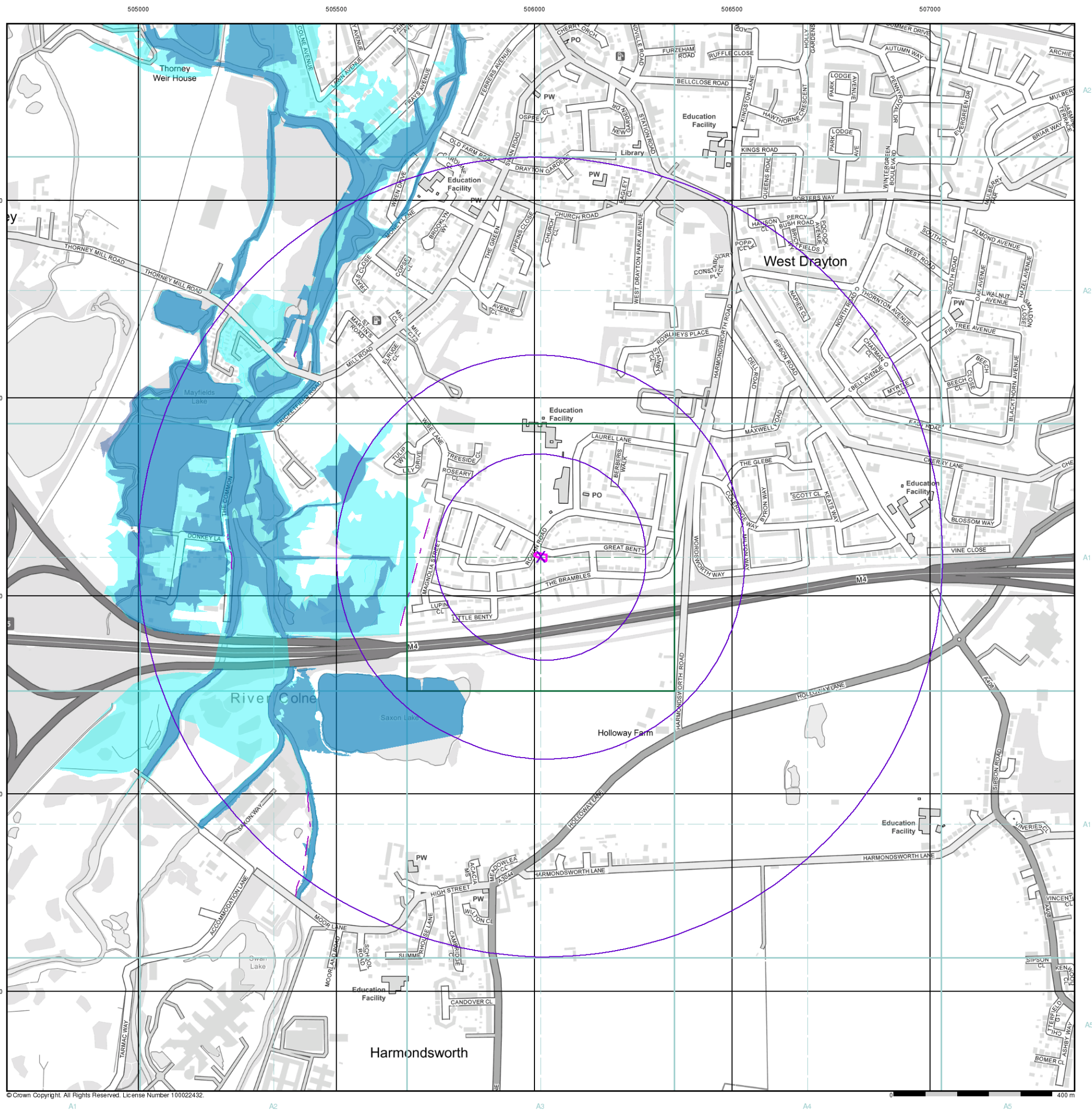

### General

- Specified Site
- Specified Buffer(s)
- Bearing Reference Point

### Agency and Hydrological (Flood)

- Extreme Flooding from Rivers or Sea without Defences (Zone 2)
- Flooding from Rivers or Sea without Defences (Zone 3)
- Area Benefiting from Flood Defence
- Flood Water Storage Areas
- Flood Defence

### Flood Map - Slice A

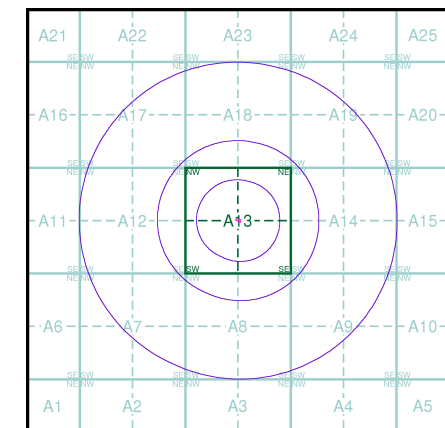

### Order Details

Order Number: 316398082\_1\_1  
Customer Ref: 2604  
National Grid Reference: 506020, 178600  
Slice: A  
Site Area (Ha): 0.04  
Search Buffer (m): 1000

### Site Details

140, Rowan Road, West Drayton, UB7 7UE



Tel: 0844 844 9952  
Fax: 0844 844 9951  
Web: www.envirocheck.co.uk



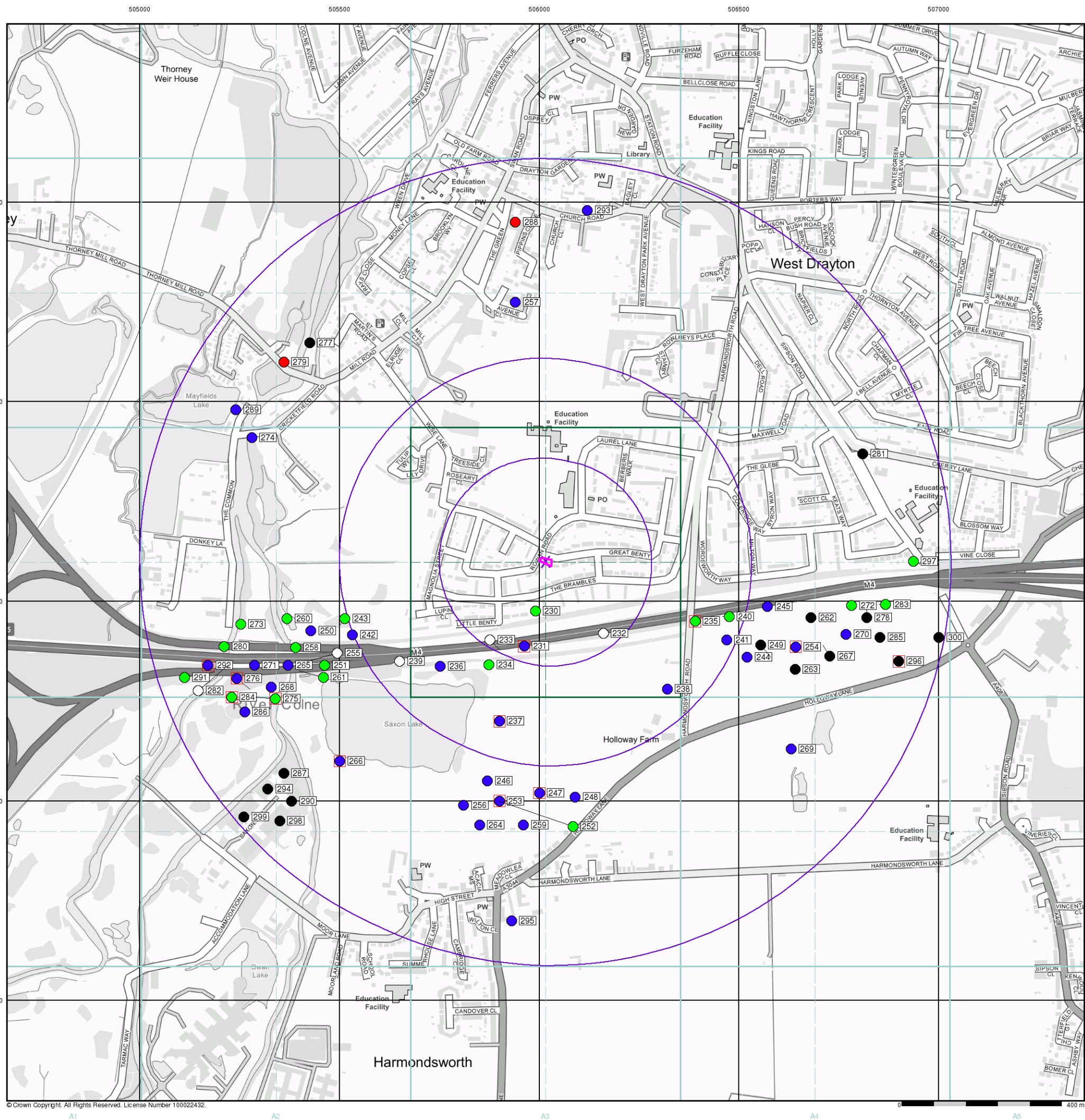

Contaminated  
Land  
Solutions

### General

- Specified Site
- Specified Buffer(s)
- Bearing Reference Point
- Map ID
- Several of Type at Location

### Agency and Hydrological (Boreholes)

- BGS Borehole Depth 0 - 10m
- BGS Borehole Depth 10 - 30m
- BGS Borehole Depth 30m +
- Confidential
- Other

For Borehole information please refer to the Borehole .csv file which accompanied this slice.

A copy of the BGS Borehole Ordering Form is available to download from the Support section of [www.envirocheck.co.uk](http://www.envirocheck.co.uk).

### Borehole Map - Slice A

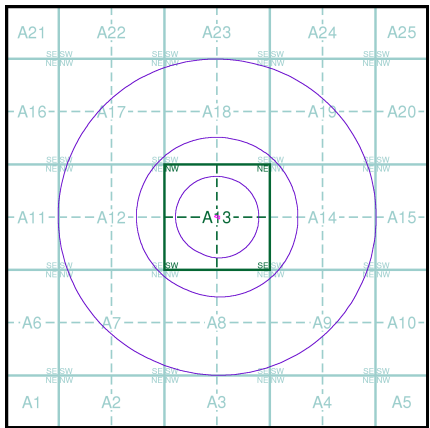

### Order Details

Order Number: 316398082\_1\_1  
Customer Ref: 2604  
National Grid Reference: 506020, 178600  
Slice: A  
Site Area (Ha): 0.04  
Search Buffer (m): 1000

### Site Details

140, Rowan Road, West Drayton, UB7 7UE

Landmark®  
INFORMATION GROUP

Tel: 0844 844 9952  
Fax: 0844 844 9951  
Web: [www.envirocheck.co.uk](http://www.envirocheck.co.uk)







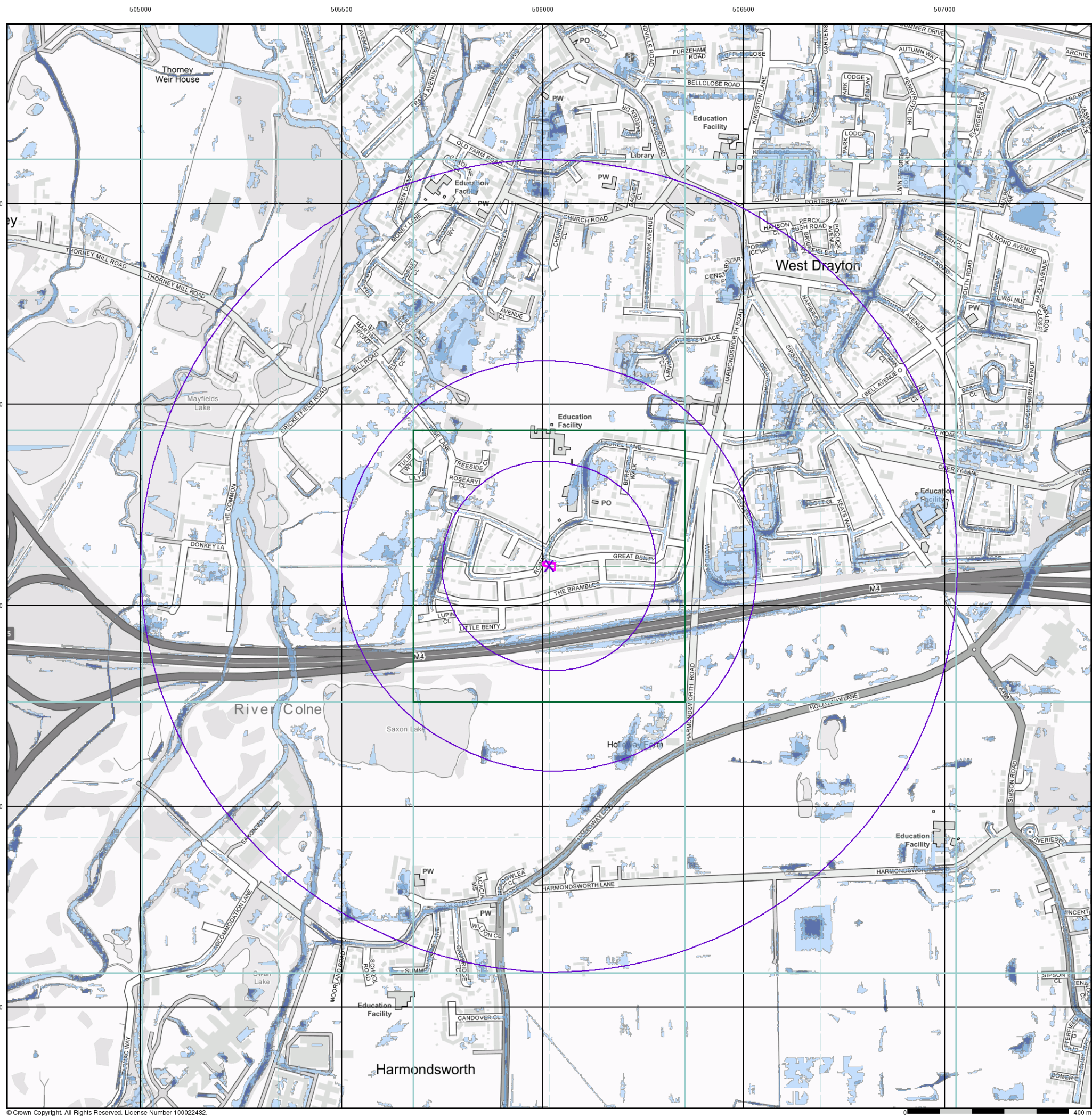

Contaminated  
Land  
Solutions

#### General

- Specified Site
- Specified Buffer(s)
- Bearing Reference Point

#### Risk of Flooding from Surface Water

- High - 30 Year Return
- Medium - 100 Year Return
- Low - 1000 Year Return

#### Suitability

See the suitability map below

- National to county
- County to town
- Town to street
- Street to parcels of land
- Property

#### EANRW Suitability Map - Slice A

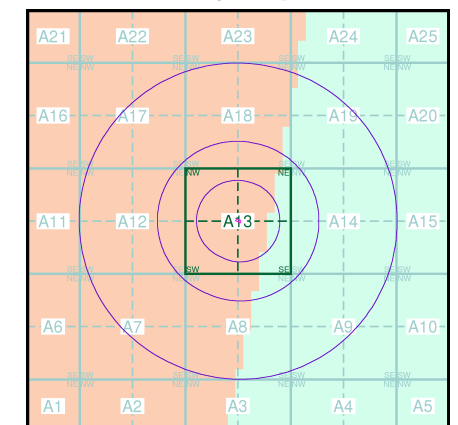

#### Order Details

Order Number: 316398082\_1\_1  
Customer Ref: 2604  
National Grid Reference: 506020, 178600  
Slice: A  
Site Area (Ha): 0.04  
Search Buffer (m): 1000

#### Site Details

140, Rowan Road, West Drayton, UB7 7UE

Landmark®  
INFORMATION GROUP

Tel: 0844 844 9952  
Fax: 0844 844 9951  
Web: www.envirocheck.co.uk



## **Appendix E – Historical Maps**

© Crown copyright. All rights reserved. Licence number LAN1001467.



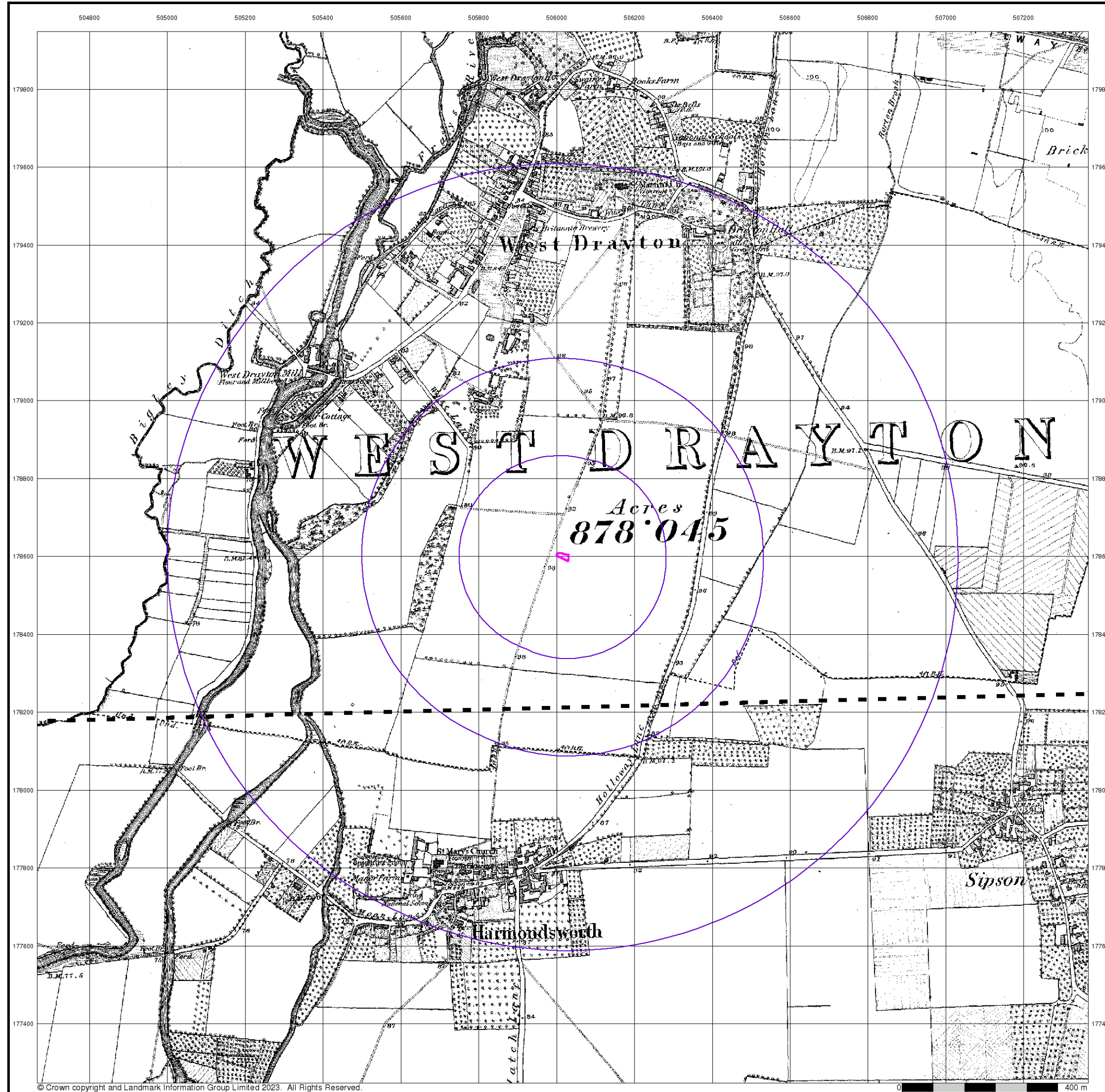

Contaminated  
Land  
Solutions

Middlesex

Published 1868

Source map scale - 1:10,560

The historical maps shown were reproduced from maps predominantly held at the scale adopted for England, Wales and Scotland in the 1840's. In 1854 the 1:2,500 scale was adopted for mapping urban areas; these maps were used to update the 1:10,560 maps. The published date given therefore is often some years later than the surveyed date. Before 1938, all OS maps were based on the Cassini Projection, with independent surveys of a single county or group of counties, giving rise to significant inaccuracies in outlying areas. In the late 1940's, a Provisional Edition was produced, which updated the 1:10,560 mapping from a number of sources. The maps appear unfinished - with all military camps and other strategic sites removed. These maps were initially overprinted with the National Grid. In 1970, the first 1:10,000 maps were produced using the Transverse Mercator Projection. The revision process continued until recently, with new editions appearing every 10 years or so for urban areas.

Map Name(s) and Date(s)

01400
1868
1:10,560
01900
1868
1:10,560

Historical Map - Slice A

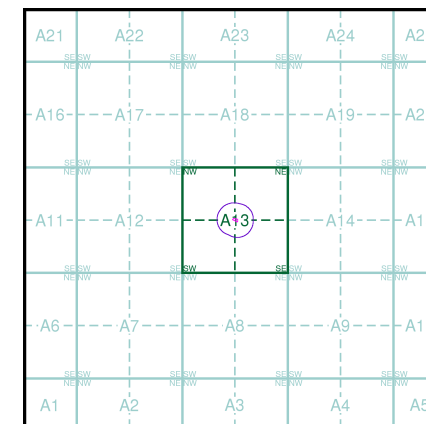

Order Details

Order Number: 316398082\_1\_1  
Customer Ref: 2604  
National Grid Reference: 506020, 178600  
Slice: A  
Site Area (Ha): 0.04  
Search Buffer (m): 1000

Site Details

140, Rowan Road, West Drayton, UB7 7UE

Landmark  
INFORMATION GROUP

Tel: 0844 844 9952  
Fax: 0844 844 9951  
Web: www.envirocheck.co.uk





Contaminated  
Land  
Solutions

Middlesex

Published 1897

Source map scale - 1:10,560

The historical maps shown were reproduced from maps predominantly held at the scale adopted for England, Wales and Scotland in the 1840's. In 1854 the 1:2,500 scale was adopted for mapping urban areas; these maps were used to update the 1:10,560 maps. The published date given therefore is often some years later than the surveyed date. Before 1938, all OS maps were based on the Cassini Projection, with independent surveys of a single county or group of counties, giving rise to significant inaccuracies in outlying areas. In the late 1940's, a Provisional Edition was produced, which updated the 1:10,560 mapping from a number of sources. The maps appear unfinished - with all military camps and other strategic sites removed. These maps were initially overprinted with the National Grid. In 1970, the first 1:10,000 maps were produced using the Transverse Mercator Projection. The revision process continued until recently, with new editions appearing every 10 years or so for urban areas.

Map Name(s) and Date(s)

014SE
1897
1:10,560
019NE
1897
1:10,560

Historical Map - Slice A

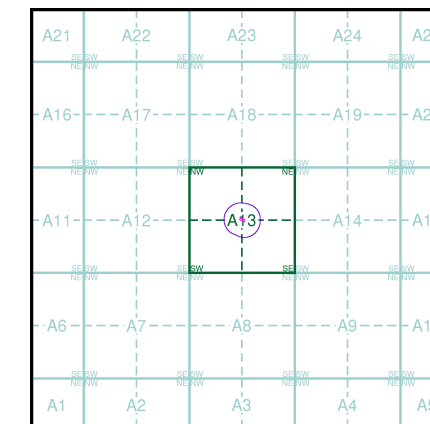

Order Details

Order Number: 316398082\_1\_1  
Customer Ref: 2604  
National Grid Reference: 506020, 178600  
Slice: A  
Site Area (Ha): 0.04  
Search Buffer (m): 1000

Site Details

140, Rowan Road, West Drayton, UB7 7UE

Landmark  
INFORMATION GROUP

Tel: 0844 844 9952  
Fax: 0844 844 9951  
Web: www.envirocheck.co.uk





## Buckinghamshire

Published 1900

Source map scale - 1:10,560

The historical maps shown were reproduced from maps predominantly held at the scale adopted for England, Wales and Scotland in the 1840's. In 1854 the 1:2,500 scale was adopted for mapping urban areas; these maps were used to update the 1:10,560 maps. The published date given therefore is often some years later than the surveyed date. Before 1938, all OS maps were based on the Cassini Projection, with independent surveys of a single county or group of counties, giving rise to significant inaccuracies in outlying areas. In the late 1940's, a Provisional Edition was produced, which updated the 1:10,560 mapping from a number of sources. The maps appear unfinished - with all military camps and other strategic sites removed. These maps were initially overprinted with the National Grid. In 1970, the first 1:10,000 maps were produced using the Transverse Mercator Projection. The revision process continued until recently, with new editions appearing every 10 years or so for urban areas.

### Map Name(s) and Date(s)

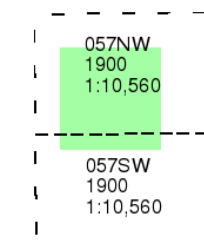

### Historical Map - Slice A

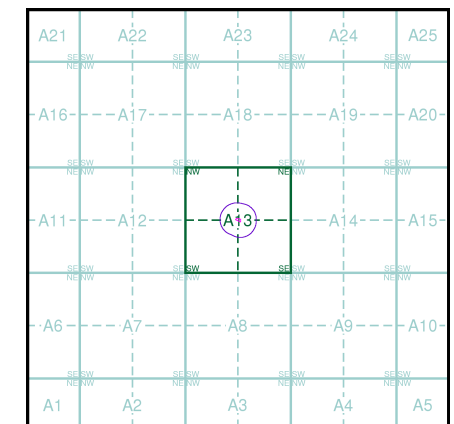

### Order Details

Order Number: 316398082\_1\_1  
Customer Ref: 2604  
National Grid Reference: 506020, 178600  
Slice: A  
Site Area (Ha): 0.04  
Search Buffer (m): 1000

### Site Details

140, Rowan Road, West Drayton, UB7 7UE



Tel: 0844 844 9952  
Fax: 0844 844 9951  
Web: www.envirocheck.co.uk

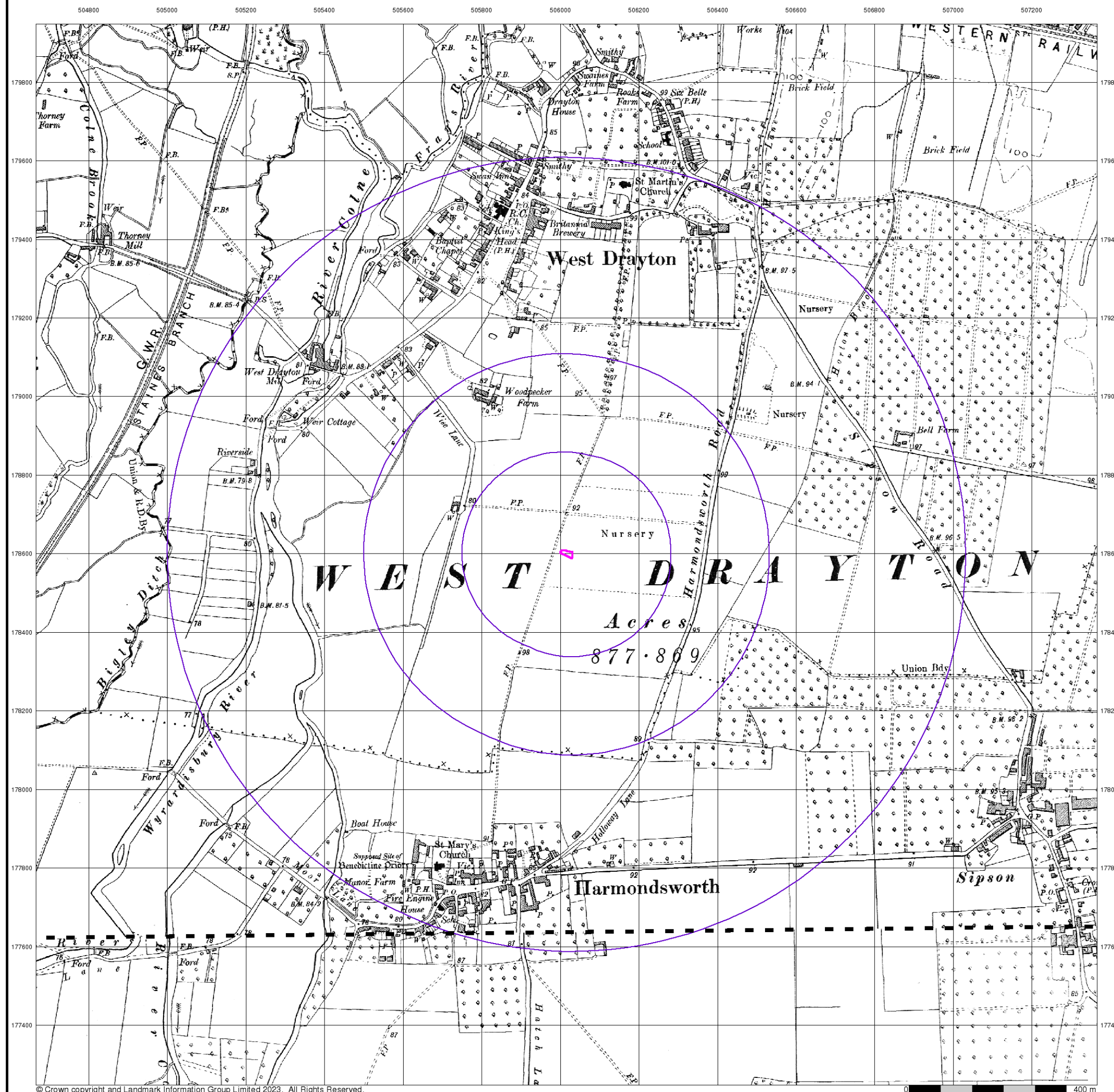





Contaminated  
Land  
Solutions

Middlesex

Published 1915 - 1920

Source map scale - 1:10,560

The historical maps shown were reproduced from maps predominantly held at the scale adopted for England, Wales and Scotland in the 1840's. In 1854 the 1:2,500 scale was adopted for mapping urban areas; these maps were used to update the 1:10,560 maps. The published date given therefore is often some years later than the surveyed date. Before 1938, all OS maps were based on the Cassini Projection, with independent surveys of a single county or group of counties, giving rise to significant inaccuracies in outlying areas. In the late 1940's, a Provisional Edition was produced, which updated the 1:10,560 mapping from a number of sources. The maps appear unfinished - with all military camps and other strategic sites removed. These maps were initially overprinted with the National Grid. In 1970, the first 1:10,000 maps were produced using the Transverse Mercator Projection. The revision process continued until recently, with new editions appearing every 10 years or so for urban areas.

Map Name(s) and Date(s)

014SE
1920
1:10,560
019NE
1915
1:10,560

Historical Map - Slice A

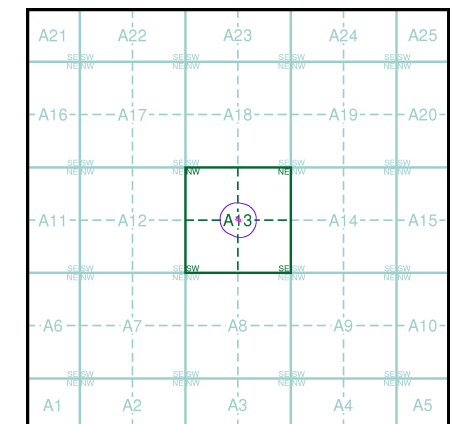

Order Details

Order Number: 316398082\_1\_1  
Customer Ref: 2604  
National Grid Reference: 506020, 178600  
Slice: A  
Site Area (Ha): 0.04  
Search Buffer (m): 1000

Site Details

140, Rowan Road, West Drayton, UB7 7UE

Landmark®  
INFORMATION GROUP

Tel: 0844 844 9952  
Fax: 0844 844 9951  
Web: www.envirocheck.co.uk



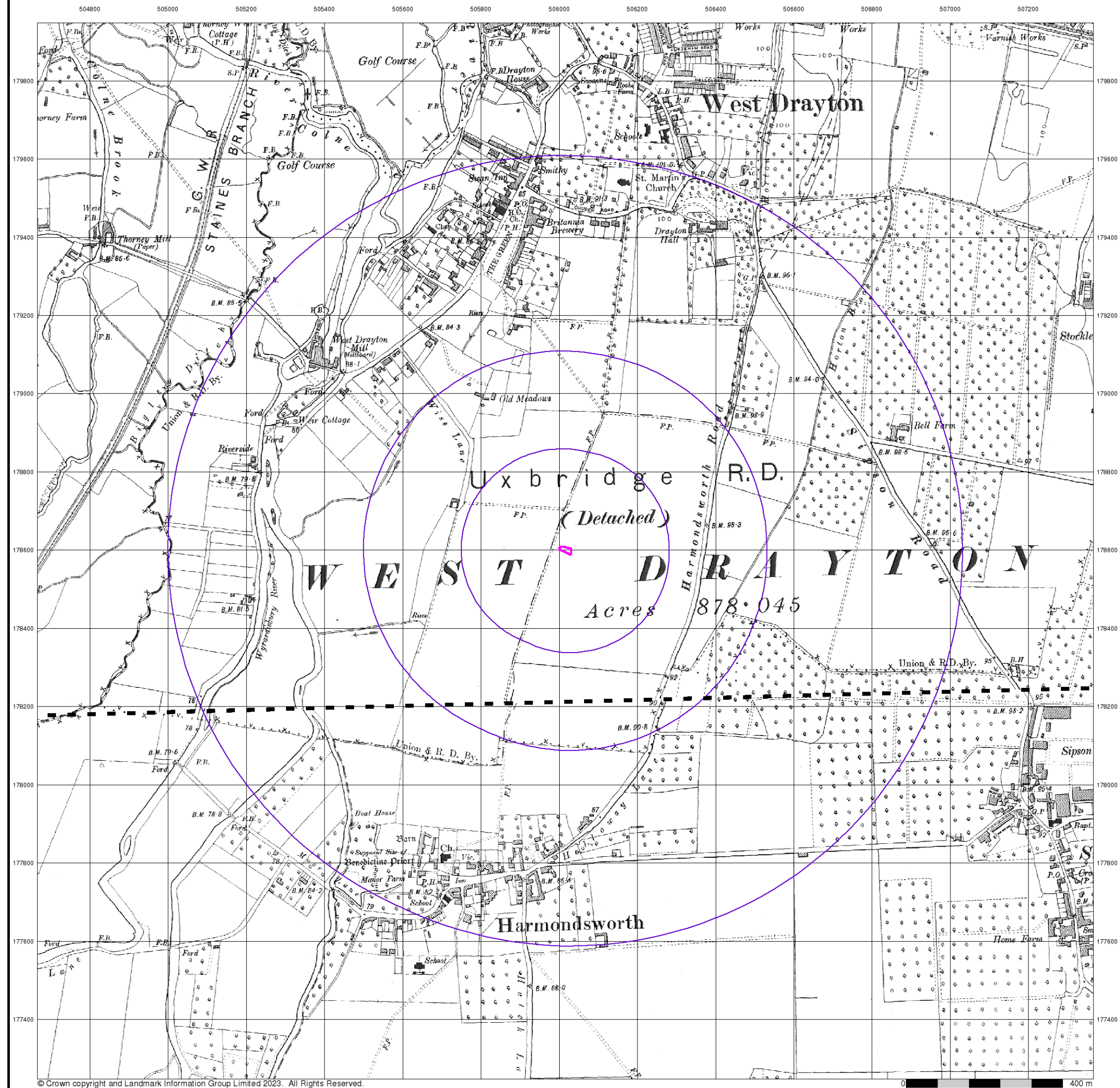

Contaminated  
Land  
Solutions

Middlesex

Published 1915 - 1920

Source map scale - 1:10,560

The historical maps shown were reproduced from maps predominantly held at the scale adopted for England, Wales and Scotland in the 1840's. In 1854 the 1:2,500 scale was adopted for mapping urban areas; these maps were used to update the 1:10,560 maps. The published date given therefore is often some years later than the surveyed date. Before 1938, all OS maps were based on the Cassini Projection, with independent surveys of a single county or group of counties, giving rise to significant inaccuracies in outlying areas. In the late 1940's, a Provisional Edition was produced, which updated the 1:10,560 mapping from a number of sources. The maps appear unfinished - with all military camps and other strategic sites removed. These maps were initially overprinted with the National Grid. In 1970, the first 1:10,000 maps were produced using the Transverse Mercator Projection. The revision process continued until recently, with new editions appearing every 10 years or so for urban areas.

Map Name(s) and Date(s)

014SE
1920
1:10,560
019NE
1915
1:10,560

Historical Map - Slice A

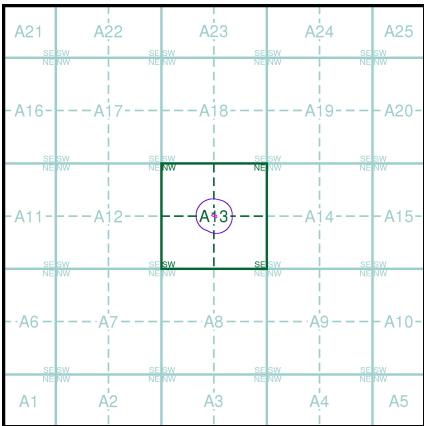

Order Details

Order Number: 316398082\_1\_1  
Customer Ref: 2604  
National Grid Reference: 506020, 178600  
Slice: A  
Site Area (Ha): 0.04  
Search Buffer (m): 1000

Site Details

140, Rowan Road, West Drayton, UB7 7UE

Landmark  
INFORMATION GROUP

Tel: 0844 844 9952  
Fax: 0844 844 9951  
Web: www.envirocheck.co.uk