

NOTES

1. All dimensions are to be checked on site prior to the commencement of work and any discrepancy is to be reported to the construction manager before construction.

2. All work is to comply with current Building Regulations and allied legislation.

3. All contractors and sub-contractors must ensure that they have the latest issue of this drawing and details before the commencement of work on site.

4. All materials are to be used and installed in strict compliance with the relevant manufacturers instructions and recommendations.
5. All works on site, managed and implemented as a result of the designs indicated on this drawing, are to be given full consideration for compliance with the Health and Safety CDM Regulations in respect of design and implementaion on site and no works are to be undertaken if it is considered that compliance with the Building Regulations cannot be achieved.

6. This drawing is not to be scaled.

7. All dimensions shown in millimetres

8. Footprint of buildings shown at1.0m above ground level

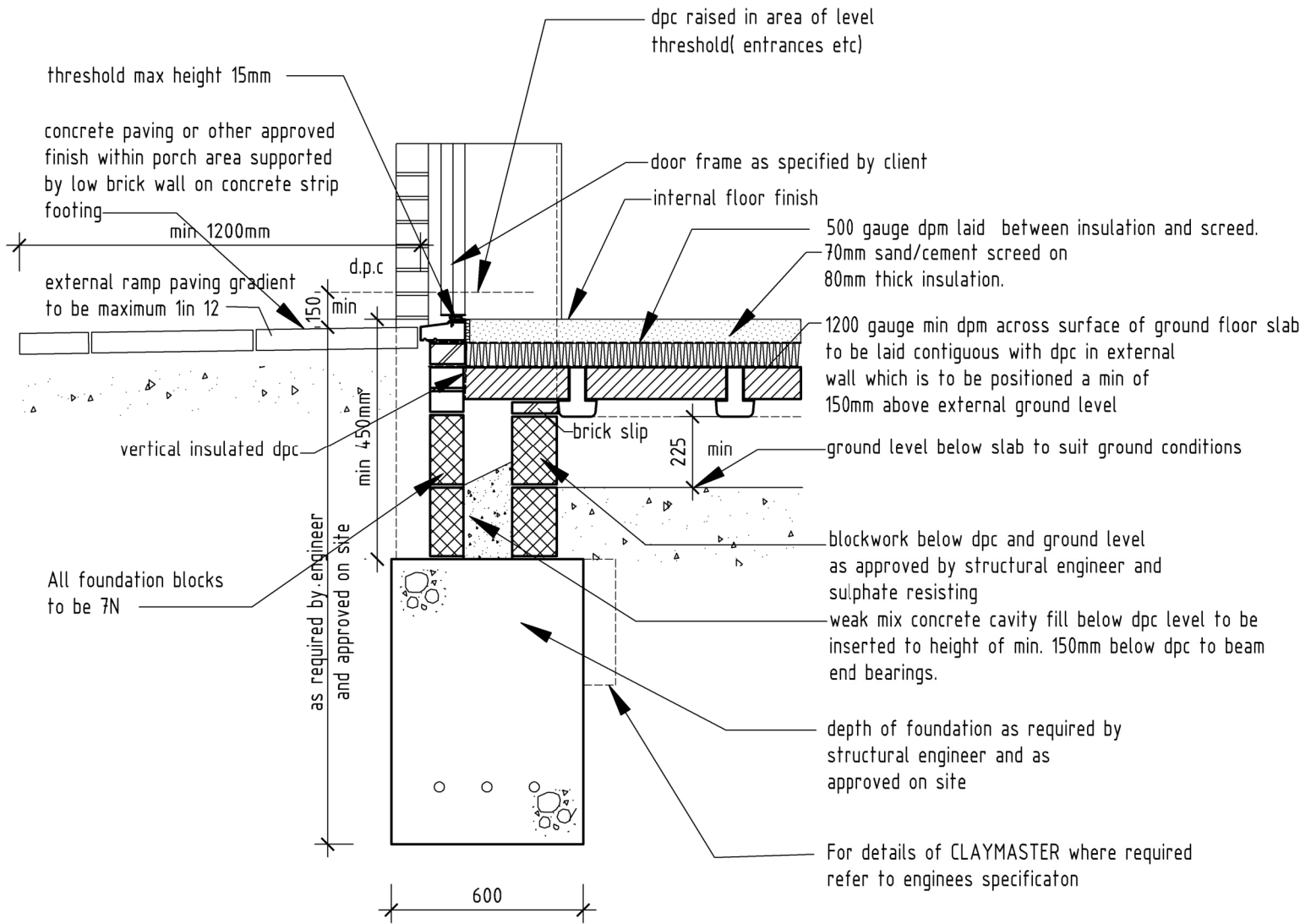
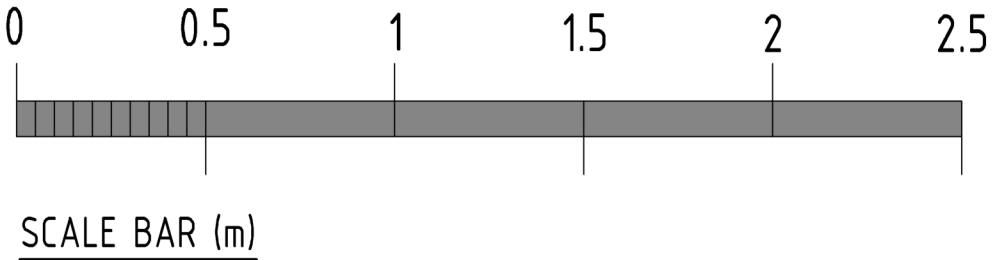

FRONT DOOR MOBILITY THRESHOLD DETAIL

SCALE 1:20

rev	date	info	drawn : JD
scale: 1 : 20 @ A3	date: 26-07-2022	drw no: 597-COC-1	
drawing: FRONT DOOR STEP FREE MOBILITY THRESHOLD DETAIL			
project: 1 BOSTON GROVE RUISLIP MIDDX HA4			
client: MR K. MORBEY			
T: 01895 831551		E: design@jackdusek.co.uk	