

EXISTING SITE PLAN

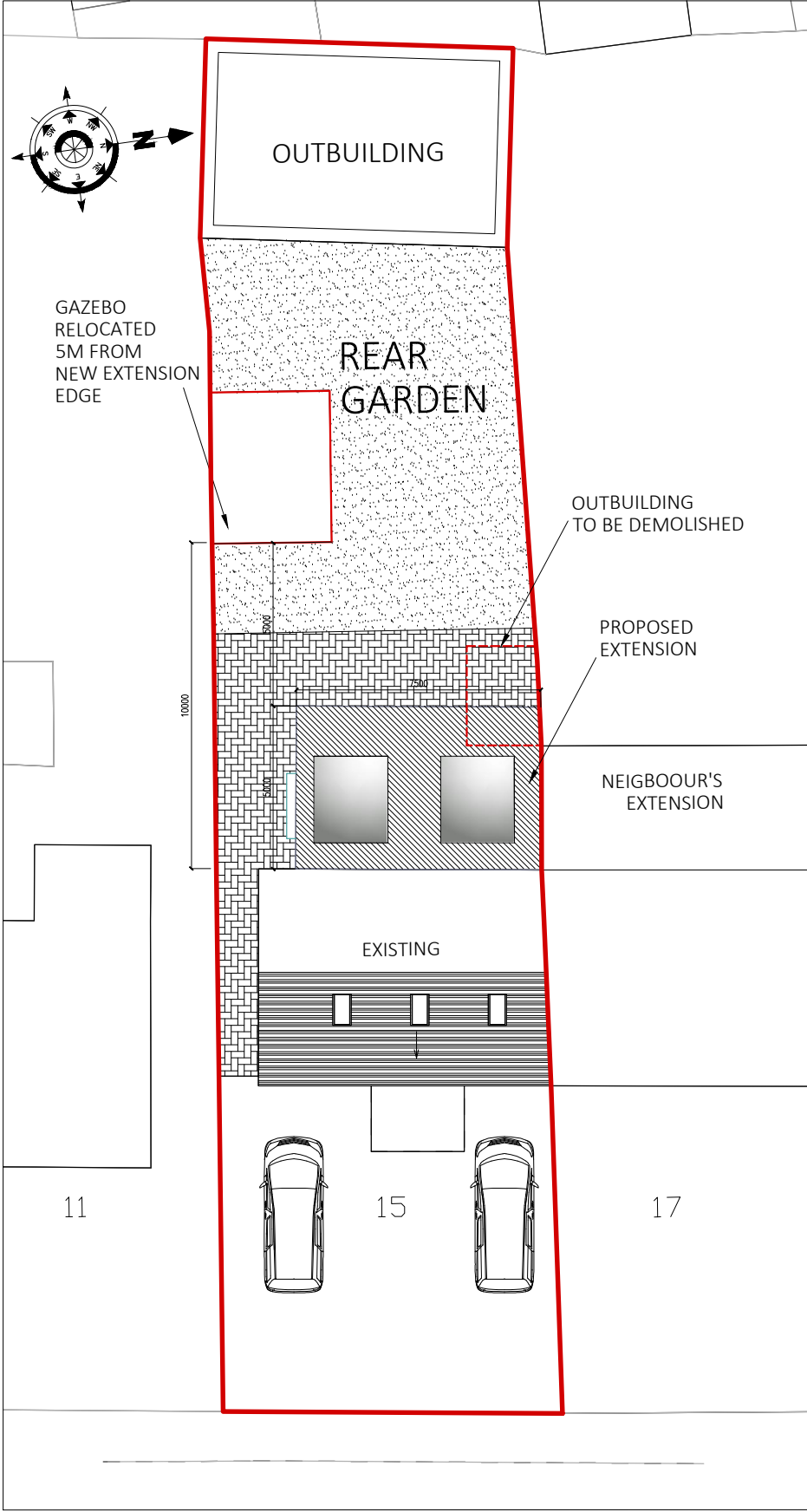

PROPOSED SITE PLAN

PROJECT: 15 CHURCH ROAD,  
HAREFIELD , UB9 6DW  
DRAWING TITLE: PROPOSED SITE PLAN  
DRAWING NUMBER: 15 CR-002  
SCALE: 1:200/A3  
DATE STARTED: 01 JAN. 2023  
REV: B : 01-02-2023

CLIENT: MR. TOM PRZYWARA  
ADDRESS: 15 CHURCH ROAD,  
HAREFIELD,  
UB9 6DW



GENERAL NOTES  
This Drawing is not to be scaled. The contractor must verify all dimensions including tolerances on site prior to commencing works. Any errors or discrepancies found should be reported to RAID immediately. All dimensions shown are in mm unless indicated otherwise. This drawing is to be read in conjunction with the relevant schedule and specifications. For all structural engineering details, foundations and steelwork specifications refer to drawings by the Structural engineer. All work and materials to be in accordance with current applicable Statutory Legislation and to comply with all relevant Codes of Practice and British Standards.  
Copyright ©2022 RAID ARCHITECTURE



RAID ARCHITECTURE  
36 Waterways House  
Bentinck Road  
West Drayton  
UB7 7SG  
Website: raidarchitecture.co.uk  
info@raidarchitecture.co.uk