

Existing Block Plan
Scale 1:200

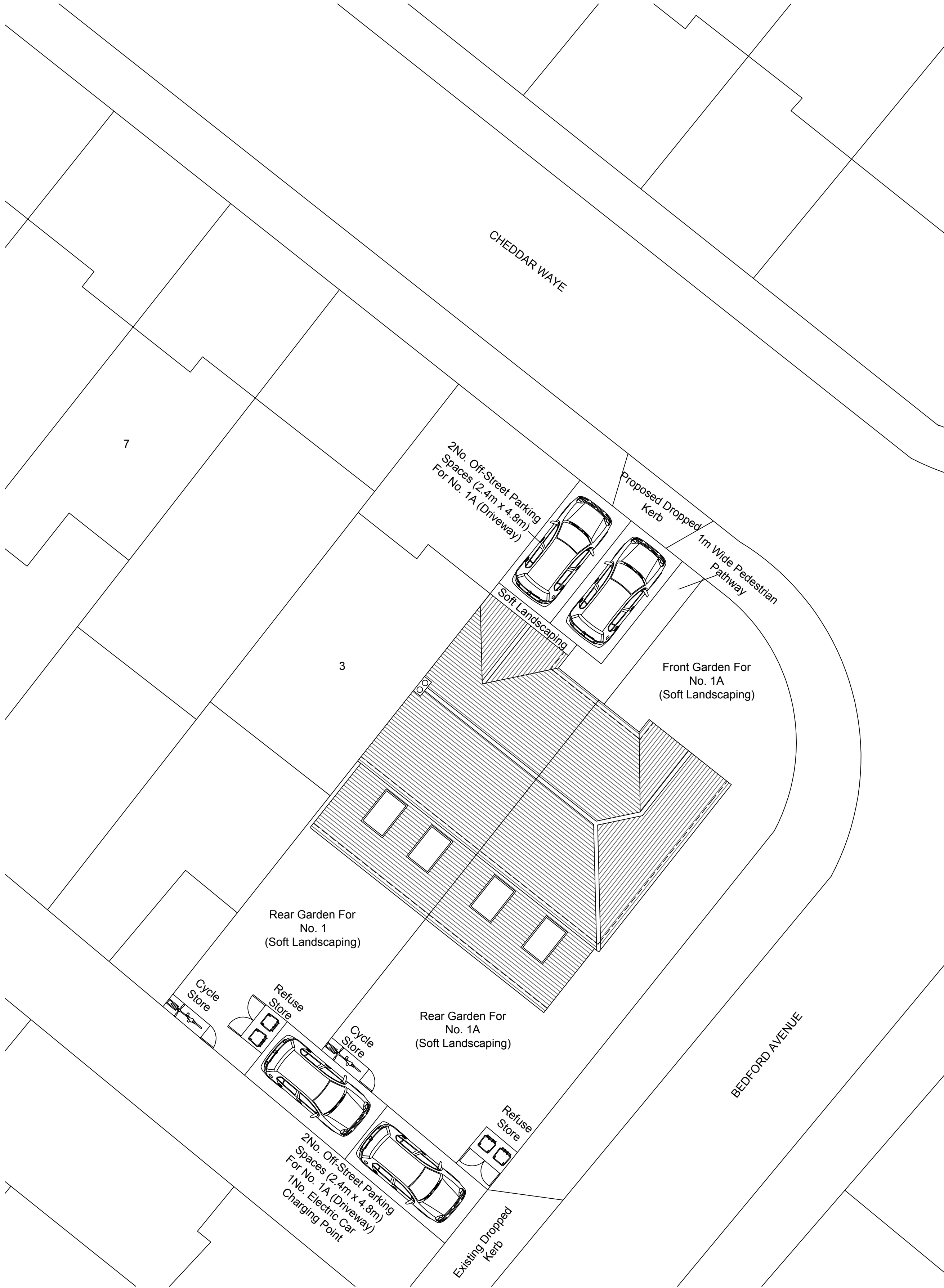

Proposed Block Plan
Scale 1:100

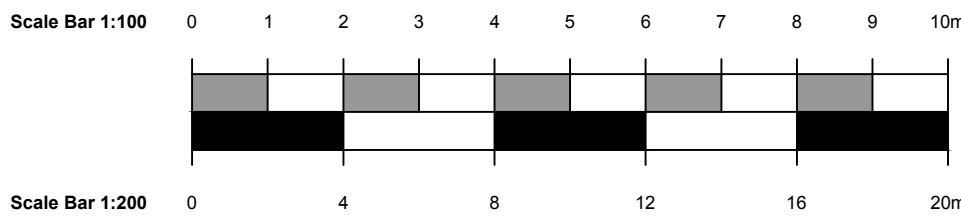

- General Notes:**
1. Dimensions should not be scaled from the drawings where accuracy is essential. Drawings are indicative for planning purposes only.
 2. Details dimensions and levels to be checked on site by builder prior to commencement of works. Any works commenced prior to all necessary local authority approvals are entirely at the risk of the owner & builder.
 3. Structural details are subject to exposure of existing construction and verification by L.A Surveyor and any necessary revised details are to be agreed with the L.A Surveyor prior to carrying out the affected works.
 4. All materials are to be used in accordance with the manufacturers' guidelines and all relevant British Standards Codes of Practice & Regulation 7 of Building Regs.
 5. All works are to be carried out in accordance with Local Authority requirements.
 6. The intended works fall within the Party Wall Act 1996 and any adjoining owners affected must be notified prior to commencement of any works.
 7. Southern Water Authority permission to be obtained prior to works commencing
 8. No part of the extension to project into adjoining boundary lines.

When printing off pdf drawings, it is the responsibility of the user to verify that the resulting prints are to scale on the appropriate sized sheet. Also the scale bar on the plan measure correctly.
All dimensions in millimetres unless stated otherwise



Project:
1 Cheddar Way,
Hayes,
Middlesex, UB4 0DZ.

Title:
Single Storey Rear Extension And
Erection Of An Attached New
Dwelling.

Existing And Proposed Block Plans.

Scale 1:100, 1:200 @ A1

Date May 2022

Drawn Heidi Mangold

Information	Planning	Building Regulations	Construction
<input type="checkbox"/>	<input checked="" type="checkbox"/>	<input type="checkbox"/>	<input type="checkbox"/>

Drawing No. RA1490/REV A/02