

SCALE BAR 1:200

NORTH

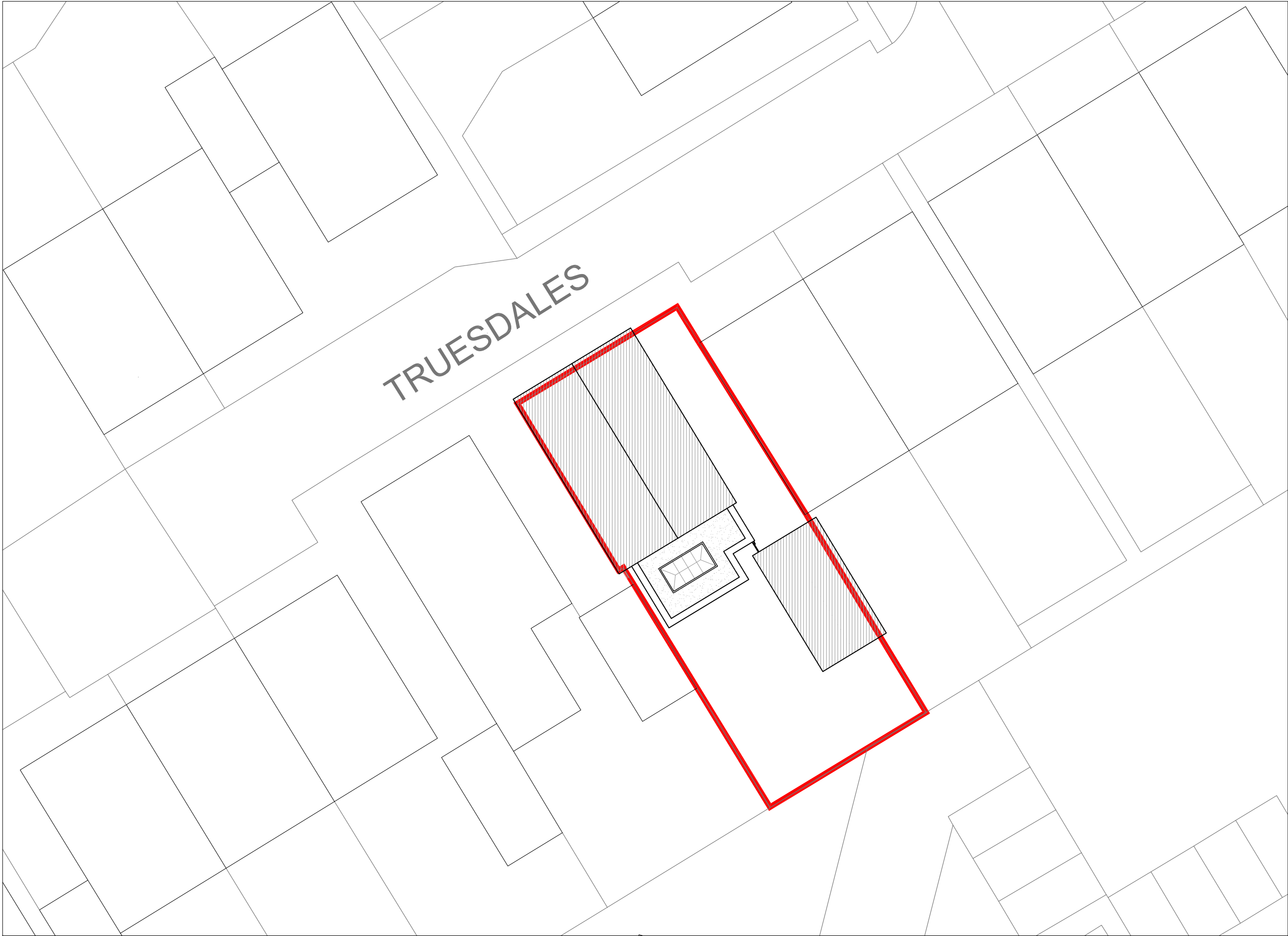

PROPOSED BLOCK PLAN  
SCALE 1:200

Rev	Date	Description	Init.
Client			

MR & MRS JHUTTY

Project Title  
PROPOSED SINGLE STOREY REAR EXTENSION

30 TRUESDALES, ICKENHAM, UB10 8FJ

Drawing Title

PROPOSED BLOCK PLAN

Cad File	Sheet Size	Scale
P001	A3	1:200
Drawn by	Drawing Date	Approved by
SG	JULY 2020	NJ
Project No.	Drawing No.	Revision
1795	P103	-



Argyle House, Joel Street,  
Northwood Hills, Middlesex, HA6 1NW

1 01923 840077 1 01923 840078  
info@jutla-architects.com  
jutla-architects.com

This drawing is property of Jutla Architects Ltd © and must not be  
copied or otherwise reproduced. All dimensions must be checked on  
site before commencing work. No dimensions to be scaled from this  
drawing. This drawing was produced using AutoCad 2016.

PLANNING ISSUE