

Appendix D

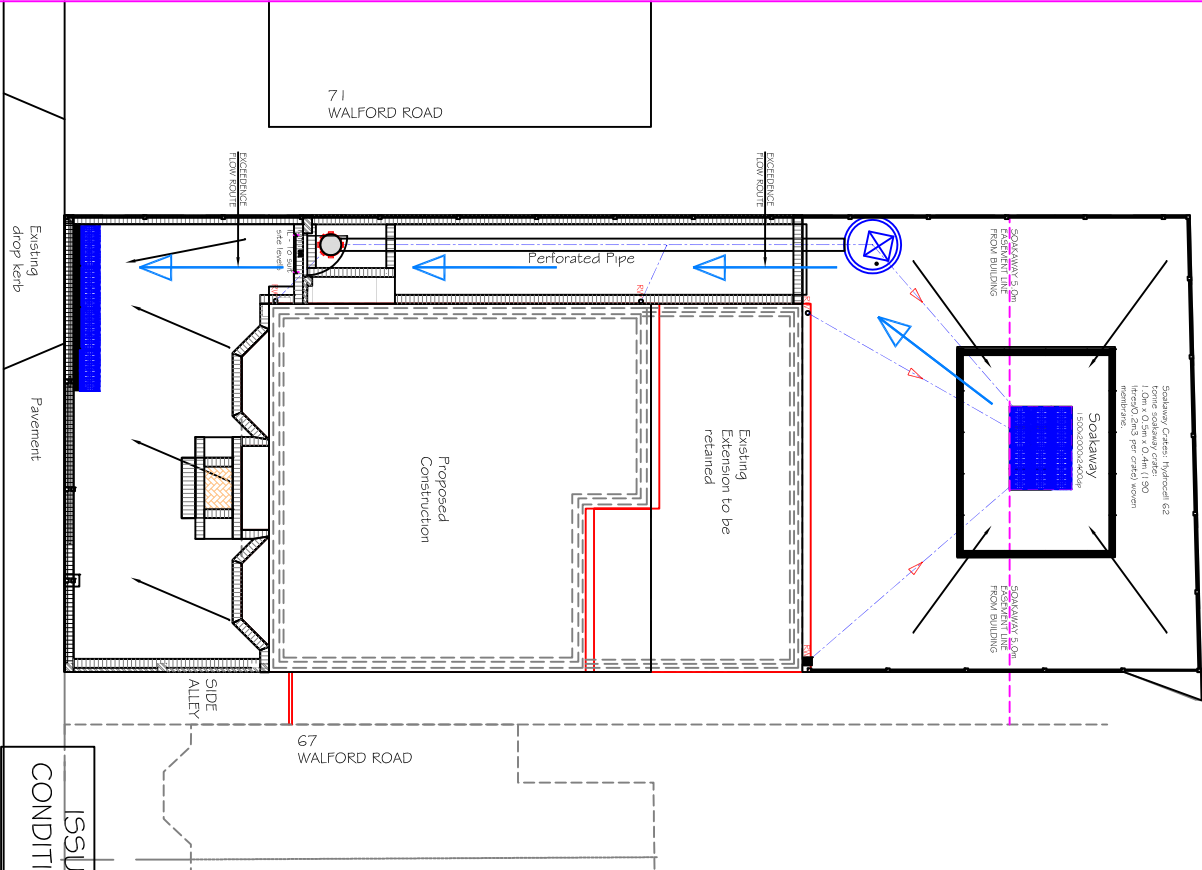

NOTES

1. THIS DRAWING HAS BEEN PRODUCED FOR PLANNING CONDITIONS SIGN-OFF USING THE AVAILABLE INFORMATION TO DATE. FURTHER STRUCTURAL CO-ORDINATION AND PENETRATION DETAILS TO BE CONFIRMED HOWEVER THE PRINCIPLES OF THIS DRAINAGE SYSTEM TO ADHERE TO THIS DRAINAGE STRATEGY.
2. WORKS IN THE VICINITY OF LIVE SERVICES INCLUDING GAS, ELECTRICITY AND BT WILL BE NECESSARY AND THE ADVICE OF ALL STATUTORY SERVICE COMPANIES MUST BE SOUGHT BEFORE ANY WORKS COMMENCE.
3. THE CONTRACTOR WILL BE RESPONSIBLE FOR LOCATING ALL EXISTING SERVICES WITHIN THE VICINITY OF THE WORKS HAND DUG AND ENSURE THESE ARE PROTECTED THROUGHOUT THE DURATION OF THE WORKS. ALL UTILITY PLANT SHOULD BE CLEARLY MARKED ON THE GROUND PRIOR TO COMMENCEMENT OF THE WORKS.
4. DO NOT USE THIS DRAWING FOR CONSTRUCTION PURPOSES UNTIL ALL FINAL DETAILS HAVE BEEN FROZEN AND APPROVED AND THIS DRAWING HAS BEEN UPDATED TO SUIT FOR THE PURPOSES OF CONSTRUCTION.
5. EXTERNAL GULLIES/ACO CHANNELS TO BE CONFIRMED BY ARCHITECT. HARD STANDING LEVELS AND FALLS TO BE CONFIRMED BY ARCHITECT/CONTRACTOR.
6. SURFACE FINISHES, PERMEABILITY, LOADING AND TYPE TO BE CONFIRMED BY ARCHITECT POST-PLANNING.
7. A DETAILED MAINTENANCE PLAN IS TO BE PREPARED UPON FULL CO-ORDINATION AND SPECIFICATION OF THE DRAINAGE SYSTEM. MAINTENANCE PLAN SHOULD BE RETAINED ON SITE AND A COPY TO BE KEPT BY A MANAGEMENT ORGANISATION.
8. REFER TO INFILTRATION TEST REPORT UNDERTAKEN BY JAYSTONES FOR NIKJOO LTD. THE TEST REPORT HAS BEEN UNDERTAKEN TO BRE 365 AND INFILTRATION RATES HAVE BEEN EXTRACTED ACCORDINGLY.

MAINTENANCE SCHEDULE		
PRODUCT	REQUIRED ACTION	RECOMMENCED FREQUENCY
CHANNEL, DRAINS YARD & PAVED GULLIES	INSPECT GRILLES & INVERTS ARE FREE OF LEAVES & DETRITUS - REMOVE AS REQUIRED	EVERY 6 MONTHS AND AFTER AUTUMN LEAF FALL
PIPES	REMOVE SILT & DETRITUS	EVERY 12 MONTHS PRIOR TO WINTER
CATCHPITS	REMOVE SILT & DETRITUS	EVERY 6 MONTHS AND AFTER AUTUMN LEAF FALL

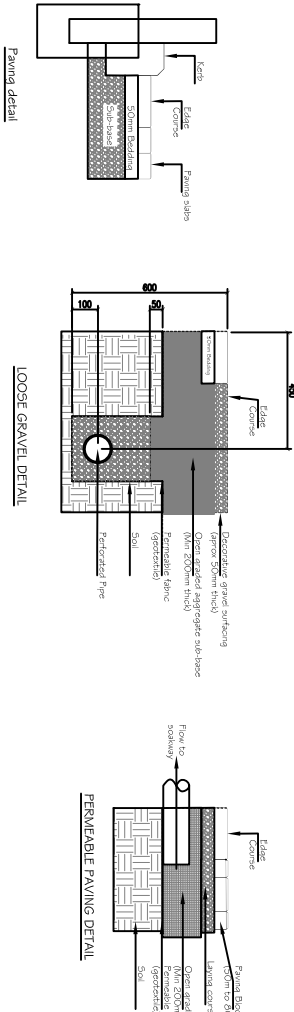

ISSUED FOR PLANNING
CONDITIONS APPROVAL ONLY

Har - Gunn Associates Ltd

Tel: 020 917 9296
Mob: 07803 619161

Email: hargunn@aol.com
www.hargunn.co.uk

Rev

Revision Note

Drawing Name

SUD5 measure and specifications
Condition 4

Location

69 Walford Road
Uxbridge, UB8 2NQ

Scale

NTS

Dwg No

1765 / 2024 / DR-01

Date

April 2024

Rev

This drawing remains the property of H.A.R. - Gunn Associates Ltd and shall not be reproduced or altered without prior written permission.

Do not scale off drawings. Check all dimensions on site and report any discrepancies before commencing work. All figured dimensions are millimeters unless noted otherwise.