

File: \\URP-HF01\DATA\REGIONAL WORKS\DRWS\PURE\1\2000\PART15489 - ARK PROJECT UNION PARK ISSUE 1\2021.10.15 STAGE 3 ISSUE 3 EWN 60H - CMLS\HPF-0471-XX-XX-DR-C-95150.DWG User: Domesdale, Ulrich Sheet: HPF-Pur Date: 14/10/2021 10:27:34

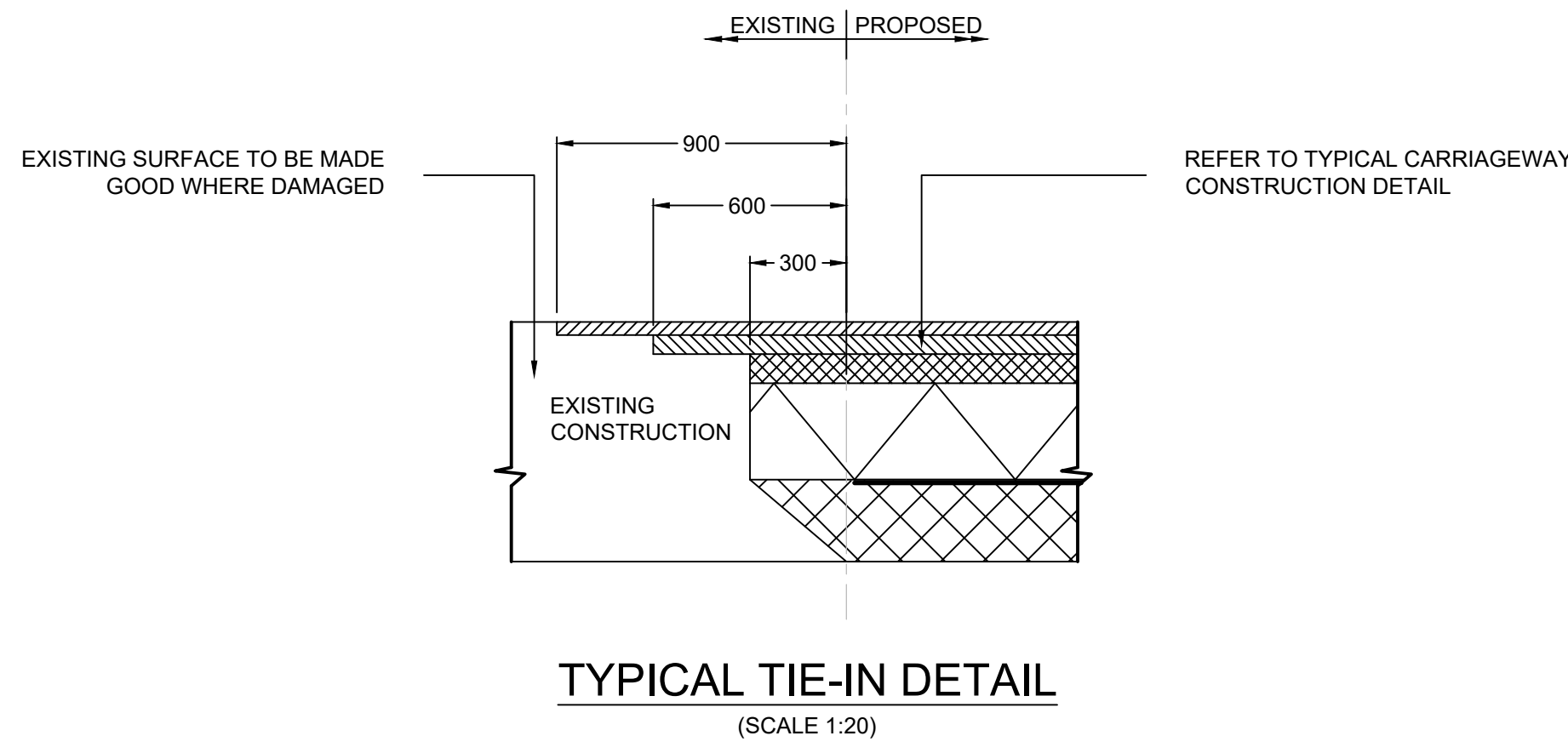
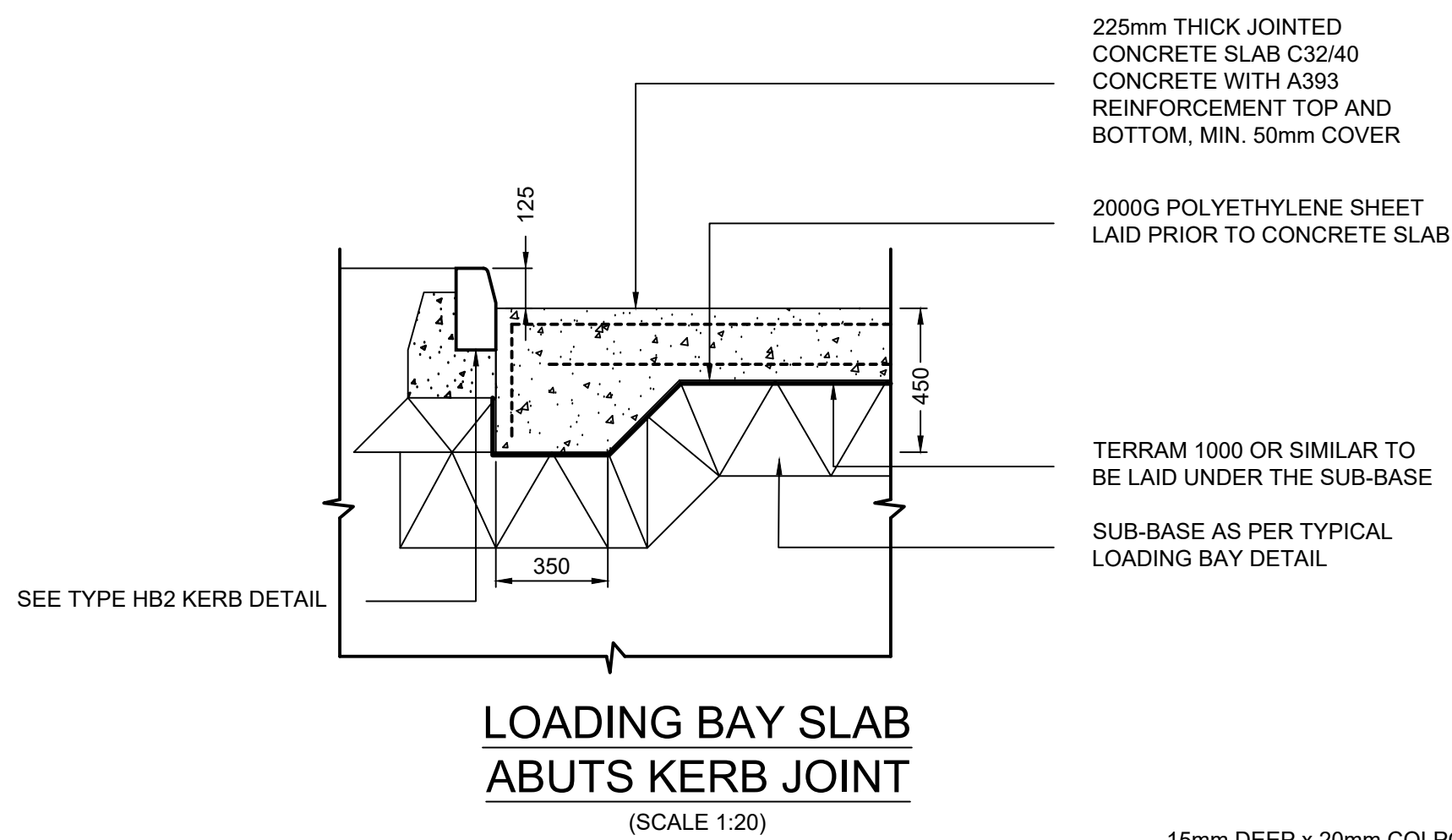
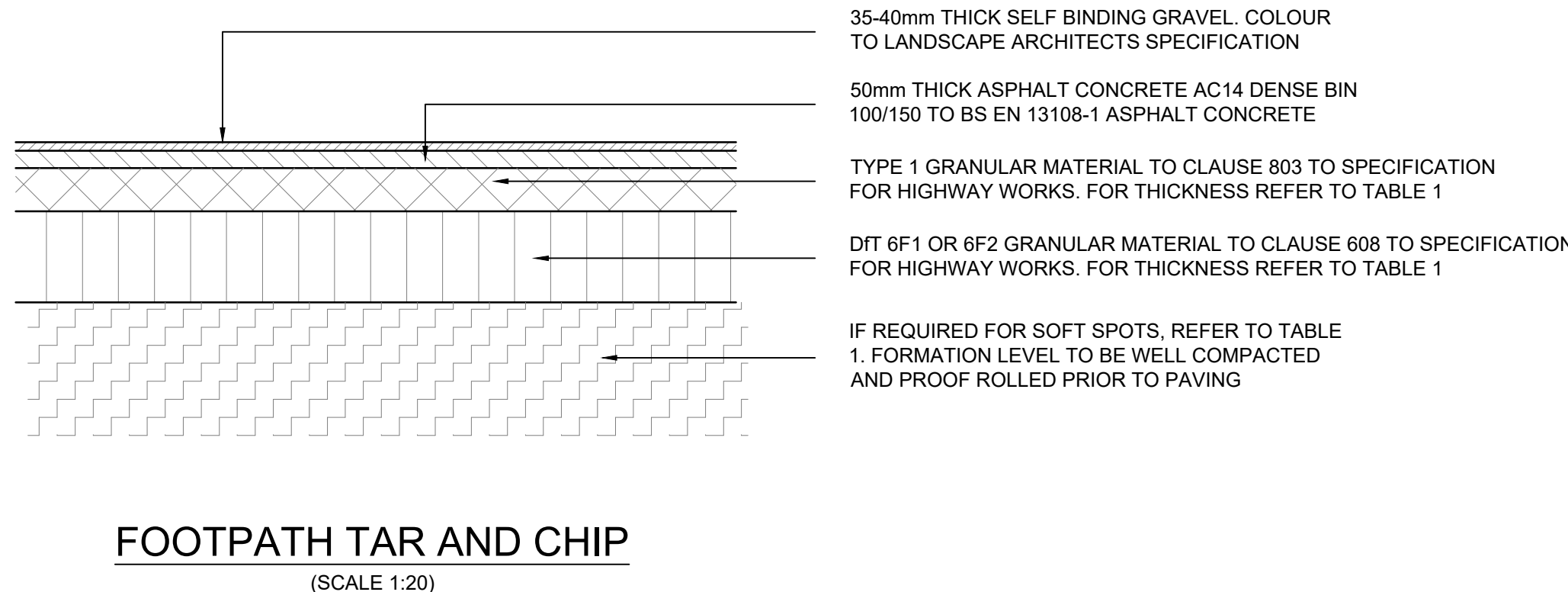
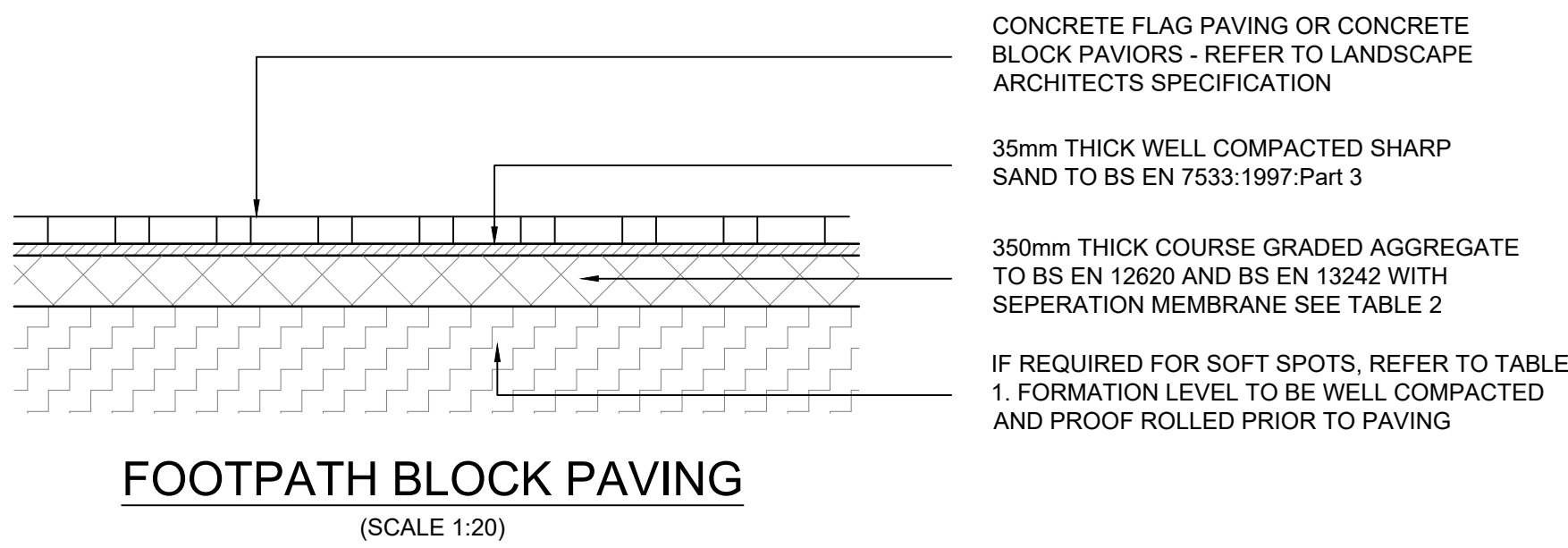
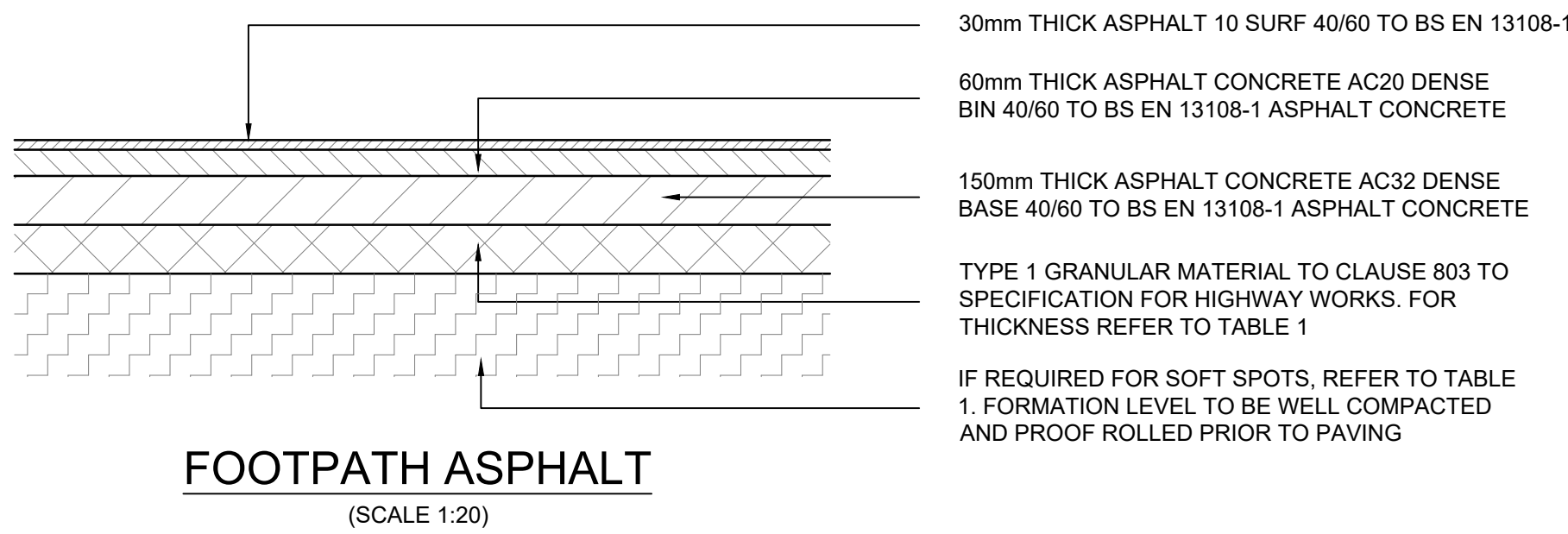
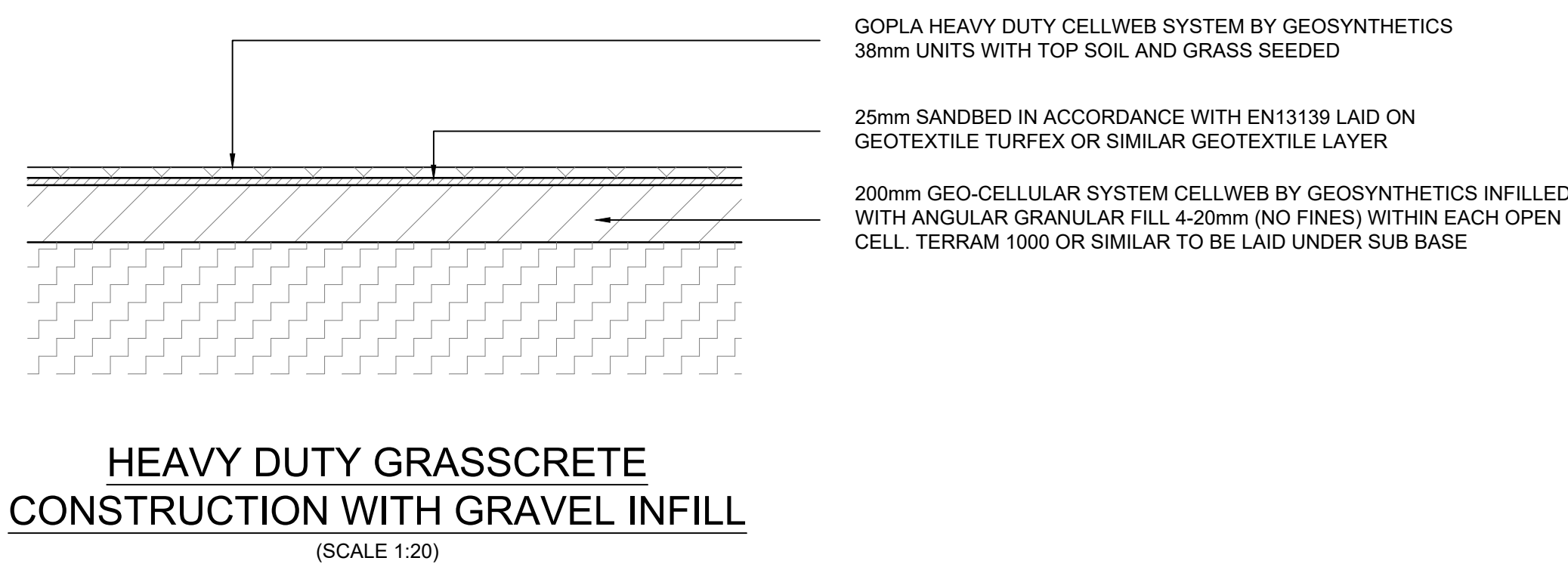
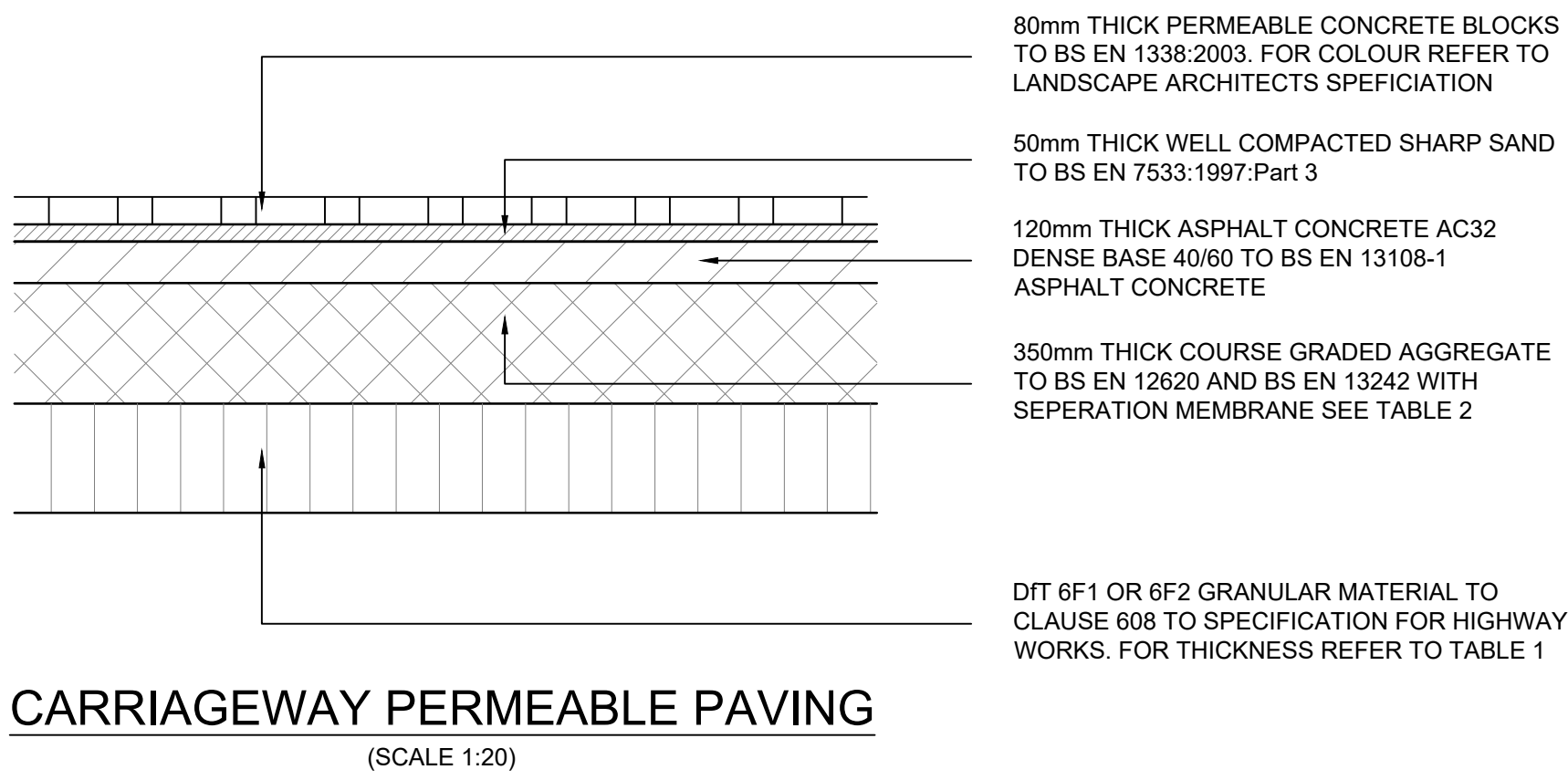
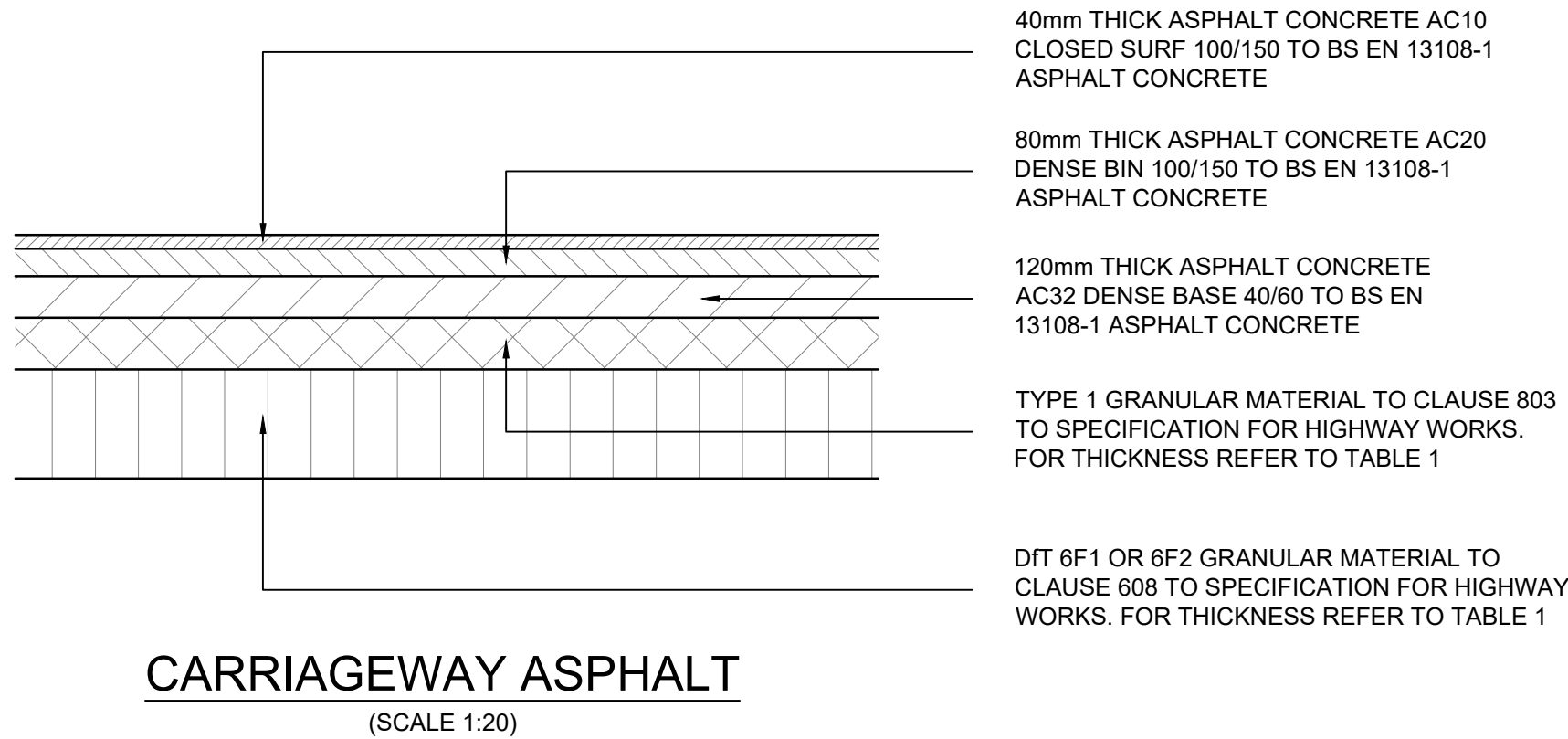

TABLE 2 - PERMEABLE PAVING AGGREGATE

420mm COARSE GRADED PERMEABLE PAVING AGGREGATE	
SIEVE SIZE (mm)	PERCENTAGE PASSING
40	100
31.5	98-100
20	90-99
10	25-70
4	0-15
2	0-5

ALL MATERIALS USED AS PERMEABLE PAVING AGGREGATE MUST COMPLY TO THE GRADING AND PHYSICAL REQUIREMENTS ABOVE. AS WELL AS THE GENERAL REQUIREMENTS OF BS EN 12620 AND BS EN 13242. SUB-BASE MATERIALS SHOULD BE CLEAN, SOUND, NON-FRIABLE AND SOUND CRUSHED ROCK MATERIAL. ROUNDED GRAVEL AND SAND MATERIALS ARE NOT RECOMMENDED FOR SUB-BASE LAYERS.

THE CONTRACTOR SHALL ALSO ENSURE THAT ON-GOING DELIVERIES TO SITE ARE CHECKED FREQUENTLY FOR GRADING, SHAPE AND INSPECTED TO ENSURE CLEANLINESS.

DURING INSTALLATION ON SITE, AGGREGATES MUST BE KEPT FREE OF CONTAMINATION OR DELETERIOUS MATTER. CONSTRUCTION TRAFFIC CANNOT BE ALLOWED TO TRAVERSE THE LAYERS OF THE SUB-BASE PERMEABLE PAVING AGGREGATE LAYERS DURING CONSTRUCTION.

440mm COARSE GRADED PERMEABLE PAVING AGGREGATE	
SIEVE SIZE (mm)	PERCENTAGE PASSING
80	100
63	98-100
40	90-99
31.5	-
20	25-70
10	-
4	0-15
2	0-5

TABLE 1 - CAPPING/SUB-BASE THICKNESS DETAILS TO MAIN ACCESS CARRIAGEWAY

CBR	Capping	Sub-Base
1-2%	600mm	150mm
>2%<2.5%	450mm	150mm
>2.5%<5%	350mm	225mm or 350mm (No Capping)
>5%<15%	Not Required	225mm
> 15%	Not Required	225mm

SUB-BASE MATERIAL SHALL BE TYPE 1 TO CLAUSE 803 OF THE DFT'S SPECIFICATION FOR HIGHWAY WORKS.

CAPPING MATERIAL SHALL BE SELECTED FROM THE FOLLOWING MATERIALS ALL OF WHICH MUST COMPLY WITH TABLE 6/1 OF THE DFT'S SPECIFICATION FOR HIGHWAY WORKS.

-CLASS 6F1, CLASS 6F2, CLASS 6F3, CLASS 6F4, CLASS 6F5

ADDITIONAL NOTES

THE ENGINEER IS TO BE CONSULTED WHERE CBR VALUES ARE <1%.

NO FROST SUSCEPTIBLE MATERIALS SHALL BE USED IN CONSTRUCTION WITHIN 450MM OF THE SURFACE.

SOFT SPOTS AT FORMATION LEVEL TO BE REMOVED AND FILLED WITH CAPPING MATERIAL OR CRUSHED CONCRETE.

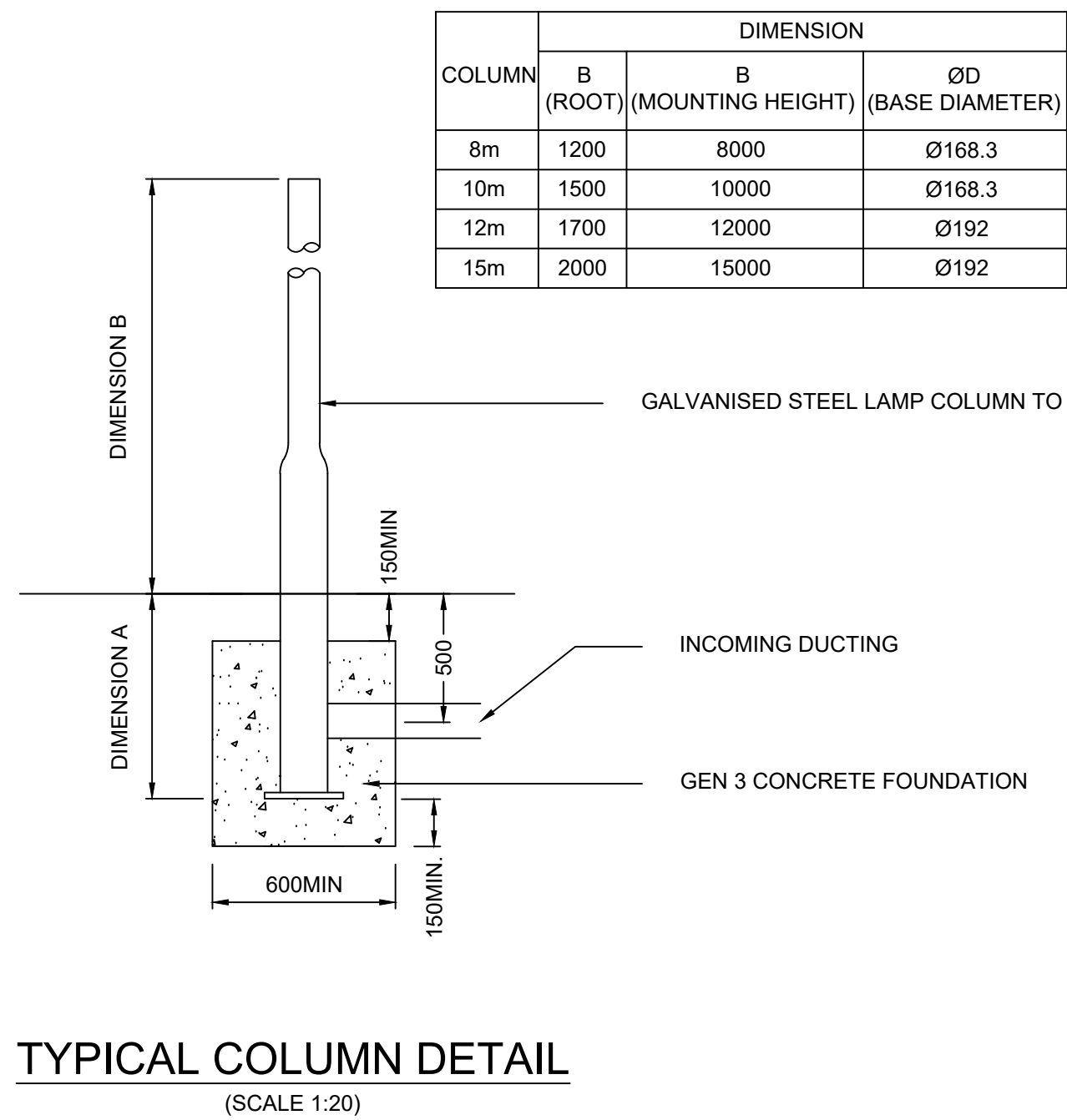
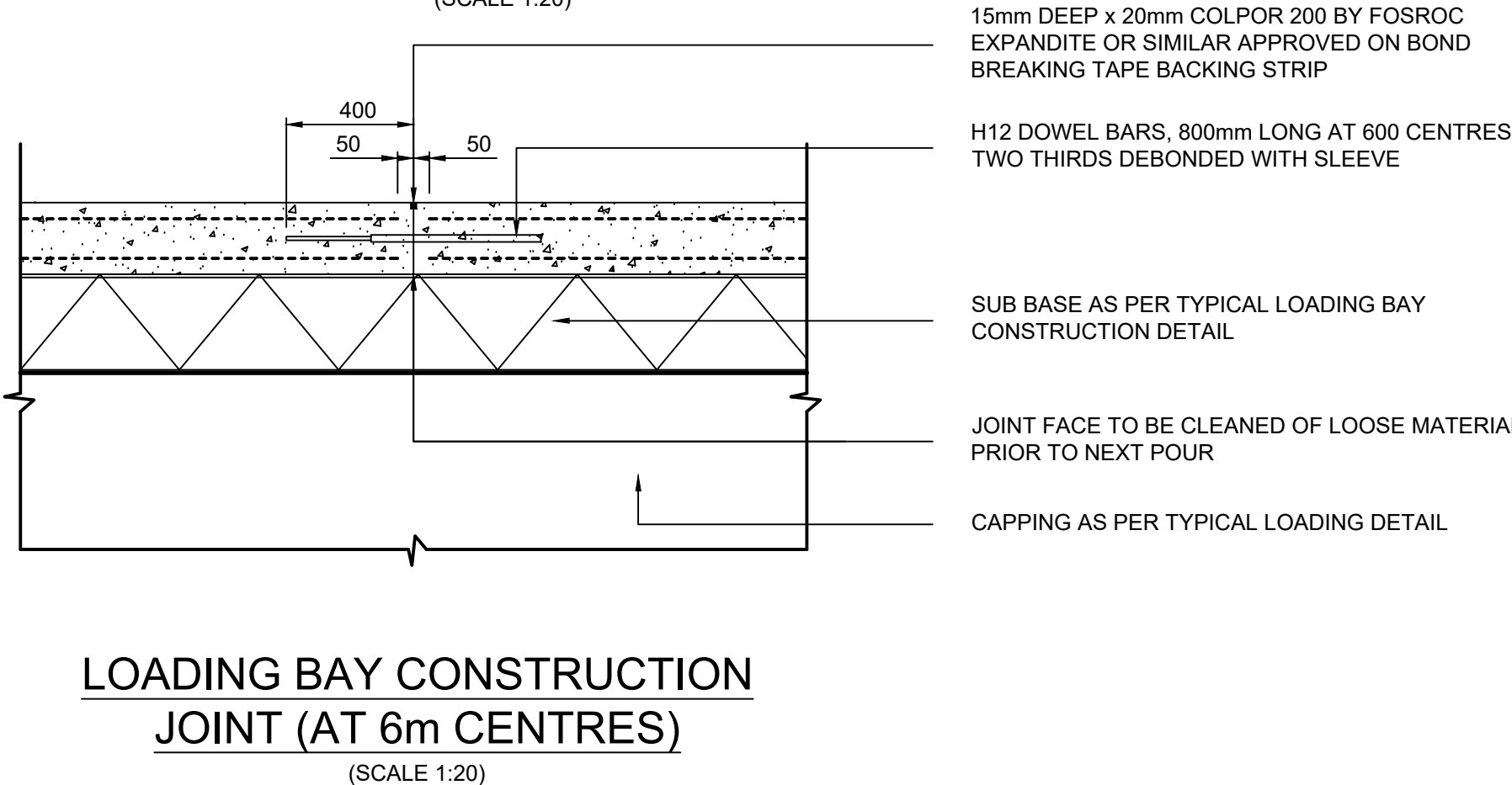

COLUMN	DIMENSION		ØD (BASE DIAMETER)
	B (FOOT)	B (MOUNTING HEIGHT)	
8m	1200	2000	Ø168.3
10m	1500	10000	Ø168.3
12m	1700	12000	Ø192
15m	2000	15000	Ø192

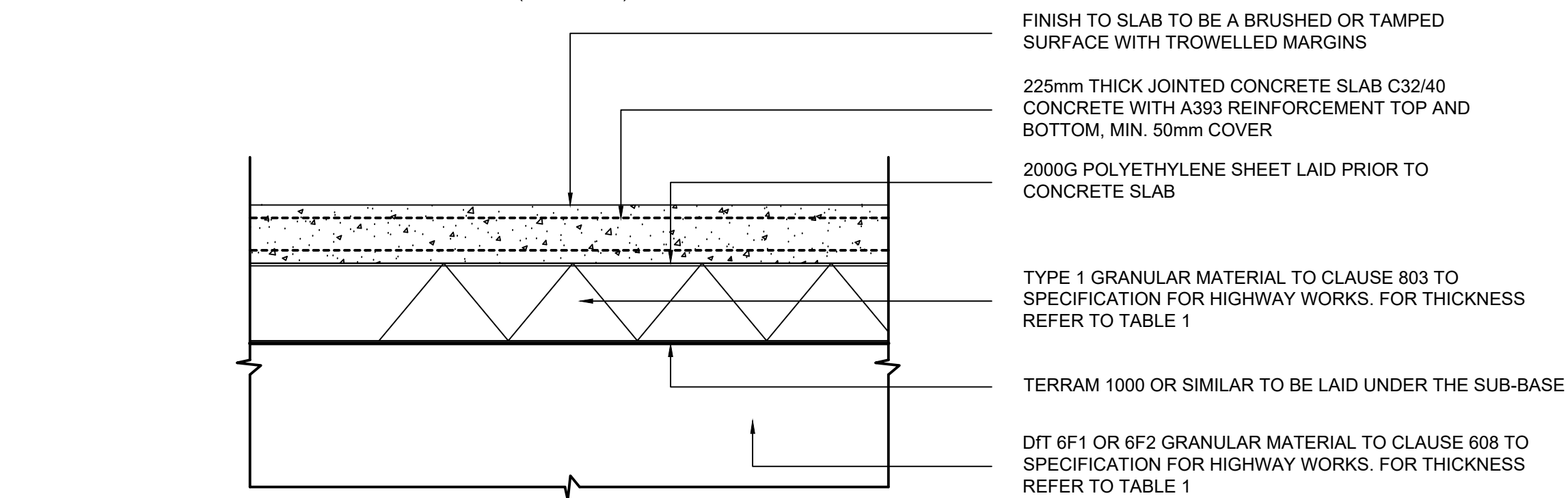
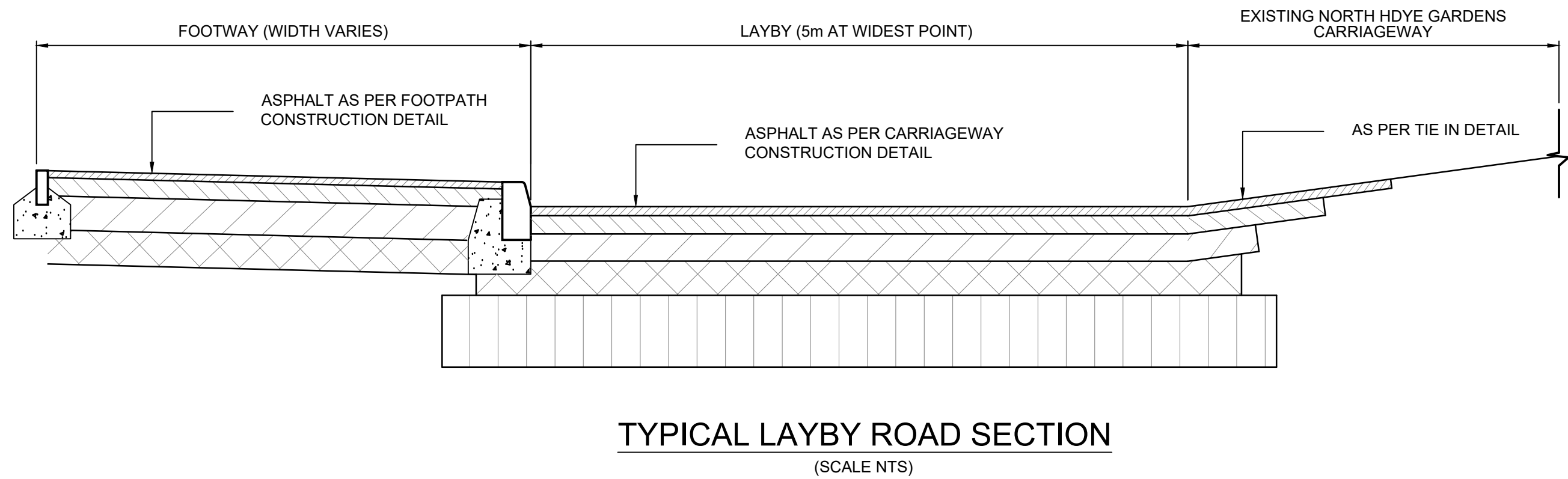

CYCLE STORAGE FOUNDATION TYPICAL EDGE DETAIL (SCALE 1:20)

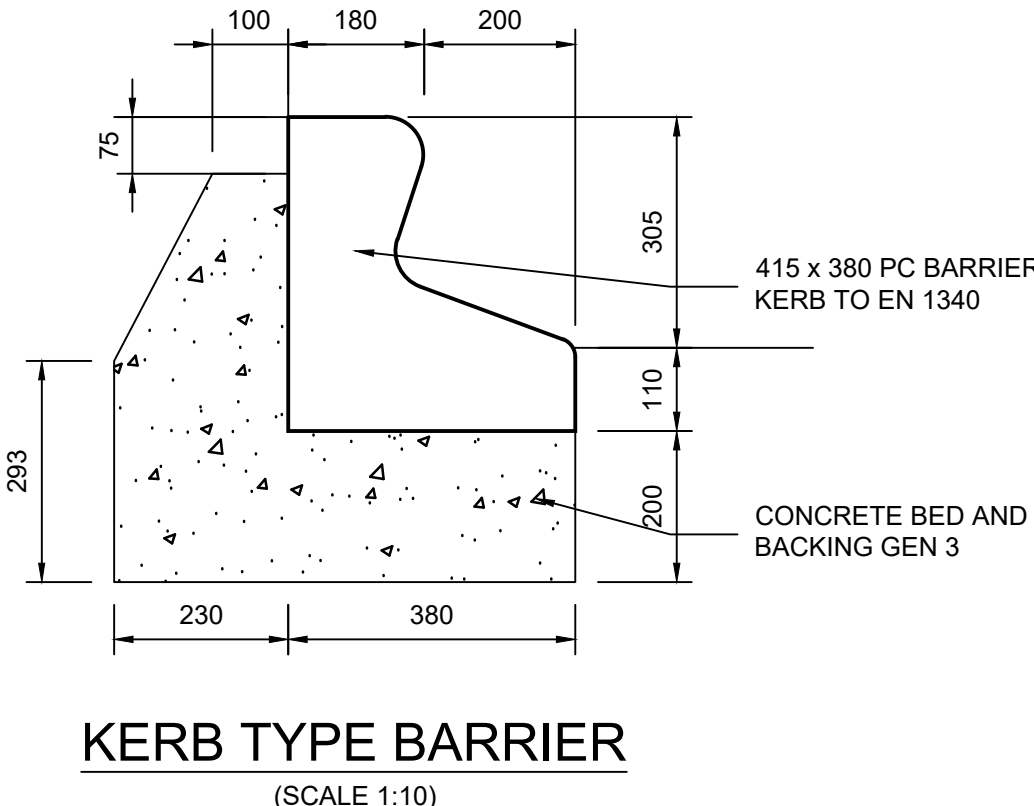
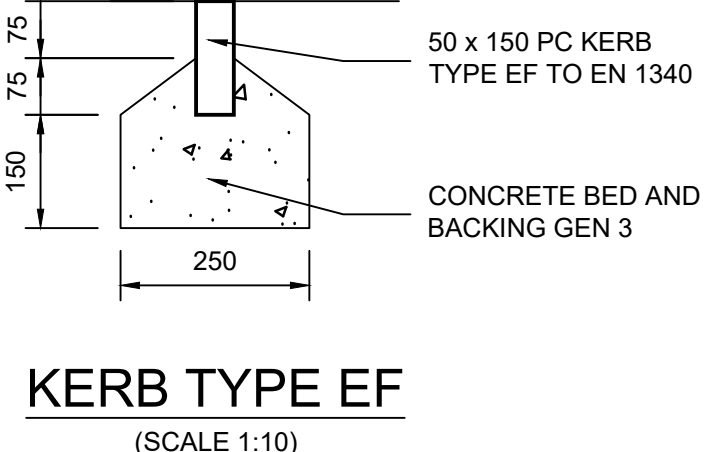
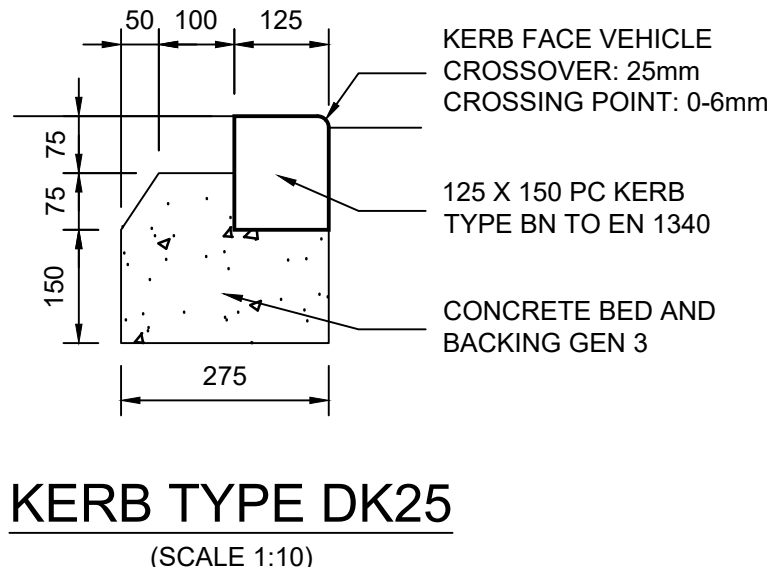
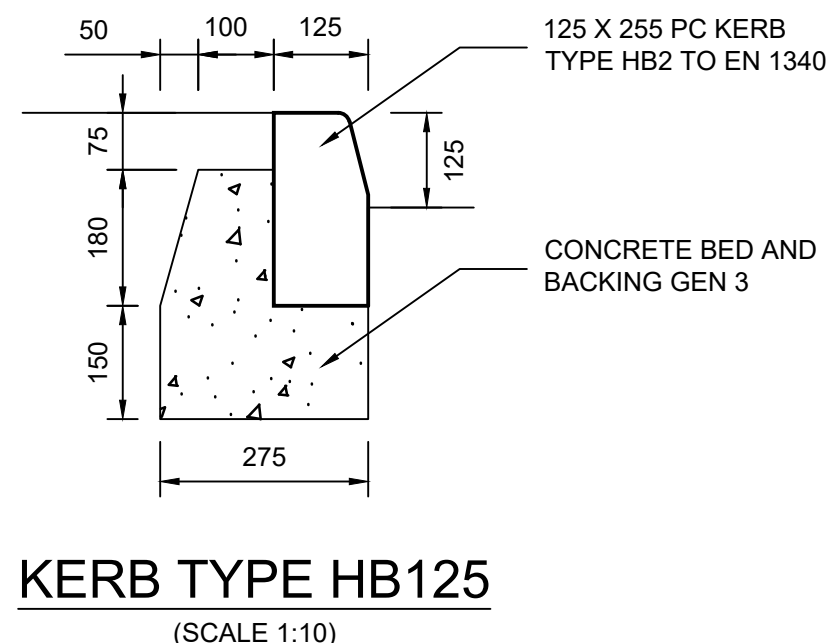
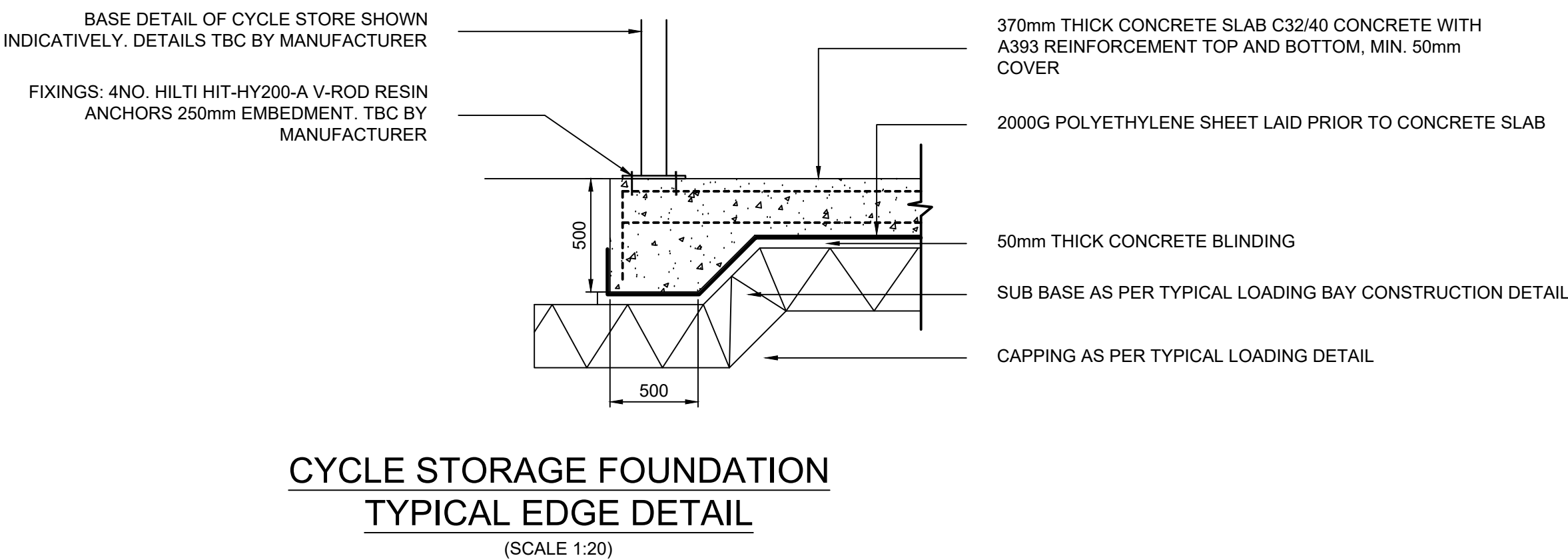

© THIS DRAWING IS THE COPYRIGHT PROPERTY OF HDR | Hurley Palmer Flatt AND IS THEREFORE CONFIDENTIAL AND MUST NOT BE LENT, COPIED, REPRODUCED IN ANY WAY WHATSOEVER WITHOUT WRITTEN PERMISSION.

NOTES:

- THIS DRAWING MUST NOT BE USED FOR CONSTRUCTION OR INSTALLATION PURPOSES UNLESS EXPRESSLY STATED.
- DO NOT SCALE OFF THIS DRAWING. ALWAYS WORK TO NOTED DIMENSIONS.
- ALL DIMENSIONS MUST BE VERIFIED ON SITE BEFORE COMPLETING SHOP DRAWINGS OR SETTING OUT THE WORKS.
- THIS DRAWING IS TO BE READ IN CONJUNCTION WITH THE SCOPE OF WORKS AS PREPARED BY HDR | Hurley Palmer Flatt.
- THIS DRAWING IS TO BE READ IN CONJUNCTION WITH ALL ARCHITECTURAL AND STRUCTURAL ENGINEER'S DRAWINGS AND ASSOCIATED HDR | Hurley Palmer Flatt DRAWINGS.

PD3	STAGE 3	ISSUE - EWN 60H	15.10.21
PD2	STAGE 3	ISSUE	16.04.21
PD2	STAGE 3	ISSUE	9.10.20
PD1	TENDER	ISSUE	30.7.20
Revision	Description	Date	
STAGE 3		S3	

HPF Hurley Palmer Flatt	
4th Floor Knollys House 17 Addiscombe Road Croydon, CR0 6SR United Kingdom	t +44 (0) 20 8763 5900 e info@hurleypalmerflatt.com w www.hurleypalmerflatt.com
Client: ARK DATA CENTRES	
Architect: NWA	
Project: UNION PARK	
Title: HIGHWAYS DETAILS	
HDR HPF Project Number: PUR15469	
Cat File Name: HPF-0471-XX-XX-DR-C-95150	
Drawn: DH	Check/Approved: CR
Date: 14.10.2021	Scale @ A0: 1:20
Drawings Number: HPF-0471-XX-XX-DR-C-95150	Revision: P03