

ARUNDEL ROAD

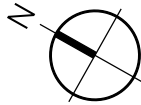

THIS DRAWING IS PROTECTED BY COPYRIGHT AND MUST NOT BE COPIED OR REPRODUCED WITHOUT THE WRITTEN CONSENT OF R.G. PARTNERSHIP LIMITED. NO DIMENSIONS ARE TO BE SCALED FROM THIS DRAWING. ALL DIMENSIONS AND SIZES TO BE CHECKED ON SITE. NORTH POINTS SHOWN ARE INDICATIVE. ©

SITE SPECIFIC HAZARDS

IN ACCORDANCE WITH THE REQUIREMENTS OF THE CDM REGULATIONS 2015 THE FOLLOWING SIGNIFICANT RESIDUAL HAZARDS HAVE NOT BEEN DESIGNED OUT OF THIS PROJECT AND MUST BE TAKEN INTO CONSIDERATION BY CONTRACTORS PLANNING TO UNDERTAKE THE WORKS SHOWN ON THIS DRAWING:

SCHEDULE OF MATERIAL

READ TOGETHER WITH RGP NBS SPEC.

1. Precast concrete kerb. NBS Ref.Q10/110A
- 1R. Raised kerb
- 1F. Flush kerb
- 1P. Pin kerb
2. Road marking, NBS Ref. K10/156
3. Concrete block paving, NBS Ref. Q24/115A
4. Tactile flag paving, NBS Ref. Q25/320A
5. Palisade fence, NBS Ref. Q40/350
6. Anti-ram raid SS bollards, (circled) NBS Ref. Q50/190
7. Cycle stands, NBS Ref. Q50/210A
8. Asphalt surface suitable for box vans and small vans to contractor eng. spec
9. Surface water drainage as per S.E details.
10. Hit and Miss timber enclosure
11. Concrete flag paving. NBS Ref. Q25/315A
12. Crash barrier NBS Ref. Q41/135
13. Steel Cycle stands (4 no.)

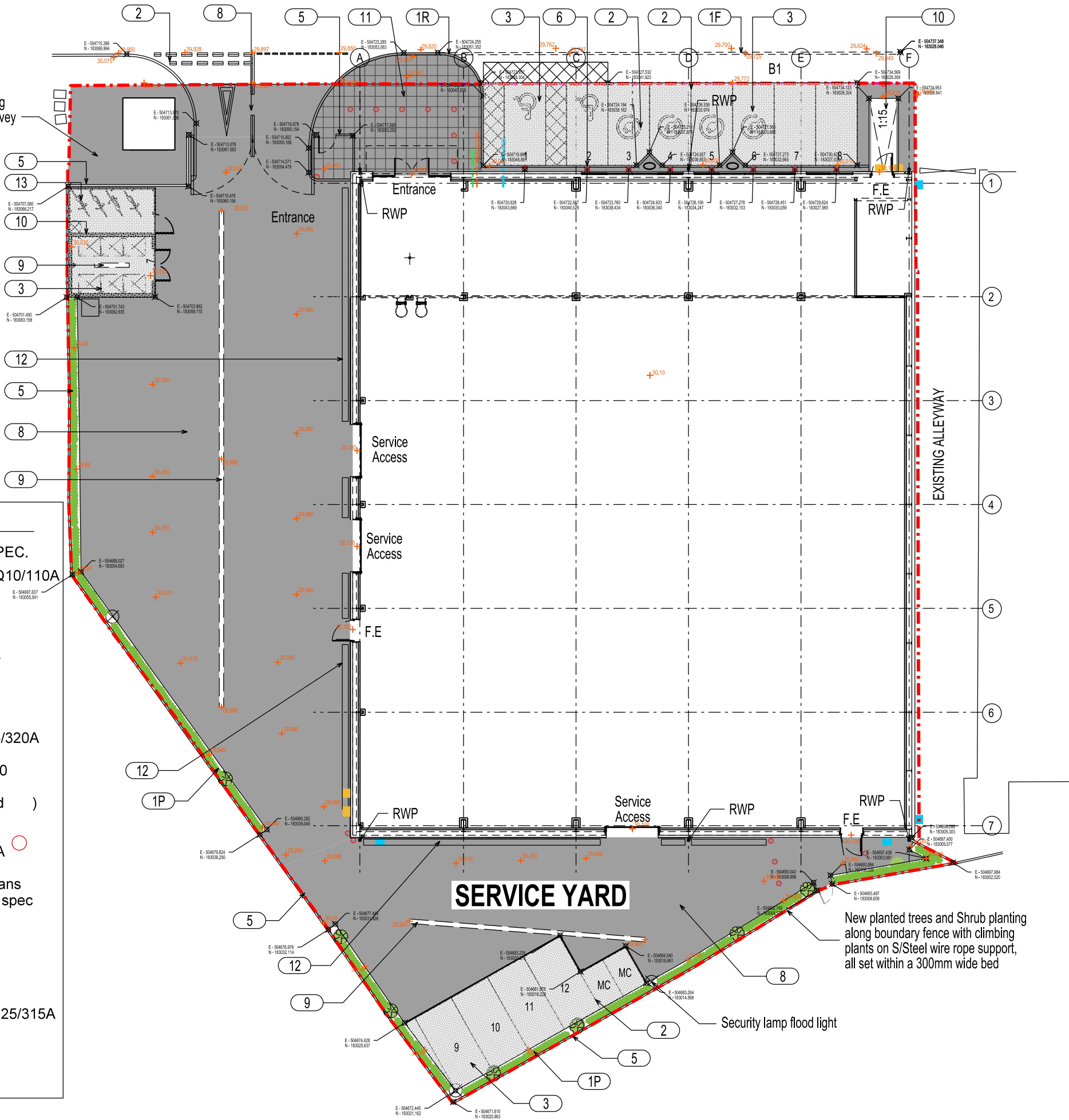

C5	21.03.22	Additional coordinates incorporated	WCS
C4	28.02.22	Additional coordinates incorporated following comments from Mitchells	WCS
C3	28.02.22	Setting out coordinates added	WCS
C2	03.02.22	Green boundary beds amended to give 500mm bed depth	WCS
REV.	DATE	NOTES	INIT.

CLIENT / PROJECT
CYRIL LEONARD
UXBRIDGE INDUSTRIAL ESTATE
BARTON BUILDINGS, UB8 2SN

DRAWING TITLE
PROPOSED EXTERNAL
WORK DETAILS

STATUS				
CONSTRUCTION				
DATE	17.11.21	DRAWN	WCS	SCALE @ A3 1:250
PROJECT NUMBER	10773	UNIT / BLOCK	C	REVISION LETTER
		CI / SFB CODE	D003	
		TYPE & NUMBER	C5	
DRAWING NO.				
10773				
Site Location Plans	L	GA Plans	P	Elevations
Sections	S	Details	D	Prefix Colour

THE RATCLIFFE GROVES PARTNERSHIP
LONDON
19 BEDFORD ROW
LONDON WC1R 4EB
T. 020 7600 6666 E. london@rgp.uk.com
www.rgp.uk.com

MANCHESTER
105 MANCHESTER ROAD
BURY LANCASHIRE BL9 0TD
T. 0161 797 6000 E. manchester@rgp.uk.com

