

# GROUND+FIRST+ROOF PLANS AS PROPOSED

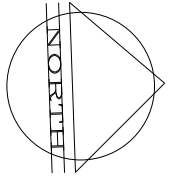

Dashed line indicates the extent of the canopy over.

3No.80mm diam steel posts supporting the roof of canopy over, Posts painted black oil paint.

Roof to the new canopy of corrugated clear PVC supported on 50x200mm black painted steel joists at 600mm centres supported by a 50x100mm black painted steel joist along the line of rear eaves supported, in turn, by 3No. 80mm diam. black painted vertical posts.

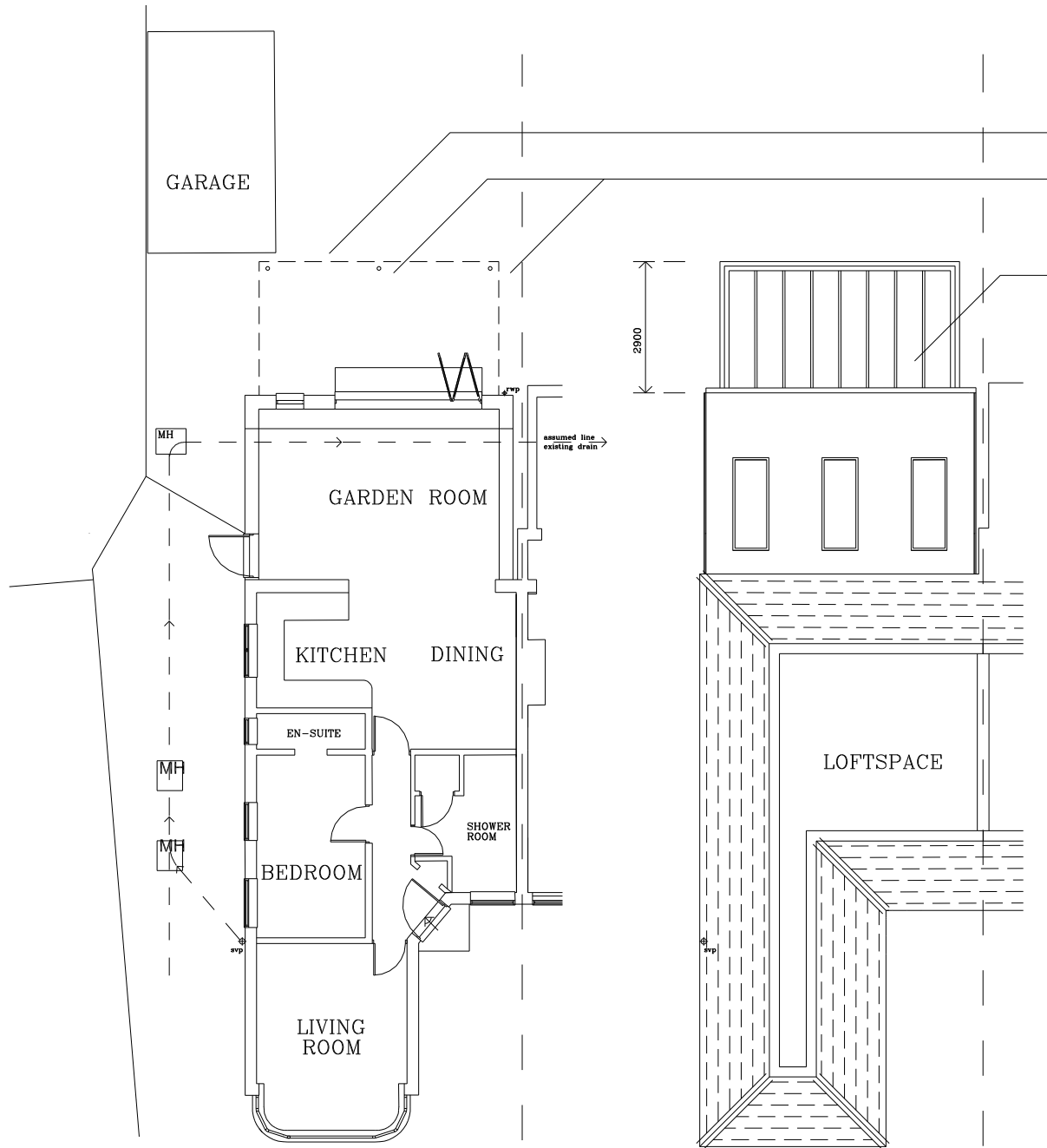

GROUND FLOOR PLAN  
AS PROPOSED

FIRST FLOOR PLAN  
AS PROPOSED.

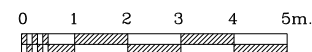

REVISION :	
SHEET TITLE 150, PAVILION WAY, HILLINGDON HA4 9JP.	
SINGLE STOREY CANOPY TO THE REAR OF HOUSE	
FLOOR PLANS AS PROPOSED	
SCALE : 1:100 @A3	STATUS.
DATE : OCT'2023	PRELIMINARY
DRAWN BY : C.L.	COMMENT/APPROVAL X
CHECKED : C.L.	INFORMATION
	TENDER
	CONSTRUCTION
DO NOT SCALE - VERIFY ALL DIMENSIONS ON SITE AND REPORT ALL ERRORS/OMISSIONS TO ARCHITECT BEFORE COMMENCING WORK. IF IN DOUBT - PLEASE ASK.	
DRAWING NUMBER : 22316/ 07	REV.
CHRIS LAWES ARCHITECT	
THE STUDIO, 9, MARBLE HILL CLOSE, TWICKENHAM, MDDX, TW1 3AY TELEPHONE 020.8891.0056 FAX 020.8607.9843	