

PAVILION WAY

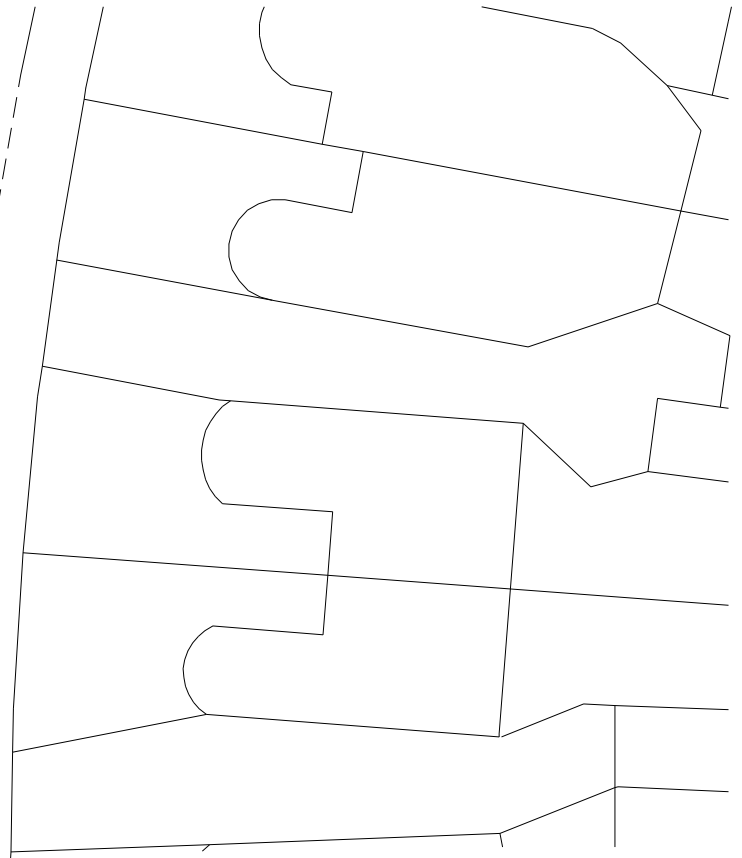
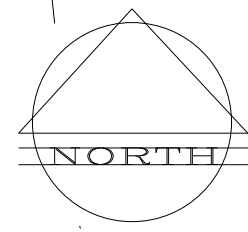

REVISION :	
SHEET TITLE 150, PAVILION WAY, HILLINGDON HA4 9JP.	
SINGLE STOREY CANOPY TO THE REAR OF HOUSE	
BLOCK PLAN	
SCALE : 1:200 @A3	STATUS.
DATE : OCT'2023	PRELIMINARY
DRAWN BY : C.L.	COMMENT/APPROVAL X
CHECKED : C.L.	INFORMATION
	TENDER
	CONSTRUCTION
DO NOT SCALE - VERIFY ALL DIMENSIONS ON SITE AND REPORT ALL ERRORS/OMISSIONS TO ARCHITECT BEFORE COMMENCING WORK. IF IN DOUBT - PLEASE ASK.	
DRAWING NUMBER : 22316/ 05	REV.
CHRIS LAWES ARCHITECT	
THE STUDIO, 9, MARBLE HILL CLOSE, TWICKENHAM, MDDX, TW1 3AY TELEPHONE 020.8891.0056 FAX 020.8607.9843	