

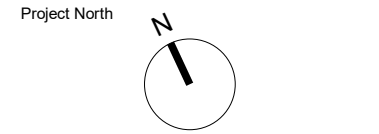

Box Plans Ltd.
124 City Road, London, EC1V 2NX
07748123419
info@boxplans.co.uk
www.boxplans.co.uk

- Notes:
- 1. Do not scale from drawings - except for local authority planning purposes only.
 - 2. All dimensions are to be verified on site by the contractor prior to setting out, ordering any materials, fabrication or construction.
 - 3. Any discrepancies to be reported to Box Plans Ltd. immediately.



Key

Rev.	Date	Amendment
Job Title:		
28 The Drive		
Drawing Title:		
Existing Parking Plan		
Status:	PLANNING	
Project Number:	16022024	
Drawing Number:	A3100	
Date:	Match 2024	

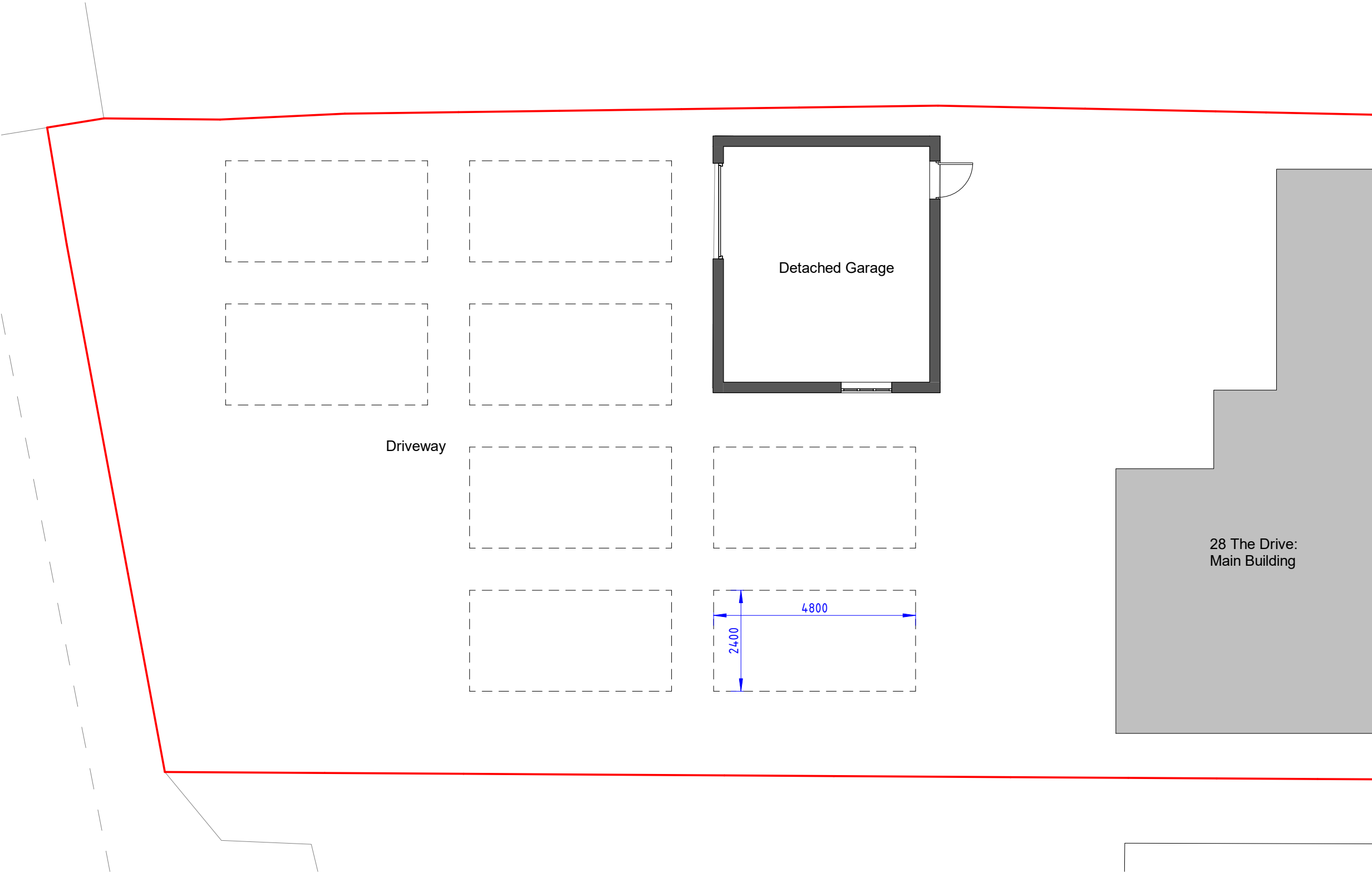
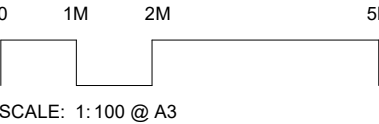

Existing Parking Plan
1 : 100