

Existing Site Location Plan

Scale 1:1250



Proposed Site Location Plan

Scale 1:1250



Existing Block Plan

Scale 1:500

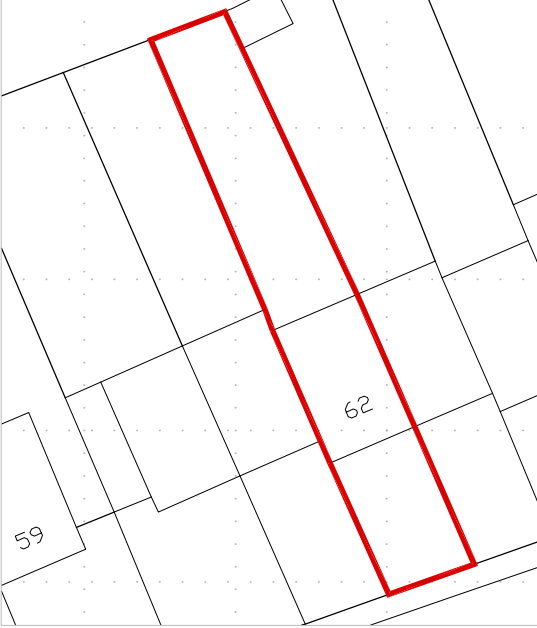

Proposed Block Plan

Scale 1:500

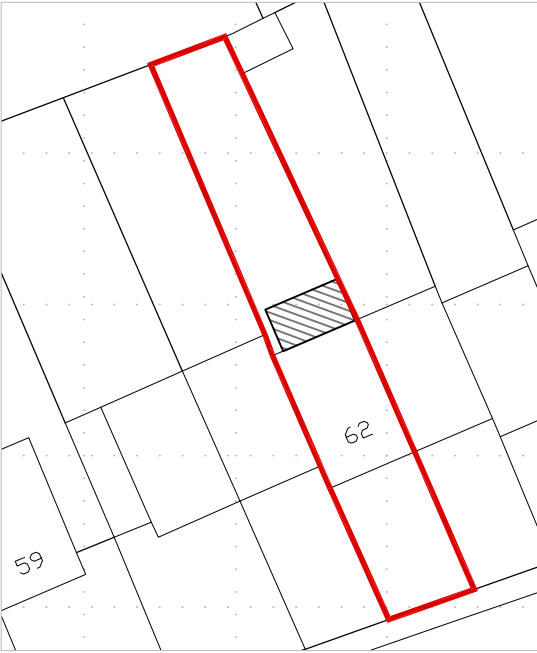

General Notes:
Do not scale, use figured dims only. Unless otherwise noted all dimensions are given in millimetres. All dims to be verified on site by the Contractor before work commences. If any discrepancies are found, Ktech is to be notified immediately for amendments. All work to be carried out in strict accordance to relevant & current British Standards, Codes of Practice, CDM Regulations & Building Regulations. Where structural alterations take place, care must be taken by the Contractor to afford required restraint to all affected areas during & after the building work. Where new loads are imposed on existing linets, they must be checked by the Builder for adequacy & to LA & SE approval & replaced if necessary. Where applicable, the drawing must be read in conjunction with Structural Calculations & other Consultants drawings. If drawings service for Planning and Building Regulations submissions only, the company accepts no liability for any site works, defects or future defects. Ktech drawings must not be reproduced wholly or in part without prior permission from the company.
© Copyright Ktech technical drawings

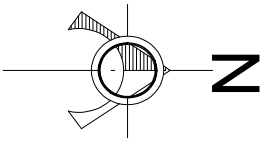

Rev Date Amendment

Ktech technical drawings

Berkhamsted House 121 High Street, Berkhamsted, Herts, HP4 2DJ
07711182591 01494 717018 info@ktechdrawings.co.uk

Project 62 Azalea Walk, Eastcote,
Pinner, HA5 2EH

Drawing title:
Single storey rear extension -
Site location & block plans

Scale: 1:1250/500@A4 Drawn: 30/04/2025

Drawing No.: 25-08_PL01 Rev: -

Drawing status: For Planning Approval