

CTC Hayes

Stage 3 |

Grand Union Canal wall

14.09.21 (Rev B- DRAFT)

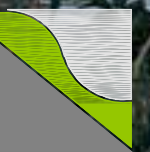

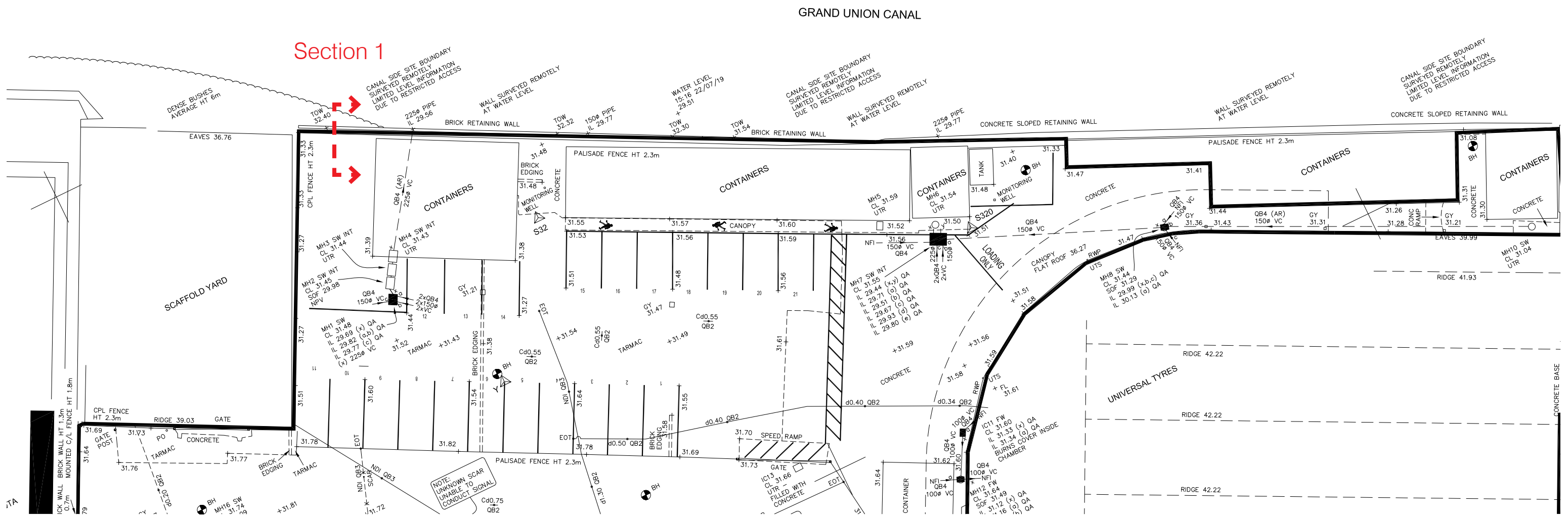
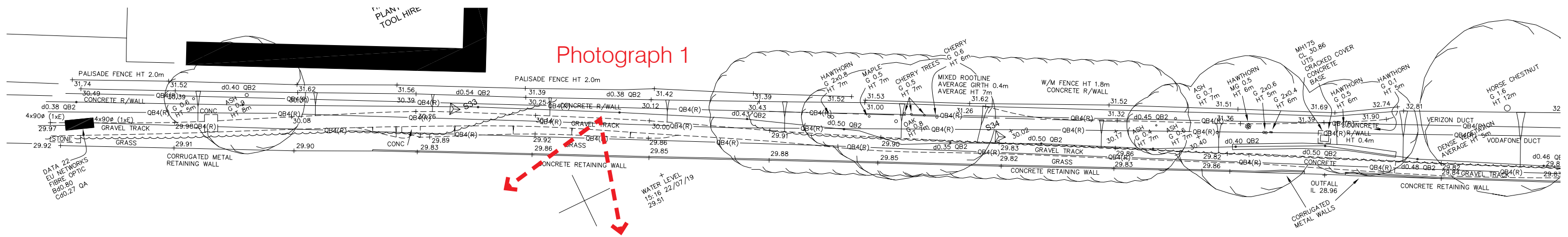



Proposal

1. Remove metal palisade fencing to back face of wall
2. Lower height of existing wall to a consistent height (approx. +31.70)
3. Locate a new metal post and rail to the back face of the wall
4. Raise levels as shown by ~200mm
5. Locate some native planting on the inside of rail within red line boundary

Photograph 1

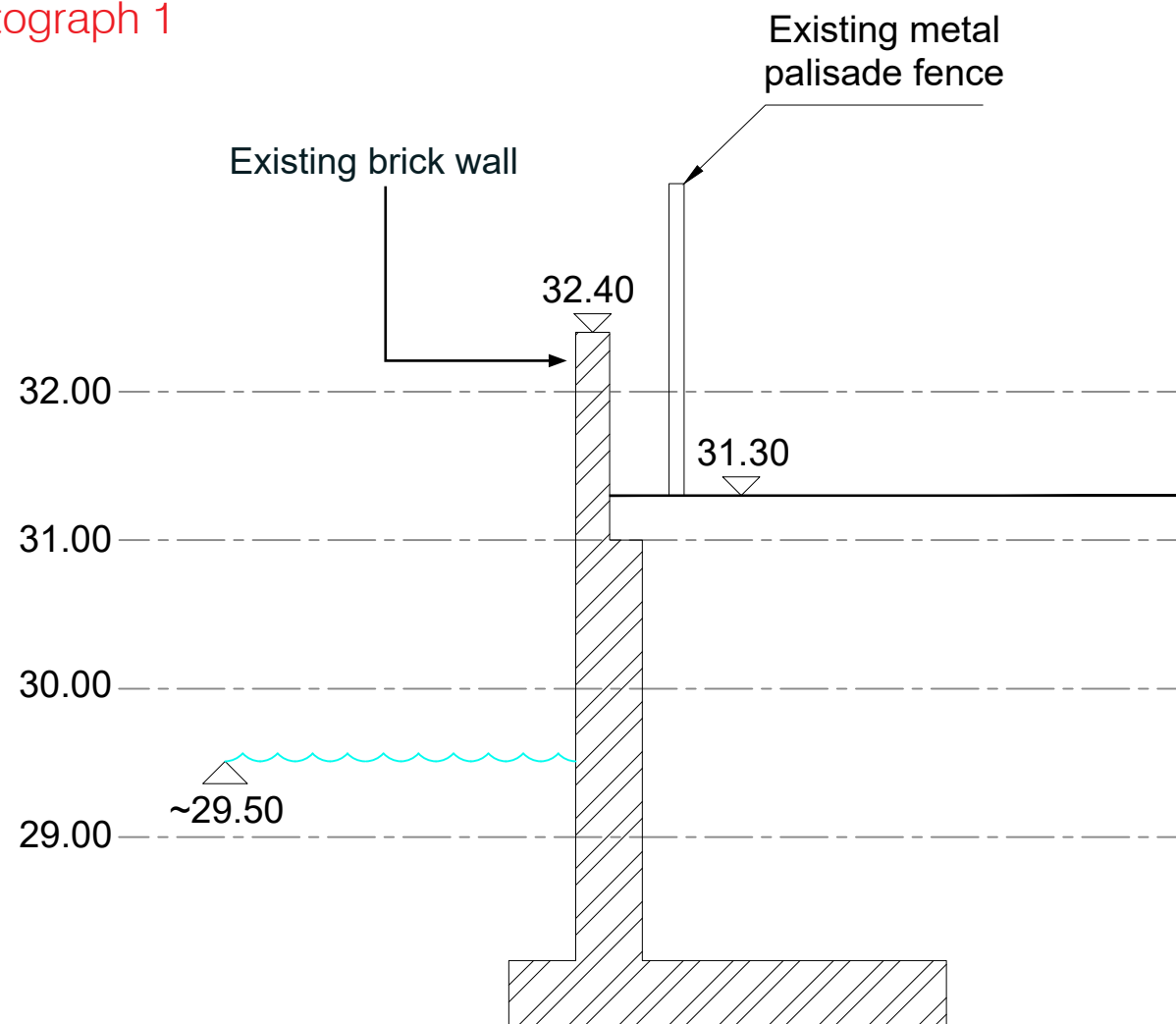

Existing section 1

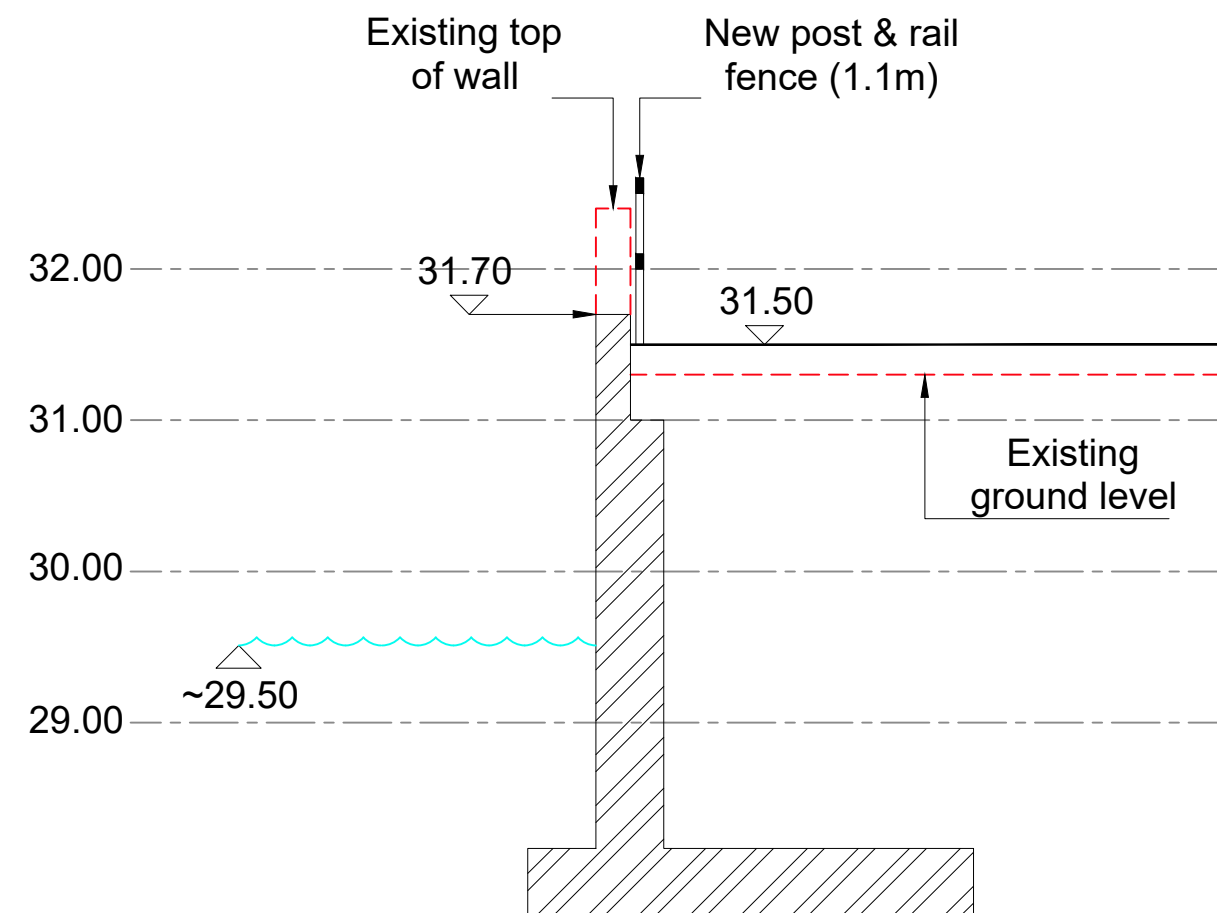

Proposed section 1

DISCLAIMER

Please note that the wall & structure below ground have been shown indicatively. Please refer to the Canal Wall Survey for further information



Photograph 2

Proposal

1. Remove metal palisade fencing to back face of wall
2. Lower height of existing wall to a consistent height (approx. +31.70)
3. Locate a new metal post and rail to the back face of the wall
4. Raise levels as shown by ~200mm
5. Locate some native planting on the inside of rail within red line boundary

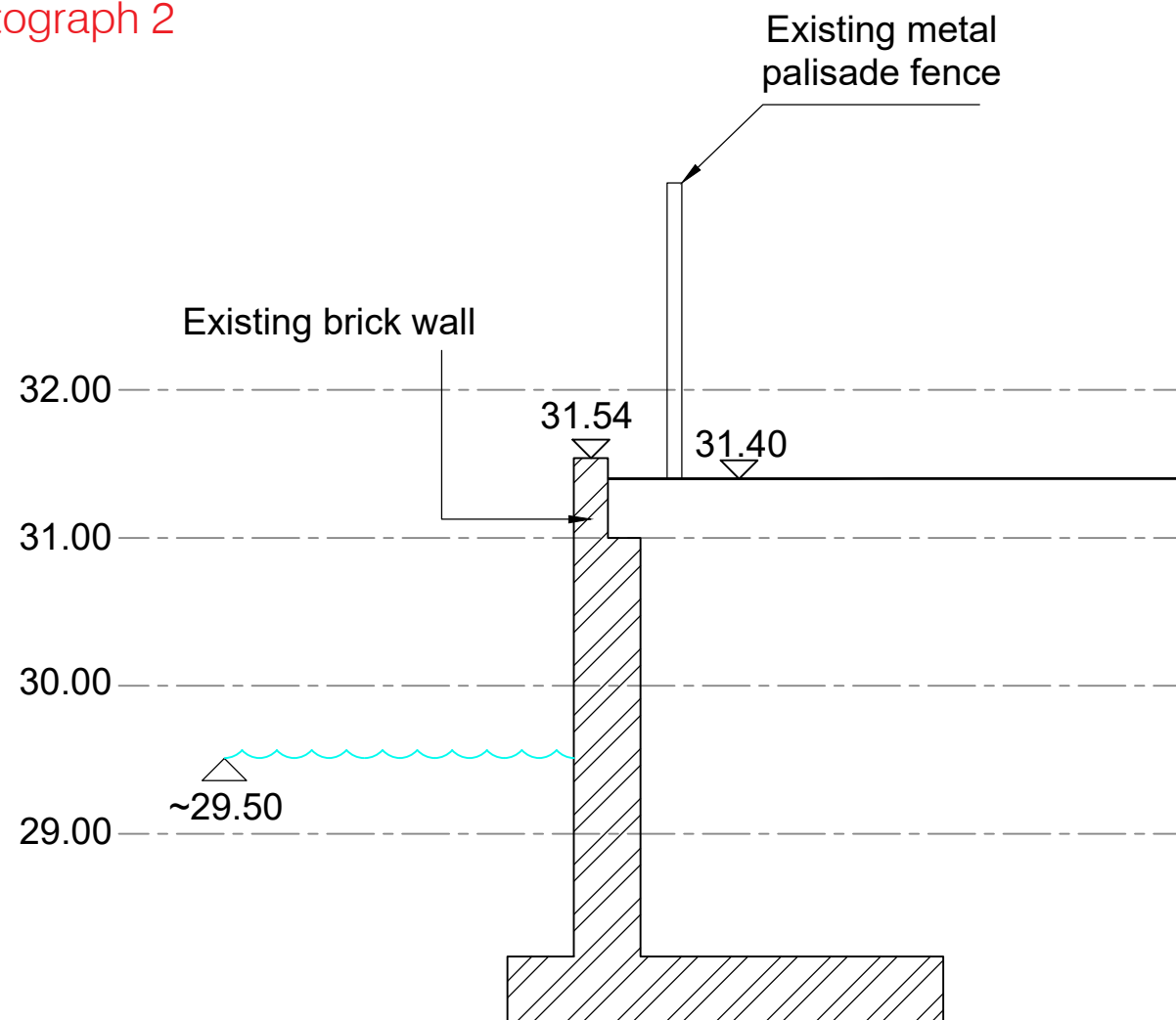

Existing section 2

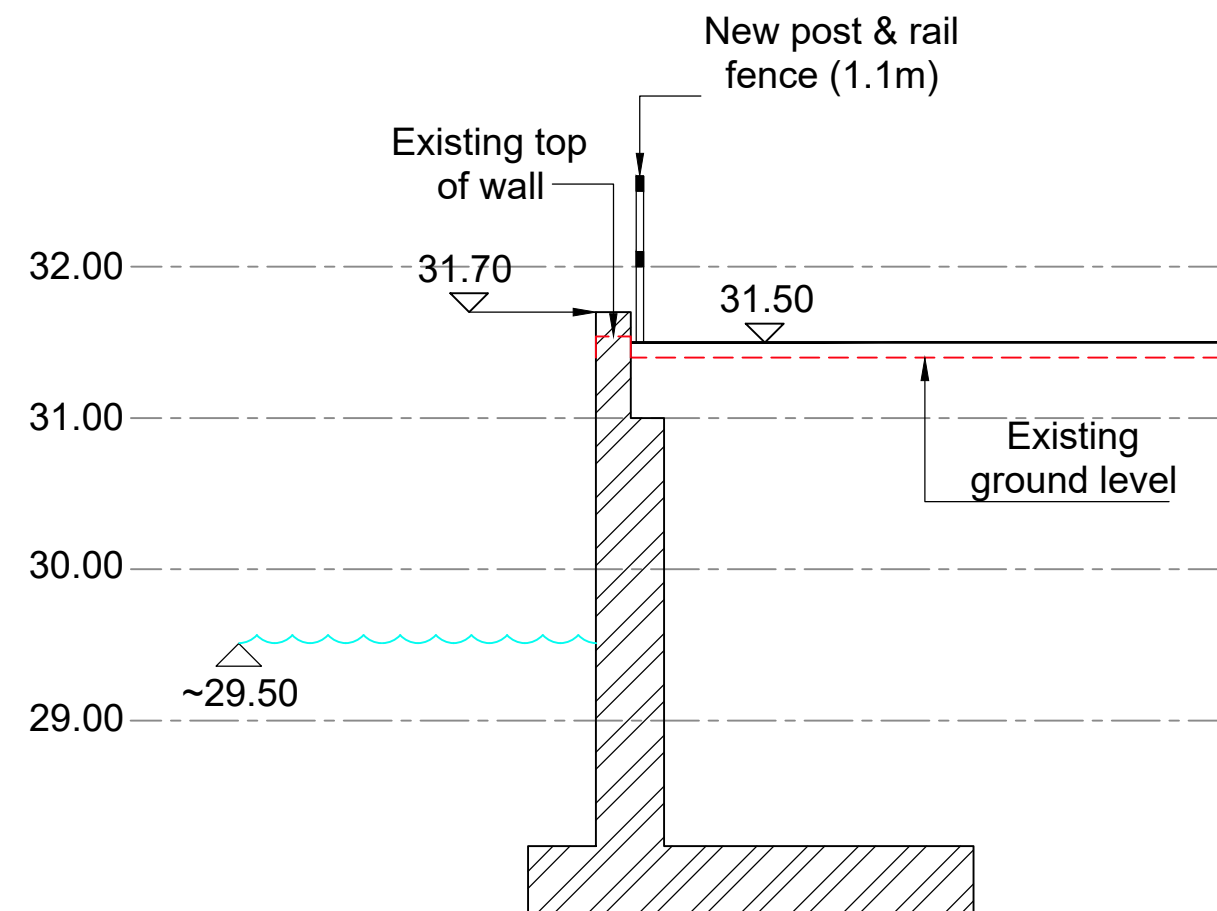

Proposed section 2

DISCLAIMER

Please note that the wall & structure below ground have been shown indicatively. Please refer to the Canal Wall Survey for further information