

- K1 - Flush kerb (50mm wide)
- K2 - Flush kerb (125mm wide)
- K3 - Flush kerb (255mm wide)
- K4 - Kerb upstand 125mm (125mm wide)
- K5 - Kerb upstand 25mm (255mm wide)
- K6 - Timber edging to soft landscape

ALL current drawings and specifications for the project must be read in conjunction with the Designer's Hazard and Environmental Assessment Record.

notes

- The contractor is responsible for checking dimensions, tolerances and references.
- Any discrepancy to be verified with the Architect before proceeding with the works.
- Where an item is covered by drawings to different scales the larger scale drawing is to be worked to.
- Do not scale drawing. Figured dimensions to be worked to in all cases.

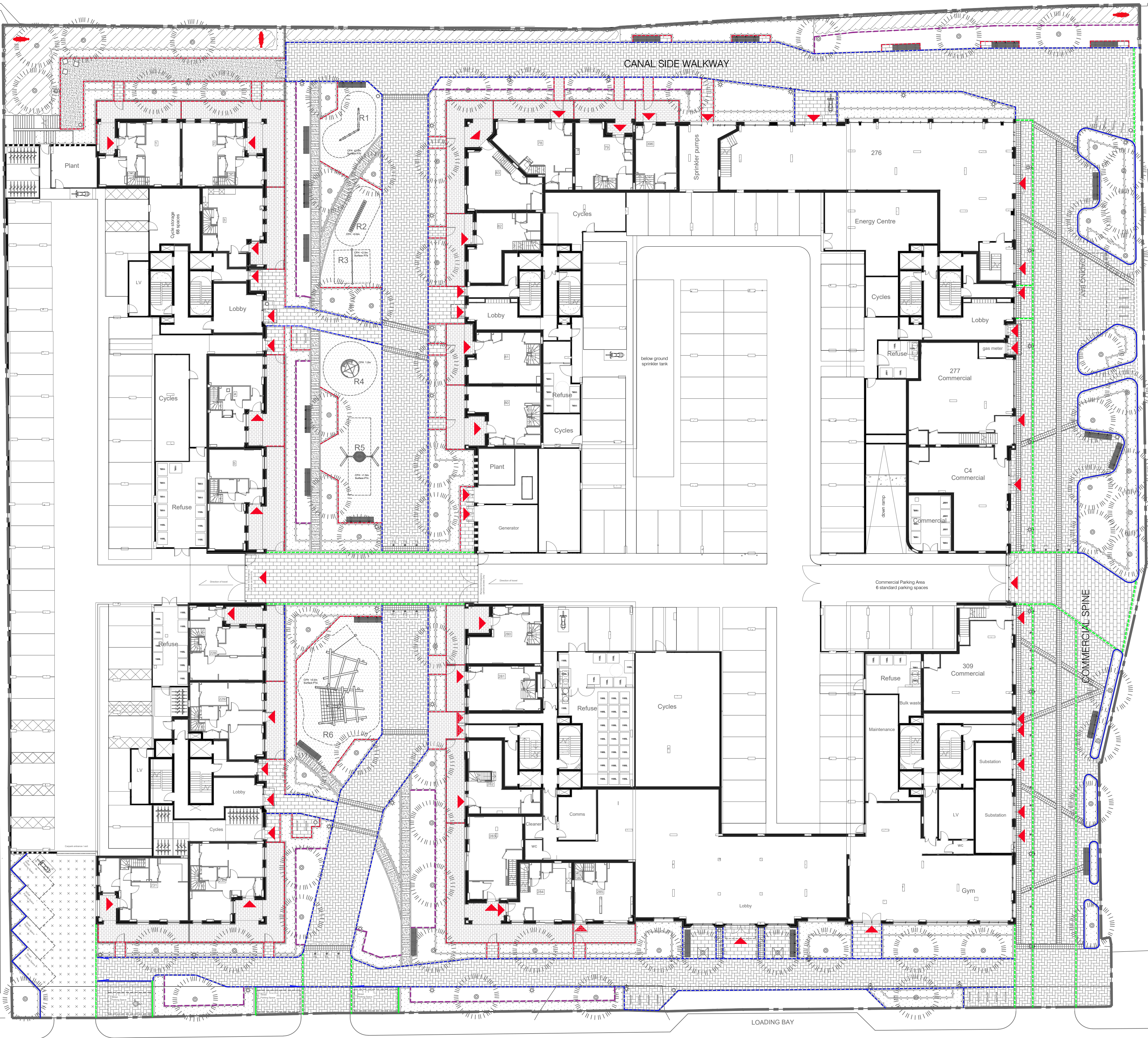

P1	ISSUED FOR PLANNING	13.02.23
REV	AMENDMENT	DATE

Client:
GREYSTAR

GREYSTAR™
The Global Leader in Rental Housing

Project:
CROWN TRADING CENTRE,
HAYES, LONDON

Title:
Kerb Strategy Plan

Scale:
1 : 250 | A1



Date FEB 2023
Drawn DT
Checked PW



L.D.A.
LANDSCAPE DESIGN ARCHITECTURE
17a Cannon Hill Rd
Coventry
CV4 7AZ
Tel: 02476 696866 Mob: 07977 483787
info@landscapearchitecture.co.uk

Drawing no. L1115 - 3.1 - 2003

Job no. L1115

Revision. P1